

HERTFORDSHIRE COUNTY COUNCIL

COMMONS ACT 2006

Schedule 2 Paragraph 2

Notice of proposal to Notice of proposal to amend the Register by registering Common Land in the parish of Hertford

As Commons Registration Authority for Hertfordshire, Hertfordshire County Council is proposing to amend the register for common land by adding to the Register land at Hartham Common, as shown coloured in green on the accompanying plan, located south of the River Beane and to the north and west of the River Lee in Hertford because the land was not registered under the Commons Registration Act 1965 but is regulated by a scheme made under the Commons Act 1899.

Copies of the proposal which includes a plan of the land affected and supporting evidence are available for inspection at County Hall and may be seen free of charge at Front Reception, County Hall, Hertford, SG13 8DN between 9.00 am to 4.00 pm on Monday to Friday. Please quote the reference number of the application, CLP037.

Anyone wishing to make a representation to Hertfordshire County Council about this application must do so in writing. All representations must be received by 3rd April 2019. The representation must state your name and postal address, the nature of your interest in the land, the grounds on which your representation is made and must be signed by you. You may also include an email address. It should be sent to Angela Simpkins, Countryside & Rights of Way Service (CHN101), Hertfordshire County Council, County Hall, Pegs Lane, Hertford, SG13 8DN; email: angela.simpkins@hertfordshire.gov.uk. Please quote the reference number of the application, CLP037.

Any representations received will not be treated as confidential and will be copied to the applicant for their comment. Representations will also be made available for inspection and where applicable will be sent to the Planning Inspectorate for a decision

21st February 2019

**Decision as to whether to make a proposal under Schedule 2
of the Commons Act 2006 to amend the commons or village
green register**

Name and location of land
Hartham Common
CL ref (if any)
No register number
Relevant paragraph under Schedule 2
Sch 2(2)
Summary of evidence
Hartham Common was not subject to an application under the Commons Registration Act 1965. The Hartham Common Scheme of Regulation (including a plan) was made pursuant to The Commons Act 1899 and was approved by the Board of Agriculture on 17/05/1902.
Decision as to whether to make a proposal
Following HCC's initial decision, dated 31 st May 2017, to make a proposal subject to consent from East Herts District Council ("EHDC") in respect of buildings on the land, HCC discussed the proposal with EHDC (landowner). EHDC has identified areas of land which are covered by buildings or which it considers to be within the curtilage of the buildings. These are areas which EHDC does not consent to registration, pursuant to regulation 14(3) of the Commons Registration (England) Regulations 2014. HCC has therefore amended the area of land proposed to be registered; removing the buildings and curtilage identified by the EHDC.

Richard Cuthbert

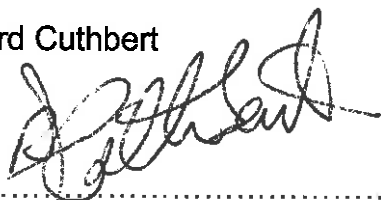

.....
Definitive Map & Enforcement Team Leader

05/11/2018

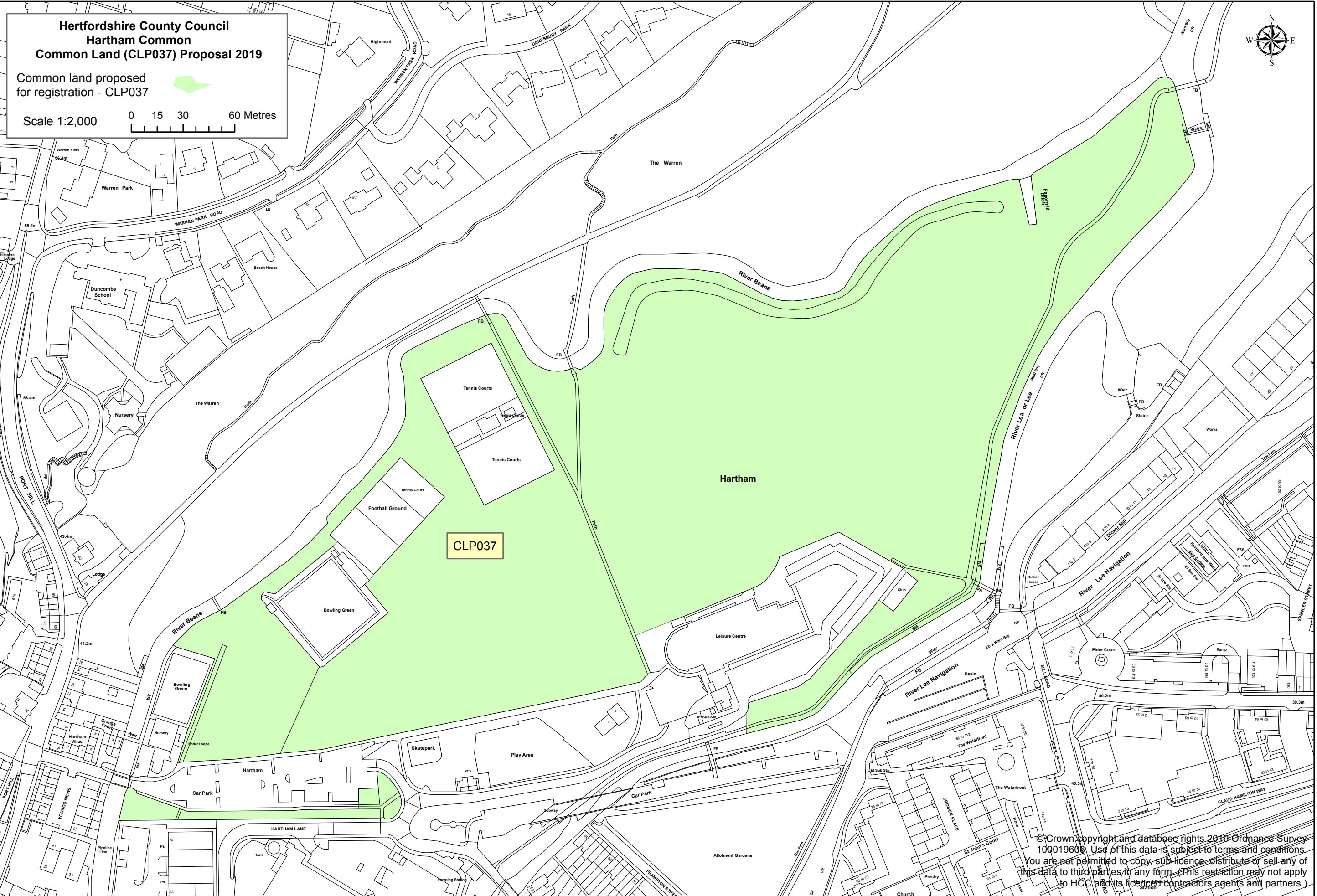

© Crown copyright and database rights 2018 Ordnance Survey
 100019606 Use of this data is subject to terms and conditions
 You are not permitted to copy, sub-licence, distribute or sell any of
 this data to third parties in any form. (This restriction may not apply
 to HCC and its licensed contractors agents and partners.)