

NOTICE OF CONFIRMATION
OF MODIFICATION ORDERS

Section 53 of the Wildlife and Countryside Act 1981

HERTFORDSHIRE COUNTY COUNCIL

Definitive Map and Statement of Public
Rights of Way in Hertfordshire

The Hertfordshire County Council

(Albury 36) Modification Order 2003
(Albury 33) Modification Order 2003
(Furneux Pelham 25 & Albury 34) Modification Order 2003

The above named Orders, made on 19th December 2003, were confirmed with modifications by an Inspector acting for the Secretary of State for the Environment. The Hertfordshire County Council (Albury 36) Modification Order 2003 was confirmed on 19th September 2011, the Hertfordshire County Council (Albury 33) Modification Order 2003 and the Hertfordshire County Council (Furneux Pelham 25 & Albury 34) Modification Order 2003 were confirmed on 12th July 2012.

The effect of the Orders as confirmed is to modify the Definitive Map and Statement by:

- adding a BR from the junction with Albury BR 13 and Albury FP 13a running generally east and then south to join Albury BR 8.
- adding a BR commencing at Patmore Heath running to the junction with Albury FP 32 and upgrading to BR the public right of way running SE from Albury FP 32 to the junction with Albury FP 33a and adding a BR from the junction with Albury FP 33a to Mount Pleasant, Mill Lane
- adding a FP commencing NW of Patmore Hall Wood from the Hixham Road at a junction with Furneux Pelham FP 19 running generally SE to the watercourse, then generally S for approx. 125m before crossing the watercourse and continuing SSE, to parish boundary, continuing generally W then S alongside the watercourse to the junction with Albury FP 15.

A copy of the confirmed Orders may be seen free of charge at Front Reception of Hertfordshire County Council, County Hall, Hertford, from 9.00 am to 4.00 pm on Monday to Friday and can be bought from Hertfordshire County Council at a cost of £2 each. A copy of the confirmed Orders and Notice may also be seen at East Herts District Council, Wallfields, Pegs Lane, Hertford. SG13 8EQ.

The Orders become operative as from the date on which they are confirmed, but if a person aggrieved by any of the Orders desires to question the validity thereof, or of any provision contained therein, on the ground that it is not within the powers of the Wildlife and Countryside Act 1981, or on the ground that any requirement of the Act, or any regulation made thereunder, has not been complied with in relation to the Orders, he may, under paragraph 12 of Schedule 15 of the Act within 42 days from August 16th 2012, make application for the purpose of the High Court.

Date: August 16th 2012

153/4/57

WILDLIFE AND COUNTRYSIDE ACT 1981
The Definitive Map and Statement of Public Rights of Way in Hertfordshire

Hertfordshire County Council
(Albury 33)
Modification Order 2003

This Order is made by Hertfordshire County Council under Section 53(2)(b) of the Wildlife and Countryside Act 1981 ("the Act") because it appears to that authority that the Definitive Map and Statement of Public Rights of Way in Hertfordshire requires modification in consequence of the occurrence of events specified in Sections 53(3)(c)(i) and 53(3)(c)(ii) of the Act, namely, the discovery by the authority of evidence which (when considered with all other relevant evidence available to them) shows that a right of way which is not shown in the map and statement subsists or is reasonably alleged to subsist over land in the area to which the map relates, being a right of way to which this Part applies; and that a highway shown in the map and statement as a highway of a particular description ought to be there shown as a highway of a different description.

The authority have consulted with every local authority whose area includes land to which the Order relates. Hertfordshire County Council hereby order that:

1. For the purposes of this Order the relevant date shall be 07 December 2003.
2. The Definitive Map and Statement of Public Rights of Way in Hertfordshire shall be modified as described in Part I and Part II of the Schedule and shown on the plan forming part of this Order ("the Order Plan").
3. This Order shall take effect on the date it is confirmed and may be cited as the Hertfordshire County Council (Albury 33) Modification Order 2003

SCHEDULE
Part I
Modification of Definitive Map

DESCRIPTION OF PATHS OR WAYS TO BE ADDED

A bridleway commencing at Patmore Heath at a point marked A on the Order Plan, thence generally SW for approximately 35m to the junction with Albury 32, marked B on the Order Plan.

Width: ~~7m~~ 4m

A bridleway commencing at the junction with Albury 33a at point C on the Order Plan, thence SE for approximately 310m to point D on the Order Plan, thence S for approximately 200m to Mount Pleasant, Mill Lane, at point E on the Order Plan.

Width: 2.4m

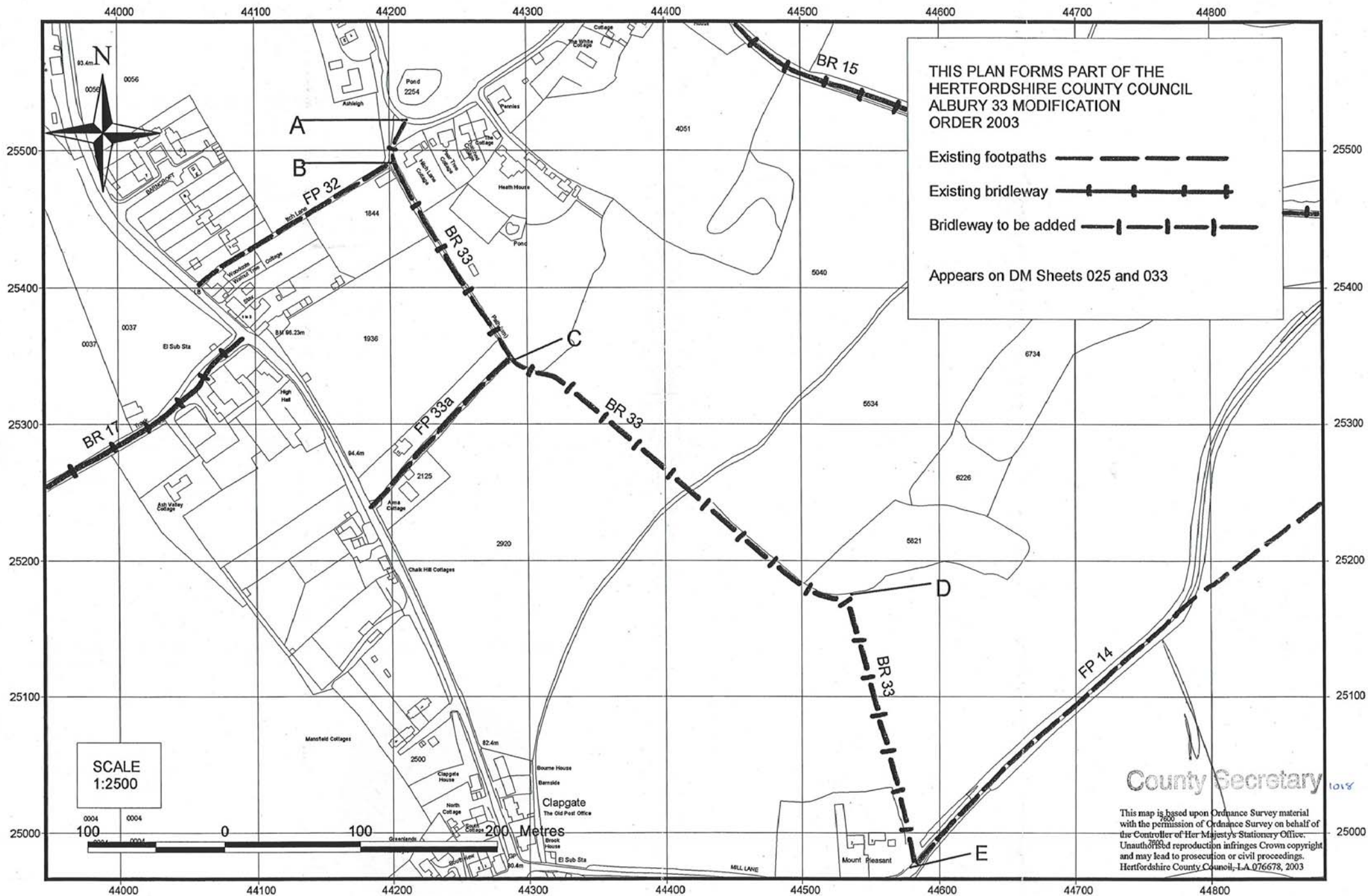

THIS PLAN FORMS PART OF THE
 HERTFORDSHIRE COUNTY COUNCIL
 ALBURY 33 MODIFICATION
 ORDER 2003

Existing footpaths ————
 Existing bridleway ————
 Bridleway to be added ————

Appears on DM Sheets 025 and 033

SCALE
 1:2500



County Secretary

This map is based upon Ordnance Survey material with the permission of Ordnance Survey on behalf of the Controller of Her Majesty's Stationary Office. Unauthorised reproduction infringes Crown copyright and may lead to prosecution or civil proceedings. Hertfordshire County Council, I.A.076678, 2003

DESCRIPTION OF PATHS OR WAYS TO BE UPGRADED

Part of footpath 33 to be upgraded to bridleway commencing at the junction with Albury 32 at point B on the Order Plan, thence SE for approximately 170m to the junction with Albury 33a at point C on the Order Plan.

Width: The route has a width of ~~between 5m and 7m~~ ^{4m}

Point	Grid Reference
A	TL 4421 2552
B	TL 4420 2549
C	TL 4429 2535
D	TL 4453 2517
E	TL 4458 2498

**Part II
Modification of Definitive Statement**

Variation of particulars of path or way

The Statement shall be amended for Albury 33 as follows:

Path No	O.S. Map Ref HCC Ref	Status	Description of Right of Way	Width	Limitations
33	TL 42 NW HCC25 TL 42 SW HCC33	BR	Commences from County Road at Patmore Heath by Hitch Lane Cottage, at TL 4421 2552, thence SW to the junction with FP 32, thence SE along path to junction with Footpath 33a at TL 4429 2535, thence SE to wood at TL 4453 2517, thence generally S to Mount Pleasant, Mill Lane at TL 4458 2498.	Between 2.4m and 7m 4m (points A-B-C) and 2.4m (points C-D-E)	
33a	TL 42 NW HCC25	FP	Commences at junction with county road S of High Hall, thence NE to junction with BR 33 at TL 4429 2535.		

IN WITNESS whereof the COMMON SEAL of the HERTFORDSHIRE COUNTY COUNCIL was hereunto affixed this 19th day of December 2003

The Common Seal of HERTFORDSHIRE COUNTY COUNCIL was hereunto affixed in the presence of:-

[Signature]
County Secretary



1018

The foregoing order is hereby confirmed
subject to the red ink modifications thereon

Mark Yates 11 2 JUL 2012

An Inspector appointed by The Secretary
of State for Environment, Food and
Rural Affairs