

NOTICE OF CONFIRMATION OF MODIFICATION ORDER

Section 53 of the Wildlife and Countryside Act 1981

HERTFORDSHIRE COUNTY COUNCIL

Definitive Map and Statement of Public Rights of Way in Hertfordshire

Hertfordshire County Council (Anstey 20) Modification Order 2015

The above named Order, made on 10th September 2015, was confirmed without modification on 8th January 2016.

The effect of the Order as confirmed is to modify the Definitive Map and Statement by adding to them a restricted byway commencing from Coltsfoot (public highway) at TL 4117 3219 running along the track generally east north-east for approximately 135 metres to a junction with Anstey Footpath 8 at TL 4130 3223. Continuing along the track east north-east then east for approximately 410 metres then north for approximately 115 metres then north-east for approximately 195 metres to join Anstey Bridleway 9 at TL 4187 3253.

A copy of the order and the order plan may be seen free of charge at front reception of Hertfordshire County Council, County Hall, Hertford, from 9.00 am to 4.00 pm on Monday to Friday and at East Herts District Council, Pegs Lane, Hertford SG13 8EQ. Copies of the order and plan may be bought at the price of £2.

The Order becomes operative as from the date on which it was confirmed, but if a person aggrieved by the Order desires to question the validity thereof, or of any provision contained therein, on the ground that it is not within the powers of the Wildlife and Countryside Act 1981, or on the ground that any requirement of the Act, or any regulation made thereunder, has not been complied with in relation to the Order, he may, under paragraph 12 of Schedule 15 of the Act within 42 days from 17th March 2016, make application for the purpose of the High Court.

Date: 17th March 2016

WILDLIFE AND COUNTRYSIDE ACT 1981
The Definitive Map and Statement of Public Rights of Way in
Hertfordshire

Hertfordshire County Council
(Anstey 20)
Modification Order 2015

This Order is made by Hertfordshire County Council under Section 53(2)(b) of the Wildlife and Countryside Act 1981 ("the Act") because it appears to that authority that the Definitive Map and Statement of Public Rights of Way in Hertfordshire require modification in consequence of the occurrence of an event specified in Sections 53(3)(c)(i) and 53(3)(c)(iii) of the Act, namely:

(c) the discovery by the authority of evidence which (when considered with all other relevant evidence available to them) shows



- (i) that a right of way which is not shown in the map and statement subsists or is reasonably alleged to subsist over land in the area to which the map relates, being a right of way such that the land over which the right subsists is a public path, a restricted byway or, subject to section 54A, a byway open to all traffic
- (iii) that there is no public right of way over land shown in the map and statement as a highway of any description, or any other particulars contained in the map and statement require modification.

The authority have consulted with every local authority whose area includes the land to which the Order relates. Hertfordshire County Council hereby order that:

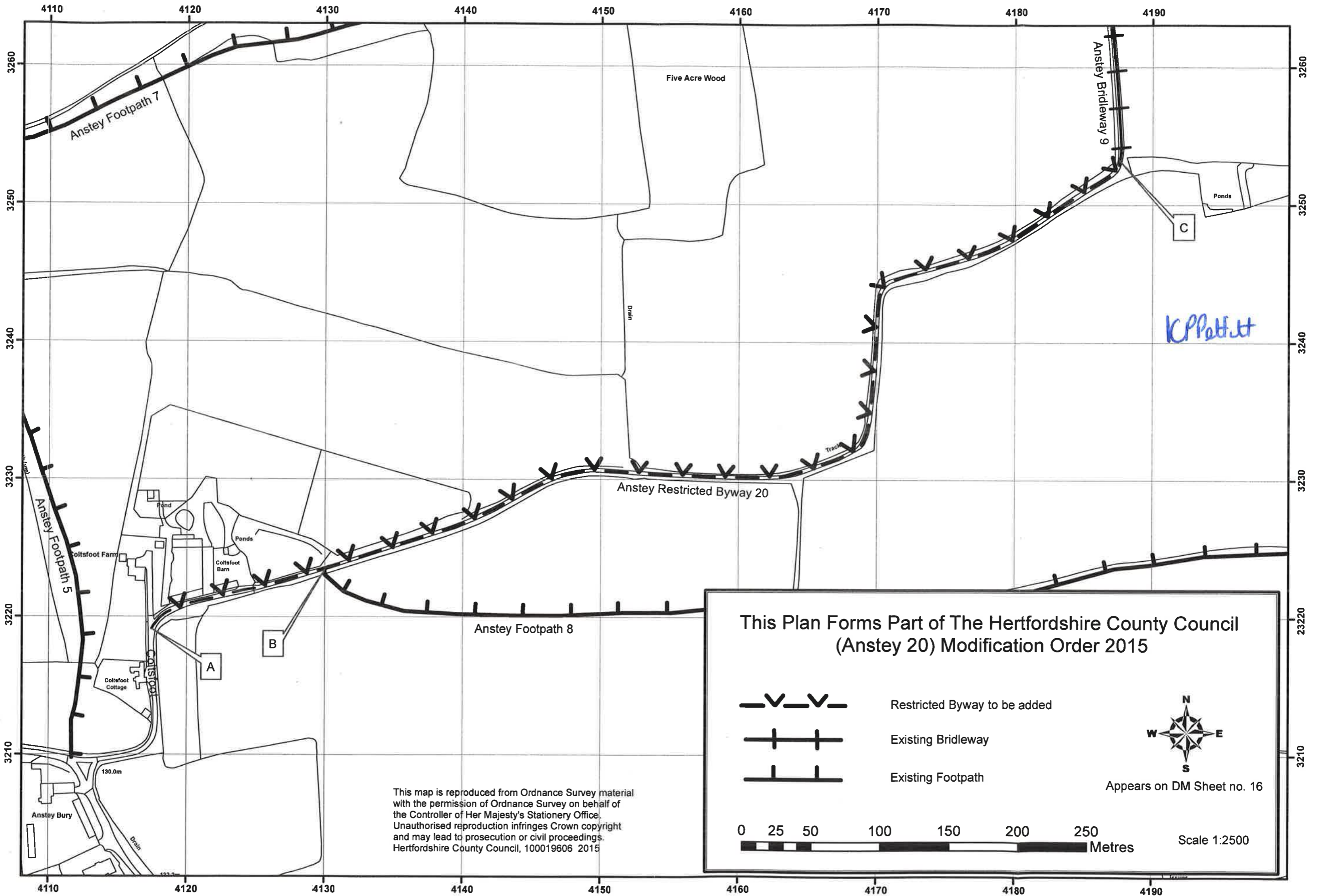
1. For the purposes of this Order the relevant date is 17th August 2015.
2. The Definitive Map and Statement of Public Rights of Way in Hertfordshire shall be modified as described in Part I and Part II of the Schedule and shown on the plan forming part of this Order ("the Order Plan").
3. This Order shall take effect on the date it is confirmed and may be cited as the Hertfordshire County Council (Anstey 20) Modification Order 2015.



This Plan Forms Part of The Hertfordshire County Council
(Anstey 20) Modification Order 2015

-  Restricted Byway to be added
-  Existing Bridleway
-  Existing Footpath

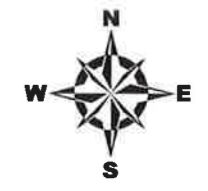

Appears on DM Sheet no. 16



Scale 1:2500

This map is reproduced from Ordnance Survey material with the permission of Ordnance Survey on behalf of the Controller of Her Majesty's Stationery Office. Unauthorised reproduction infringes Crown copyright and may lead to prosecution or civil proceedings. Hertfordshire County Council, 100019606 2015

SCHEDULE
Part I
Modification of Definitive Map

DESCRIPTION OF PATH OR WAY TO BE ADDED

Coltsfoot Lane. Commences from Coltsfoot (public highway) at TL 4117 3219 (point A on the Order Plan) running along the track generally east north-east for approximately 135 metres to a junction with Anstey Footpath 8 at TL 4130 3223 (point B on the Order Plan). Continuing along the track east north-east then east for approximately 410 metres then north for approximately 115 metres then north-east for approximately 195 metres to join Anstey Bridleway 9 at TL 4187 3253 (point C on the Order Plan).

Width: Varies between 4.8 metres & 14.5 metres as shown uncoloured on the 1910 Finance Act map.

Limitations: None.

**Part II
Modification of Definitive Statement**

VARIATION OF PARTICULARS OF PATH OR WAY

A new Statement shall be recorded for Anstey 20 as follows:

Path No	Status	HCC Map Ref
---------	--------	-------------

020	RB	HCC 16
Coltsfoot Lane. Commences from Coltsfoot (public highway) at TL 4117 3219 running along the track generally ENE for approx. 135m to a junction with FP 8 at TL 4130 3223. Continuing generally ENE then E for approx. 410m then N for approx. 115m then NE for approx. 195m to join BR 9 at TL 4187 3253.		

Width Varies between 4.8m & 14.5m as shown uncoloured on the 1910 Finance Act map.

Limitations None

The Statement for Anstey 8 shall be amended as follows:

Path No	Status	HCC Map Ref
---------	--------	-------------

008	FP	HCC 16
Commencing at a junction with RB20 at TL 4130 3223 near Coltsfoot then proceeding E to parish boundary at Ladylike Grove.		

Width

Limitations

The Statement for Anstey 9 shall be amended as follows:

Path No	Status	HCC Map Ref
009	BR	HCC 16

Commencing at end of RB20 leading from Coltsfoot at TL 4187 3253 thence N to join county road E of Hale Farm and near Meesden parish boundary.

**Width
Limitations**

IN WITNESS whereof the COMMON SEAL of HERTFORDSHIRE COUNTY COUNCIL was hereunto affixed this 10th day of September 2015

The Common Seal of
HERTFORDSHIRE
COUNTY COUNCIL
was hereunto affixed
in the presence of:-
Kathryn Pettitt
Chief Legal Officer

KPettitt



The foregoing Order is
hereby confirmed

~~Chief Legal Officer~~

Dated

8 January 2016

Mary Cornack

Mary Cornack
Asst Chief Legal Officer