

REGISTER OF APPLICATIONS - PUBLIC PATH ORDERS

DETAILS OF APPLICATION

District East Herts File Name Bishops Stortford BR10
 Parish Bishops Stortford Application Date 26/11/04

Grid References

Application to Point A TL 466, 221
Divert bridleway Point B TL 466, 220

Applicant P & O James

	City	Town	Village
Nearest	<u>Cambridge</u>	<u>Bishops Stortford</u>	<u>Bury Green</u>

Addresses of properties affected	House Name/Street	Postcode
	<u>Hadham Lodge, Hadham Rd</u>	<u>CM23 1JH</u>

DETERMINATION (DECISION) OF APPLICATION

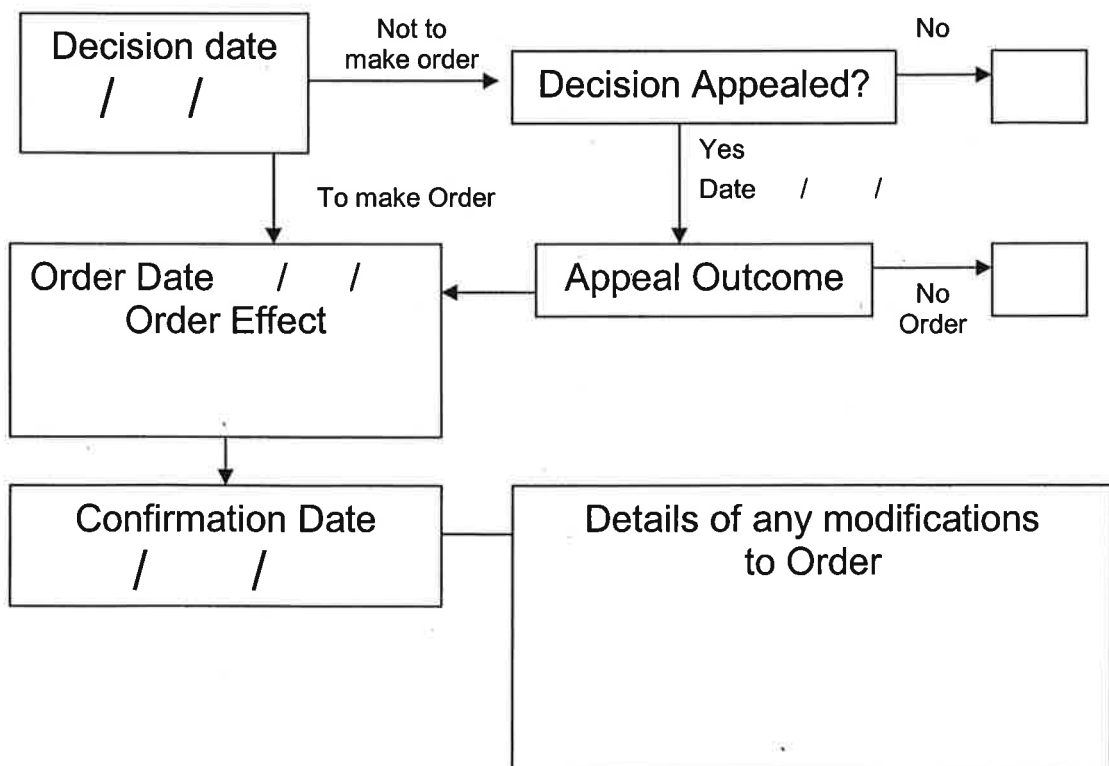

APPLICATION FOR A PUBLIC PATH DIVERSION ORDER Highways Act 1980 Section 119

Please read the Advice to Applicants carefully before filling in the application form.

- The completed form,
- a plan based on an Ordnance Survey map of a scale not less than 1:2500,
- proof of title, and
- a cheque for £70, payable to Hertfordshire County Council should be sent to the Definitive Map Officer

Application to divert public footpath*/bridleway*

Number 10

Parish BISHOP'S STORTFORD

Full name(s) of applicants PETER IAN DOUGLAS JAMES AND DEBORAH ANN JAMES

Address HADHAM HODGE,
HADHAM ROAD
BISHOP'S STORTFORD. CM23 1JH

Phone no. 01279 652484 daytime phone no. 01279 658338*

Fax no. 01279 757023 e-mail address pid.james@btinternet.com

Address for correspondence (if different from above e.g. solicitor)

(*Delete as appropriate)

1. **Ownership of land affected by the application**

1.1 Are you the freehold owner and occupier of all of the land affected by the proposed diversion?

Yes No

If yes, go to 1.4

1.2 If no,

- list below the names and addresses of all the owners, occupiers or lessees of land affected by the diversion including yourself,
- indicate accurately on the application plan the different ownerships and occupations.
- enclose a letter of consent, and supporting documentation proving title, such as Land Registry documents, from all of the owners, occupiers and lessees.

Name	Address	Status (i.e. landowner, occupier or lessee)

1.3 Will any owners, occupiers or lessees of the land affected by the proposed diversion to your knowledge claim compensation under Section 28 of the Highways Act 1980?

Yes No

1.4 Does, to your knowledge, any statutory undertaker (e.g. gas, water, electricity, telephone) have any rights on, over or under the land over which the right of way runs?

Yes No

If yes, describe the rights (e.g. wayleave)

1.5 Is to your knowledge the apparatus of any statutory undertaker affected by the proposed diversion?

Yes No

If yes, state what apparatus may be affected

2. **Reasons for application**

2.1 Please state fully your reasons for applying to divert the public right(s) of way. Remember that the County Council may not make an order unless it is satisfied that it is expedient in your interests to do so.

- 1. TO OBTAIN MORE PRIVACY FOR THE PROPERTY.
- 2. WE WOULD PLANT TREES & SHRUBS ALONG CURRENT BRISLEWAY THAT WOULD MAKE IT MORE ATTRACTIVE TO WILDLIFE AND ALSO, TO LOOK AT.

3. **Description of routes**

The routes should be shown on an accurate up-to-date plan at a scale of not less than 1:2500.

3.1 **Existing Route** (i.e. the path recorded on the Definitive Map)

from _____ OS grid ref _____

to _____ OS grid ref _____

distance _____ metres width _____

existing stiles/gates/bridges (list and show position on plan)

3.2 **Proposed Route**

from _____ OS grid ref _____

to _____ OS grid ref _____
(if known)

distance _____ metres width _____

proposed stiles/gates/bridges (list with grid refs and show position on plan). The Council will not normally agree to stiles or gates in the Order setting out the new route. If necessary they may be authorised separately under s147 of the Highways Act 1980 to prevent the ingress or egress of stock.

on THE
ATTACHED
PLAN

3.3 Is the existing (definitive) route unobstructed and fully available to the public?

Yes No

3.4 If the answer is NO, state fully the reasons why the route is obstructed and describe and show clearly on the application plan the obstruction and the route walked/ridden by the public.

4. COSTS

4.1 We agree to pay the cost of processing the application as detailed in the Advice to Applicants. We enclose a cheque for £70.

(*delete as appropriate)

Signed  Date 26.11.2004
on behalf of 

5. AGREEMENT REGARDING WORKS AND COMPENSATION COSTS

5.1 Works

*I/We understand that the applicant must pay the cost of all works which may be required by the County Council including signposting and waymarking to bring the new site of the path diversion into fit condition for use by the public. *I/We understand that *I/We will be required to enter into an agreement to carry out works specified in a schedule to be drawn up by the Countryside Access Officer. *I/We understand that if the works are not completed within the time specified, or to the required standard, the Countryside Access Officer will, after notice in writing, carry out or complete the works and that *I/We will be liable for all costs so incurred.

(*delete as appropriate)

5.2 Compensation

~~I/We~~ confirm that ~~I/We~~ are the sole owner(s) and occupier(s) of the land affected by the proposed diversion.

~~I/We~~ enclose letters of consent from all landowners, occupiers or lessees of the land affected by the diversion and agree to pay any compensation which may become payable in consequence of the order becoming operative. N/A

~~I/We~~ declare that the existing public right of way is not obstructed as described in 3.1 and is fully available to the public.

~~I/We~~ undertake not to obstruct the existing public path(s) in any way before the confirmed diversion order comes into operation.

~~I/We~~ understand that the diversion is not operational until the works, as specified, have been completed.

(*delete as appropriate)

Signed _____ 26.11.2004
on behalf of _____

LR

TITLE NUMBER
HD416618 EH 325 DIV

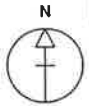

HERTFORDSHIRE : EAST HERTFORDSHIRE

ORDNANCE SURVEY MAP REFERENCE:

TL46228E

SCALE 1:2500 Reduced from 1/1250

©CROWN COPYRIGHT. Produced by HM.LR. Further reproduction in whole or in part is prohibited without the prior written permission of Ordnance Survey. Licence Number GD 272728.

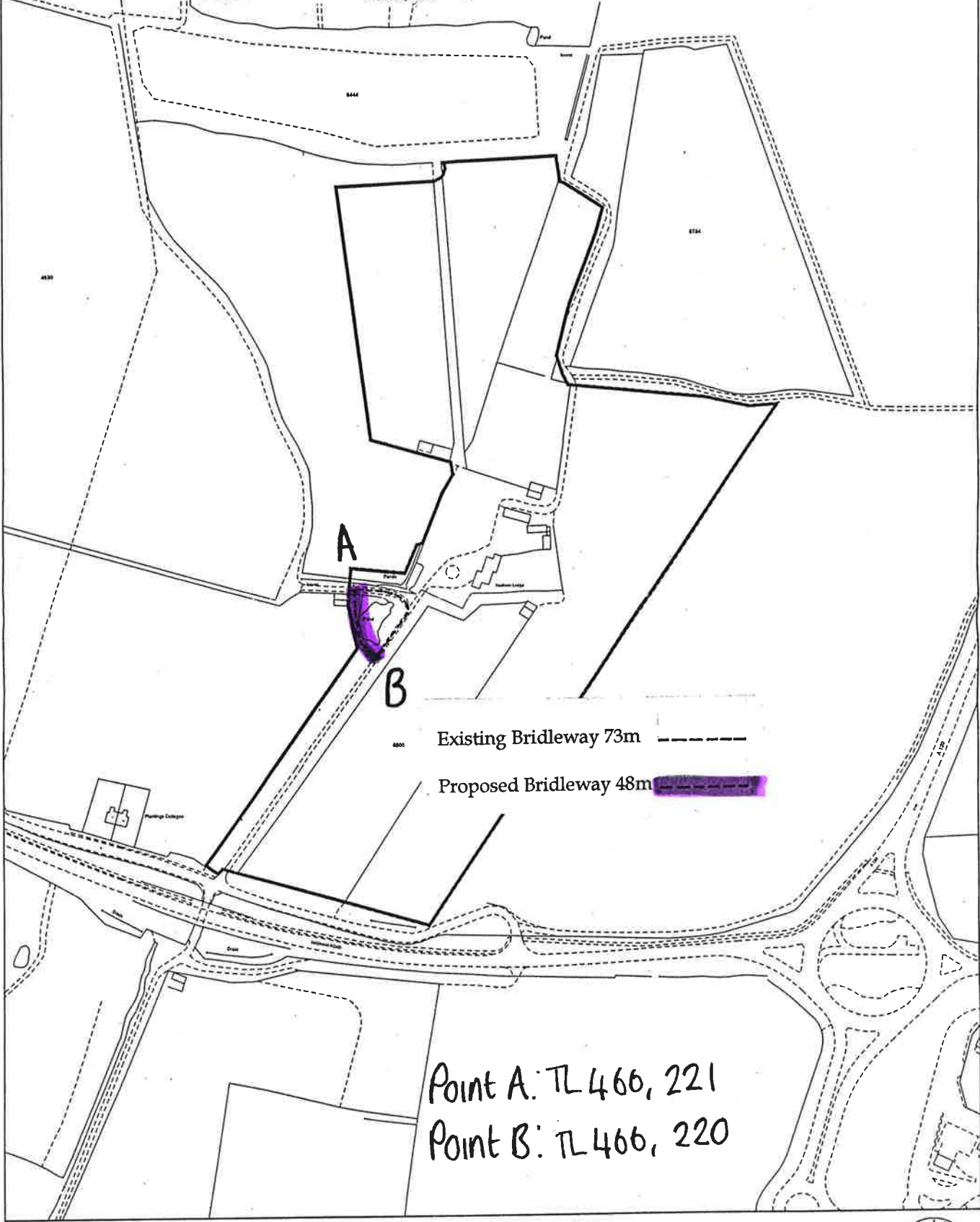

Point A: TL 466, 221

Point B: TL 466, 220

