

**PUBLIC PATH DIVERSION ORDER**  
**HIGHWAYS ACT 1980 SECTION 119**  
**HERTFORDSHIRE COUNTY COUNCIL**

**Hertfordshire County Council (Furneux Pelham 19 and 19a)**  
**Diversion Order 2014**

This order is made by Hertfordshire County Council ("the authority") under section 119 of the Highways Act 1980 ("the 1980 Act") because it appears to the authority that in the interests of the owner of the land crossed by the footpath described in paragraph 1 of this order it is expedient that the line of the path should be diverted.

Andrew David Collins and Susan Frances Collins have agreed to defray any compensation which becomes payable in consequence of the coming into force of this Order and any expenses which are incurred in bringing the new site of the path into a fit condition for use by the public.

East Herts District Council have been consulted as required by section 120(2) of the 1980 Act.

**BY THIS ORDER:**

1. The public right of way over the land situate to the south of Hixham Hall in the Parish of Furneux Pelham and shown by a bold continuous line on the plan contained in this order ("the Order Plan") and described in Part 1 of the Schedule to this order shall be stopped up on the date of confirmation of this order.
2. There shall on the date of confirmation of this order be a public footpath over the land situate to the south of Hixham Hall in the Parish of Furneux Pelham described in Part 2 of the Schedule and shown by a bold broken line on the Order Plan.

**SCHEDULE**



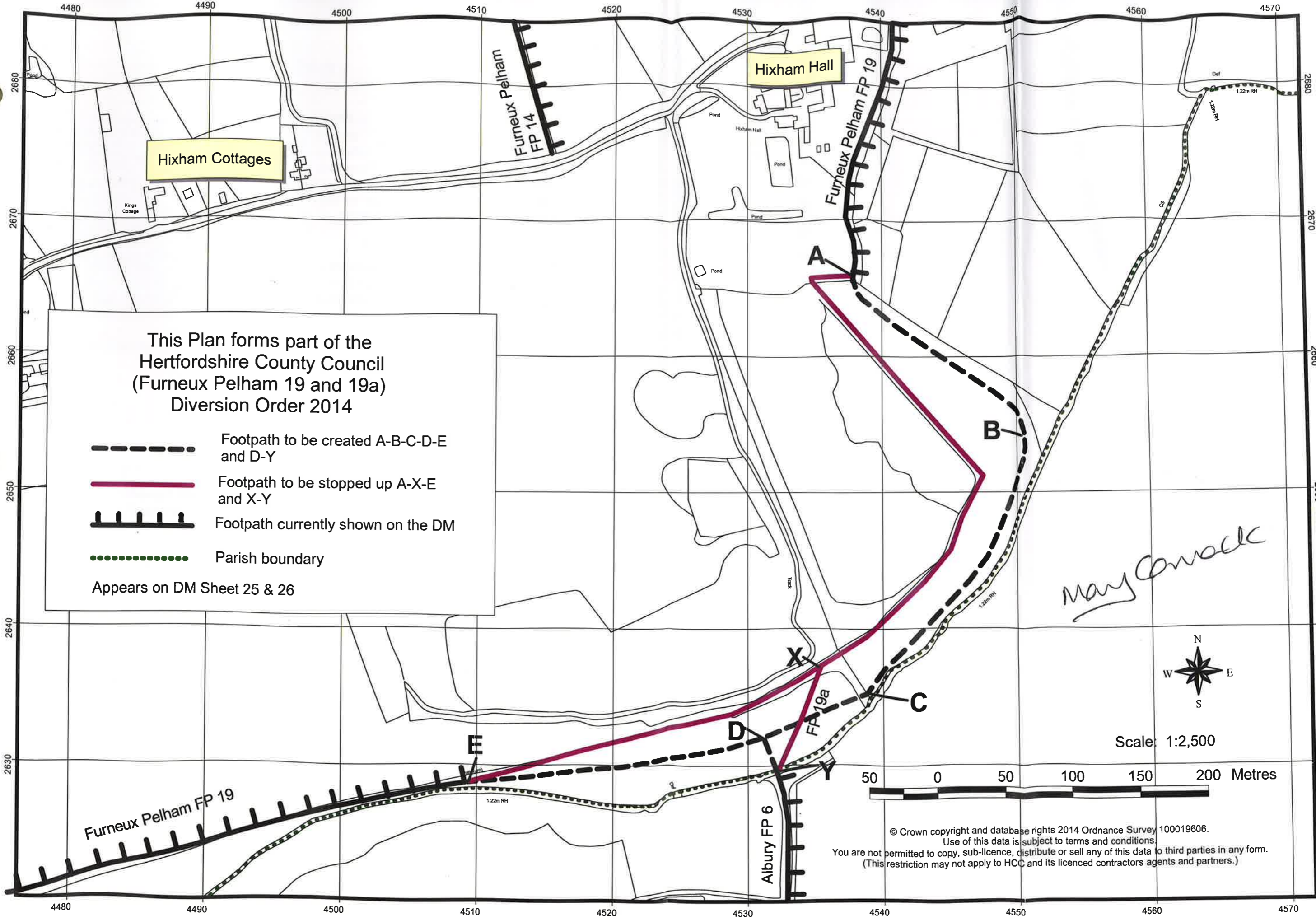

**PART 1**  
**DESCRIPTION OF SITE OF EXISTING PATH OR WAY**

The full width of that part of Furneux Pelham Footpath 19 commencing at TL 4537 2666 (Point A on the Order Plan) and running west for approximately 30 metres then turning to run south east for approximately 195 metres and turning again to run generally south west for approximately 195 metres to the junction with Furneux Pelham 19a at TL 4535 2637 (Point X on the Order Plan) and continuing west south west for approximately 270 metres to TL 4509 2628 (Point E on the Order Plan). Total distance approximately 690 metres.

The full width of Furneux Pelham Footpath 19a commencing at TL 4535 2637 (Point X on the Order Plan) and running south south west for approximately 80 metres to the parish boundary at TL 4532 2629 (Point Y on the Order Plan) where it joins Albury Footpath 6.



This Plan forms part of the  
 Hertfordshire County Council  
 (Furneux Pelham 19 and 19a)  
 Diversion Order 2014

-  Footpath to be created A-B-C-D-E and D-Y
-  Footpath to be stopped up A-X-E and X-Y
-  Footpath currently shown on the DM
-  Parish boundary

Appears on DM Sheet 25 & 26

*May Conwell*

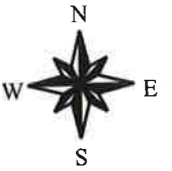

Scale: 1:2,500



© Crown copyright and database rights 2014 Ordnance Survey 100019606.  
 Use of this data is subject to terms and conditions.  
 You are not permitted to copy, sub-licence, distribute or sell any of this data to third parties in any form.  
 (This restriction may not apply to HCC and its licenced contractors agents and partners.)



PART 2  
DESCRIPTION OF SITE OF NEW PATH OR WAY

A public footpath commencing from TL 4537 2666 (Point A on the Order Plan) and running south east for approximately 180 metres to TL 4550 2654 (Point B on the Order Plan) then turning to run south west for approximately 230 metres to TL 4539 2635 (Point C on the Order Plan) and continuing west south west for approximately 85 metres to a junction with the diverted Furneux Pelham Footpath 19a at TL 4531 2632 (Point D on the Order Plan) then continuing west south west for approximately 225 metres to re-join the existing Furneux Pelham Footpath 19 at TL 4509 2628 (Point E on the Order Plan). Total distance approximately 720 metres.

A public footpath commencing from the parish boundary and junction with Albury Footpath 6 at TL 4532 2629 (Point Y on the Order Plan) and running north north west for approximately 30 metres to join the diverted footpath Furneux Pelham 19 described above at TL 4531 2632 (Point D on the Order Plan).

Width: 3 metres for both footpaths.

PART 3  
LIMITATIONS AND CONDITIONS

None

IN WITNESS whereof the COMMON SEAL of HERTFORDSHIRE COUNTY COUNCIL was hereunto affixed this 4<sup>th</sup> day of July 2014

The Common Seal of  
HERTFORDSHIRE  
COUNTY COUNCIL  
was hereunto affixed  
in the presence of:-

Mary Cormack



~~Chief Legal Officer~~

Mary Cormack  
Asst Chief Legal Officer

The foregoing Order is  
hereby confirmed

Chief Legal Officer  
Dated K P Pettit 5/12/14