

REGISTER OF APPLICATIONS - PUBLIC PATH ORDERS

DETAILS OF APPLICATION

District Welwyn + Hatfield File Name Hatfield 57
 Parish Hatfield Application Date 20/3/06

Grid References

Application to Point A TL 219, 124 C: TL 220, 123
Divert Public Footpath Point B TL 219, 123
 Applicant Ramblers Holidays Ltd.

	City	Town	Village
Nearest	<u>St Albans</u>	<u>Welwyn Garden City</u>	<u>LEMSFORD</u>

Addresses of properties affected	House Name/Street	Postcode
	<u>38 Lemsford Village</u>	<u>AL8 7JR</u>

DETERMINATION (DECISION) OF APPLICATION

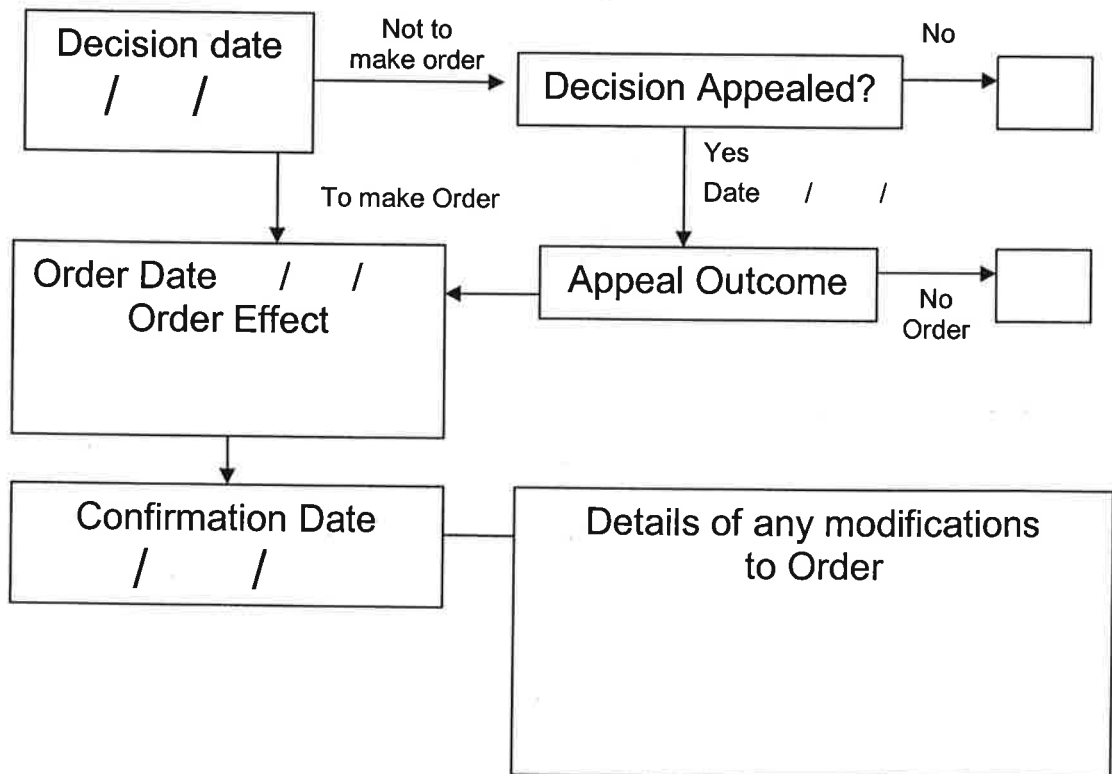

APPLICATION FOR A PUBLIC PATH DIVERSION ORDER

Highways Act 1980 Section 119

Please read the Advice to Applicants carefully before filling in the application form.

- The completed form,
- a plan based on an Ordnance Survey map of a scale not less than 1:2500,
- proof of title, and
- a cheque for £70, payable to Hertfordshire County Council should be sent to the Definitive Map Officer

Application to divert public footpath*/bridleway*

Number HATFIELD 57

Parish HATFIELD

Full name(s) of applicant RAMBLERS HOLIDAYS LIMITED

Address P.O. Box 43

WELWYN GARDEN CITY

AL8 6PA

Phone no. 01707 331133 daytime phone no. _____

Fax no. 01707 333276 e-mail address _____

Address for correspondence (if different from above e.g. solicitor)

LODDERS SOLICITORS, NUMBER TEN, ELM COURT,

ARDEN STREET, STRATFORD UPON AVON CV37 8GA

PHONE: 01789 206106 FAX: 01789 206902

REF: MFO

(*Delete as appropriate)

1. **Ownership of land affected by the application**

1.1 Are you the freehold owner and occupier of all of the land affected by the proposed diversion?

Yes No

If yes, go to 1.4

1.2 If no,

- list below the names and addresses of all the owners, occupiers or lessees of land affected by the diversion including yourself,
- indicate accurately on the application plan the different ownerships and occupations.
- enclose a letter of consent, and supporting documentation proving title, such as Land Registry documents, from all of the owners, occupiers and lessees.

Name	Address	Status (i.e. landowner, occupier or lessee)
------	---------	--

_____	_____	_____
_____	_____	_____
_____	_____	_____
_____	_____	_____
_____	_____	_____

1.3 Will any owners, occupiers or lessees of the land affected by the proposed diversion to your knowledge claim compensation under Section 28 of the Highways Act 1980?

Yes No

1.4 Does, to your knowledge, any statutory undertaker (e.g. gas, water, electricity, telephone) have any rights on, over or under the land over which the right of way runs?

Yes No

WE ARE NOT AWARE OF FORMAL AGREEMENTS BUT

If yes, describe the rights (e.g. wayleave)

- (1) OVERHEAD TELEPHONE WIRES CROSS THE PATH - AS CAN BE SEEN
(2) ELECTRICITY CABLES TO THE TRANSFORMER IN BROCKETT PARK PASS UNDERGROUND THROUGH THE "LOCKED GATES" AND ACROSS THE OLD BRICK BRIDGE

1.5 Is to your knowledge the apparatus of any statutory undertaker affected by the proposed diversion?

Yes No

If yes, state what apparatus may be affected _____

2. **Reasons for application**

2.1 Please state fully your reasons for applying to divert the public right(s) of way. Remember that the County Council may not make an order unless it is satisfied that it is expedient in your interests to do so.

- (1) INCREASED SECURITY FOR MILL AND MILL HOUSE AND COTTAGE
- (2) INCREASED PRIVACY FOR THE SAME THREE BUILDINGS ABOVE
- (3) IMPROVED SAFETY FOR THE PUBLIC BY REASON OF:
 - (i) HANDRAILS ON FOOTBRIDGE
 - (ii) BETTER SURFACE FOR PEDESTRIANS ON FOOTBRIDGE
 - (iii) SEGREGATION OF PEDESTRIAN AND VEHICULAR TRAFFIC
- (4) BETTER VIEW OF THE MILL FOR PEDESTRIANS - HIGHER AMENITY VALUE

3. **Description of routes**

The routes should be shown on an accurate up-to-date plan at a scale of not less than 1:2500.

3.1 **Existing Route** (i.e. the path recorded on the Definitive Map)

SHOWN RED ON ATTACHED PLAN

from 21959 12412 OS grid ref _____

to 21968 12371 OS grid ref _____

distance 55m. approx. metres width VARYING

existing stiles/gates/bridges (list and show position on plan)

3.2 **Proposed Route**

SHOWN IN BLUE ON ATTACHED PLAN

from 21959 12412 OS grid ref _____

to 21985 12392 OS grid ref _____
(if known)

distance 33m. approx. metres width VARYING

proposed stiles/gates/bridges (list with grid refs and show position on plan). The Council will not normally agree to stiles or gates in the Order setting out the new route. If necessary they may be authorised separately under s147 of the Highways Act 1980 to prevent the ingress or egress of stock.

1:20000m

W+H 72 DIV

0.25m

21

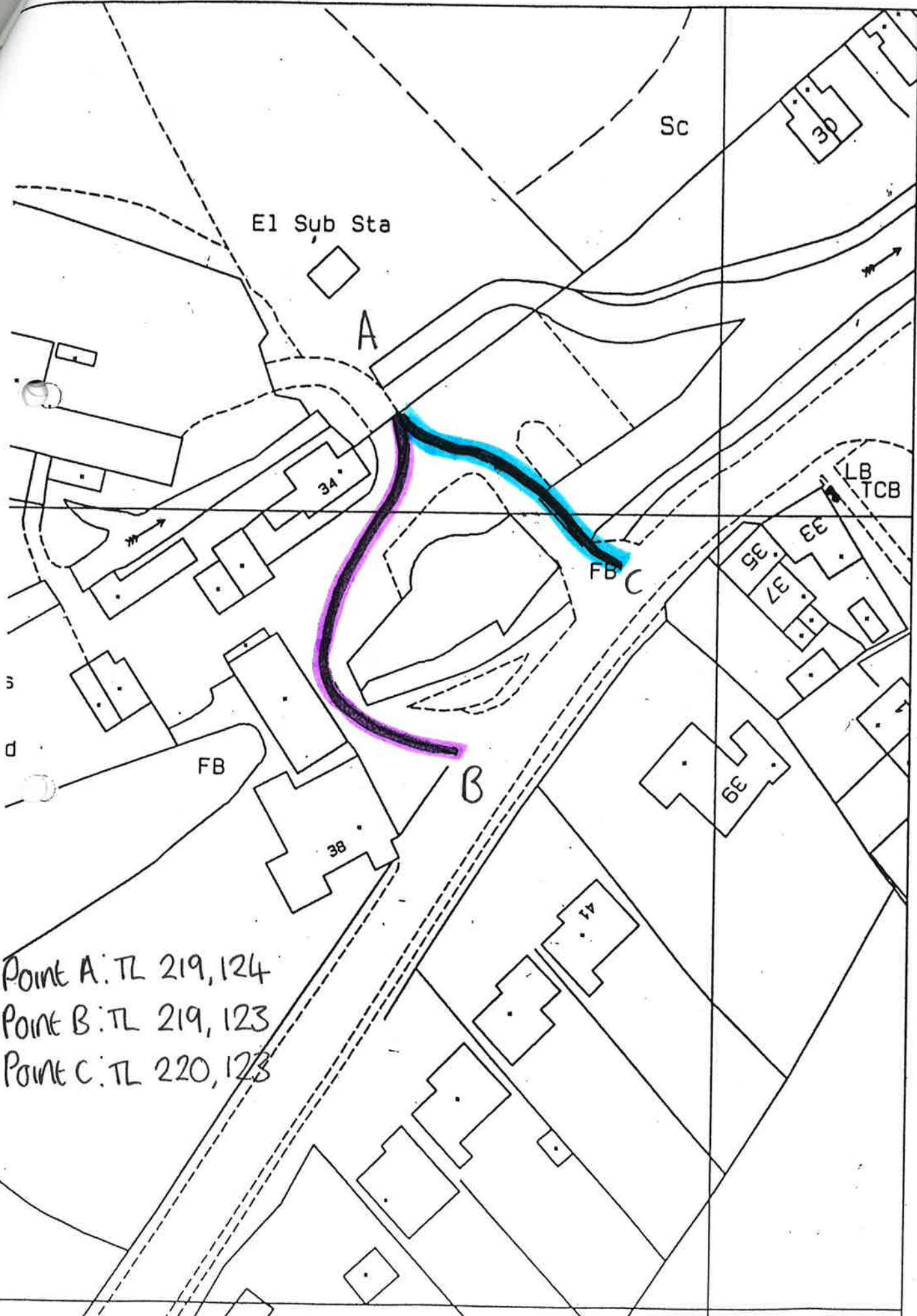

124

Point A: TL 219, 124
 Point B: TL 219, 123
 Point C: TL 220, 123

123

3.3 Is the existing (definitive) route unobstructed and fully available to the public?

Yes No

3.4 If the answer is NO, state fully the reasons why the route is obstructed and describe and show clearly on the application plan the obstruction and the route walked/ridden by the public.

4. COSTS

4.1 We agree to pay the cost of processing the application as detailed in the Advice to Applicants. We enclose a cheque for £70.

(*delete a

Signed _____

20/3/06

on behalf of RAMBLERS HOLIDAYS LIMITED

5. AGREEMENT REGARDING WORKS AND COMPENSATION COSTS

5.1 Works

~~/~~We understand that the applicant must pay the cost of all works which may be required by the County Council including signposting and waymarking to bring the new site of the path diversion into fit condition for use by the public.
~~/~~We understand that ~~/~~We will be required to enter into an agreement to carry out works specified in a schedule to be drawn up by the Countryside Access Officer. ~~/~~We understand that if the works are not completed within the time specified, or to the required standard, the Countryside Access Officer will, after notice in writing, carry out or complete the works and that ~~/~~We will be liable for all costs so incurred.

(*delete as appropriate)

5.2 Compensation

~~/~~We confirm that ~~/~~We are the sole owner(s) and occupier(s) of the land affected by the proposed diversion.

RAMBLERS HOLIDAYS LIMITED ARE THE ONLY PARTY AFFECTED BY THE DIVERSION.

~~/~~We enclose letters of consent from all landowners, occupiers or lessees of the land affected by the diversion and agree to pay any compensation which may become payable in consequence of the order becoming operative.

~~/~~We declare that the existing public right of way is not obstructed as described in 3.1 and is fully available to the public.

~~/~~We undertake not to obstruct the existing public path(s) in any way before the confirmed diversion order comes into operation.

~~/~~We understand that the diversion is not operational until the works, as specified, have been completed.

(*delete :

Signed _

20/3/06

on behal

RAMBLERS HOLIDAYS LIMITED