

NOTICE OF CONFIRMATION OF A DIVERSION ORDER

HIGHWAYS ACT 1980, SECTION 119

HERTFORDSHIRE COUNTY COUNCIL

**HERTFORDSHIRE COUNTY COUNCIL (HINXWORTH 1)
DIVERSION ORDER 2013**

On 1st August 2014, Hertfordshire County Council confirmed the above Order made under section 119 of the Highways Act 1980.

The effect of the Order as confirmed is to divert the public footpath running from TL 2347 4050 north north east for 50 metres to TL 2348 4055 onto a new line from TL 2347 4050 north west for 12 metres to TL 2346 4050 and continuing north east for 50 metres to TL 2348 4055 as shown on the Order Plan.

A copy of the order and the order plan may be seen free of charge at front reception of Hertfordshire County Council, County Hall, Hertford, from 9.00 am to 4.00 pm on Monday to Friday and at North Hertfordshire District Council, Gernon Road, Letchworth Garden City, SG6 3JF. Copies of the order and plan may be bought from Hertfordshire County Council at the price of £2.

The Order comes into force as from 14th August 2014, but if any person aggrieved by the Order wants to question its validity, or that of any provision contained in it, on the grounds that it is not within the powers of the Highways Act 1980, as amended, or on the grounds that any requirement of the Act, as amended, or of any regulation made under the Act has not been complied with in relation to the Order, he or she may, under paragraph 2 of Schedule 2 to the Act as applied by paragraph 5 of Schedule 6 to the Act, within 6 weeks from 14th August 2014, make an application to the High Court.

Dated: 14th August 2014

PUBLIC PATH DIVERSION ORDER
HIGHWAYS ACT 1980
HERTFORDSHIRE COUNTY COUNCIL

Hertfordshire County Council (Hinworth 1) Diversion Order 2013

This Order is made by the Hertfordshire County Council ("the Authority") under section 119 of the Highways Act 1980 ("the 1980 Act") because it appears to the Authority that in the interests of the owner of the land crossed by the footpath described in paragraph 1 of the order it is expedient that the line of the path should be diverted.

Joanne Cole has agreed to defray any compensation which becomes payable in consequence of the coming into force of this order and any expenses which are incurred in bringing the new site of the path into a fit condition for use by the public.

North Hertfordshire District Council has been consulted in the making of the order as required by section 120(2) of the 1980 Act.

BY THIS ORDER

1. The public right of way over the land situate at Hinworth shown by a bold continuous line on the plan forming part of the Order ("the Order Plan") and described in Part 1 of the Schedule to this Order ("the Schedule") shall be stopped up on the date of the confirmation of this Order.
2. There shall on the date of confirmation of this Order be a public footpath over the land situate at Hinworth as described in Part 2 of the Schedule and shown by a bold broken line on the Order Plan attached to this Order.

This Plan forms part of the Hertfordshire County Council (Hinworth 1) Diversion Order 2013.



Scale 1:1,250

Appears on DM Sheet No. 01

Public Footpath



Public Footpath to be extinguished



Public Footpath to be created



20 0 20 40 Metres



4065

4060

4055

4050

4045

4040

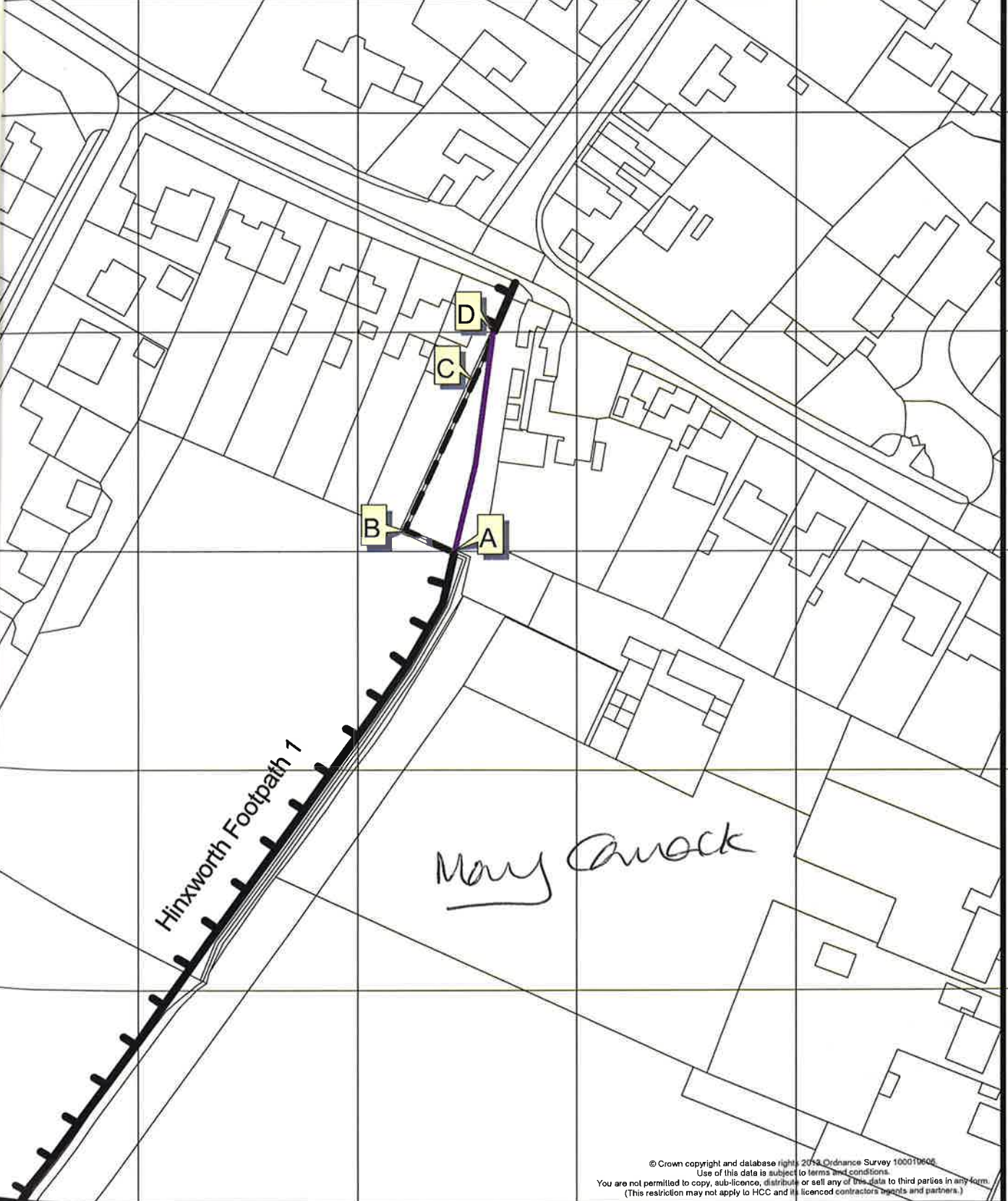

Hinworth Footpath 1

Mary Ancock

SCHEDULE

**PART 1
DESCRIPTION OF SITE OF EXISTING PATH OR WAY**

The full width of part of Hinxworth FP 1 commencing at TL 2347 4050 (Point A on the Order Plan) and continuing in a generally north north easterly direction for approximately 50 metres to TL 2348 4055 (Point D on the Order Plan).

**PART 2
DESCRIPTION OF SITE OF NEW PATH OR WAY**

A public footpath commencing from TL 2347 4050 (Point A on the Order Plan) and continuing in a generally north westerly direction for approximately 12 metres to TL 2346 4050 (point B on the Order Plan) and continuing in a generally north easterly direction for approximately 50 metres to re-join the un-diverted section of Hinxworth FP 1 at TL 2348 4055 (Point D on the Order Plan).

Width: 2.5 metres from TL 2347 4050 (Point A on the Order Plan) to TL 2347 4053 (Point C on the Order Plan)
2.0 metres from TL 2347 4053 (Point C on the Order Plan) to TL 2348 4055 (Point D on the Order Plan)

**PART 3
LIMITATIONS AND CONDITIONS**

None between TL 2347 4050 (Point A on the Order Plan) and TL 2348 4055 (Point D on the Order Plan)

IN WITNESS whereof the COMMON SEAL of HERTFORDSHIRE COUNTY COUNCIL was hereunto affixed this 26th day of July 2013

The Common Seal of HERTFORDSHIRE COUNTY COUNCIL was hereunto affixed in the presence of:-

Mary Cormack

~~Chief Legal Officer~~

Mary Cormack
Asst Chief Legal Officer



The foregoing Order is hereby confirmed

~~Chief Legal Officer~~ *Mary Cormack*

Dated *1 August 2013*
Mary Cormack
Asst Chief Legal Officer

.....