

WILDLIFE AND COUNTRYSIDE ACT 1981

The Definitive Map and Statement of Public Rights of Way in Hertfordshire

Hertfordshire County Council (Nettleden with Potten End Footpath 32) Modification Order 2015

This Order is made by Hertfordshire County Council under Section 53(2)(b) of the Wildlife and Countryside Act 1981 ("the Act") because it appears to that authority that the Definitive Map and Statement of Public Rights of Way in Hertfordshire require modification in consequence of the occurrence of an event specified in Section 53(3)(b) of the Act, namely the expiration, in relation to any way in the area to which the Map relates, of any period such that the enjoyment by the public of the way during that period raises the presumption that the way has been dedicated as a public path or restricted byway.

The authority has consulted with every local authority whose area includes the land to which the Order relates. Hertfordshire County Council hereby order that:

1. For the purposes of this Order the relevant date is 21st January 2015.
2. The Definitive Map and Statement of Public Rights of Way in Hertfordshire shall be modified as described in Part I and Part II of the Schedule and shown on the plan attached to the Order ("the Order Plan").
3. This Order shall take effect on the date it is confirmed and may be cited as the Hertfordshire County Council (Nettleden with Potten End Footpath 32) Modification Order 2015.

SCHEDULE PART I

Modification of Definitive Map

Description of path or way to be added

A public footpath commencing at the north eastern end of Browns Spring (public highway) at TL 0217 0933 (point A on the Order Plan), continuing generally north east between the properties Everglade and Hallgarth for approximately 55 metres to TL 0220 0938 (point B on the Order Plan) and then continuing generally north east through Brown's Spring woodland for approximately 130 metres to join Nettleden with Potten End Footpath 31 at TL 0226 0948 (point C on the Order Plan).

Width: Varies between 4 and 4.8 metres between TL 0217 0933 and TL 0220 0938 (points A – B) as shown shaded grey on the Order Plan
2.5 metres between TL 0220 0938 and TL 0226 0948 (points B - C) on the Order Plan.

Limitations: None





02100

02200

02300

02400

This Plan Forms Part of the
 Hertfordshire County Council
 (Nettleden with Potten End Footpath 32)
 Modification Order 2015

- Footpath to be added **A**  **B**  **C** 
- Existing footpaths 
- Existing bridleway 
- Appears on DM sheet 65

09800

09700

09600

09500

09400

09300

09200

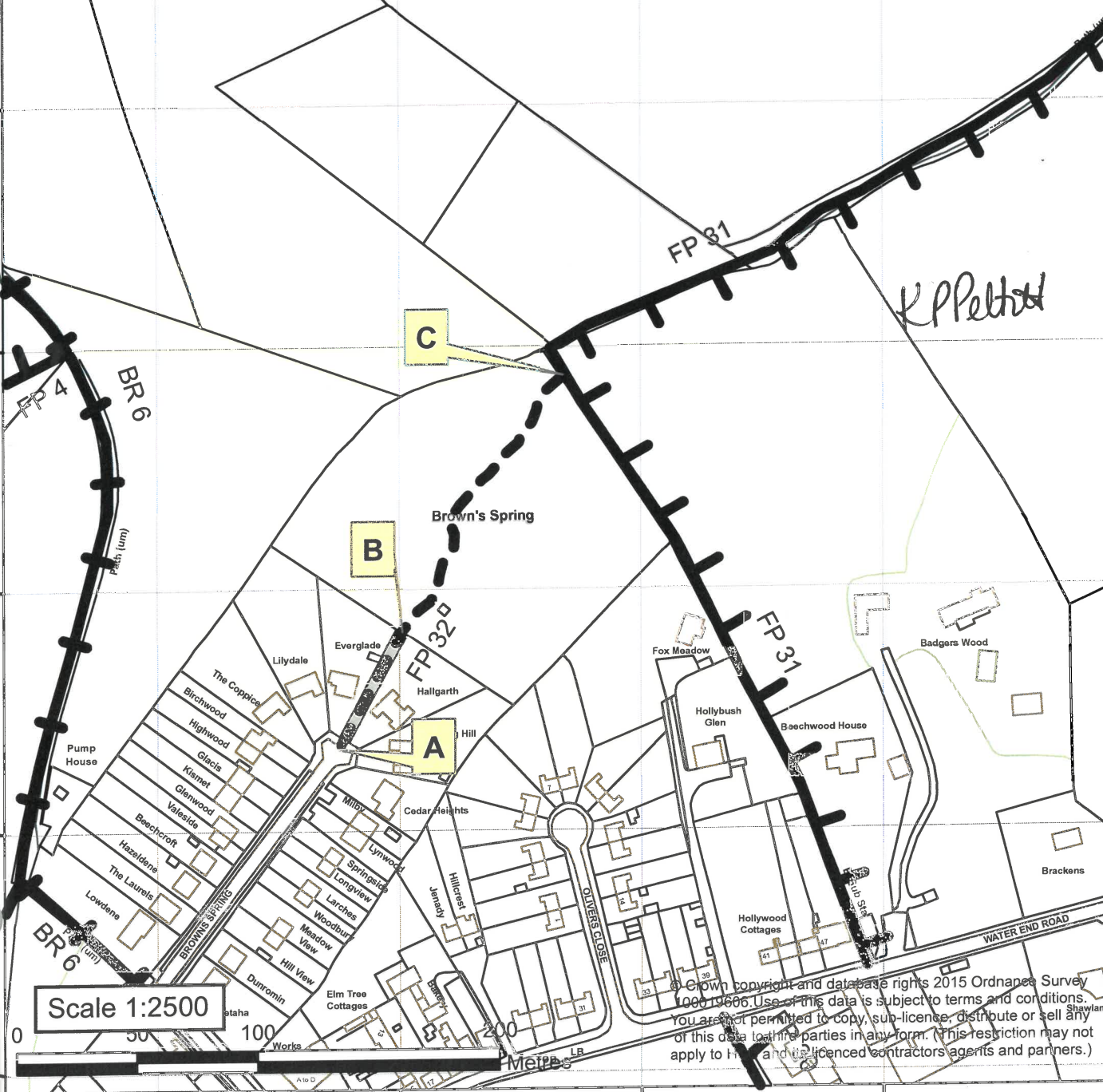
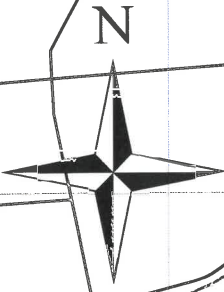

K.P. Pellett

© Crown copyright and database rights 2015 Ordnance Survey 100019606. Use of this data is subject to terms and conditions. You are not permitted to copy, sub-license, distribute or sell any of this data to third parties in any form. (This restriction may not apply to Her Majesty's and its licensed contractors agents and partners.)

Scale 1:2500

02100

02200

02300

02400

PART II
Modification of Definitive Statement

Variation of particulars of path or way

A new Statement shall be recorded for Nettleden with Potten End 32 as follows:

Path No	Status	HCC Map Ref
---------	--------	-------------

032	FP	HCC 065
-----	----	---------

Commences from the north eastern end of Browns Spring (public highway) at TL 0217 0933, continuing generally north east between the properties Everglade and Hallgarth for approximately 55 metres to TL 0220 0938 and then continuing generally north east through Brown's Spring woodland for approximately 130 metres to join Nettleden with Potten End Footpath 31 at TL 0226 0948.

Width Varies between 4 and 4.8 metres between TL 0217 0933 and TL 0220 0938 as shown shaded grey on the Hertfordshire County Council (Nettleden with Potten End Footpath 32) Modification Order 2015 Order Plan
2.5 metres between TL 0220 0938 and TL 0226 0948

Limitations None

IN WITNESS whereof the COMMON SEAL of HERTFORDSHIRE COUNTY COUNCIL was hereunto affixed this 13th day of February 2015

The Common Seal of
HERTFORDSHIRE
COUNTY COUNCIL
was hereunto affixed
in the presence of:-

KP Pettitt
Kathryn Pettitt

Chief Legal Officer



The foregoing Order is
hereby confirmed

Chief Legal Officer

Dated *KP Pettitt* 8th April 2016