

NOTICE OF CONFIRMATION OF A CREATION ORDER

HIGHWAYS ACT 1980, SECTION 26

HERTFORDSHIRE COUNTY COUNCIL

**HERTFORDSHIRE COUNTY COUNCIL
(SHENLEY 10)
CREATION ORDER 2016**

On 9th December 2016, Hertfordshire County Council confirmed the above Order made under section 26 of the Highways Act 1980. The effect of the Order as confirmed is to create the public bridleway running from Woodhall Lane at TQ 1902 9997 (point D on the Order plan) then continuing along the line of Shenley FP 10 generally north west for approx 130m to a junction with Shenley FP 11, continuing north west for approx 265m to join Shenley BR 10 at TL 1869 0019 (point C on the Order plan) as shown on the Order Plan.

A copy of the Order and the Order Plan may be seen free of charge at front reception of Hertfordshire County Council, County Hall, Pegs Lane, Hertford, from 9.00 am to 4.00 pm on Monday to Friday and at Hertsmere Borough Council, Civic Offices, Elstree Way, Borehamwood. Copies of the order and plan may be bought from Hertfordshire County Council at the price of £2.

The Order comes into force as from 6th January 2017, but if any person aggrieved by the Order wants to question its validity, or that of any provision contained in it, on the grounds that it is not within the powers of the Highways Act 1980, as amended, or on the grounds that any requirement of the Act, as amended, or of any regulation made under the Act has not been complied with in relation to the Order, he or she may, under paragraph 2 of Schedule 2 to the Act as applied by paragraph 5 of Schedule 6 to the Act, within 6 weeks from 6th January 2017, make an application to the High Court.

Dated: 6th January 2017

**PUBLIC PATH CREATION ORDER
HIGHWAYS ACT 1980**

HERTFORDSHIRE COUNTY COUNCIL

**Hertfordshire County Council
(Shenley 10)
Creation Order 2016**

This Order is made by Hertfordshire County Council ("the authority") under section 26 of the Highways Act 1980 ("the 1980 Act") because it appears to the authority that, having regard to the matters set out in section 26(1), there is a need for a public bridleway over the land to which this Order relates, and that it is expedient that the way should be created.

Hertsmere Borough Council has been consulted as required by section 26(3) of the 1980 Act.

BY THIS ORDER

1. There shall be on the date of confirmation of this Order a public bridleway over the land at Shenley described in Part 1 of the Schedule to this Order and shown by a bold broken line on the plan attached to this Order ("the Order Plan").
2. The rights conferred on the public under this Order shall be subject to the limitations and conditions set out in Part 2 of the Schedule.

SCHEDULE

**PART 1
DESCRIPTION OF LAND**

A public bridleway commencing from Woodhall Lane (public road) at TQ 1902 9997 (point D on the Order Plan) then continuing along the line of Shenley Footpath 10 generally north west for approximately 130 metres to a junction with Shenley Footpath 11 then continuing north west for approximately 265 metres to join Shenley Bridleway 10 at TL 1869 0019 (point C on the Order Plan).

The bridleway shall be 4 metres wide between TQ 1902 9997 (point D on the Order Plan) and TL 1869 0019 (point C on the Order Plan).

156/5/64

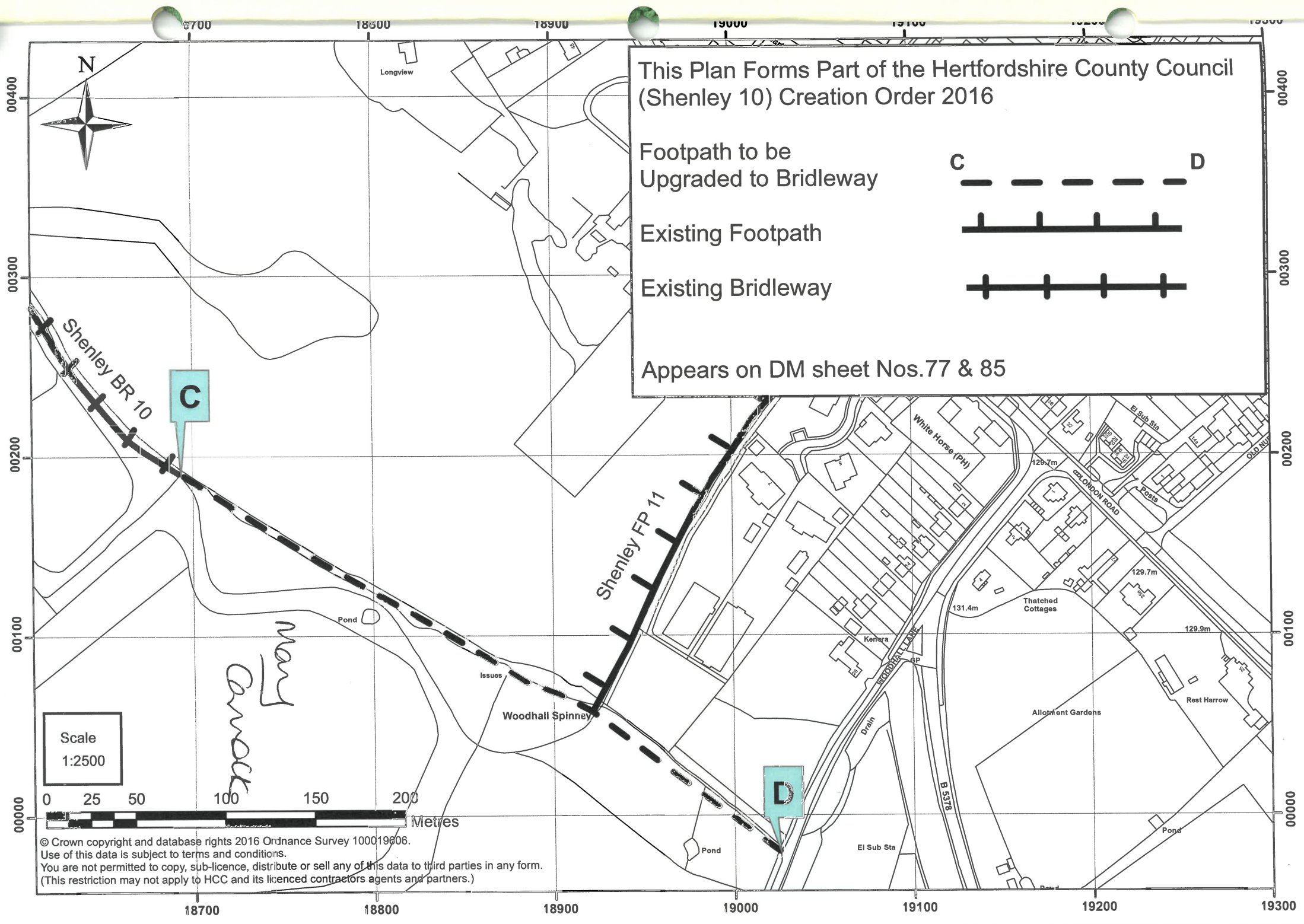

This Plan Forms Part of the Hertfordshire County Council
(Shenley 10) Creation Order 2016

Footpath to be
Upgraded to Bridleway



Existing Footpath



Existing Bridleway



Appears on DM sheet Nos.77 & 85

C

D

Scale
1:2500

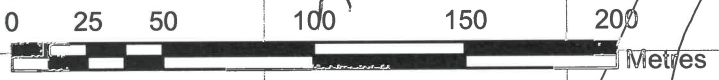

*many
canals*

© Crown copyright and database rights 2016 Ordnance Survey 100019606.
Use of this data is subject to terms and conditions.
You are not permitted to copy, sub-licence, distribute or sell any of this data to third parties in any form.
(This restriction may not apply to HCC and its licenced contractors agents and partners.)

PART 2
LIMITATIONS AND CONDITIONS

None

IN WITNESS whereof the COMMON SEAL of HERTFORDSHIRE COUNTY COUNCIL
was hereunto affixed this 13th day of October 2016

The Common Seal of
HERTFORDSHIRE
COUNTY COUNCIL
was hereunto affixed
in the presence of:-

~~Chief Legal Officer~~

1454/16
*Mary
Cormack*



Mary Cormack
Asst Chief Legal Officer

The foregoing Order is
hereby confirmed

Mary Cormack
Mary Cormack
Asst Chief Legal Officer

~~Chief Legal Officer~~

Dated

..... 9 December 2016