

**PUBLIC PATH EXTINGUISHMENT ORDER**

**HIGHWAYS ACT 1980**

**HERTFORDSHIRE COUNTY COUNCIL**

**Hertfordshire County Council  
(Tring Rural Footpath 11, 12 & 13)  
Extinguishment Order 2017**

This Order is made by Hertfordshire County Council ('the authority') under section 118 of the Highways Act 1980 ("the 1980 Act") because it appears to the authority that the footpaths described in paragraph 1 below are not needed for public use.

Dacorum Borough Council has been consulted as required by section 120(2) of the 1980 Act.

**BY THIS ORDER:**

1. The public rights of way over the land situate at Long Marston and shown by a continuous bold line on the plan contained in this Order ("the Order Plan") and described in the Schedule to this Order shall be extinguished 90 days from the date of confirmation of this Order.

**SCHEDULE**

The full width of that part of Tring Rural Footpath 11 commencing from SP 8935 1791 (Point D on the Order Plan) and running in a generally north north-easterly direction for approximately 95 metres to its junction with Tring Rural Footpaths 12 and 13 at SP 8939 1799 (Point B on the Order Plan).

The full width of Tring Rural Footpath 12 commencing from its junction with Tring Rural Footpaths 11 and 13 at SP 8939 1799 (Point B on the Order Plan) and running in a generally east north easterly direction for approximately 710 metres to the county boundary at SP 8999 1835 (Point E on the Order Plan).

The full width of Tring Rural Footpath 13 commencing from the disused railway at SP 9049 1756 (Point A on the Order Plan) and running in a generally west north westerly direction for a distance of approximately 1180 metres to its junction with



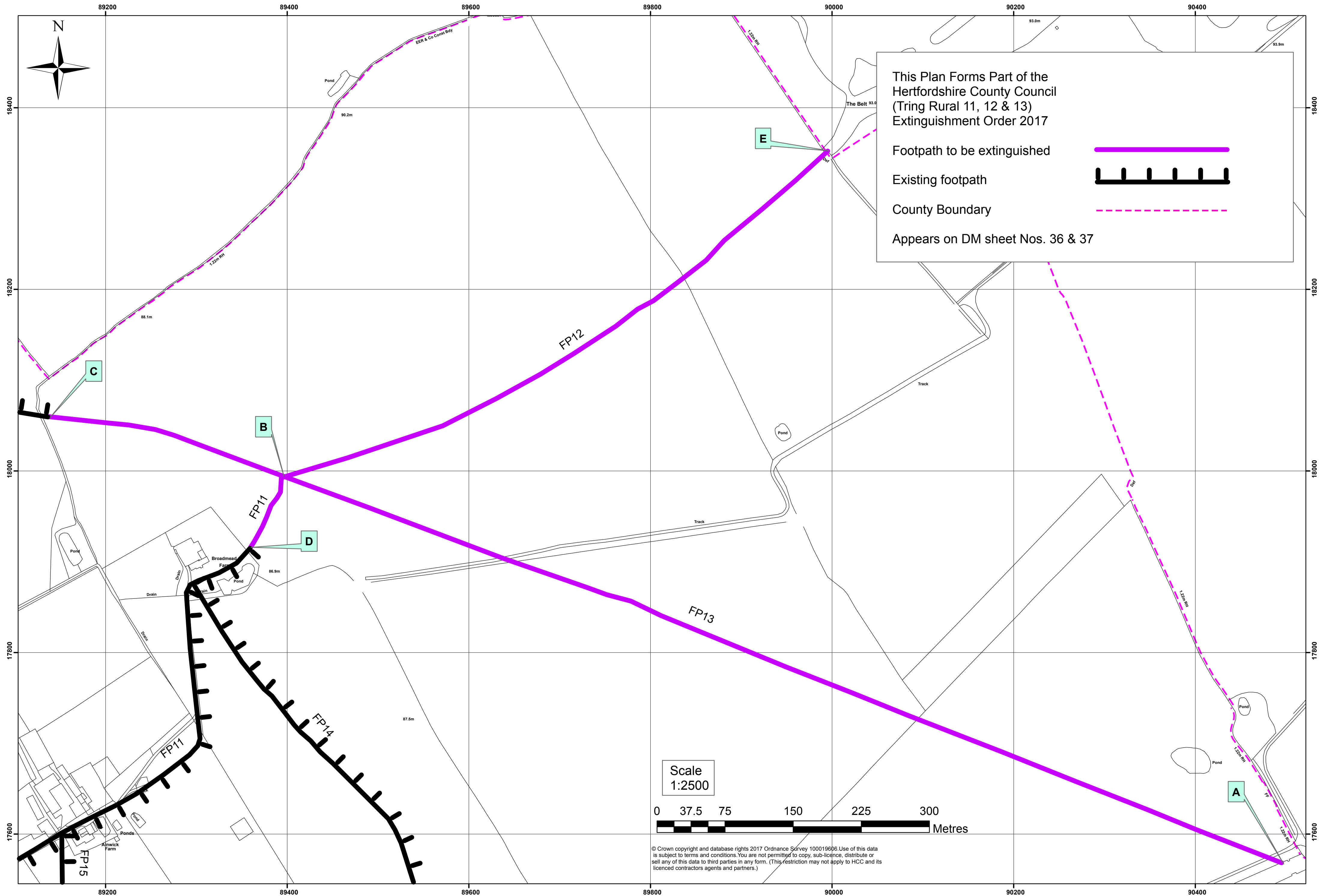

This Plan Forms Part of the Hertfordshire County Council (Tring Rural 11, 12 & 13) Extinguishment Order 2017

Footpath to be extinguished 

Existing footpath 

County Boundary 

Appears on DM sheet Nos. 36 & 37

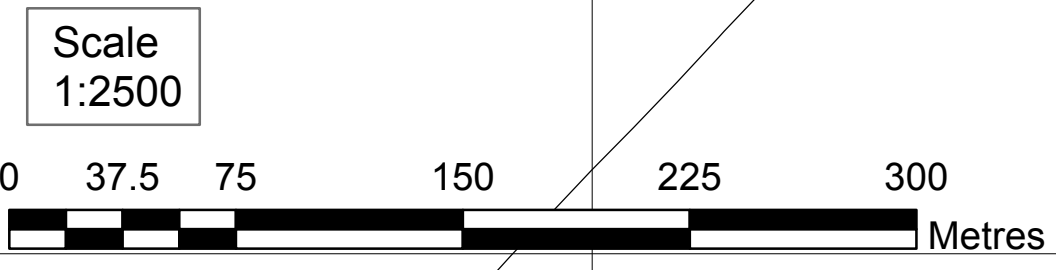

© Crown copyright and database rights 2017 Ordnance Survey 100019606. Use of this data is subject to terms and conditions. You are not permitted to copy, sub-licence, distribute or sell any of this data to third parties in any form. (This restriction may not apply to HCC and its licenced contractors agents and partners.)