

REGISTER OF APPLICATIONS - MODIFICATION ORDERS

DETAILS OF APPLICATION

District Three Rivers File Name Loudwater Lane
 Parish Rickmansworth Application Date 20/11/05

Grid References

Application to Point A TQ 063, 961
Add Footpath Point B TQ 062, 958

Applicant Colin Knight

Nearest City Town Village
St Albans Watford Croxley Green

Addresses of properties affected House Name/Street Postcode
Hendre, Loudwater Lane WD3 4AN

DETERMINATION (DECISION) OF APPLICATION

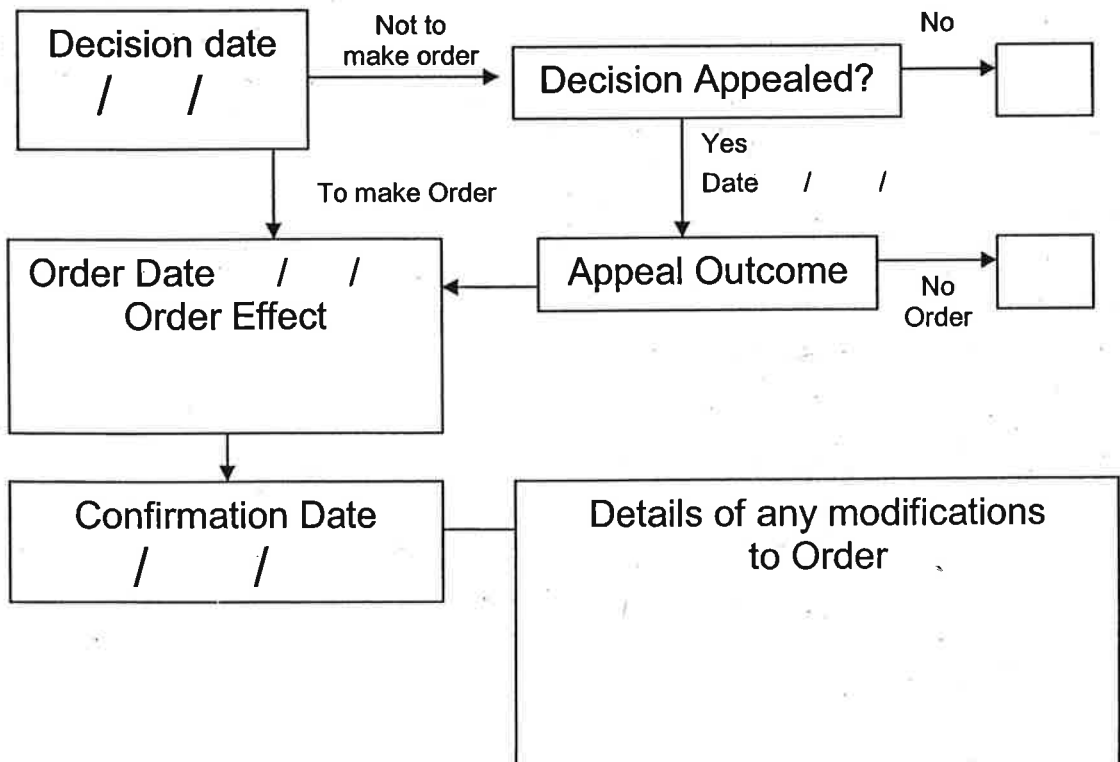

APPLICATION FOR A MODIFICATION ORDER

Wildlife and Countryside Act 1981
The Definitive Map and Statement of Public Rights of Way in Hertfordshire

To : *Definitive Map Officers, Hertfordshire County Council*
of : *Environment Department, County Hall, Pegs Lane,*
HERTFORD, SG13 8DN

I/we : COLIN KNIGHT name and
address of
applicant(s)
of : 96A MILDRED AVENUE, WATFORD, WD18 7DX

hereby apply for an order under section 53(2) of the Wildlife and Countryside Act 1981
modifying the Definitive Map and Statement for the area by

(N.B. Choose ONE of the four options given below)

- | | | | |
|---|---|---|---|
| 1. deleting the | *footpath
*bridleway
*RUPP/restricted byway
*byway open to all traffic | from # _____ to # _____ | * delete as
appropriate |
| <hr/> | | | |
| 2. adding the | *footpath
*bridleway
*byway open to all traffic | from # <u>0630 9616</u> to # <u>0622 9585</u> | * fill in grid
references
for start
and end of
routes |
| <hr/> | | | |
| 3. upgrading/downgrading
the route currently shown
as a | *footpath
*bridleway
*RUPP/restricted byway
*byway open to all traffic | from # _____ to # _____ | |
| so that it is shown as a | *footpath
*bridleway
*byway open to all traffic | | |
| <hr/> | | | |
| 3. varying /adding to the
particulars relating to
the | *footpath
*bridleway
*byway open to all traffic | from # _____ to # _____ | |
| by providing that | _____ | | explain how
you want
the
particulars
altered |
| <hr/> | | | |

and shown on the map accompanying this application.

I/we attach copies of the following evidence in support of this application;

USER EVIDENCE FORMS FROM THESE 8 PEOPLE : (1) JESSICA RANNAHAN,
(2) BRIAN SAINSBURY, (3) JOHN HANSCOMB, (4) R. HANSCOMB, (5) STEVE J.
HANSCOMB, (6) BARRY GRANT, (7) J.W. BATKIN, (8) J. CREAK

list the
evidence
which
supports
your
application

Dated 20.11.05 Signed 

SUMMARY OF MODIFICATION ORDER APPLICATION

Wildlife and Countryside Act 1981

The Definitive Map and Statement of Public Rights of Way in Hertfordshire

Name and address of Applicant C. KNIGHT
96A MILDRED AVENUE, WATFORD, WD18 7DX

Date of Application 20.11.05

Description

Please describe the route starting at one end and working through to the other end.
Describe any feature of note, roads, landmarks, buildings, hedges etc.
If the route has a name or nickname please give it here.

PATH STARTS (SOUTH END) AT A GAP (WHEN SEEN IN AUG. 2005)
IN BOUNDARY FENCE AT OR APPROX. 2m N.W. OF JUNCTION OF FPs
(C. GRN.) 1, 2 & (RIC.) 34, IMMEDIATELY CROSSES PARISH BOUNDARY
FROM CROXLEY GREEN INTO RICKMANSWORTH AND CONTINUES THROUGHOUT
IN A ROUGHLY NORTHERLY DIRECTION, PASSING THROUGH GAP BETWEEN
TWO LINES OF TREES 240m. FROM START. FINISHES (NORTH END) AT
NARROW GAP BETWEEN TWO THICK ROUND POSTS AT LOUDWATER LANE
3m. N.W. OF STILE AT JUNCTION OF FPs 6 & 7.

Length

Please give the approximate length of the entire path in metres.
If you are claiming more than one path in the same application please give the length of each path separately.

355m.

Width

Please give the full width of the path you are claiming.
Please also give the width of the claimed path as it is now

Width claimed : 3m.

Width now : 3m.

Nature of surface

Please describe the surface of the path e.g. grass, made up track, ploughed, mud.

GRASS, MOSTLY MOWN SHORT SPECIFICALLY OVER THIS ROUTE.

Location of structures

Please give details and grid references for any gates, stiles, fences, bollards, barriers etc which are on the route now. Do not give details of fences if they run beside the route unless they are encroaching.

Structure	Grid Ref	Structure	Grid Ref	Structure	Grid Ref
<u>FENCE</u>	<u>0622 9585</u>				
<u>GAP BY</u>					
<u>FARM GATE</u>	<u>0630 9616</u>				

CERTIFICATE OF SERVICE OF NOTICE
OF
APPLICATION FOR A MODIFICATION ORDER

Wildlife and Countryside Act 1981
The Definitive Map and Statement of Public Rights of Way in Hertfordshire

To : *Definitive Map Officers, Hertfordshire County Council*
of : *Environment Department, County Hall, Pegs Lane, HERTFORD,*
SG13 8DN

I/we : COLIN KNIGHT
of : 96A MILDRED AVENUE, WATFORD, WD18 7DX

*name and
address of
applicant(s)*

hereby certify that the requirements of paragraph 2 of Schedule 14 to the Wildlife and Countryside Act 1981 have been complied with and attach a copy of each notice served pursuant to that Paragraph.

Dated 20.11.05 Signed 

Paragraph 2 of Schedule 14 to the Wildlife and Countryside Act states that ;

“the applicant shall serve a notice stating that the application has been made on every owner and occupier of any land to which the application relates”

“if, after reasonable inquiry has been made, the authority are satisfied that it is not practicable to ascertain the name or address of an owner or occupier of any land to which the application relates the authority may direct that the notice ... may be served by addressing it to him by the description ‘owner’ or ‘occupier’ of the land (describing it) and by affixing it to some conspicuous object or objects on the land”

NOTICE OF APPLICATION FOR A MODIFICATION ORDER

Section 53(5) and Schedule 14 to the Wildlife and Countryside Act 1981
The Definitive Map and Statement of Public Rights of Way in Hertfordshire

To : MR. JOHN COOK, ROYAL MASONIC TRUST FOR GIRLS & BOYS *name and address of owner or occupier*
 of : 31 GREAT QUEEN STREET, LONDON WC2B 5AG

Notice is hereby given that on 20th day NOVEMBER 2005
 the _____ of _____ *give the date of your application*

~~I/we~~ : COLIN KNIGHT *name and address of applicant(s)*
 of : 96A MILDRED AVENUE, WATFORD, WD18 7DX

made application to the Definitive Map Officers, Hertfordshire County Council, County Hall, HERTFORD, SG13 8DN that the Definitive Map and Statement for the area be modified by

<p>*deleting the</p>	<p>*footpath *bridleway *byway open to all traffic</p>	<p>from # _____</p>	<p>to # _____</p>	<p><i>* delete as appropriate - take detail from application</i></p>
<p>*adding the</p>	<p>*footpath *bridleway *byway open to all traffic</p>	<p>from # <u>0630 9616</u></p>	<p>to # <u>0622 9585</u></p>	<p><i>* fill in grid references for start and end of routes</i></p>
<p>*upgrading / downgrading the route currently shown as a to be shown as a</p>	<p>*footpath *bridleway *byway open to all traffic</p> <p>*footpath *bridleway *byway open to all traffic</p>	<p>from # _____</p>	<p>to # _____</p>	
<p>*varying /adding to the particulars relating to the by providing that</p>	<p>*footpath *bridleway *byway open to all traffic</p>	<p>from # _____</p>	<p>to # _____</p>	<p><i>explain how you want the particulars altered</i></p>

and shown on the map accompanying this notice.

Dated 20.11.05 Signed _____



Loudwater Lane, Croxley Green

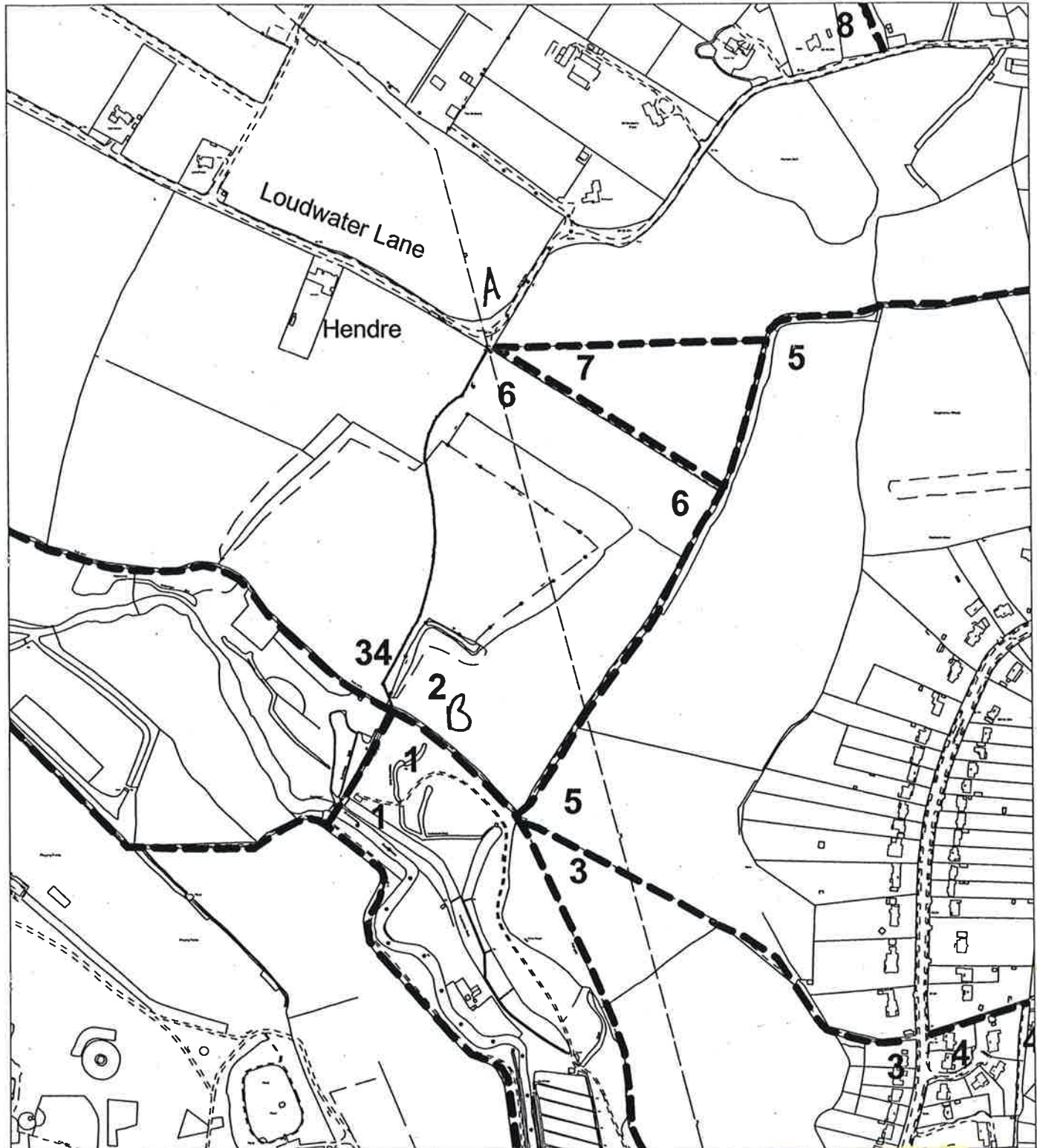

ROUTE OF CLAIMED FOOTPATH SHOWN RED

Point A: TQ 063, 961

Point B: TQ 062, 958

Scale 1:5000



Existing footpath

Appears on Definitive Map 83

This map is based upon Ordnance Survey material with the permission of Ordnance Survey on behalf of the Controller of Her Majesty's Stationery Office. Unauthorised reproduction infringes Crown copyright and may lead to prosecution or civil proceedings. Hertfordshire County Council, 100019606, 2005