

**REGISTER OF APPLICATIONS - MODIFICATION ORDERS**

DETAILS OF APPLICATION

District St. Albans File Name Napsbury fields  
 Parish St. Albans City Application Date 3/4/06

Grid References

Application to Add a number Point A .....  
of footpaths Point B PTO .....

Applicant Mr. Cameron Lavin .....

Nearest City Town Village  
St. Albans London Colney Colney Heath

Addresses of properties affected House Name/Street Postcode  
PTO .....  
 .....  
 .....

DETERMINATION (DECISION) OF APPLICATION

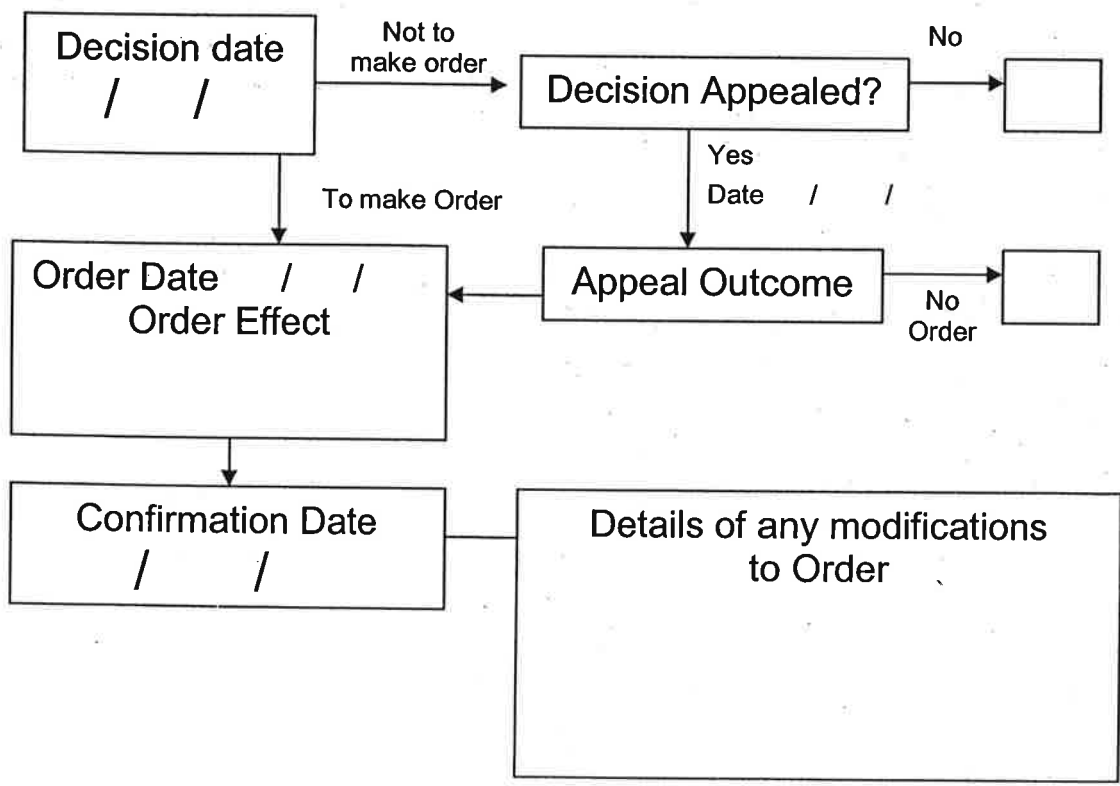

### Grid References:

Point A: TL 166, 048  
Point B: TL 167, 050  
Point C: TL 164, 053  
Point D: TL 162, 051

### Addresses of properties affected:

21-71	(odd no's)	Napsbury Lane	AL1 1DU
20-31	(all)	Meadowcroft	AL1 1UL
1-6	(all)	The Willows	AL1 1UL
6&11		The Firs	AL1 1UN
13-25	(odd no's)	The Poplars	AL1 1UW
1&4		The Almonds	AL1 1UZ
Aylett Nurseries Ltd		North Orbital Road	AL2 1DH
North Orbital Trading Estate		Napsbury Lane	AL1 1XB
Ambala Foods			
Metrans Ltd			
Bunzi Cleaning & Hygienic Supplies Ltd			
Everest Conservatories			

# APPLICATION FOR A MODIFICATION ORDER

Wildlife and Countryside Act 1981  
The Definitive Map and Statement of Public Rights of Way in Hertfordshire

To : *Definitive Map Officers, Hertfordshire County Council*  
of : *Environment Department, County Hall, Pegs Lane,*  
*HERTFORD, SG13 8DN*

Name : *CAMERON LAVIN* .....

name and address of applicant(s)

of : *23, THE POPLARS, STALBANS, HERTS AL1 1UW* .....

hereby apply for an order under section 53(2) of the Wildlife and Countryside Act 1981 modifying the Definitive Map and Statement for the area by

(N.B. Choose ONE of the four options given below)

1. deleting the *footpath* from # ..... to # .....  
*bridleway*  
*RUPP/restricted byway*  
*byway open to all traffic* \* delete as appropriate

X

2. adding the *footpath* from # *TL 165050* to # *TL 166048*  
*bridleway* \* fill in grid references for start and end of routes  
*byway open to all traffic*

3. upgrading/downgrading the route currently shown as a *footpath* from # ..... to # .....  
*bridleway*  
*RUPP/restricted byway*  
*byway open to all traffic*  
so that it is shown as a *footpath*  
*bridleway*  
*byway open to all traffic*

3. varying /adding to the particulars relating to the *footpath* from # ..... to # .....  
*bridleway*  
*byway open to all traffic*  
by providing that .....  
.....  
..... explain how you want the particulars altered

and shown on the map accompanying this application.

I/we attach copies of the following evidence in support of this application;  
*FOOTPATH A - USER EVIDENCE FORMS - 48 (+ 13 for under 20 yrs use)* list the evidence which supports your application  
*FOOTPATH B - USER EVIDENCE FORMS - 40 (+ 16 for under 20 yrs use)*  
*FOOTPATH C - USER EVIDENCE FORMS - 33 (+ 8 for under 20 yrs use)*  
*FOOTPATH D - USER EVIDENCE FORMS - 26 (+ 8 for under 20 yrs use)*  
Dated *03.04.06* Signed .....

OTHER EVIDENCE ATTACHED:- PERSONAL STATEMENTS 1  
PHOTOGRAPHS - PRINTS + CD ; AERIAL PHOTOS - 3 ; STALBANS MAPGUIDE x 3 EDS.  
3 SETS of FORMS RELATING TO USE of all 4 PATHS TOGETHER  
17 PAGES of PETITION SIGNED BY RESIDENTS, MOSTLY under 20 years USE of PATHS  
..... EVIDENCE FORMS

# NOTICE OF APPLICATION FOR A MODIFICATION ORDER

Section 53(5) and Schedule 14 to the Wildlife and Countryside Act 1981  
**The Definitive Map and Statement of Public Rights of Way in Hertfordshire**

To : MR ROGER AYLETT  
 of : AYLETT'S NURSERIES, NORTH ORBITAL ROAD, STALBANS, HERTS.

*name and address of owner or occupier*

Notice is hereby given that on the 3 day of APRIL 20 2006

*give the date of your application*

by : CAMERON LAVIN  
 of : 23 THE POPLARS, STALBANS,

*name and address of applicant(s)*

made application to the Definitive Map Officers, Hertfordshire County Council, County Hall, HERTFORD, SG13 8DN that the Definitive Map and Statement for the area be modified by

<p>*deleting the</p>	<p>*footpath  <del>*bridleway          *byway open to all traffic</del></p>	<p>from #</p>	<p>to #</p>	<p><i>* delete as appropriate - take detail from application</i></p>
<p>*adding the</p>	<p>*footpaths <u>A, B, C, D, on map</u>  <del>*bridleway          *byway open to all traffic</del></p>	<p>from # <u>165 050</u></p>	<p>to # <u>166 048</u></p>	<p><i>* fill in grid references for start and end of routes</i></p>
<p>*upgrading / downgrading the route currently shown as a</p>	<p>*footpath  <del>*bridleway          *byway open to all traffic</del></p>	<p>from #</p>	<p>to #</p>	
<p>to be shown as a</p>	<p>*footpath          *bridleway          *byway open to all traffic</p>			
<p>*varying /adding to the particulars relating to the</p>	<p>*footpath  <del>*bridleway          *byway open to all traffic</del></p>	<p>from #</p>	<p>to #</p>	<p><i>explain how you want the particulars altered</i></p>
<p>by providing that</p>	<p>_____</p> <p>_____</p>			

and shown on the map accompanying this notice.

Dated 03.04.06 Signed \_\_\_\_\_

# NOTICE OF APPLICATION FOR A MODIFICATION ORDER

Section 53(5) and Schedule 14 to the Wildlife and Countryside Act 1981  
**The Definitive Map and Statement of Public Rights of Way in Hertfordshire**

To : RIALTO HOMES c/o FAIRVIEW HOMES LTD  
 of : 50 LANCASTER ROAD, ENFIELD, MIDDLESEX EN2 0BY

*name and address of owner or occupier*

Notice is hereby given that on the 3 day of APRIL 2006

*give the date of your application*

I/we : MR CAMERON LAVIN  
 of : 23 THE POPLARS, ST ALBANS, HERTS. AL1 1UW

*name and address of applicant(s)*

made application to the Definitive Map Officers, Hertfordshire County Council, County Hall, HERTFORD, SG13 8DN that the Definitive Map and Statement for the area be modified by

\*deleting the ~~footpath~~ from # to #  
~~bridleway~~  
~~byway open to all traffic~~

*\* delete as appropriate - take detail from application*

\*adding the footpaths ABCD from # TL 165 050 to # TL 166 048  
~~bridleway~~  
~~byway open to all traffic~~

*\* fill in grid references for start and end of routes*

\*upgrading / downgrading the route currently shown as a ~~footpath~~ to be shown as a footpath  
~~bridleway~~  
~~byway open to all traffic~~

\*varying /adding to the particulars relating to the ~~footpath~~ by providing that ~~bridleway~~  
~~byway open to all traffic~~

*explain how you want the particulars altered*

and shown on the map accompanying this notice.

Dated 03.04.06 Signed \_\_\_\_\_

**CERTIFICATE OF SERVICE OF NOTICE**  
OF  
**APPLICATION FOR A MODIFICATION ORDER**

Wildlife and Countryside Act 1981  
**The Definitive Map and Statement of Public Rights of Way in Hertfordshire**

To : *Definitive Map Officers, Hertfordshire County Council*  
of : *Environment Department, County Hall, Pegs Lane, HERTFORD,*  
*SG13 8DN*

Name : *CAMERON LAVIN*  
of : *23 THE POPLARS, STALBANS, AL1 1UW*

*name and  
address of  
applicant(s)*

hereby certify that the requirements of paragraph 2 of Schedule 14 to the Wildlife and Countryside Act 1981 have been complied with and attach a copy of each notice served pursuant to that Paragraph. \*

Dated *03.04.06* Signed 

**Paragraph 2 of Schedule 14 to the Wildlife and Countryside Act states that ;**

*"the applicant shall serve a notice stating that the application has been made on every owner and occupier of any land to which the application relates"*

*"if, after reasonable inquiry has been made, the authority are satisfied that it is not practicable to ascertain the name or address of an owner or occupier of any land to which the application relates the authority may direct that the notice ... may be served by addressing it to him by the description 'owner' or 'occupier' of the land (describing it) and by affixing it to some conspicuous object or objects on the land"*

# SUMMARY OF MODIFICATION ORDER APPLICATION

Wildlife and Countryside Act 1981

## The Definitive Map and Statement of Public Rights of Way in Hertfordshire

Name and address of Applicant CAMERON LAVIN  
23 THE POPLARS ST ALBANS AL1 1UW

Date of Application 3<sup>rd</sup> APRIL 2006

### Description

Please describe the route starting at one end and working through to the other end.  
Describe any feature of note, roads, landmarks, buildings, hedges etc.  
If the route has a name or nickname please give it here.

PLEASE SEE DESCRIPTIONS ATTACHED for  
PATHS A, B, C, D  
HEDGE LINE + MATURE TREES + TPO AREAS SHOWN  
on ATTACHED MAP SENT BY ST ALBANS DISTRICT COUNCIL

### Length

Please give the approximate length of the entire path in metres.  
If you are claiming more than one path in the same application please give the length of each path separately.

A = 1550m. B = 600m C = 1300 D = 600m

### Width

Please give the full width of the path you are claiming.  
Please also give the width of the claimed path as it is now

Width claimed : 2 metres

Width now : Various between 0.5 and 2 metres

### Nature of surface

Please describe the surface of the path e.g. grass, made up track, ploughed, mud.

A, B, C, D - All grass surfaces; sections behind  
The Firs and The Poplars become muddy after wet weather

### Location of structures

Please give details and grid references for any gates, stiles, fences, bollards, barriers etc which are on the route now. Do not give details of fences if they run beside the route unless they are encroaching.

Structure	Grid Ref	Structure	Grid Ref	Structure	Grid Ref
-----------	----------	-----------	----------	-----------	----------

2<sup>m</sup> FENCES across each former access point shown on map  
and numbered 1, 2, 3, 4, 4a, 5, 6, 6a

1<sup>m</sup> FENCE Separates section of eastern field, leased by Ayletts, from  
the rest, with wide gate giving access between the two areas

These structures were erected January to March 2006

**Footpath Description: A – The Perimeter Path**

This is a continuous path around the edge of the entire Napsbury Field area with six important access points that link it with the Whitecroft Estate and London Road, Napsbury Lane and the A414 marked as follows on map: from Herons Way (1); from The Firs (2); from Birklands Field (3) which allows access to London Road; from A414 next to Ayletts Garden Centre western boundary fence (4); from eastern end of Napsbury Lane adjacent to house no. 71; and (5) to western end of Napsbury Lane, Green Lane Cottages and North Cottages. There is clear evidence that all sections are well used and have been so far at least 30 years. There are also access paths at the "dog leg" of Herons Way across to the Perimeter path, and from the North Orbital Trading Estate car park (6) used by their employees.

Beginning from Herons Way behind the garages at the back of the Newsagent, a 50 metre path x 2 m wide forks left at approx 45 degrees into the field, where it meets the Perimeter Path. Bearing slightly right and walking in anti-clockwise direction, the path is approx. 1 metre wide and runs roughly parallel to the general line of Herons Way. About 200 metres up is a link path across to Herons Way through an area of young oaks. The Perimeter path continues towards the south-west corner of the Top Field (with access out over a bank onto Napsbury Lane). The path turns left and follows the line of back gardens in Napsbury Lane. This section is mostly 2 metres wide. Past the corner of the last garden, the path turns north. (Approx 50 metres to the south-east across the grass is an access point to the footway on the A414, and thence to Ayletts, and previously to Bygraves & Wyevale). The Perimeter path continues northwards towards the stream that separates Napsbury Fields from Birklands Meadow, then turns north-west to run behind houses in The Almonds, The Firs and The Willows. This section is narrower (about 0.5 metres wide) but well used with access into The Firs which leads to the Whitecroft shops, the rest of the Whitecroft estate and out to the London Road. The Perimeter path continues to the north-west corner of the Sports field and links back to Herons Way again.

**Footpath Description: B The Diagonal Path**

This links the A414 adjacent to Ayletts western boundary fence to Herons Way and thereby to the London Road.

Starting on the A414, the route goes north. The path is ill-defined for first 50 metres due to grass cutting and track-laying by Ayletts to make the area suitable for their car parking. The path runs approx 350 metres north x 1 metre wide to the two old oak trees. It then turns west and north-west for approx 180 metres across the field and meets the dividing hedge at a midway point next to an old oak tree. Path narrows to 0.5 metre width as it passes through the hedge. It then bears north-west diagonally across the Sports field to meet up with the Perimeter path (A) and gives access to Herons Way, Meadowcroft, New House Park and London Road. The path width across the Sports field is approx is 2 metres. Access points are no. 1 and 4 on map.



### **Footpath Description C. The Western Perimeter Path Variation.**

This runs from Herons Way (access point 1 on map) but can also be accessed from point 6a on map at the Herons Way "dog leg". It provides an alternative route from Meadowcroft / Whitecroft / New House Park and from London Road via Herons Way to the A414 and Ayletts (formerly also to Bygraves/Wyevale Nurseries). It leads south west for about 180 metres as the Perimeter Path then turns south east across the corner of the field and meets the Perimeter path again just before the Copper beech tree (CB on map) This section is a wide track 2 metres x 200 metres long approx. It then continues along the back of the gardens in Napsbury Lane. Just beyond the last house there is access out into the A414 and to the Nurseries. The path goes north to the stream on the boundary of Birklands Meadow then north west behind the back gardens of The Almonds, The Poplars and The Firs and to the north west corner of the Sports Field with access at the Firs and also back to Herons Way. Access points are no. 6, 4, 3, 2 and 1 on map.

### **Footpath Description D. – Inner variation on perimeter path**

This links the Whitecroft Estate with the A414 and Napsbury Lane. From Herons Way and Meadowcroft at north corner of Sports Field, this is the same route going south east as that section of the Perimeter Path A, passing the back of houses in The Firs, The Poplars and The Almonds. But at a point near the end of the houses Path D bears right (southwards) to the two large oak trees, making this a shorter route than the Perimeter Path. The width is about half a metre.

It meets up with the Diagonal Path B and crosses Path C on the south east of the field and then out onto the A414 next to Ayletts boundary fence (where Footpath No. 52 used to be). The last 50 metres of the route across the grass is not well-defined as the area is mown and used for car parking – but the access point with A414 is obvious and well used.

This map is based upon Ordnance Survey material with the permission of Ordnance Survey on behalf of the Controller of Her Majesty's Stationery Office. Unauthorised reproduction infringes Crown copyright and may lead to prosecution or civil proceedings. Hertfordshire County Council, 100019606 ,2006

STA/104/MOD

Key to Map

- Footpath A shown in red
- Footpath B shown in blue
- Footpath C shown in green
- Footpath D shown in mauve

Access Points between the Footpaths and Roads, as applicable:-

- 1 To/from Herons Way
- 2 To/from The Firs
- 3 To/from London Road via Birklands
- 4 To/from A414
- 4a To/from Napsbury Lane eastern end
- 5 To/from Napsbury Lane western end and North Orbital Trading Estate
- 6 To/from North Orbital Trading Estate car park
- 6a To/from Heron's Way "Dog Leg"

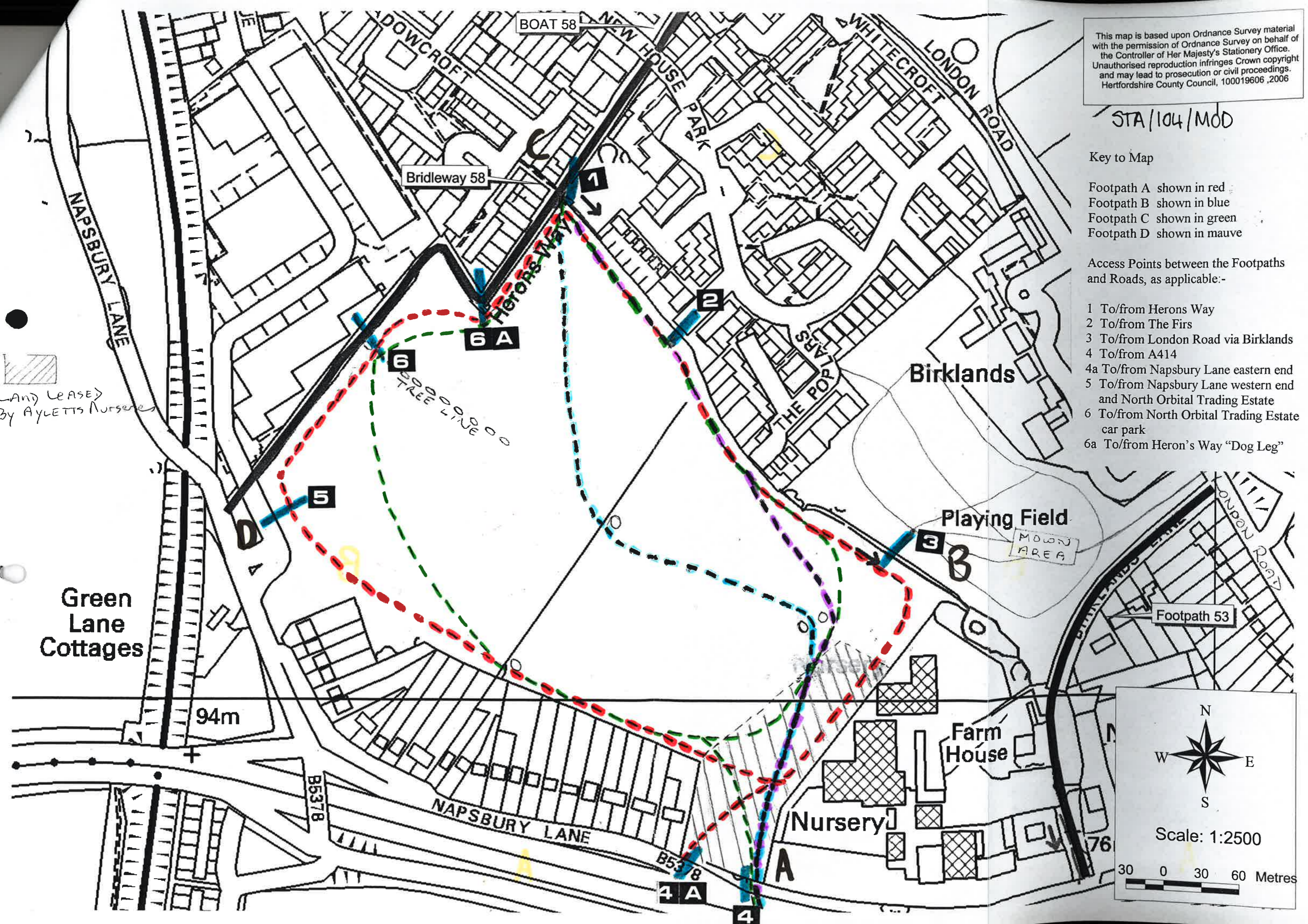

LAND LEASED  
By Aylett's Nurseries

Green Lane Cottages

94m

B5378

NAPSBUURY LANE

B5378

4A

4

Nursery

Farm House

Playing Field

MOWN AREA

Footpath 53

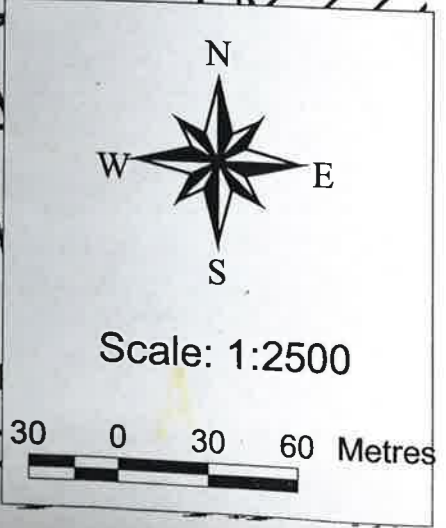

Scale: 1:2500

30 0 30 60 Metres