

REGISTER OF APPLICATIONS - MODIFICATION ORDERS

DETAILS OF APPLICATION

District	ST ALBANS.....	File Name	FROGMORE.....
Parish	ST STEPHENS INTO ST ALBANS CITY.....	Application Date	27/10/2007
Grid References			
Application to	ADD FOOTPATH.....	Point A	TL 160 035.....
	Point B	TL 151 033.....
Applicant	MR P. ESCRITT.....		
Nearest	City	Town	Village
	ST ALBANS.....	ST ALBANS.....	FROGMORE.....
Addresses of properties affected	House Name/Street	Postcode	
	35A, FROGMORE.....	AL2 2JT.....	
	31 SILVERDALE HOUSE, FROGMORE.....	AL2 2NH.....	
	PARKHOUSE, FROGMORE.....	AL2 2NH.....	

DETERMINATION (DECISION) OF APPLICATION

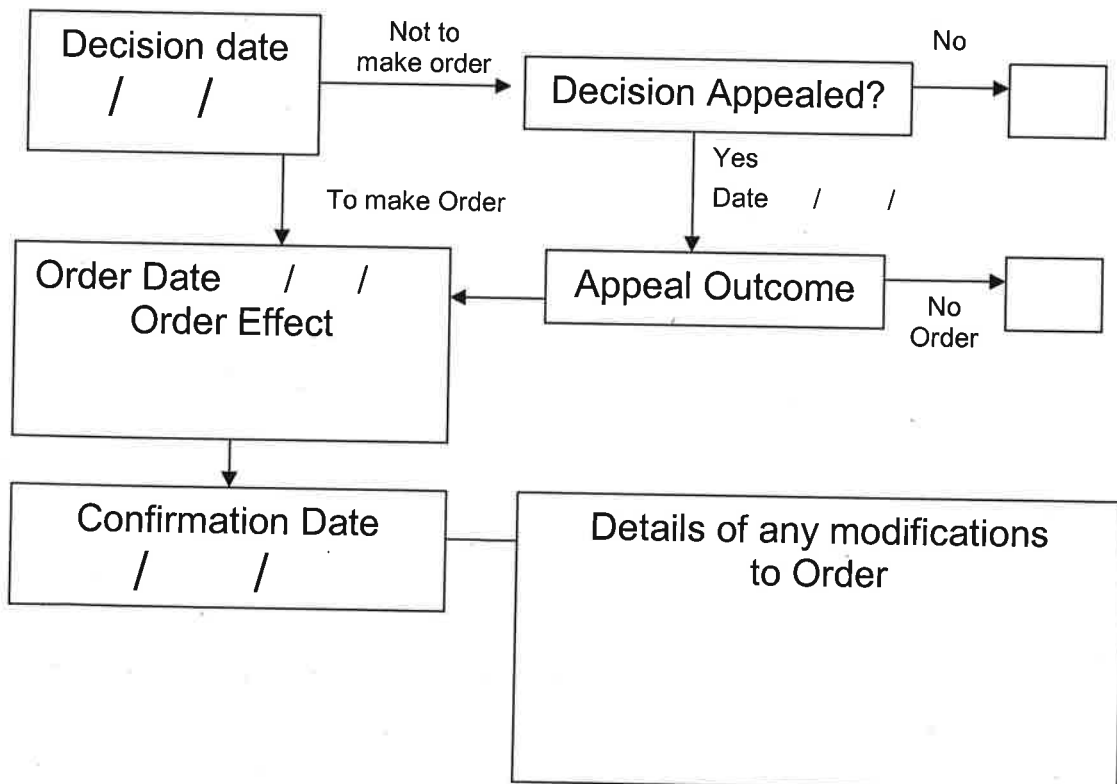

The Ramblers' Association
Working for Walkers
Hertfordshire & North Middlesex Area

Charity registration number 1093577; part of the Ramblers' Association,
a company limited by guarantee, registration number 4458492

The Ramblers



Wildlife and Countryside Act 1981

Definitive Map and Statement for the Public Rights of Way in Hertfordshire

To: Hertfordshire County Council
Of: County Hall, Hertford, SG13 8DN

I, Philip Escritt, of 2 St Stephens Avenue, St Albans, AL3 4AD, hereby certify that the requirements of paragraph 2 of Schedule 14 to the Wildlife and Countryside Act 1981 have been complied with in connection with my application dated 27 October 2007 for the modification of the definitive map and statement for the county of Hertfordshire by adding the footpath from St Stephens Footpath 14 (grid reference 160036) to Frogmore (grid reference 152034)

Dated 27 October 2007

Signed



The Ramblers' Association
Working for Walkers
Hertfordshire & North Middlesex Area

Charity registration number 1093577; part of the Ramblers' Association,
a company limited by guarantee, registration number 4458492

The Ramblers



Wildlife and Countryside Act 1981

Definitive Map and Statement for the Public Rights of Way in Hertfordshire

To: Hertfordshire County Council
Of: County Hall, Hertford, SG13 8DN

I, Philip Escritt, of 2 St Stephens Avenue, St Albans, AL3 4AD, hereby apply for an order under section 53(2) of the Wildlife and Countryside Act 1981 modifying the definitive map and statement for the county of Hertfordshire by adding the footpath from St Stephens Footpath 14 (grid reference 160036) to Frogmore (grid reference 152034) as shown on the map annexed hereto.

I refer to the following documentary evidence in the Hertfordshire County Council Archives in support of this application.

1862 – Midland Railway Extension to London

- 1) Plans and Sections of Railway from London to Bedford – Plate 11 – HCC Archives R/159 or R/160
- 2) Book of References – Field 48 – HCC Archives R/158

I attach copies of the following documentary evidence in support of this application

Extracts from Ordnance Survey Sheet XXXIX.4 showing the path as a physical feature

- a) First edition 1879
- b) 1898 edition
- c) 1924 edition
- d) 1938 edition

Dated 27 October 2007

Signed



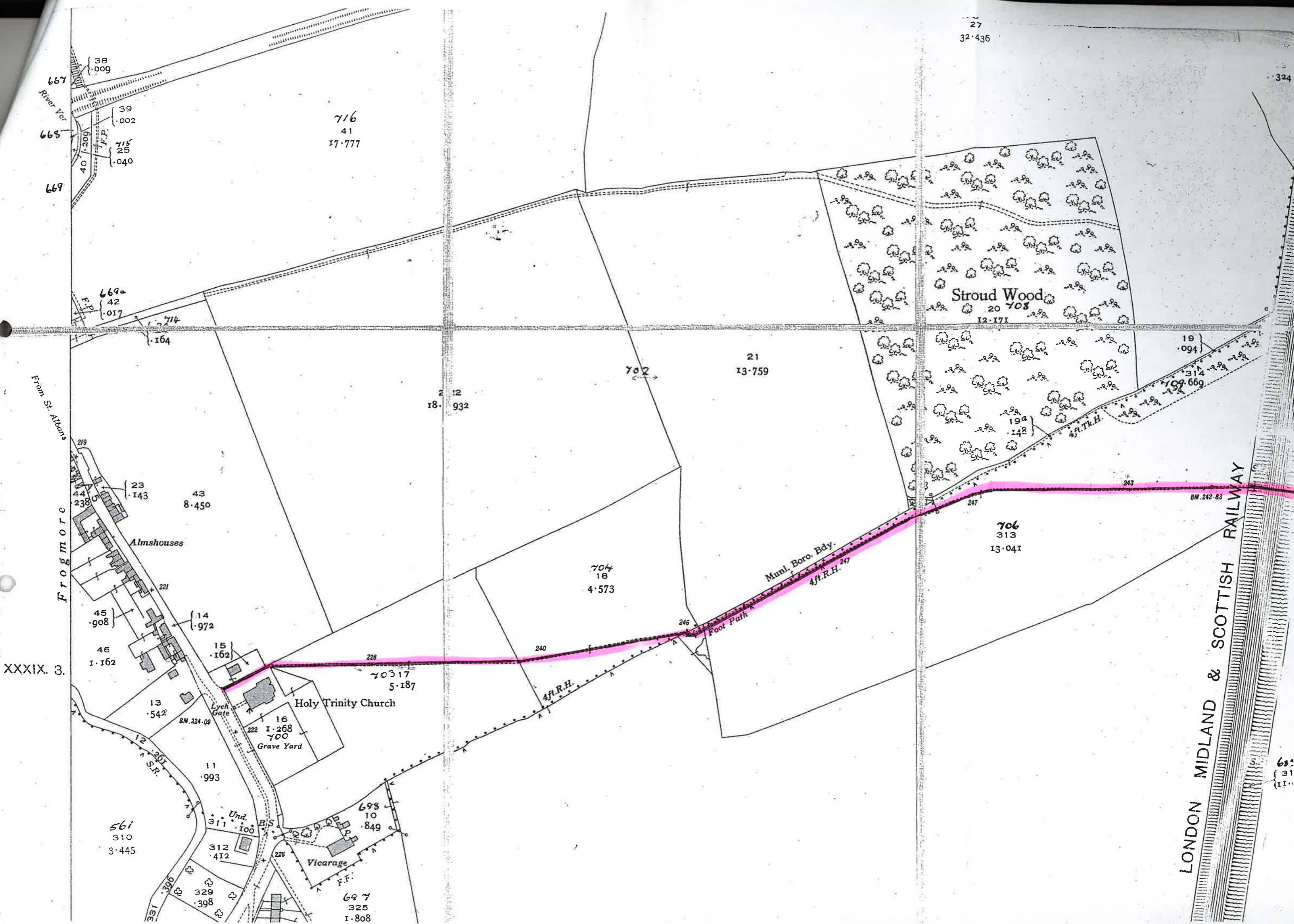

667
River Ver
668
669

716
41
17.777

669a
42
017

Stroud Wood
20 703
12.171

From St. Albans
Frogmore

Almshouses

Holy Trinity Church

Vicarage

LONDON MIDLAND & SCOTTISH RAILWAY

XXXIX. 3.

561
310
3.445

697
325
1.808

695
31
11.

Frogmore, St Albans STA/111/MOD

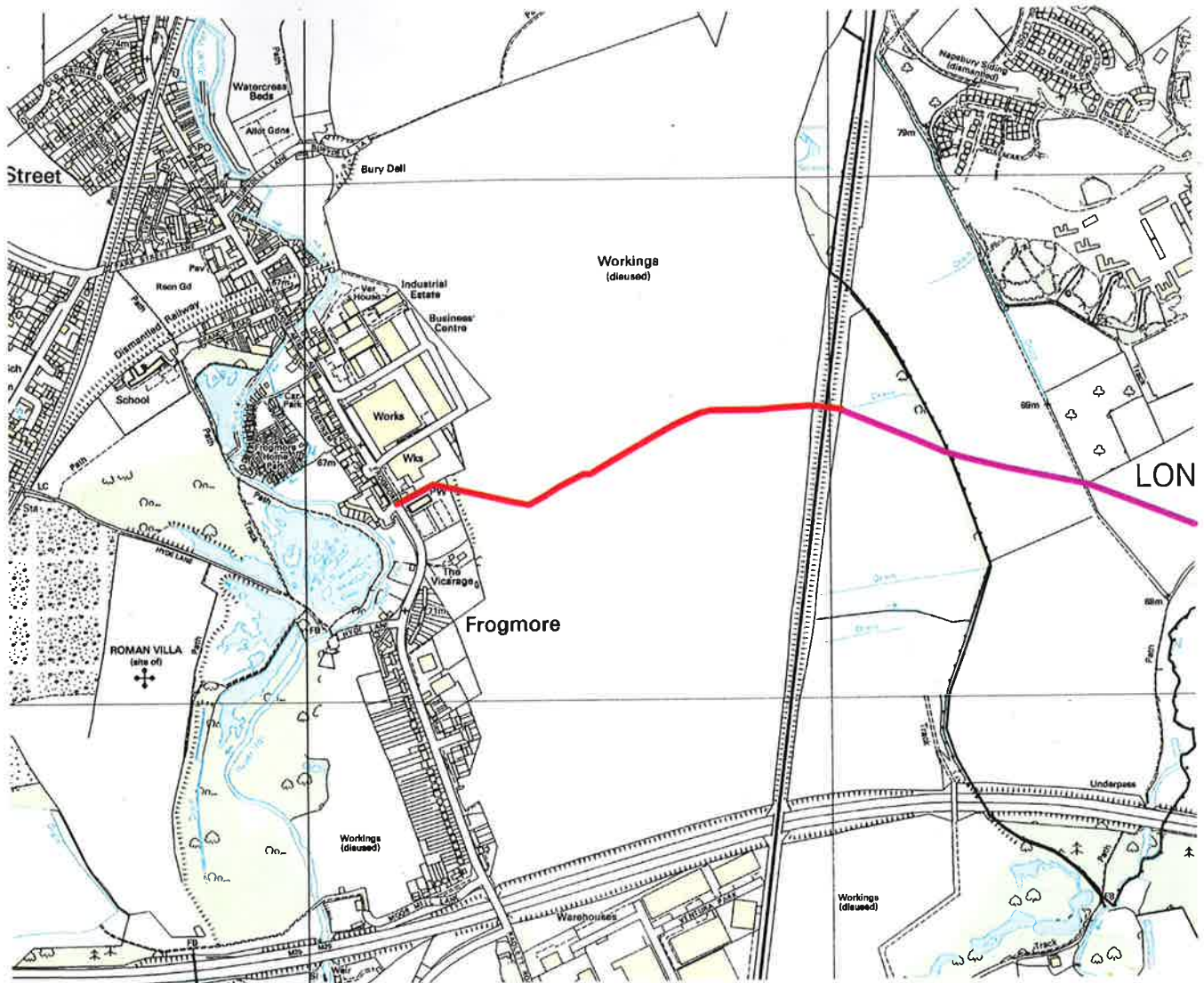

0 200 400 600 800 1000 Metres

Scale 1:7500

This map is based upon Ordnance Survey material with the permission of Ordnance Survey on behalf of the Controller of Her Majesty's Stationery Office. Unauthorised reproduction infringes Crown copyright and may lead to prosecution or civil proceedings. Hertfordshire County Council, 100019606, 2008.

Proposed Route to join footpath St Stephen 014



Existing Foot Path St Stephen 014



Grid References

TL 160 035

TL 151 033