

PUBLIC PATH DIVERSION ORDER

HIGHWAYS ACT 1980, SECTION 119

HERTFORDSHIRE COUNTY COUNCIL

Hertfordshire County Council (Standon 91) Public Path Diversion Order 2012

This Order is made by Hertfordshire County Council ("the authority") under section 119 of the Highways Act 1980 ("the 1980 Act") because it appears to the authority that in the interests of the owner of the land crossed by the footpath described in paragraph 1 of this order it is expedient that the line of the path should be diverted.

The Westminster Roman Catholic Diocese Trustee has agreed to defray any compensation which becomes payable in consequence of the coming into force of this order and any expenses which are incurred in bringing the new site of the path into a fit condition for use by the public.

East Herts District Council has been consulted as to the making of the Order as required by section 120(2) of the 1980 Act.

BY THIS ORDER

1. The public right of way over the land situate at Standon shown by a bold continuous line on the plan forming part of this Order ("the Order Plan") and described in Part 1 of the Schedule to this Order ("the Schedule") shall be stopped up 30 days after the date of confirmation of this Order.
2. There shall 30 days after the date of confirmation of this Order be a public footpath over the land situate at Standon described in Part 2 of the Schedule and shown by a bold broken line on the Order Plan.
3. The rights conferred on the public under this Order shall be subject to the limitations and conditions set out in Part 3 of the Schedule.

SCHEDULE

PART 1

DESCRIPTION OF SITE OF EXISTING PATH OR WAY

The full width of a public footpath commencing at the entrance to St Edmund's College off Ermine Street at point A on the Order Plan (TL 3751 2175) and continuing in a generally north westerly direction to the junction with Old Hall Green Lane at point B on the Order Plan (TL 3700 2189).

Width: 1.2 metres (4 feet)

Limitations: Gates at point A on the Order Plan (TL 3751 2175) and point B on the Order Plan (TL 3700 2189)

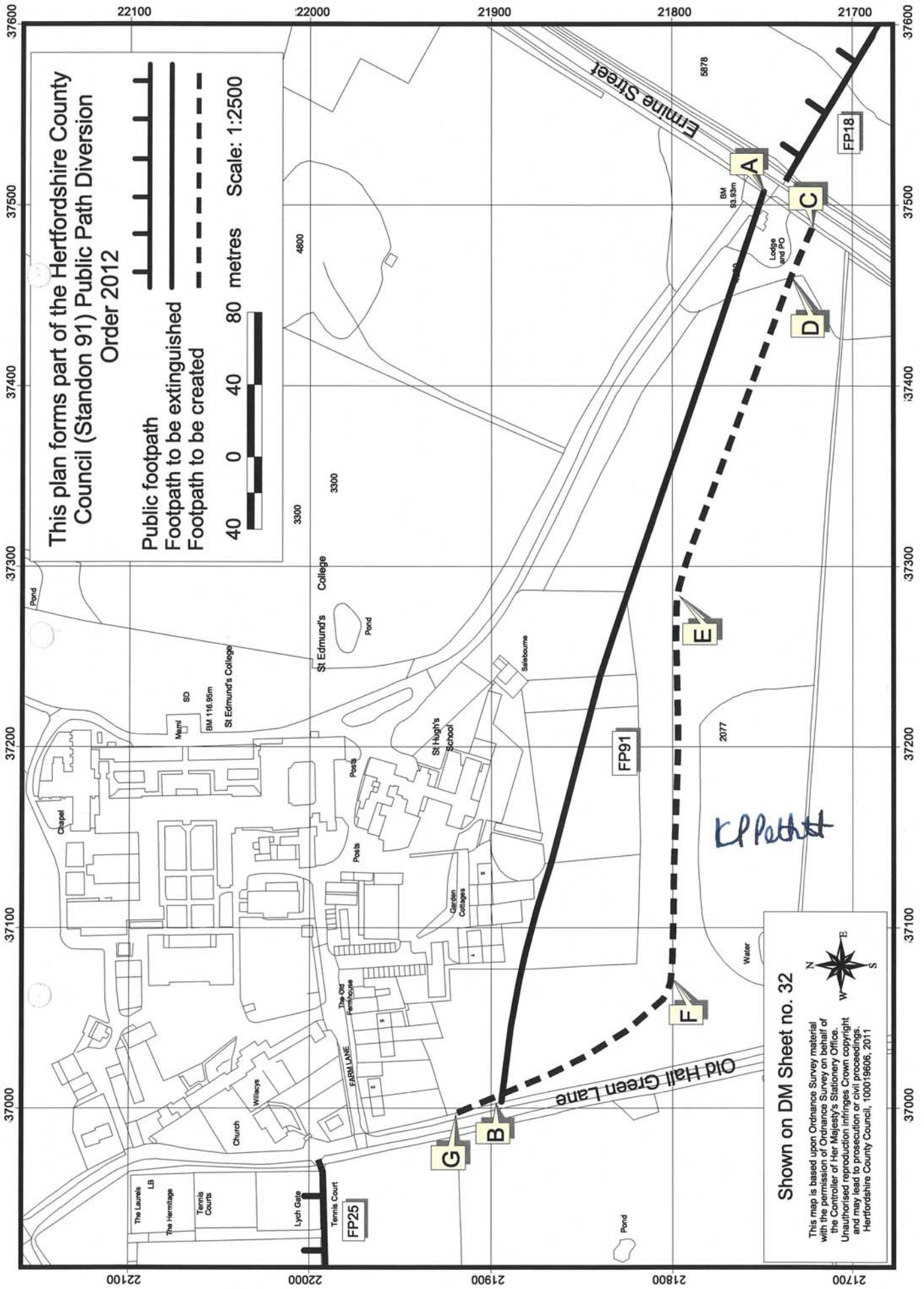

This plan forms part of the Herfordshire County Council (Standon 91) Public Path Diversion Order 2012

Public footpath
 Footpath to be extinguished
 Footpath to be created

40 0 40 80 metres Scale: 1:2500

Shown on DM Sheet no. 32

This map is based upon Ordnance Survey material with the permission of Ordnance Survey on behalf of the Controller of Her Majesty's Stationery Office. Unauthorised reproduction infringes Crown copyright and may lead to prosecution or civil proceedings. Herfordshire County Council, 1000/19606, 2011

K.P. Petch

PART 2
DESCRIPTION OF SITE OF NEW PATH OR WAY

A public footpath commencing at the junction with Ermine Street at point C on the Order Plan (TL 3748 2172) and continuing in a generally north westerly direction across the meadow for approximately 215 metres to point E on the Order Plan (TL 3728 2179) then continuing in a generally westerly direction along the brow of the hill for approximately 210 metres to point F on the Order Plan (TL 3707 2180) then continuing in a generally north north westerly direction uphill for approximately 145 metres to a junction with Old Hall Green Lane at point G on the Order Plan (TL 3699 2192).

Width: 3 metres

PART 3
LIMITATIONS AND CONDITIONS

None

IN WITNESS whereof the COMMON SEAL of HERTFORDSHIRE COUNTY COUNCIL was hereunto affixed this 26th day of January 2012

The Common Seal of
HERTFORDSHIRE
COUNTY COUNCIL
was hereunto affixed
in the presence of:-

Kathryn Pettitt

Chief Legal Officer

