

NOTICE OF CONFIRMATION OF A CREATION ORDER

HIGHWAYS ACT 1980, SECTION 26

HERTFORDSHIRE COUNTY COUNCIL

HERTFORDSHIRE COUNTY COUNCIL (TRING RURAL FOOTPATH) CREATION ORDER 2015

On 27th February 2015 Hertfordshire County confirmed the above Order made under section 26 of the Highways Act 1980.

The effect of the Order as confirmed is to create public footpaths running from:

- SP 8880 1596 (Point A on the Order Plan) in a generally south westerly direction for approximately 250 metres to SP 8859 1583 (Point E on the Order Plan) then continuing in a generally south westerly direction for approximately 190 metres to SP 8842 1574 (Point F on the Order Plan). The footpath then continues in a generally south westerly direction before arcing around the field generally north westerly and then north easterly for a distance of approximately 500 metres to SP 8827 1588 (Point G on the Order Plan)
- SP 8859 1583 (Point E on the Order Plan) north west along the south west side of the field boundary then continuing around the field following the northern sides of the field for approximately 430 metres to its junction with Tring Rural Footpath 7 at SP 8828 1590 (Point H on the Order Plan).
- SP 8828 1590 (Point H on the Order Plan) in a south westerly direction for a distance of approximately 30 metres to SP 8827 1588 (Point G on the Order Plan) then running in a north westerly direction for approximately 10 metres to its junction with Tring Rural Footpaths 4 and 7 at SP 8826 1588 (Point D on the Order Plan)

as shown on the Order Plan.

A copy of the Order and the Order Plan may be seen free of charge at front reception of Hertfordshire County Council, County Hall, Hertford, from 9.00 am to 4.00 pm on Monday to Friday and at Dacorum Borough Council, Civic Centre, The Marlowes, Hemel Hempstead, Hertfordshire. Copies of the Order and Plan may be bought at the price of £2.

The Order comes into force as from 11th March 2015, but if any person aggrieved by the Order wants to question its validity, or that of any provision contained in it, on the grounds that it is not within the powers of the Highways Act 1980, as amended, or on the grounds that any requirement of the Act, as amended, or of any regulation made under the Act has not been complied with in relation to the Order, he or she may, under paragraph 2 of Schedule 2 to the Act as applied by paragraph 5 of Schedule 6 to the Act, within 6 weeks from 11th March 2015, make an application to the High Court.

Dated: 11th March 2015

PUBLIC PATH CREATION ORDER
HIGHWAYS ACT 1980
HERTFORDSHIRE COUNTY COUNCIL

Hertfordshire County Council
(Tring Rural Footpath)
Creation Order 2015

This Order is made by Hertfordshire County Council ('the authority') under section 26 of the Highways Act 1980 ("the 1980 Act") because it appears to the authority that, having regard to the matters set out in section 26(1), there is a need for public footpaths over the land to which this Order relates, and that it is expedient that the paths should be created.

Dacorum Borough Council has been consulted as required by section 26(3) of the 1980 Act.

BY THIS ORDER:

1. There shall be on the date of confirmation of this Order public footpaths ("the Footpaths") over the land at Long Marston described in part 1 of the Schedule to this Order and shown by a bold broken line on the Plan attached to this Order ("the Order Plan").

SCHEDULE

PART 1

DESCRIPTION OF LAND

A new footpath commencing from its junction with Tring Rural Footpath 3 at SP 8880 1596 (Point A on the Order Plan) and running in a generally south westerly direction for approximately 250 metres to SP 8859 1583 (Point E on the Order Plan) then continuing in a generally south westerly direction for approximately 190 metres to SP 8842 1574 (Point F on the Order Plan). The footpath then continues in a generally south westerly direction before arcing around the field in a generally north westerly and then north easterly direction for a distance of approximately 500 metres to SP 8827 1588 (Point G on the Order Plan).

Width: 4 metres between SP 8880 1596 (Point A on the Order Plan) and SP 8859 1583 (Point E on the Order Plan).

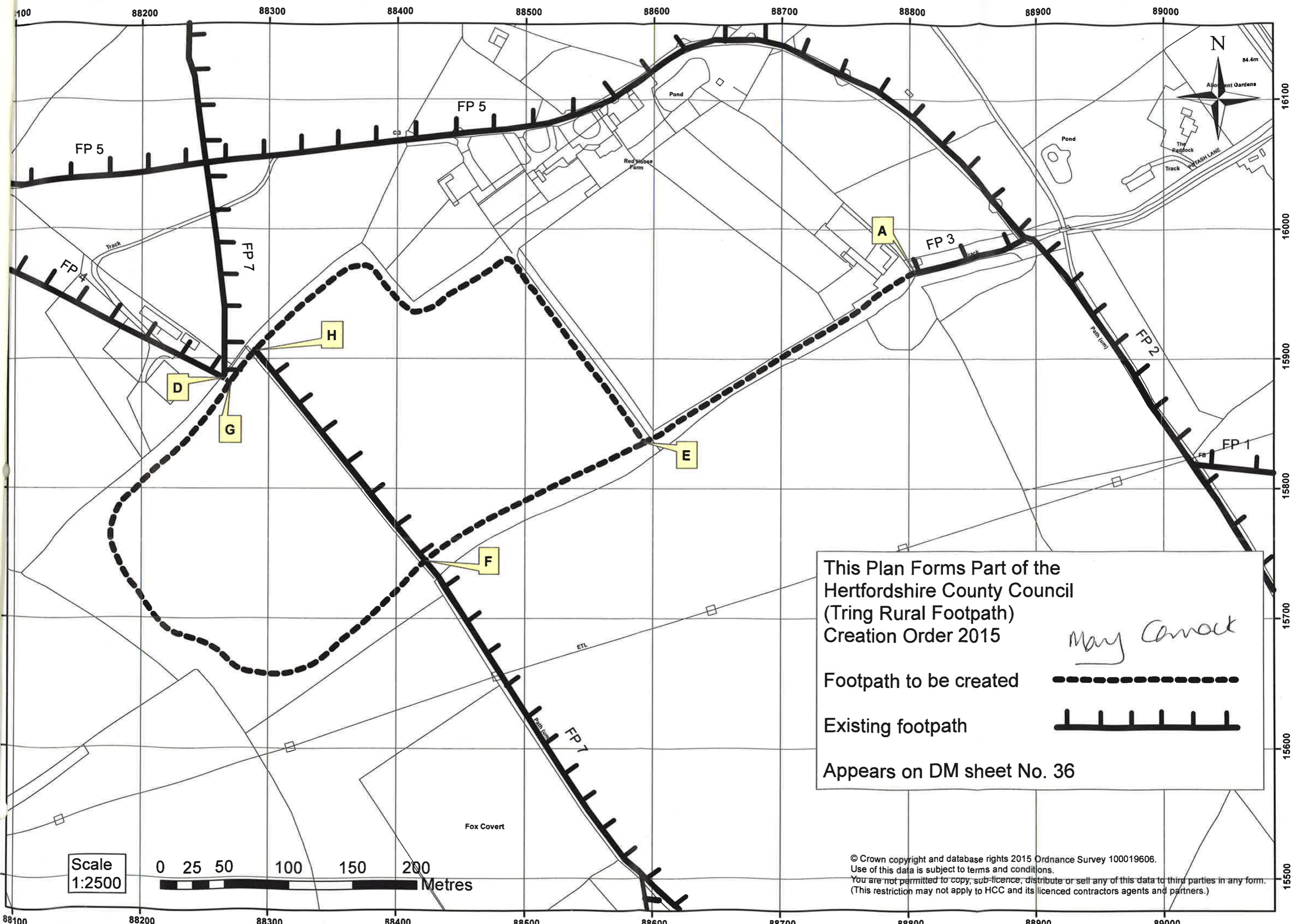

This Plan Forms Part of the
 Hertfordshire County Council
 (Tring Rural Footpath)
 Creation Order 2015

Mary Conrath

Footpath to be created 

Existing footpath 

Appears on DM sheet No. 36

Scale
 1:2500

0 25 50 100 150 200 Metres

© Crown copyright and database rights 2015 Ordnance Survey 100019606.
 Use of this data is subject to terms and conditions.
 You are not permitted to copy, sub-licence, distribute or sell any of this data to third parties in any form.
 (This restriction may not apply to HCC and its licenced contractors agents and partners.)

3 metres between SP 8859 1583 (Point E on the Order Plan) and SP 8827 1588 (Point G on the Order Plan).

A new footpath commencing at SP 8859 1583 (Point E on the Order Plan) running north west along the south west side of the field boundary then continuing around the field following the northern sides of the field for approximately 430 metres to its junction with Tring Rural Footpath 7 at SP 8828 1590 (Point H on the Order Plan).

Width: 3 metres

A new footpath commencing at its junction with Tring Rural Footpath 7 at SP 8828 1590 (Point H on the Order Plan) and running in a south westerly direction for a distance of approximately 30 metres to SP 8827 1588 (Point G on the Order Plan) then running in a north westerly direction for approximately 10 metres to its junction with Tring Rural Footpaths 4 and 7 at SP 8826 1588 (Point D on the Order Plan).

Width: 3 metres

PART 2

LIMITATIONS AND CONDITIONS

None

IN WITNESS whereof the COMMON SEAL of HERTFORDSHIRE COUNTY COUNCIL was hereunto affixed this 9th day of January 2015

The Common Seal of)
HERTFORDSHIRE COUNTY COUNCIL)
was hereunto affixed)
in the presence of:-)
)

36/15

Mary Cormack

Chief Legal Officer

Mary Cormack
Asst Chief Legal Officer

The foregoing Order is hereby confirmed

~~Chief Legal Officer~~

Mary Cormack

Dated

Mary Cormack
Asst Chief Legal Officer

27 February 2015

