

REGISTER OF DEPOSITS- **HIGHWAYS ACT 1980***- **COMMONS ACT 2006***

(* tick if applicable or specify N/A)

DETAILS OF APPLICATION

Date Application received in prescribed form 28/11/2019

Date by which any subsequent highways
declaration must be lodged 27/11/2039**Parcel**

District Dacorum Parish Berkhamsted

Address and postcode of buildings
on each piece of land subject to the
application to which a postcode has
been assignedLand at Bridle Way
Berkhamsted
Herts
HP4 1DS

Nearest town/city to above

Berkhamsted

OS 6 figure Grid Reference(s)
for a point within the area of the land
(if possible for postcode point above)

SP 983 089



NOTICE OF LANDOWNER DEPOSITS under
Section 31(6) of the Highways Act 1980 and
Section 15A(1) of the Commons Act 2006
HERTFORDSHIRE COUNTY COUNCIL

An application to deposit a map and statement under section 31(6) of the Highways Act 1980 and deposit a statement under section 15A(1) of the Commons Act 2006 has been made in relation to the land (or lands) described below and shown edged red on the accompanying map.

PLEASE NOTE:

This deposit may affect rights over the land described below. Deposits made under section 31(6) of the Highways Act 1980 may prevent deemed dedication of public rights of way over such land under section 31(1) of that Act. Deposits made under section 15A(1) of the Commons Act 2006 may affect the ability to register such land as a town or village green under section 15 of that Act. For further information please see guidance at <https://www.gov.uk/guidance/town-and-village-greens-how-to-register>

Description of the land:

Land at Bridle Way, Berkhamsted, Herts, HP4 1DS

Name of the parish, ward or district in which the land is situated:

Berkhamsted, Dacorum

The deposit was submitted by Carter Jonas on behalf of Hertfordshire County Council and was received by this authority on 22nd October 2019.

The authority maintains a register of maps, statements and declarations deposited under section 31A of the Highways Act 1980 and section 15B of the Commons Act 2006. This register can be accessed online at www.hertfordshire.gov.uk/landownerdeposits or can be inspected free of charge at Hertfordshire County Council, County Hall, Pegs Lane, Hertford, Hertfordshire, SG13 8DN during office hours between 9:00am and 5:00 pm

Signed on behalf of Hertfordshire County Council:

Name and position of Signatory: R. Cuthbert, Definitive Map & Enforcement Team Leader

Date: 28th November 2019

PART A

Information relating to the Applicant and Land to which the Application relates

(all applicants must complete this part)

1 Name of appropriate authority to which the application is addressed:
Hertfordshire County Council

2 Name and full address (including postcode) of applicant:

Name: Oliver Patterson
Address: Carter Jonas
One Chapel Place
London

Postcode: W1G 0BG

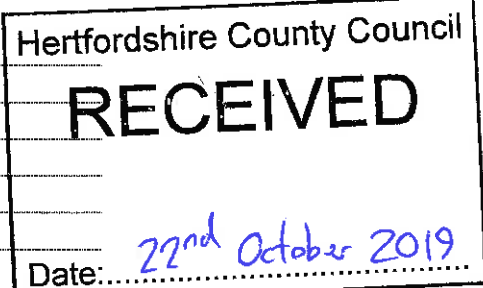

3 Status of applicant (tick relevant box or boxes):

I am

- (a) the owner of the land(s) described in paragraph 4.
(b) making this application and the statements/declarations it contains on behalf of Hertfordshire County Council who is the owner of the land(s) described in paragraph 4 and in my capacity as Estates Consultant to the County Council.

4 Insert description of the land(s) to which the application relates (including full address and postcode):

Description of
Land(s):

Land at Bridle Way, Berkhamsted (asset plan 00153107)

Full address:

Bridle Way, Berkhamsted

Postcode

HP4 1DS

5 Ordnance Survey six-figure grid reference(s) of a point within the area of land(s) to which the application relates (if known):

Asset Plan 00153107 – OS Ref: SP9808NW

6 This deposit comprises the following statement(s) and/or declarations (tick relevant box or boxes):

PART B
PART C
PART D

(delete Parts B, C or D from the form below where not applicable):

PART B

Statement under section 31(6) of the Highways Act 1980

Hertfordshire County Council is the owner of the land described in paragraph 4 of Part A of this form and shown edged red on the maps accompanying this statement.

(delete wording in square brackets as appropriate and/or insert information as required)

The areas of land shown coloured purple and shown coloured green on the accompanying maps have been dedicated as highways/rights of way. The line coloured green is designated as Bridleway 022 and the lines coloured purple are designated as Footpath 037 and Footpath 023.

PART D

Statement under section 15A(1) of the Commons Act 2006

Hertfordshire County Council is the owner of the land described in paragraph 4 of Part A of this form and shown edged red on the maps accompanying this statement on the 21st May 2019.

This application is made by Oliver Patterson of Carter Jonas as agent for the landowner and on its behalf.

Hertfordshire County Council wishes to bring to an end any period during which persons may have indulged as of right in lawful sports and pastimes on the whole or any part of the land shown edged red on the accompanying maps referenced above.

For the avoidance of doubt, the referenced plan is asset plan numbered 00153107.
(delete wording in square brackets as appropriate and/or insert information as required)

PART E

Additional information relevant to the application (insert any additional information relevant to the application)

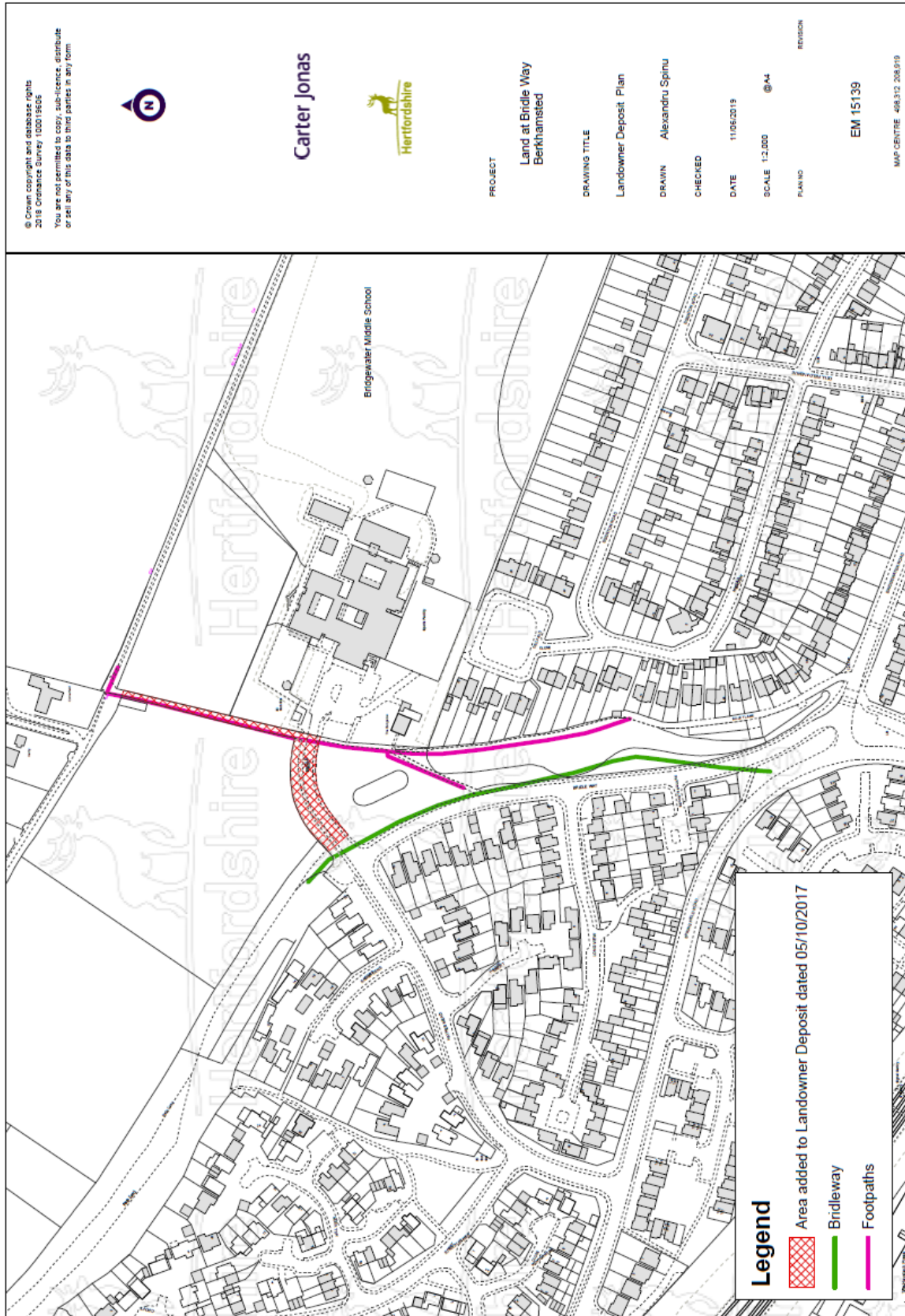

WARNING: If you dishonestly enter information or make a statement that you know is, or might be, untrue or misleading, and intend by doing so to make a gain for yourself or another person, or to cause loss or the risk of loss to another person, you may commit the offence of fraud under section 1 of the Fraud Act 2006, the maximum penalty for which is 10 years' imprisonment or an unlimited fine, or both.

I BELIEVE THAT THE FACTS AND MATTERS CONTAINED IN THIS FORM ARE TRUE

Signature: _____

(of the person making the statement of truth)

Date: 11/06/2019

Print Name: Oliver Patterson

You should keep a copy of the completed form

Data Protection Act 1998 Fair Processing Notice

The purpose of this Fair Processing Notice is to inform you of the use that will be made of your personal data, as required by the Data Protection Act 1998.

The appropriate authority (see explanation of definition in above guidance notes) in England is the data controller in respect of any personal data that you provide when you complete this form.

The information that you provide will be used by the appropriate authority in its duties to process applications to deposit statements, maps and declarations under section 31(6) the Highways Act 1980 and statements under section 15A(1) of the Commons Act 2006. The information you provide will also be used by the appropriate authority in its duty to upgrade the registers in which details of such deposits are recorded under the Dedicated Highways (Registers under Section 31A of the Highways Act 1980 (England) Regulations 2007 and the Commons (Registration of Town or Village Greens) and Dedicated Highways (Landowner Statements and Declarations) (England) Regulations 2013.

The appropriate authority is required by the legislation above to maintain a register which holds information provided in this form, which can be inspected online or in person by members of the public on request. It may also be required to release information, including personal data and commercial information, on request under the Environmental Information Regulations 2004 or the Freedom of Information Act 2000. However, the appropriate authority will not permit any unwarranted breach of confidentiality nor will they act in contravention of their obligations under the Data Protection Act 1998.