

33/3/20

---

Dated 7<sup>TH</sup> APRIL 1998

Du Parcq (Jersey) Limited  
land at Harpenden, Hertfordshire

---

STATUTORY DECLARATION  
of J  
pursuant to section 31(6) of the Highways Act 1980

---

KJD  
Kent Jones and Done

I, [redacted] of [redacted]  
[redacted], Jersey, do solemnly and sincerely  
declare that:

1. I am a director of Du Parcq (Jersey) Ltd ("the Company"). I am duly authorised by the Company to make this declaration on its behalf in connection with a deposit of statement and map pursuant to section 31(6) of the Highways Act 1980.
2. The Company is the owner of the land in the parish of Harpenden ("the Land") shown for identification purposes only edged red on the plan now produced and shown to me marked "JML1" which is to the best of my knowledge and belief accurate.
3. On 10 March 1998 I (through Kent Jones and Done Solicitors) deposited with Hertfordshire County Council, being the appropriate Council, a statement dated 4 March 1998 accompanied by a map identifying the Land by red edging which stated that no ways had been dedicated as highways over the Land.
4. No ways have been dedicated by the Company over the Land since the statement date of 4 March 1998 referred to in paragraph 3 above and at the present time the Company has no intention of dedicating any public rights of way over the Land.

AND I make this solemn declaration conscientiously believing the same to be true and by virtue of the Statutory Declaration Act 1835

Declared at St. Peter Jersey

.....  
J .....

this ~~seventh~~ day of April 1998  
Before me

G. [Signature]

Solicitor/~~Commissioner for Oaths~~

---

Du Parcq (Jersey) Ltd  
land at Harpenden, Hertfordshire

---

"JML1"

---

This is the exhibit marked "JML1" referred to in  
paragraph 2 of the statutory declaration of

sworn this *seventh* day of *April* 1998

before me:

*[Signature]*  
Solicitor/Commissioner for Oaths

**KJD**  
Kent Jones and Done

SECRET

ANCE SURVEY  
REFERENCE

TL1413 TL1414 TL1513 TL1514 TL1613 TL1614

Scale  
1/2500

INSTRATIVE AREA

HERTFORDSHIRE: ST ALBANS

© Green copyright

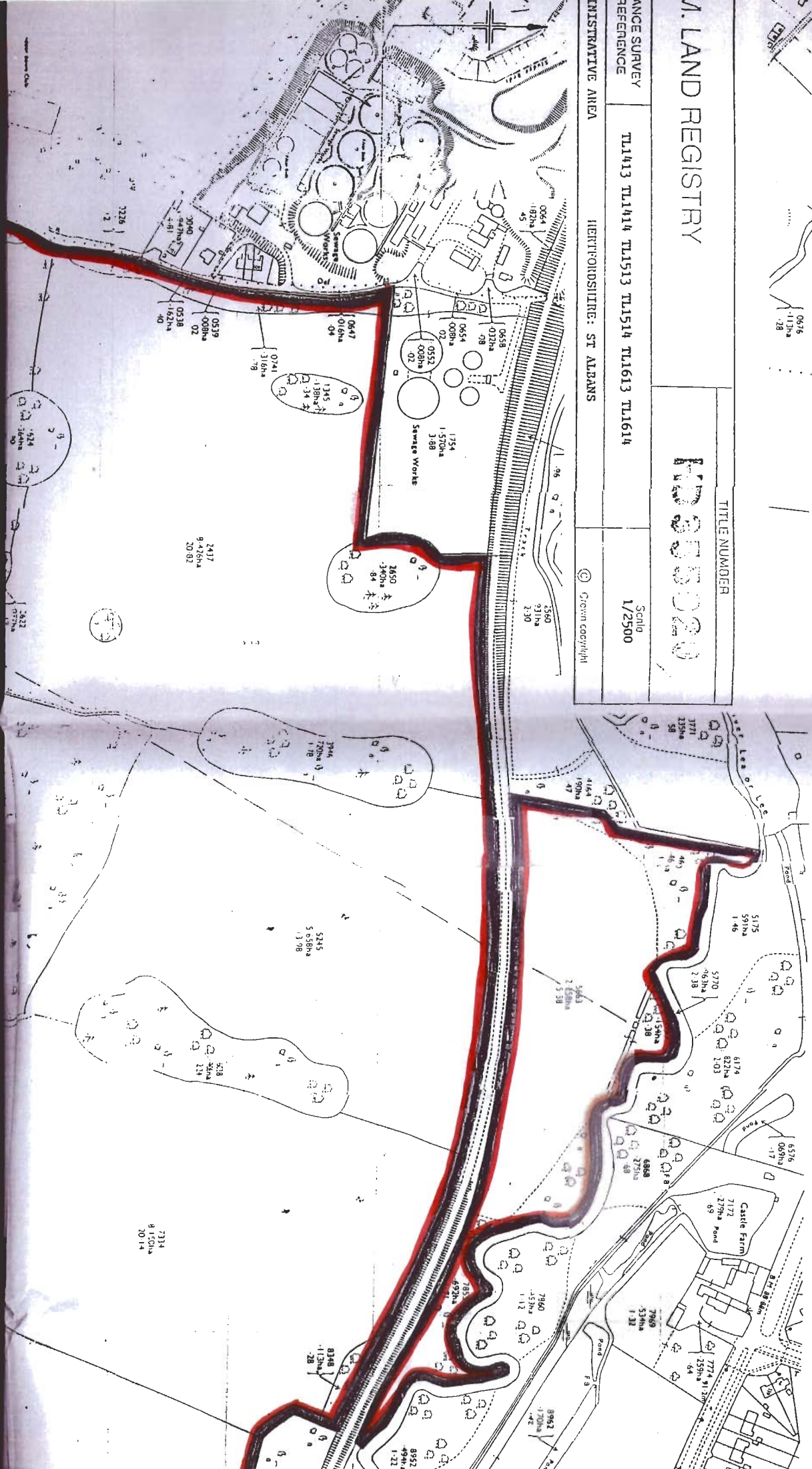



TITLE NUMBER	
HD 355020	
513 TL1614	Scotio 1/2500
BANS	
© Crown copyright	

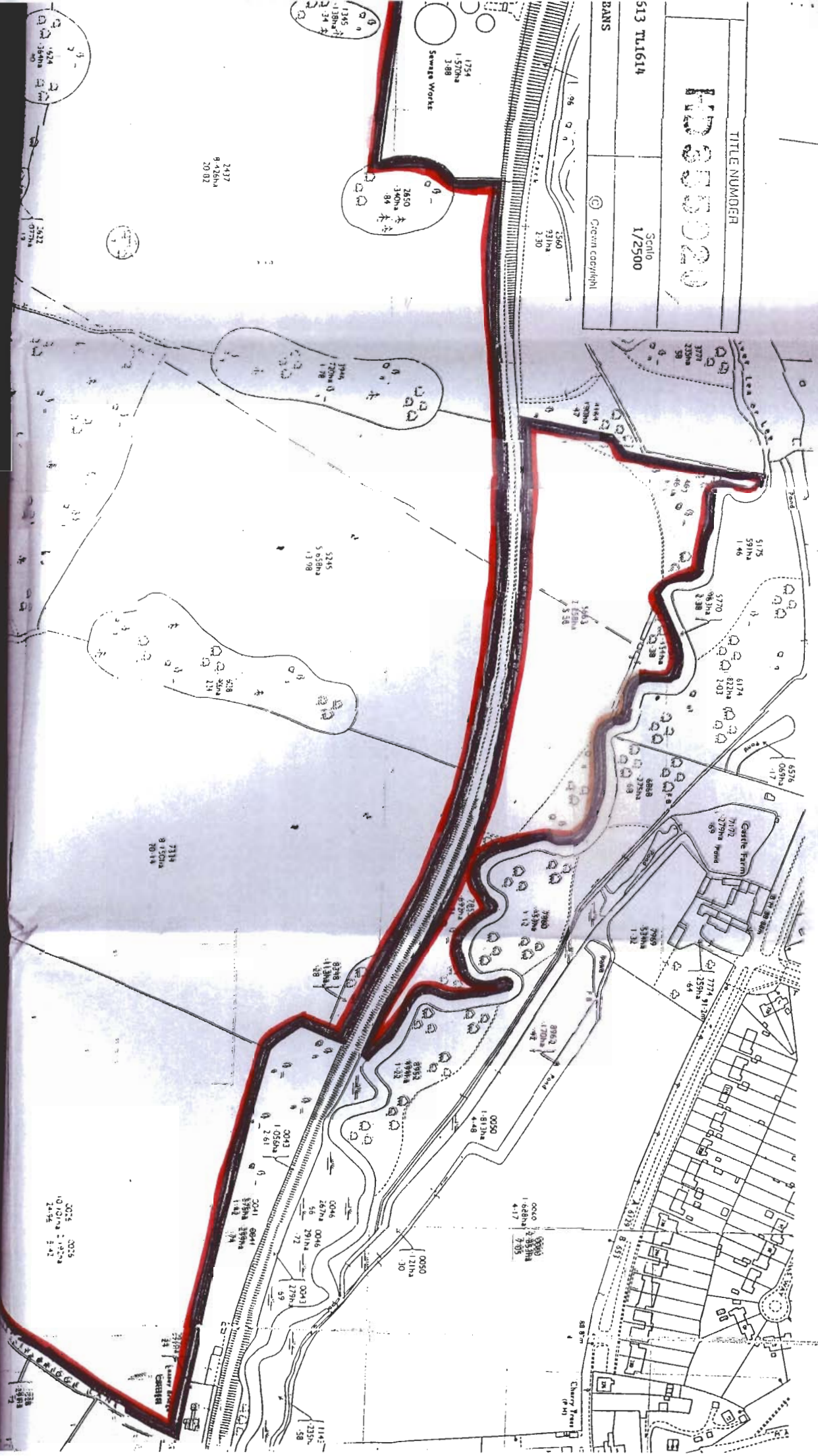



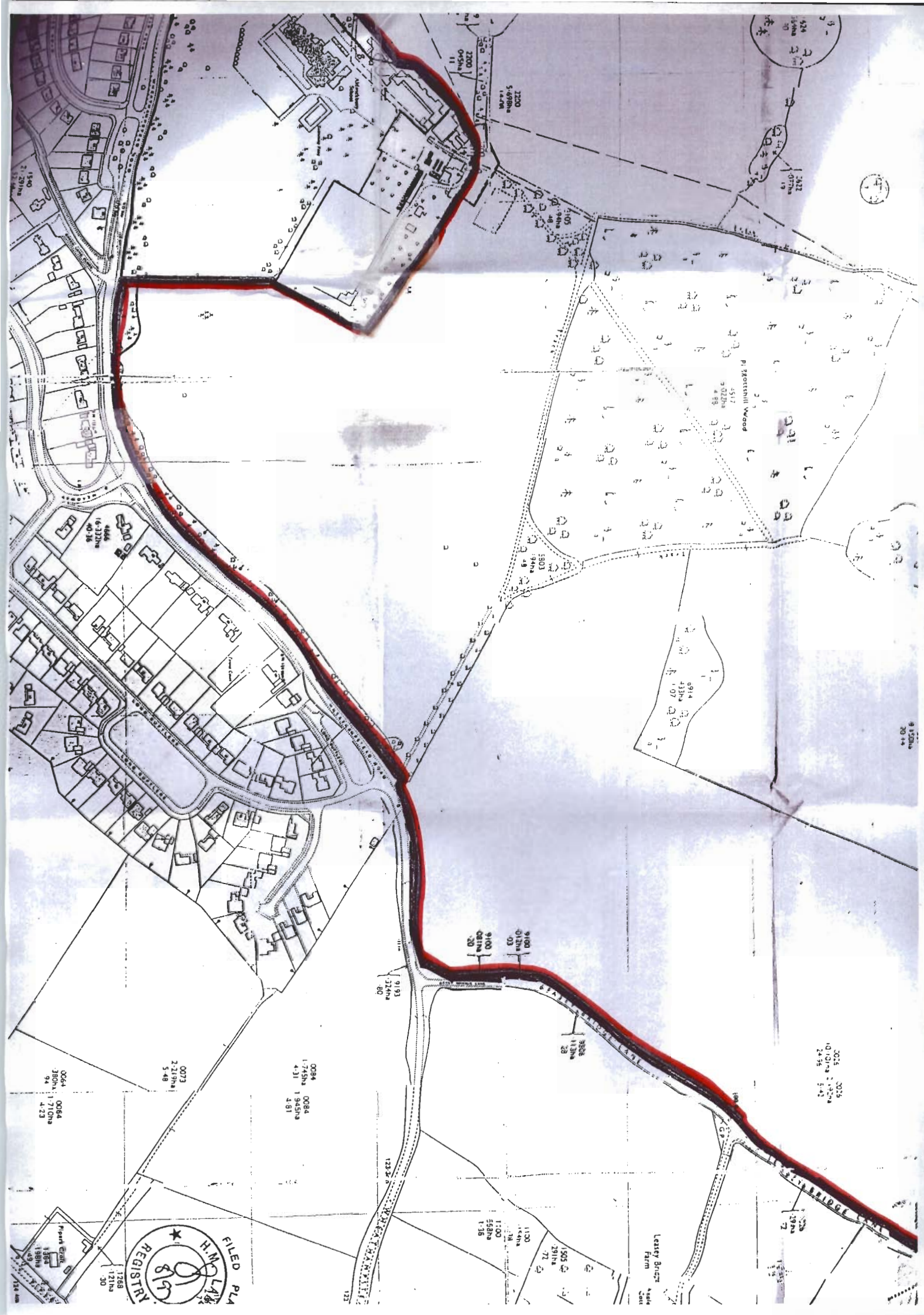



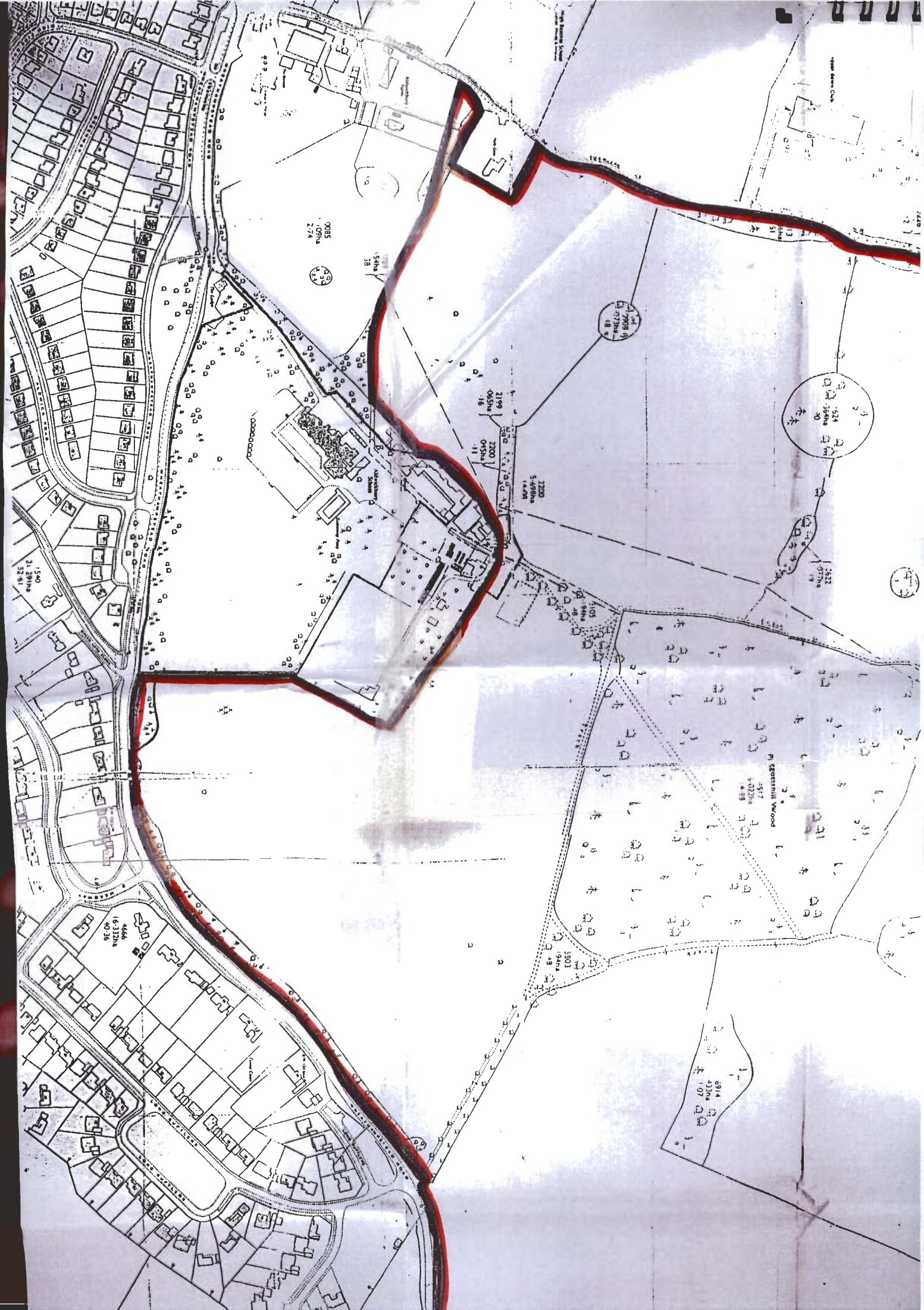



133/3/20

---

Dated 7<sup>TH</sup> APRIL 1998

The Trustees of The Aldwickbury Settlement  
land at Harpenden, Hertfordshire

---

STATUTORY DECLARATION  
of  
pursuant to section 31(6) of the Highways Act 1980

---

KJD  
Kent Jones and Done

I, [redacted], of [redacted], do solemnly and sincerely declare that:

1. I am one of the two Trustees of the Aldwickbury Settlement ("the Trustees"). I am duly authorised to make this declaration on behalf of the Trustees in connection with a deposit of statement and map pursuant to section 31(6) of the Highways Act 1980.
2. The Trustees are the owners of the land at Harpenden ("the Land") shown for identification purposes only edged red on the plan now produced and shown to me and marked "JML1" which is to the best of my knowledge and belief accurate.
3. On 10 March 1998 the Trustees (through Kent Jones and Done Solicitors) deposited with Hertfordshire County Council, being the appropriate Council, a statement dated 4 March 1998 accompanied by a map identifying the Land by red edging which stated that the ways shown coloured purple on the said map and the plan at "JML1" had been dedicated as footpaths over the Land and that no other ways had been dedicated as highways over the Land.
4. No additional ways have been dedicated over the Land since the statement dated 4 March 1998 referred to in paragraph 2 above and at the present time the Trustees have no intention of dedicating any more public rights of way over the Land.

AND I make this solemn declaration conscientiously believing the same to be true and by virtue of the Statutory Declarations Act 1835.

Declared at St. Peter Jersey /      /  
.....  
J .....

this seventh day of April 1998  
Before me

C. I.  
Solicitor/~~Commissioner for Oaths~~



---

The Trustees of The Aldwickbury Settlement  
land at Harpenden, Hertfordshire

---

"JML1"

---

This is the exhibit marked "JML1" referred to in  
paragraphs 2 and 3 of the statutory declaration of  
sworn this *seventh* day of *April*  
1998 before me:



Solicitor/Commissioner for Oaths

**KJD**  
Kent Jones and Done

This OFFICE COPY shows the state of the title plan on 7.10.97  
 under s.113 of the Land Registration Act 1925 this copy is admissible in evidence to the same extent as the original.  
 This office copy of the title plan may be subject to minor distortions in scale.  
 Issued on 8.10.97 by HM Land Registry. This title is administered by the Stevenage District Land Registry.  
 Crown Copyright. All rights reserved.

H.M. LAND REGISTRY

TITLE NUMBER

HD 139936

ORDNANCE SURVEY  
 PLAN REFERENCE

TL614-1714, 1613-1713, TL1413, TL1414, TL1513, TL1514

Scale  
 1/2500

COUNTY HERTFORDSHIRE

DISTRICT ST ALBANS

© Crown copyright

