

REGISTER OF DEPOSITS

- **HIGHWAYS ACT 1980***

☒

- **COMMONS ACT 2006***

☒

(* tick if applicable or specify N/A)

DETAILS OF APPLICATION

Date Application received in prescribed form 21/11/17

Date by which any subsequent highways
declaration must be lodged 20/11/37

Parcel

District St Albans
Parish Harpenden and Wheathampstead

Address and postcode of buildings
on each piece of land subject to the
application to which a postcode has
been assigned Land east of Common Lane
Lower Harpenden Road
Harpenden
AL5 5AF

Nearest town/city to above Harpenden

OS 6 figure Grid Reference(s)
for a point within the area of the land
(if possible for postcode point above) TL 155 155



NOTICE OF LANDOWNER DEPOSITS under
Section 31(6) of the Highways Act 1980 and
Section 15A(1) of the Commons Act 2006
HERTFORDSHIRE COUNTY COUNCIL

An application to deposit a map and statement under section 31(6) of the Highways Act 1980 and deposit a statement under section 15A(1) of the Commons Act 2006 has been made in relation to the land (or lands) described below and shown edged red on the accompanying map.

PLEASE NOTE:

This deposit may affect rights over the land described below. Deposits made under section 31(6) of the Highways Act 1980 may prevent deemed dedication of public rights of way over such land under section 31(1) of that Act. Deposits made under section 15A(1) of the Commons Act 2006 may affect the ability to register such land as a town or village green under section 15 of that Act. For further information please see guidance at <https://www.gov.uk/guidance/town-and-village-greens-how-to-register>

Description of the land:

Land east of Common Lane, Lower Luton Road, Harpenden, AL5 5AF

Name of the parish, ward or district in which the land is situated:

St Albans district, Harpenden and Wheathampstead parishes

The deposit was submitted by Lambert Smith Hampton on behalf of Hertfordshire County Council and was received by this authority on 21st November 2017.

The authority maintains a register of maps, statements and declarations deposited under section 31A of the Highways Act 1980 and section 15B of the Commons Act 2006. This register can be accessed online at www.hertfordshire.gov.uk/landownerdeposits or can be inspected free of charge at Hertfordshire County Council, County Hall, Pegs Lane, Hertford, Hertfordshire, SG13 8DN during office hours between 9:00am and 5:00 pm

Signed on behalf of Hertfordshire County Council:

Name and position of Signatory: R. Cuthbert Team Leader Access & Rights of Way

Date: 22nd November 2017

PART A

Information relating to the Applicant and Land to which the Application relates

(all applicants must complete this part)

- 1 Name of appropriate authority to which the application is addressed:

Hertfordshire County Council

- 2 Name and full address (including postcode) of applicant:

Name: **Richard Fyfe**

Address: **Lambert Smith Hampton,**

45 Grosvenor Rd,

St Albans,

Herts

Postcode: **AL1 3AW**

- 3 Status of applicant (tick relevant box or boxes):

I am

(a) ☐

the owner of the land(s) described in paragraph 4.

(b) ☒

making this application and the statements/declarations it contains on behalf of Hertfordshire County Council who is the owner of the land(s) described in paragraph 4 and in my capacity as Estates Consultant to the County Council.

- 4 Insert description of the land(s) to which the application relates (including full address and postcode):

Description of Land(s):

Land at Lower Luton Road, Harpenden

Full address:

Land east of Common Lane, North of Lower Luton Road Harpenden

Postcode

AL5 5AF

- 5 Ordnance Survey six-figure grid reference(s) of a point within the area of land(s) to which the application relates (if known):

Plan EM14883 – OS Grid Ref: TL155155

- 6 This deposit comprises the following statement(s) and/or declarations (*tick relevant box or boxes*):

PART B ☒

PART C ☐

PART D ☒

(delete Parts B, C or D from the form below where not applicable):

PART B

Statement under section 31(6) of the Highways Act 1980

Hertfordshire County Council is the owner of the land described in paragraph 4 of Part A of this form and shown edged red on the maps accompanying this statement.

(delete wording in square brackets as appropriate and/or insert information as required)

No ways over the land shown edged red on the accompanying plan have been dedicated as highways.

**Statement
under section 15A(1) of the Commons Act 2006**

Hertfordshire County Council is the owner of the land described in paragraph 4 of Part A of this form and shown edged red on the maps accompanying this statement on the 14th November 2017.

This application is made by Richard Fyfe of Lambert Smith Hampton as agent for the landowner and on its behalf.

Hertfordshire County Council wishes to bring to an end any period during which persons may have indulged as of right in lawful sports and pastimes on the whole or any part of the land shown edged red on the accompanying maps referenced above.

For the avoidance of doubt, the referenced plan is EM14883.

(delete wording in square brackets as appropriate and/or insert information as required)

PART F

Statement of Truth

(all applicants must complete this part)

WARNING: If you dishonestly enter information or make a statement that you know is, or might be, untrue or misleading, and intend by doing so to make a gain for yourself or another person, or to cause loss or the risk of loss to another person, you may commit the offence of fraud under section 1 of the Fraud Act 2006, the maximum penalty for which is 10 years' imprisonment or an unlimited fine, or both.

I BELIEVE THAT THE FACTS AND MATTERS CONTAINED IN THIS FORM ARE TRUE

Signature:

Date: **20.11.17**

J

(of the person making the statement of truth)

Print Name: **Richard Fyfe**

You should keep a copy of the completed form

Data Protection Act 1998

Fair Processing Notice

The purpose of this Fair Processing Notice is to inform you of the use that will be made of your personal data, as required by the Data Protection Act 1998.

The appropriate authority (see explanation of definition in above guidance notes) in England is the data controller in respect of any personal data that you provide when you complete this form.

The information that you provide will be used by the appropriate authority in its duties to process applications to deposit statements, maps and declarations under section 31(6) the Highways Act 1980 and statements under section 15A(1) of the Commons Act 2006. The information you provide will also be used by the appropriate authority in its duty to upgrade the registers in which details of such deposits are recorded under the Dedicated Highways (Registers under Section 31A of the Highways Act 1980 (England) Regulations 2007 and the Commons (Registration of Town or Village Greens) and Dedicated Highways (Landowner Statements and Declarations) (England) Regulations 2013.

The appropriate authority is required by the legislation above to maintain a register which holds information provided in this form, which can be inspected online or in person by members of the public on request. It may also be required to release information, including personal data and commercial information, on request under the Environmental Information Regulations 2004 or the Freedom of Information Act 2000. However, the appropriate authority will not permit any unwarranted breach of confidentiality nor will they act in contravention of their obligations under the Data Protection Act 1998.

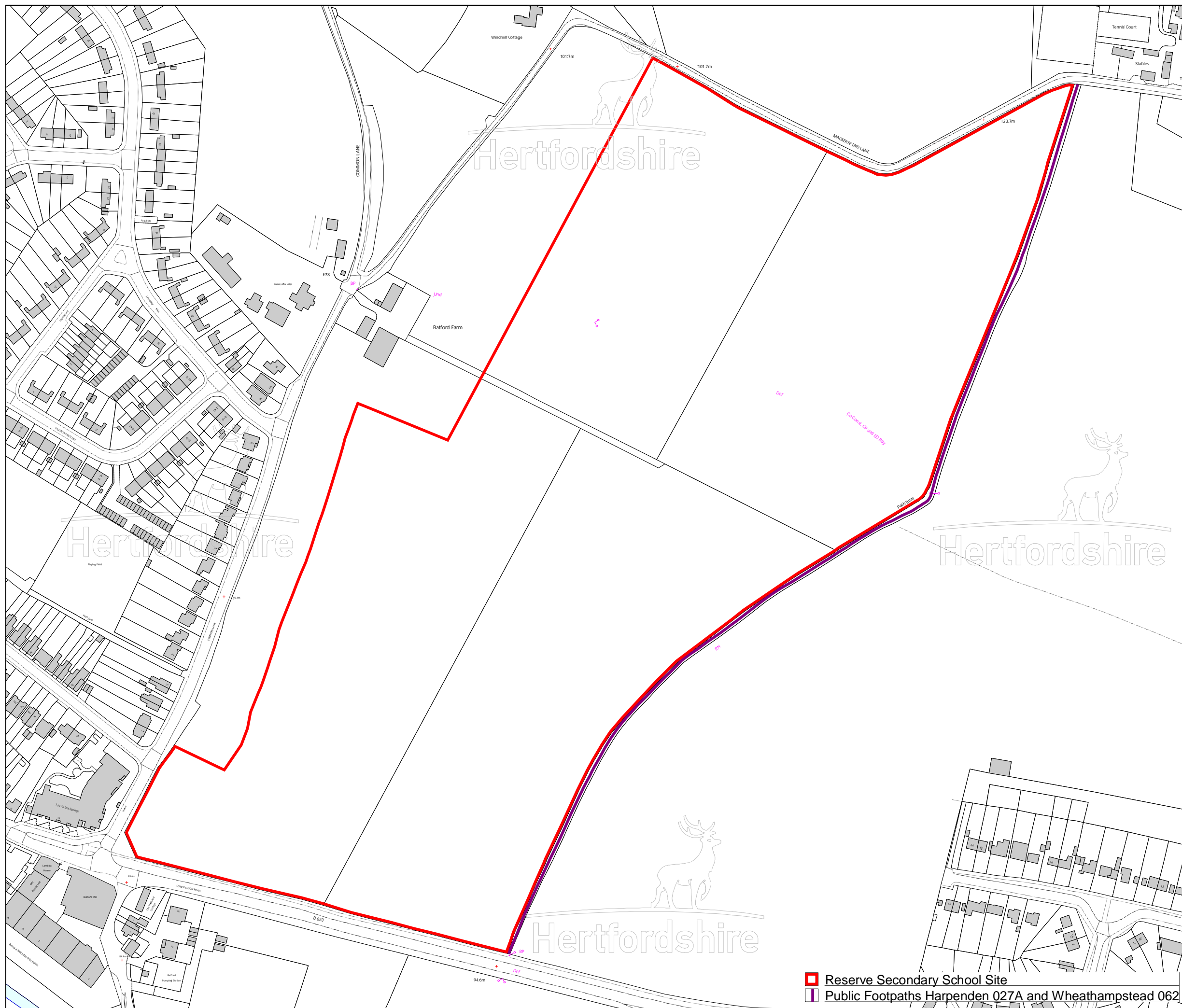

© Crown copyright and database rights 2017 Ordnance Survey 100019606
You are not permitted to copy, sub-licence, distribute or sell any of this data to third parties in any form



**Lambert
Smith
Hampton**



PROJECT Reserve Secondary
School Site
Lower Luton Road
Harpenden

DRAWING TITLE

Land Owner
Deposit Statement

DRAWN	Jo-Ann Burke
CHECKED	
DATE	16/11/2017
SCALE	1:2500@A

PLAN NO.	REVISION
----------	----------

OS GRID: TL1515 16/11/20

☒ Reserve Secondary School Site

☐ Public Footpaths Harpenden 027A and Wheathampstead 062