

**DEPOSIT OF STATEMENT AND MAP  
SECTION 31(6) HIGHWAYS ACT 1980**

To: Hertfordshire County Council

1. I am and have been since 10<sup>th</sup> August 2007 the owner, within the meaning of the above section of the Highways Act 1980, of the land known as Ponsfall Farm, Newgate Street Village, Near Hertford, Hertfordshire SG13 8NH more particularly delineated on the map reference 0158-FP/JDRS.01.12 accompanying this statement and thereon edged red.
2. The afore mentioned land lies predominately in the parish of Hatfield in the county of Hertfordshire.
3. Way coloured purple on the said map is a public footpath. It is possible to get through between points 'E' - 'F' with minor deviations. An alternative route has been provided whilst a formal diversion is sought.
4. No other ways over the land have been dedicated as highways.
5. The deposit shall comprise this statement and the accompanying map.

Signed:  ..... (Landowner)

Name: Mr John Douglas Robinson-Sawyer

Address: Ponsfall Farm, Newgate Street, Hertford, Herts, SG13 8NH

Date: 7<sup>th</sup> March 2013

Signed: ..... (Witness)

Address: .....

Occupation: Surveyor

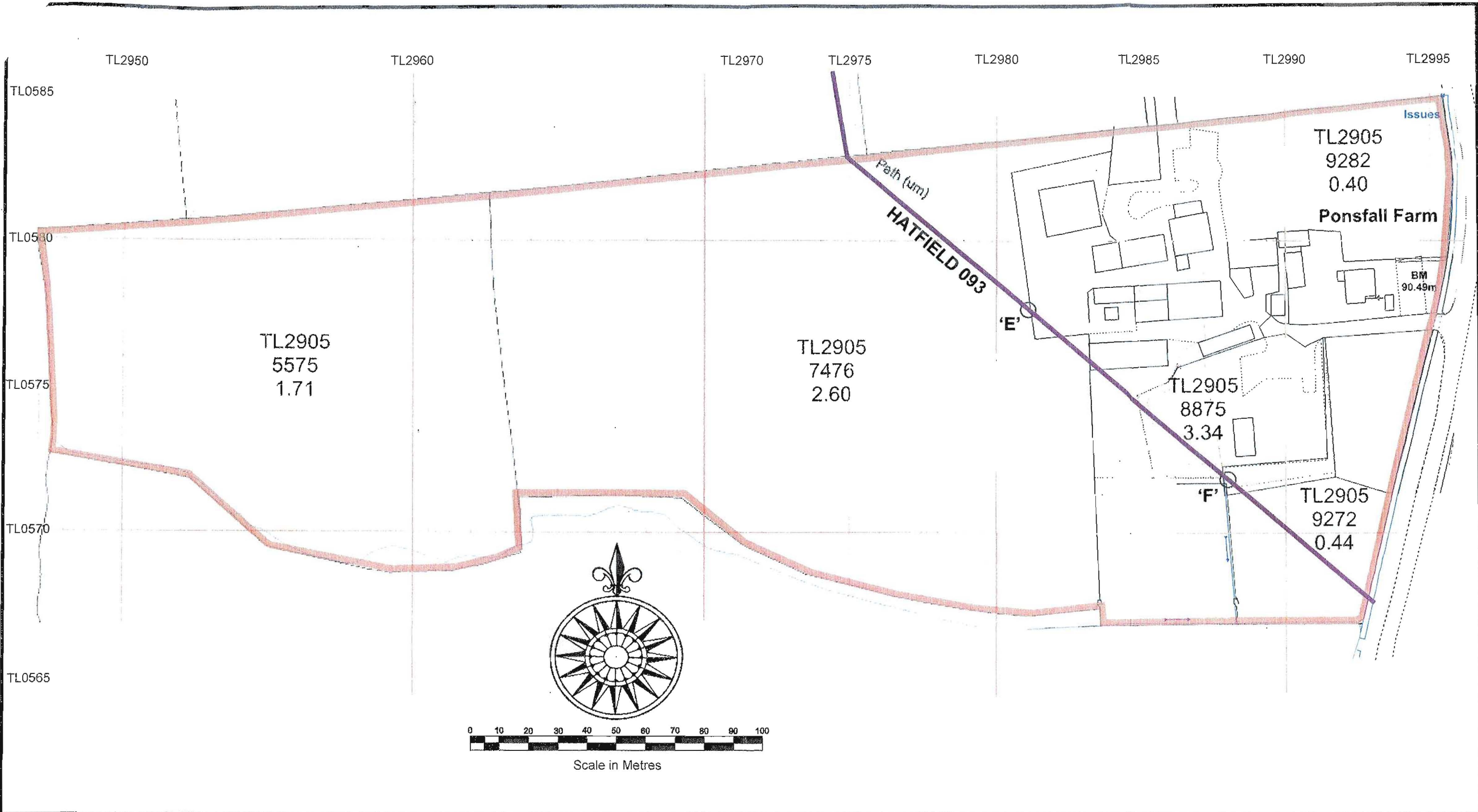

**RIGHTS OF WAY  
AT  
PONSFALL FARM  
NEWGATE STREET VILLAGE  
HERTFORD HERTS SG13 8NH  
FOR  
J D ROBINSON SAWYER**

**Notes:**  
 PUBLIC FOOTPATH

Date: 06:03:2012	File Ref: DRF/JDRS
Scale: 1/1,250	Rev:
DRAWING No. 0158-FP/JDRS.01.12	

**Revisions:**



18 Lee Close  
Hertford  
Herts  
SG13 8HN  
Tel: 01992 552746  
Mob: 07972 032514  
David.R.Franklin@hotmail.co.uk  
Website: drfranklin.co.uk

# STATUTORY DECLARATION

## SECTION 31(6) OF THE HIGHWAYS ACT 1980

I JOHN DOUGLAS ROBINSON-SAWYER DO SOLEMNLY AND SINCERELY DECLARE as follows:

1. I am and have been since 10<sup>th</sup> August 2007 the owner of the land known as Ponsfall Farm, Newgate Street Village, Near Hertford, Hertfordshire SG13 8NH more particularly delineated on the map reference 0158-FP/JDRS.01.12 accompanying this declaration and thereon edged red.
2. On the 7<sup>th</sup> day of March 2013 I deposited with Hertfordshire County Council, being the appropriate Council, a statement accompanied by a map delineating my property by red edging which stated that the way coloured purple on the said map and on the map accompanying this declaration had been dedicated as a public footpath. It is possible to get through between points 'E'-'F' with some minor deviations. An alternative route has been provided whilst a formal diversion is sought. No other ways have been dedicated as highways over my property.
3. No additional ways have been dedicated over the land edged red on the map accompanying this declaration since the statement dated 7<sup>th</sup> March 2013 referred to in (2) above other than the footpath marked in the appropriate colour on the map accompanying this declaration and at the present time I have no intention of dedicating any more public rights of way over my property.

AND I MAKE this solemn declaration on the 29<sup>th</sup> day of ~~April~~<sup>May</sup> 2013 conscientiously believing it to be true and by virtue of the Statutory Declarations Act 1835.

**Declared at**

2nd Floor Stag House

Old London Road

Hertford

Hertfordshire

SG13 7LA

Breeze & Wyles Solicitors LLP  
2nd Floor, Stag House  
Old London Road  
Hertford  
SG13 7LA

**Signed** .....

(J. D. Robinson-Sawyer - Landowner)

**Before me**

..... (Solicitor)

29/5/2013

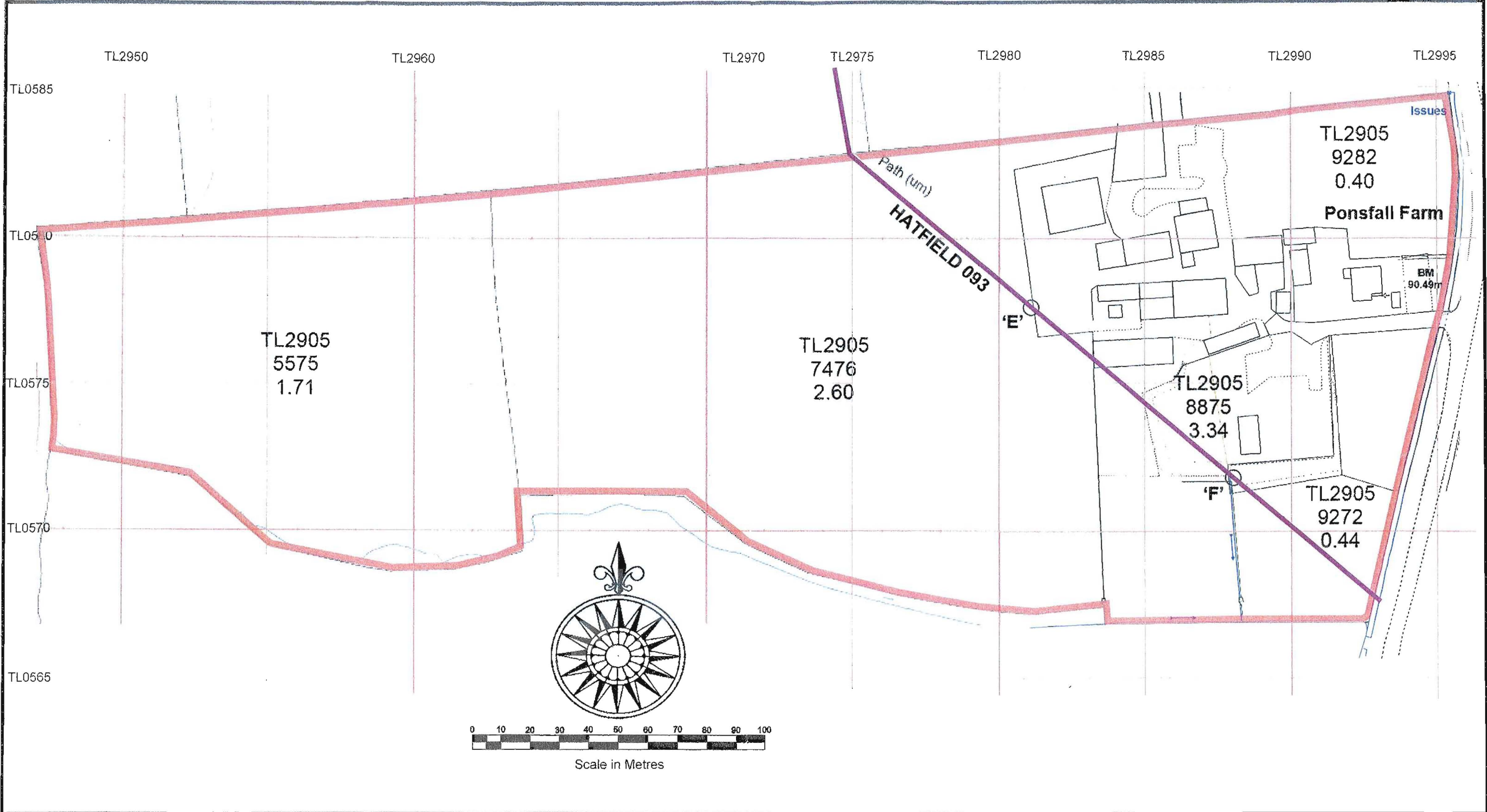

Breeze & Wyles Solicitors LLP  
 2nd Floor, Stag House  
 Old London Road  
 Hertford  
 SG13 7LA

29/5/13  
 Plan returned to in  
 Statutory declaration  
 date 29/5/13 of ...

**RIGHTS OF WAY  
 AT  
 PONSFALL FARM  
 NEWGATE STREET VILLAGE  
 HERTFORD HERTS SG13 8NH  
 FOR  
 J D ROBINSON SAWYER**

**Notes:**  
 PUBLIC FOOTPATH

**Revisions:**

Date: 06:03:2012 File Ref: DRF/JDRS  
 Scale: 1/1,250 Rev:  
 DRAWING No. 0158-FP/JDRS.01.12



18 Lee Close  
 Hertford  
 Herts  
 SG13 8HN  
 Tel: 01992 552746  
 Mob: 07972 032514  
 David.R.Franklin@hotmail.co.uk  
 Website: drfranklin.co.uk