

REGISTER OF DEPOSITS- **HIGHWAYS ACT 1980***- **COMMONS ACT 2006***

(* tick if applicable or specify N/A)

DETAILS OF APPLICATION

Date Application received in prescribed form 17/07/17

Date by which any subsequent highways
declaration must be lodged 16/07/37**Parcel**

District North Herts Parish Braughing, Hormead

Address and postcode of buildings
on each piece of land subject to the
application to which a postcode has
been assigned Mutfords Farm
Hare Street
Buntingford
SG11 2QX

Nearest town/city to above Buntingford

OS 6 figure Grid Reference(s)
for a point within the area of the land TL 402 276

District North Herts Parish Hormead

Address and postcode of buildings
on each piece of land subject to the
application to which a postcode has
been assigned Land off Anderson's Lane
Great Hormead
Buntingford
SG9 0NY

Nearest town/city to above Buntingford

OS 6 figure Grid Reference(s)
for a point within the area of the land TL 398 306

District	North Herts	Parish	Anstey
Address and postcode of buildings on each piece of land subject to the application to which a postcode has been assigned		Land south of Northey Wood Anstey Buntingford SG9 0TJ	
Nearest town/city to above		Buntingford	
OS 6 figure Grid Reference(s) for a point within the area of the land		TL 397 329	

District	North Herts	Parish	Anstey
Address and postcode of buildings on each piece of land subject to the application to which a postcode has been assigned		Land at Lincoln Hill Anstey Buntingford SG9 0DL	
Nearest town/city to above		Buntingford	
OS 6 figure Grid Reference(s) for a point within the area of the land		TL 400 324	

District	North Herts	Parish	Barley
Address and postcode of buildings on each piece of land subject to the application to which a postcode has been assigned		Land to rear of Abbotsbury Cottage Barley Buntingford SG8 8LP	
Nearest town/city to above		Buntingford	
OS 6 figure Grid Reference(s) for a point within the area of the land		TL 380 346	

District	North Herts	Parish	Barkway
Address and postcode of buildings on each piece of land subject to the application to which a postcode has been assigned		Land off Buckland Road Barkway Buntingford SG8 8EY	
Nearest town/city to above		Buntingford	
OS 6 figure Grid Reference(s) for a point within the area of the land		TL 380 346	



NOTICE OF LANDOWNER DEPOSITS under
Section 31(6) of the Highways Act 1980
HERTFORDSHIRE COUNTY COUNCIL

An application to deposit a map and statement under section 31(6) of the Highways Act 1980 has been made in relation to the land (or lands) described below and shown edged red on the accompanying map.

PLEASE NOTE:

This deposit may affect rights over the land described below. Deposits made under section 31(6) of the Highways Act 1980 may prevent deemed dedication of public rights of way over such land under section 31(1) of that Act. Deposits made under section 15A(1) of the Commons Act 2006 may affect the ability to register such land as a town or village green under section 15 of that Act. For further information please see guidance at <https://www.gov.uk/guidance/town-and-village-greens-how-to-register>

Description of the land:

Mutfords Farm, Hare Street, SG11 2QX
Land off Anderson's Lane, Great Hormead, SG9 0NY
Land south of Northey Wood, Anstey, SG9 0TJ
Land at Lincoln Hill, Anstey, SG9 0DL
Land to rear of Abbotsbury Cottage, Barley, SG8 8LP
Land off Buckland Road, Barkway, SG8 8EY

Name of the parish, ward or district in which the land is situated:

North Herts district

The deposit was submitted by Weldon Beesly on behalf of NCP (UK) Ltd and was received by this authority on 17th July 2017.

The authority maintains a register of maps, statements and declarations deposited under section 31A of the Highways Act 1980 and section 15B of the Commons Act 2006. This register can be accessed online at www.hertfordshire.gov.uk/landownerdeposits or can be inspected free of charge at Hertfordshire County Council, County Hall, Pegs Lane, Hertford, Hertfordshire, SG13 8DN during office hours between 9:00am and 5:00 pm

Signed on behalf of Hertfordshire County Council:

Name and position of Signatory: R. Cuthbert Team Leader Access & Rights of Way

Date: 18th July 2017

PART A

Information relating to the Applicant and Land to which the Application relates

(all applicants must complete this part)

1 Name of appropriate authority to which the application is addressed:
Hertfordshire County Council

2 Name and full address (including postcode) of applicant:

Name: Charlotte Balaam
Address: Weldon Beesly
100 South Street
Bishop's Stortford
Hertfordshire
Postcode: CM23 3BG

Hertfordshire County Council

RECEIVED

Date: 17th July 2017

3 Status of applicant (tick relevant box or boxes):

I am

- (a) the owner of the land(s) described in paragraph 4.
(b) making this application and the statements/declarations it contains for and on behalf of Weldon Beesly Ltd on behalf of NHP (UK) Limited who is the owner of the land described in paragraph 4 and in my capacity as land agent (Chartered Surveyor).

4 Insert description of the land(s) to which the application relates (including full address and postcode):

See accompanying table

5 Ordnance Survey six-figure grid reference(s) of a point within the area of land(s) to which the application relates (if known):

See accompanying table

6 This deposit comprises the following statement(s) and/or declarations (tick relevant box or boxes):

PART B
PART C
PART D

(delete Parts B, C or D from the form below where not applicable):

PART B

Statement under section 31(6) of the Highways Act 1980

NHP (UK) Limited is the owner of the land described in paragraph 4 of Part A of this form and shown edged in red on the map accompanying this statement.

Ways shown black on the accompanying map are restricted byways

Ways shown green on the accompanying map are public bridleways

Ways shown purple on the accompanying map are public footpaths

No other ways over the land shown on the accompanying map have been dedicated as highways

Application Form for Deposits under

- section 31(6) of the Highways Act 1980 and
- section 15A(1) of the Commons Act 2006

Owners – NHP (UK) Limited

Questions 4 & 5

4. Description	4. Address	4. Postcode	5. Grid ref
Mutfords Farm	Hare Street, Buntingford	SG9 0EF	TL393287
		SG11 2QX	TL402276
		SG11 2QY	TL411271
		SG11 2QX	TL412268
		SG11 2RE	TL404261
Land at Anstey	Anstey, Buntingford	SG9 0NY	TL398306
		SG9 0TJ	TL397329
		SG9 0DL	TL400324
Land to rear of Abbotsbury Cottage	Cokenach Estate, Barkway, Royston	SG8 8LP	TL405371
Land off Buckland Road	Buckland Road, Barkway, Royston	SG8 8EY	TL380346
		SG8 8HA	TL375343
		SG8 8HA	TL377347

PART F

Statement of Truth

(all applicants must complete this part)

WARNING: If you dishonestly enter information or make a statement that you know is, or might be, untrue or misleading, and intend by doing so to make a gain for yourself or another person, or to cause loss or the risk of loss to another person, you may commit the offence of fraud under section 1 of the Fraud Act 2006, the maximum penalty for which is 10 years' imprisonment or an unlimited fine, or both.

I BELIEVE THAT THE FACTS AND MATTERS CONTAINED IN THIS FORM ARE TRUE

Signature

(of the person making the statement or truth)

Date: 14 July 2017

Print Name: Charlotte Balaam MRICS FAAV for and on behalf of
Weldon Beesly Ltd

You should keep a copy of the completed form

Data Protection Act 1998 Fair Processing Notice

The purpose of this Fair Processing Notice is to inform you of the use that will be made of your personal data, as required by the Data Protection Act 1998.

The appropriate authority (see explanation of definition in above guidance notes) in England is the data controller in respect of any personal data that you provide when you complete this form.

The information that you provide will be used by the appropriate authority in its duties to process applications to deposit statements, maps and declarations under section 31(6) the Highways Act 1980 and statements under section 15A(1) of the Commons Act 2006. The information you provide will also be used by the appropriate authority in its duty to upgrade the registers in which details of such deposits are recorded under the Dedicated Highways (Registers under Section 31A of the Highways Act 1980 (England) Regulations 2007 and the Commons (Registration of Town or Village Greens) and Dedicated Highways (Landowner Statements and Declarations) (England) Regulations 2013.

The appropriate authority is required by the legislation above to maintain a register which holds information provided in this form, which can be inspected online or in person by members of the public on request. It may also be required to release information, including personal data and commercial information, on request under the Environmental Information Regulations 2004 or the Freedom of Information Act 2000. However, the appropriate authority will not permit any unwarranted breach of confidentiality nor will they act in contravention of their obligations under the Data Protection Act 1998.

Mutfords farm (1 of 2)

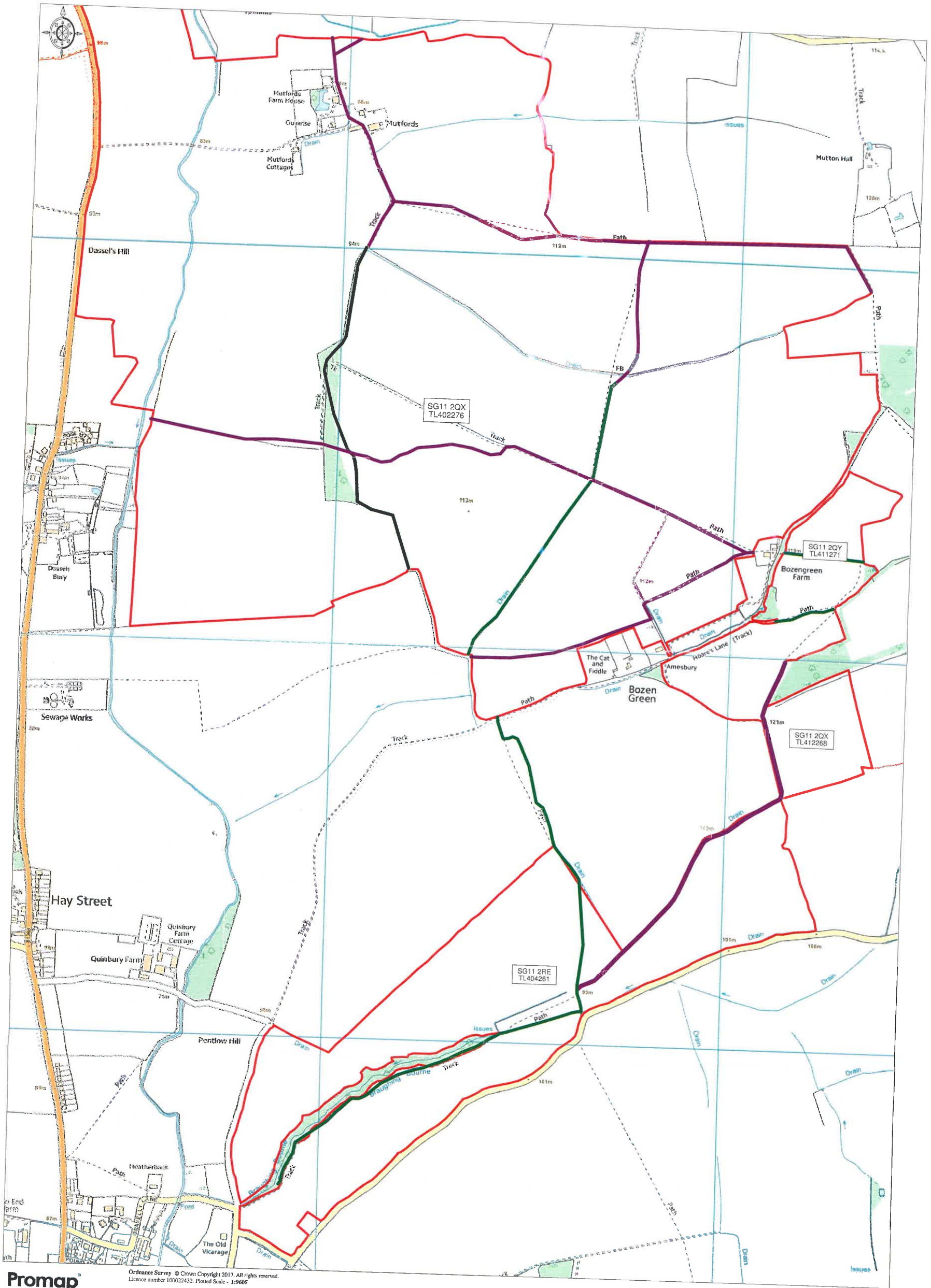

Mutfords Farm (2 of 2)

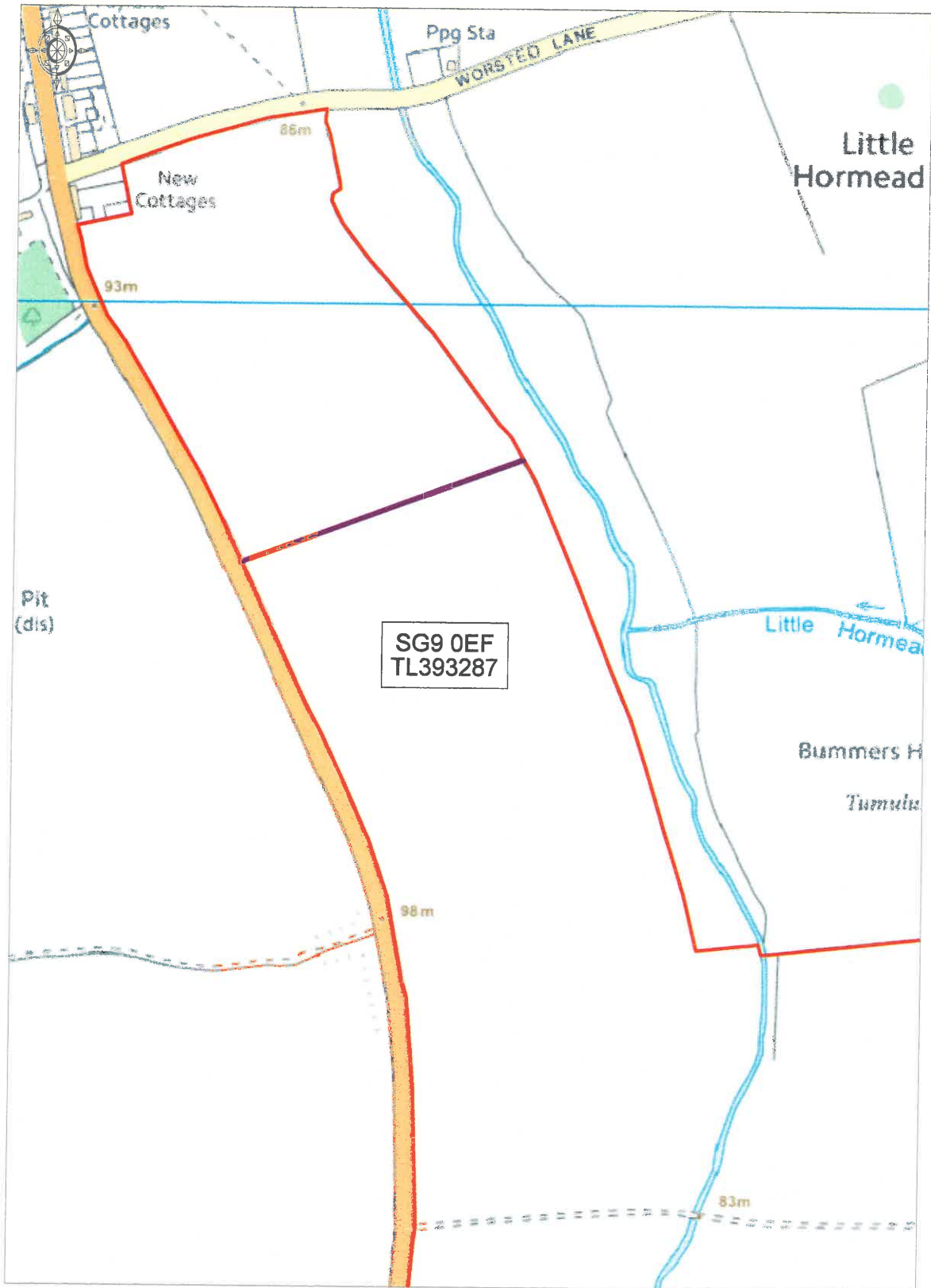

Land at Anstey (1 of 2)

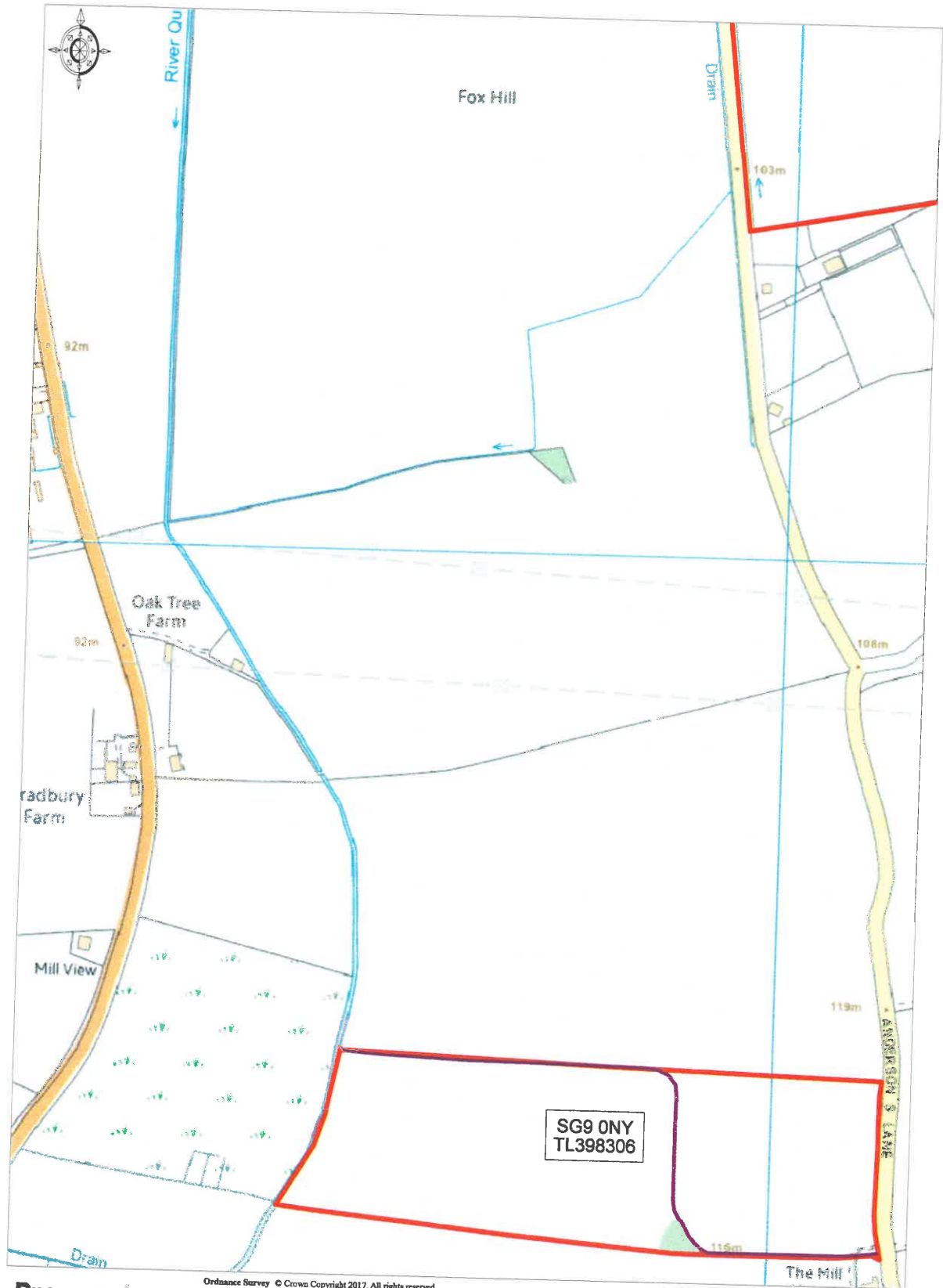

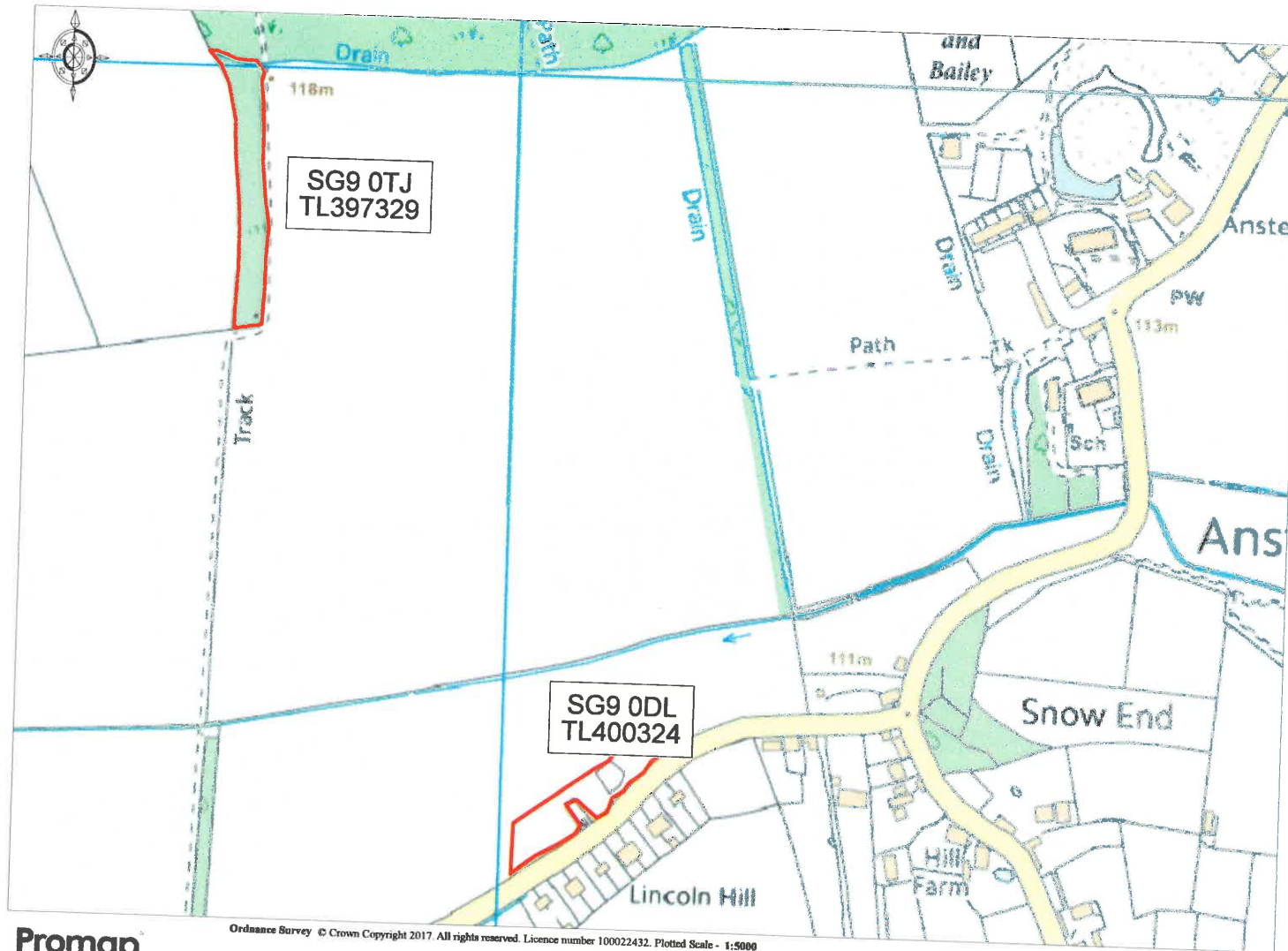

Land at Anster (2 of 2)

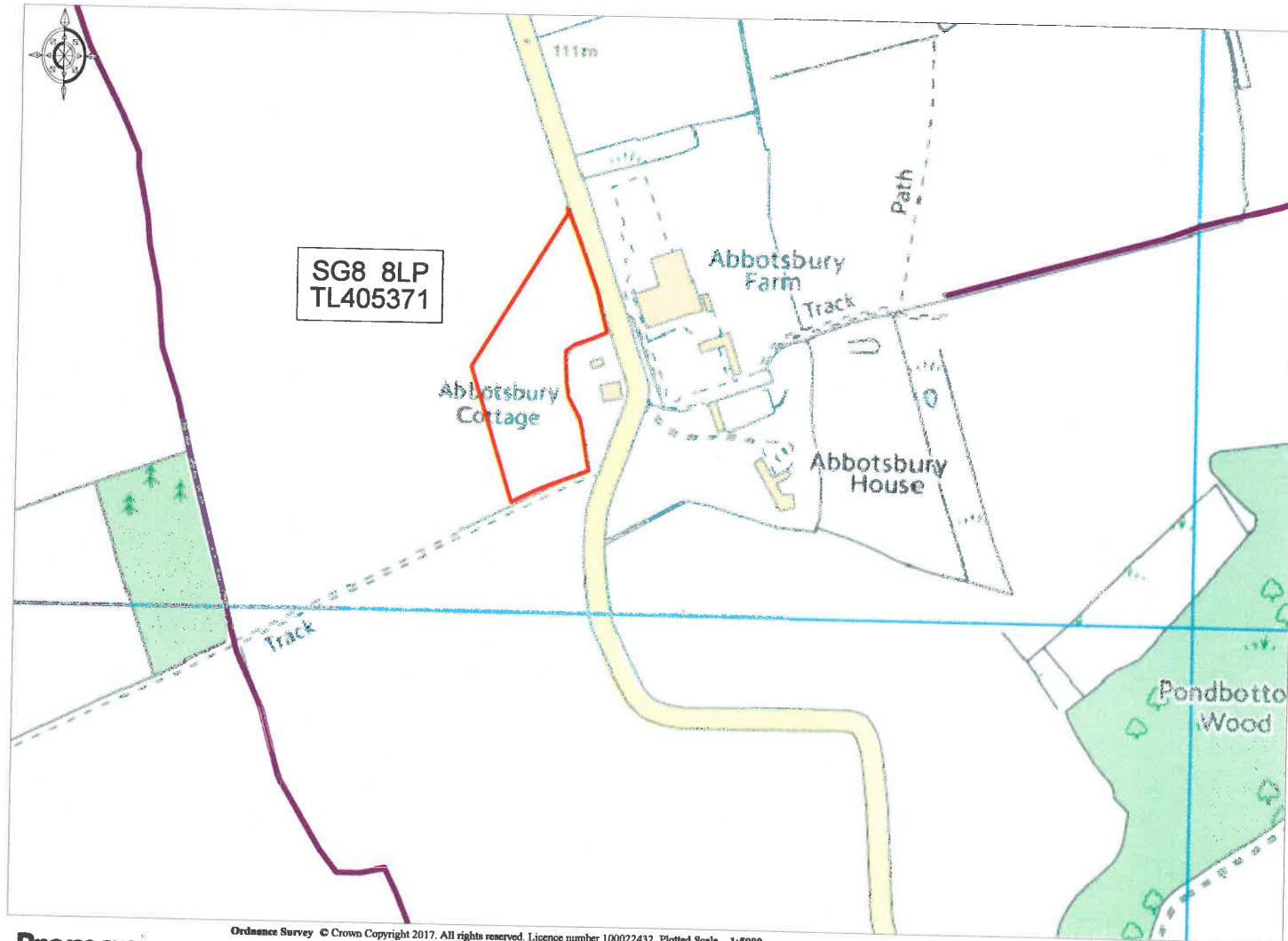

Land at Abbotsbury

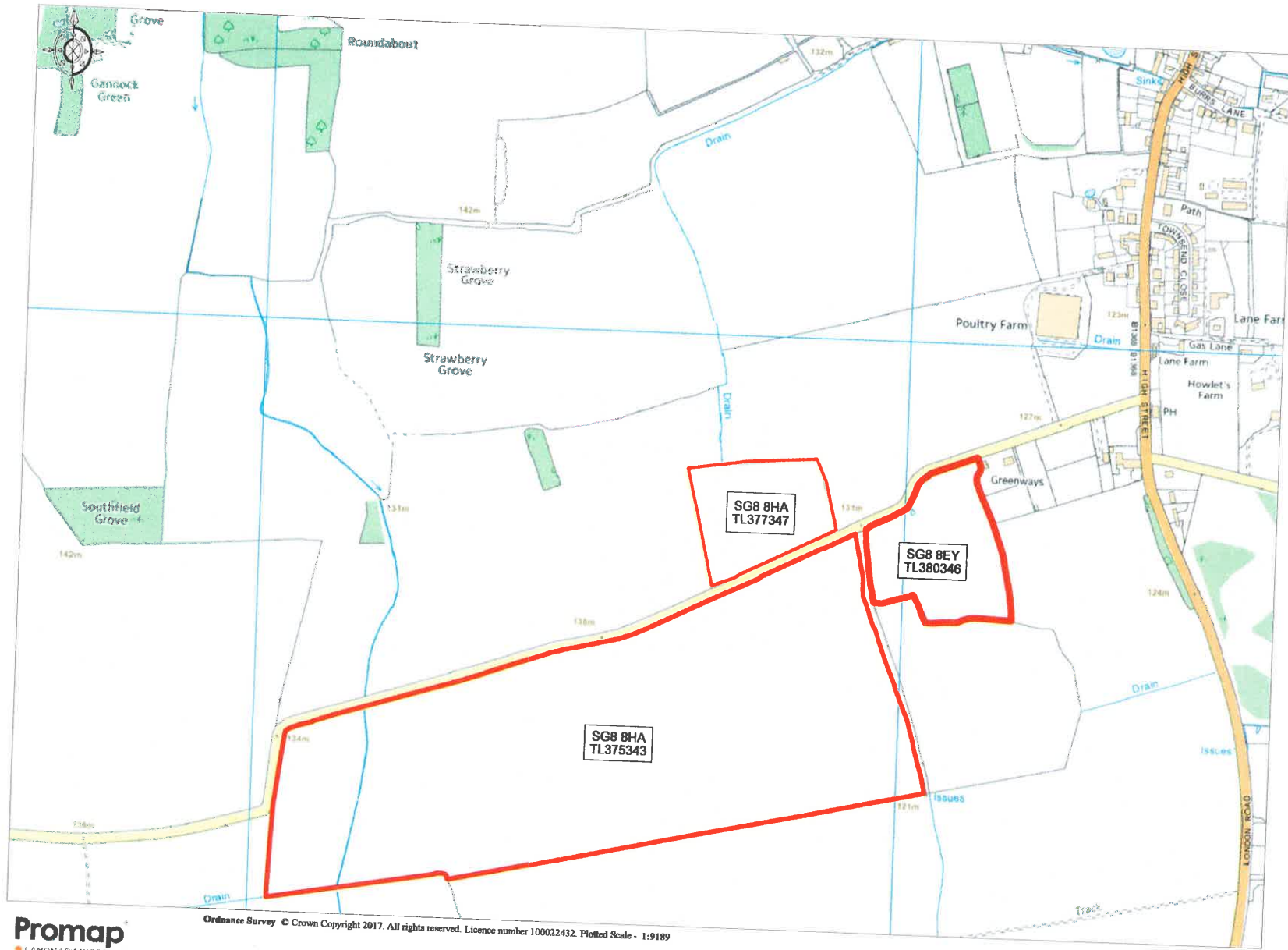

Land off Buckard Road