

REGISTER OF DEPOSITS

- **HIGHWAYS ACT 1980***

☒

- **COMMONS ACT 2006***

☒

(* tick if applicable or specify N/A)

DETAILS OF APPLICATION

Date Application received in prescribed form 11/05/2020

Date by which any subsequent highways
declaration must be lodged 10/05/2040

Parcel

District North Herts

Parish Kimpton

Address and postcode of buildings
on each piece of land subject to the
application to which a postcode has
been assigned

Prior's Wood and Prior's Close
Bibbs Hall Lane, Ayot St Lawrence,
Welwyn, Herts
AL6 9BY

Nearest town/city to above

Welwyn

OS 6 figure Grid Reference(s)
for a point within the area of the land
(*if possible for postcode point above*)

TL 187 171



NOTICE OF LANDOWNER DEPOSITS under
Section 31(6) of the Highways Act 1980 and
Section 15A(1) of the Commons Act 2006
HERTFORDSHIRE COUNTY COUNCIL

An application to deposit a map and statement under section 31(6) of the Highways Act 1980 and deposit a statement under section 15A(1) of the Commons Act 2006 has been made in relation to the land (or lands) described below and shown edged red on the accompanying map.

PLEASE NOTE:

This deposit may affect rights over the land described below. Deposits made under section 31(6) of the Highways Act 1980 may prevent deemed dedication of public rights of way over such land under section 31(1) of that Act. Deposits made under section 15A(1) of the Commons Act 2006 may affect the ability to register such land as a town or village green under section 15 of that Act. For further information please see guidance at <https://www.gov.uk/guidance/town-and-village-greens-how-to-register>

Description of the land:

Prior's Wood and Prior's Close,
Bibbs Hall Lane, Ayot St Lawrence, Welwyn, Herts, AL6 9BY

Name of the parish, ward or district in which the land is situated:

Kimpton, North Herts

The deposit was submitted by Dr Simon Leadbeater and was received by this authority on 11th May 2020.

The authority maintains a register of maps, statements and declarations deposited under section 31A of the Highways Act 1980 and section 15B of the Commons Act 2006. This register can be accessed online at www.hertfordshire.gov.uk/landownerdeposits or can be inspected free of charge at Hertfordshire County Council, County Hall, Pegs Lane, Hertford, Hertfordshire, SG13 8DN during office hours between 9:00am and 5:00 pm

Signed on behalf of Hertfordshire County Council:

Name and position of Signatory: R. Cuthbert, Definitive Map & Enforcement Team Leader

Date: 11th May 2020

10. 'Appropriate authority' means (a) in relation to a map or statement deposited or declaration lodged under section 31(6) of that Act, an appropriate council (as defined in section 31(7) of the Highways Act 1980); and (b) in relation to a statement and map deposited under section 15A(1) of the 2006 Act, a commons registration authority (defined in section 4 of the Commons Act 2006 and section 2 of the Commons Registration Act 1965). In practice, the appropriate council and commons registration authority will usually be the same body.

**PART A: Information relating to the applicant and land to which the application relates
(all applicants must complete this Part)**

1. Name of appropriate authority to which the application is addressed:

Hertfordshire County Council,
County Hall
Pegs Lane
Hertford
SG13 8DQ

2. Name and full address (including postcode) of applicant:

Dr Simon Leadbeater
Ayot View
Bibbs Hall Lane
Ayot St. Lawrence
Welwyn
Herts
AL6 9BY

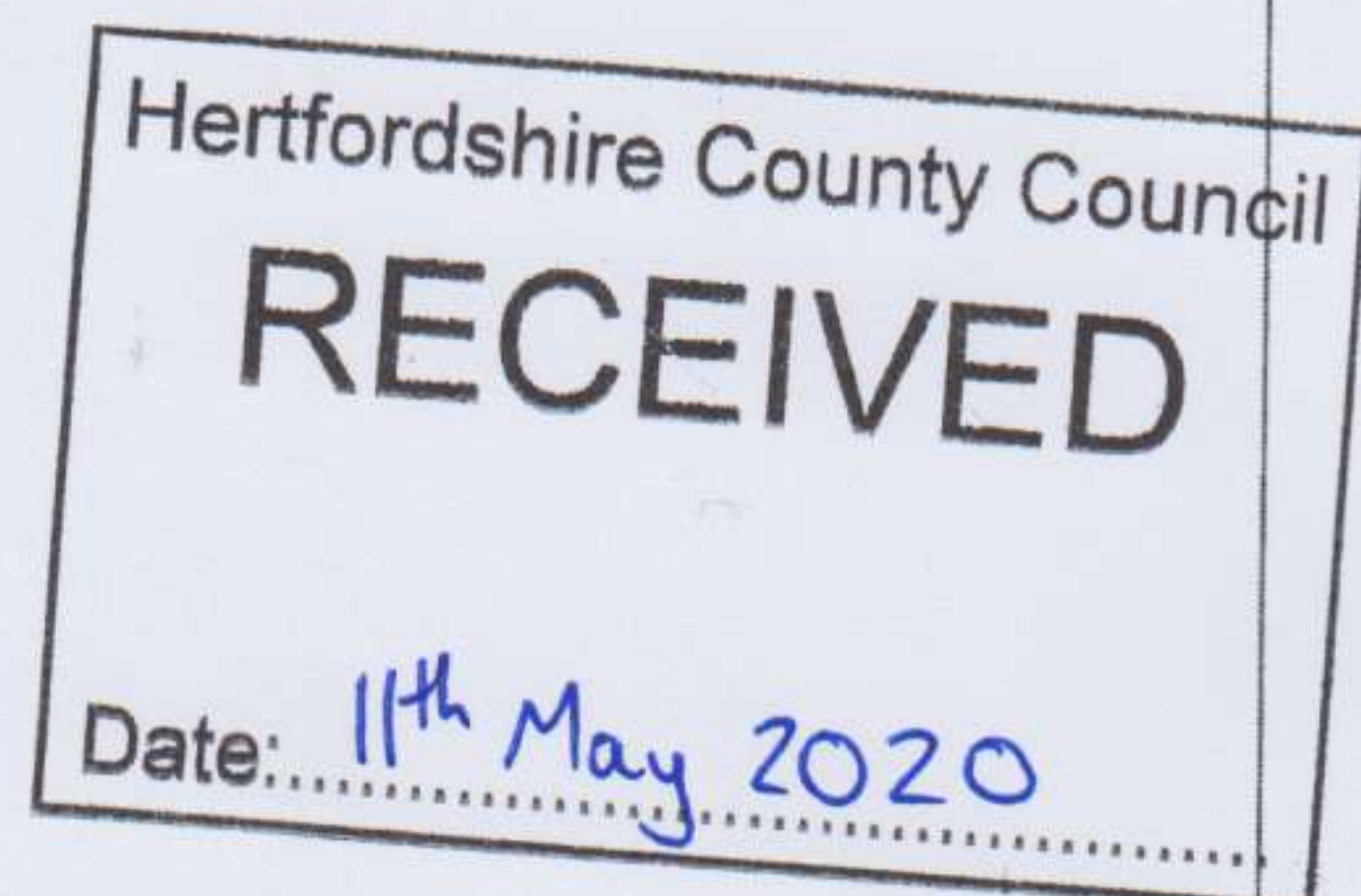

3. Status of applicant (tick relevant box or boxes):

I am

☒ the owner of the land(s) described in paragraph 4.

(b) ☐ making this application and the statements/declarations it contains on behalf of [insert name of owner] who is the owner of the land(s) described in paragraph 4 and in my capacity as [insert details].

4. Insert description of the land(s) to which the application relates (including full address and postcode):

Priors Wood and Pryor's Close adjacent to:

Bibbs Hall Lane
Ayot St. Lawrence
Welwyn
Herts
AL6 9BY

5. Ordnance Survey six-figure grid reference(s) of a point within the area of land(s) to which the application relates (if known):

6. This deposit comprises the following statement(s) and/or declarations (delete Parts B, C, or D where not applicable):

PART B: Statement under section 31(6) of the Highways Act 1980

I am the owner of the land described in paragraph 4 of Part A of this form, surrounded by a red line on the map accompanying this statement.

Ways shown in mauve on the accompanying map are public footpaths.

No other ways over the land shown on the accompanying map have been dedicated as highways.

PART D: Statement under section 15A(1) of the Commons Act 2006

I am the owner of the land described in paragraph 4 of Part A of this form and shown bordered in red on the map accompanying this statement deposited with Hertfordshire County Council on 5th May 2020.

I wish to end any period during which persons may have indulged as of right in lawful sports and pastimes on the whole or any part of the land shown bordered red on the accompanying map referenced above.

PART F: Statement of Truth
(all applicants must complete this Part)

WARNING: If you dishonestly enter information or make a statement that you know is, or might be, untrue or misleading, and intend by doing so to make a gain for yourself or another person, or to cause loss or the risk of loss to another person, you may commit the offence of fraud under section 1 of the Fraud Act 2006, the maximum penalty for which is 10 years' imprisonment or an unlimited fine, or both.

I BELIEVE THAT THE FACTS AND MATTERS CONTAINED IN THIS FORM ARE TRUE

Signature: 

Print full name: Simon Robert Brough Leadbeater

Date: *5th May 2020*

You should keep a copy of the completed form

Data Protection Act 1998 - Fair Processing Notice

The purpose of this Fair Processing Notice is to inform you of the use that will be made of your personal data, as required by the Data Protection Act 1998.

The appropriate authority (see explanation of definition in above guidance notes) in England is the data controller in respect of any personal data that you provide when you complete this form.

The information that you provide will be used by the appropriate authority in its duties to process applications to deposit statements, maps and declarations under section 31(6) the Highways Act 1980 and statements under section 15A(1) of the Commons Act 2006. The information you provide will also be used by the appropriate authority in its duty to update the registers in which details of such deposits are recorded under the Dedicated Highways (Registers under Section 31A of the Highways Act 1980) (England) Regulations 2007 and the Commons (Registration of Town or Village Greens) and Dedicated Highways (Landowner Statements and Declarations) (England) Regulations 2013.

The appropriate authority is required by the legislation above to maintain a register which holds information provided in this form, which can be inspected online or in person by members of the public on request. It may also be required to release information, including personal data and commercial information, on request under the Environmental Information Regulations 2004 or the Freedom of Information Act 2000. However, the appropriate authority will not permit any unwarranted breach of confidentiality nor will they act in contravention of their obligations under the Data Protection Act 1998.

H.M. LAND REGISTRY		TITLE NUMBER HD 377222	
ORDNANCE SURVEY PLAN REFERENCE	TL1816 TL1817 TL1916 TL1917	Scale 1/2500	
COUNTY HERTFORDSHIRE	DISTRICT NORTH HERTS	© Crown copyright	

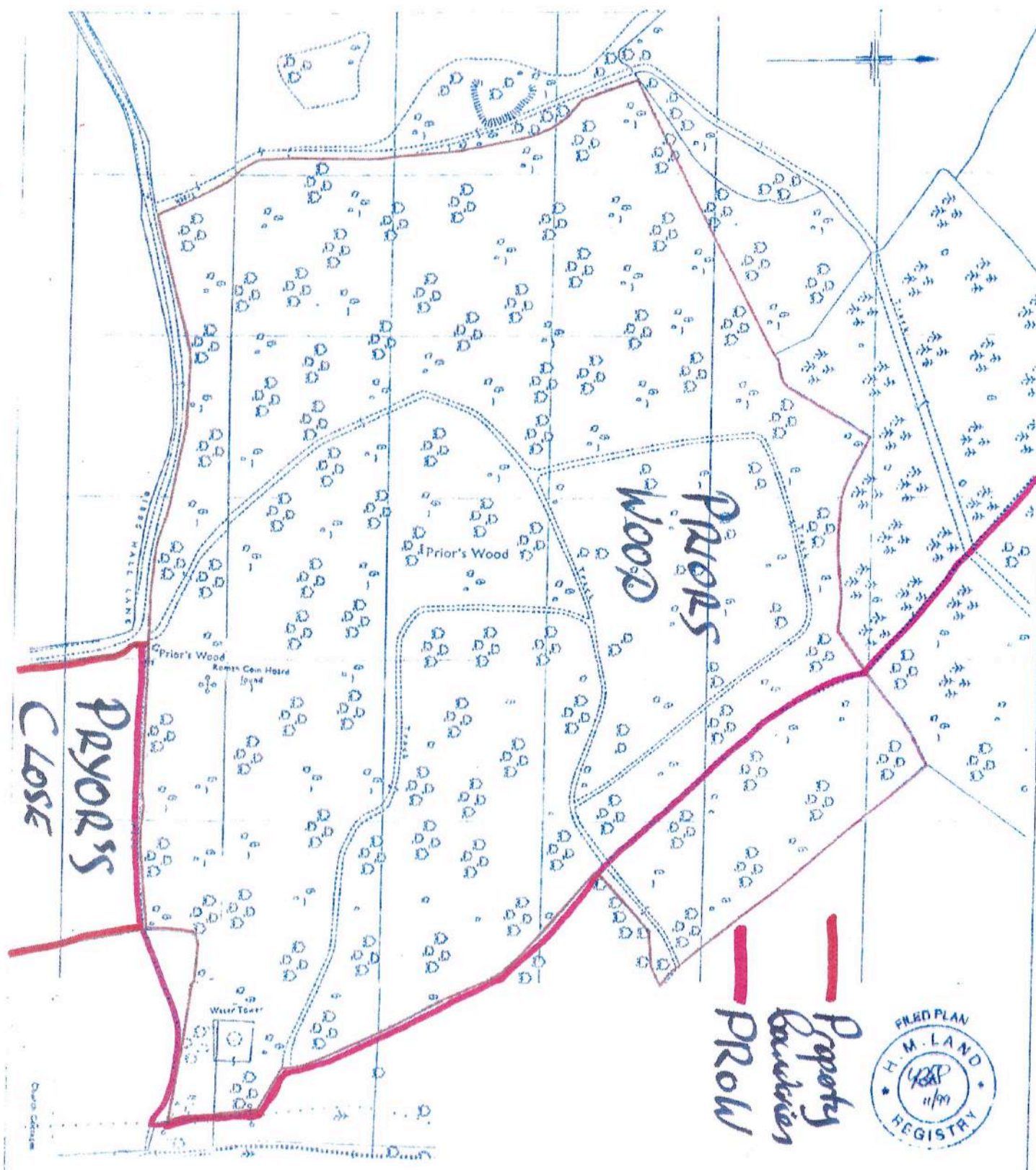

REGISTER OF DEPOSITS

- **HIGHWAYS ACT 1980***

☒

- **COMMONS ACT 2006***

☒

(* tick if applicable or specify N/A)

DETAILS OF APPLICATION

Date Application received in prescribed form 14/05/2020

Date by which any subsequent highways
declaration must be lodged 13/05/2040

Parcel

District North Herts

Parish Kimpton

Address and postcode of buildings
on each piece of land subject to the
application to which a postcode has
been assigned

Prior's Wood and Prior's Close
Bibbs Hall Lane, Ayot St Lawrence,
Welwyn, Herts
AL6 9BY

Nearest town/city to above

Welwyn

OS 6 figure Grid Reference(s)
for a point within the area of the land
(*if possible for postcode point above*)

TL 187 171



NOTICE OF LANDOWNER DEPOSITS under
Section 31(6) of the Highways Act 1980 and
Section 15A(1) of the Commons Act 2006
HERTFORDSHIRE COUNTY COUNCIL

An application to lodge a declaration under section 31(6) of the Highways Act 1980 has been made in relation to the land (or lands) described below and shown edged red on the accompanying map.

PLEASE NOTE:

This deposit may affect rights over the land described below. Deposits made under section 31(6) of the Highways Act 1980 may prevent deemed dedication of public rights of way over such land under section 31(1) of that Act. Deposits made under section 15A(1) of the Commons Act 2006 may affect the ability to register such land as a town or village green under section 15 of that Act. For further information please see guidance at <https://www.gov.uk/guidance/town-and-village-greens-how-to-register>

Description of the land:

Prior's Wood and Prior's Close,
Bibbs Hall Lane, Ayot St Lawrence, Welwyn, Herts, AL6 9BY

Name of the parish, ward or district in which the land is situated:

Kimpton, North Herts

The deposit was submitted by Dr Simon Leadbeater and was received by this authority on 12th May 2020.

The authority maintains a register of maps, statements and declarations deposited under section 31A of the Highways Act 1980 and section 15B of the Commons Act 2006. This register can be accessed online at www.hertfordshire.gov.uk/landownerdeposits or can be inspected free of charge at Hertfordshire County Council, County Hall, Pegs Lane, Hertford, Hertfordshire, SG13 8DN during office hours between 9:00am and 5:00 pm

Signed on behalf of Hertfordshire County Council:

Name and position of Signatory: R. Cuthbert, Definitive Map & Enforcement Team Leader

Date: 14th May 2020

10. 'Appropriate authority' means (a) in relation to a map or statement deposited or declaration lodged under section 31(6) of that Act, an appropriate council (as defined in section 31(7) of the Highways Act 1980); and (b) in relation to a statement and map deposited under section 15A(1) of the 2006 Act, a commons registration authority (defined in section 4 of the Commons Act 2006 and section 2 of the Commons Registration Act 1965). In practice, the appropriate council and commons registration authority will usually be the same body.

PART A: Information relating to the applicant and land to which the application relates
(all applicants must complete this Part)

1. Name of appropriate authority to which the application is addressed:

Hertfordshire County Council,
County Hall
Pegs Lane
Hertford
SG13 8DQ

2. Name and full address (including postcode) of applicant:

Dr Simon Leadbeater
Ayot View
Bibbs Hall Lane
Ayot St. Lawrence
Welwyn
Herts
AL6 9BY



3. Status of applicant (tick relevant box or boxes):

I am

☒ the owner of the land(s) described in paragraph 4.

(b) ☐ making this application and the statements/declarations it contains on behalf of [insert name of owner] who is the owner of the land(s) described in paragraph 4 and in my capacity as [insert details].

4. Insert description of the land(s) to which the application relates (including full address and postcode):

Priors Wood and Pryor's Close adjacent to:

Bibbs Hall Lane
Ayot St. Lawrence
Welwyn
Herts
AL6 9BY

5. Ordnance Survey six-figure grid reference(s) of a point within the area of land(s) to which the application relates (if known):

6. This deposit comprises the following statement(s) and/or declarations (delete Parts B, C, or D where not applicable):

PART C: Declaration under section 31(6) of the Highways Act 1980

1. I am the owner of the land described in paragraph 4 of Part A of this form and shown surrounded by a red line on the map accompanying this declaration/lodged with Hertfordshire County Council on 5th May 2020.

2. On the 5th May 2020, I, Simon Leadbeater, deposited with Hertfordshire County Council, being the appropriate council, a statement accompanied by a map showing my property demarcated by a red line, which stated that:

the ways shown in mauve on the map accompanying this declaration had been dedicated as footpaths.

No other ways had been dedicated as highways over my property.

3. No additional ways have been dedicated over the land surrounded in red on the map accompanying this declaration/referenced in paragraph 1 above since the two earlier statements lodged with Hertfordshire County Council.

PART F: Statement of Truth
(all applicants must complete this Part)

WARNING: If you dishonestly enter information or make a statement that you know is, or might be, untrue or misleading, and intend by doing so to make a gain for yourself or another person, or to cause loss or the risk of loss to another person, you may commit the offence of fraud under section 1 of the Fraud Act 2006, the maximum penalty for which is 10 years' imprisonment or an unlimited fine, or both.

I BELIEVE THAT THE FACTS AND MATTERS CONTAINED IN THIS FORM ARE TRUE

Signature: 

Print full name: Simon Robert Brough Leadbeater

Date:

7th May 2020

You should keep a copy of the completed form

Data Protection Act 1998 - Fair Processing Notice

The purpose of this Fair Processing Notice is to inform you of the use that will be made of your personal data, as required by the Data Protection Act 1998.

The appropriate authority (see explanation of definition in above guidance notes) in England is the data controller in respect of any personal data that you provide when you complete this form.

The information that you provide will be used by the appropriate authority in its duties to process applications to deposit statements, maps and declarations under section 31(6) the Highways Act 1980 and statements under section 15A(1) of the Commons Act 2006. The information you provide will also be used by the appropriate authority in its duty to update the registers in which details of such deposits are recorded under the Dedicated Highways (Registers under Section 31A of the Highways Act 1980) (England) Regulations 2007 and the Commons (Registration of Town or Village Greens) and Dedicated Highways (Landowner Statements and Declarations) (England) Regulations 2013.

The appropriate authority is required by the legislation above to maintain a register which holds information provided in this form, which can be inspected online or in person by members of the public on request. It may also be required to release information, including personal data and commercial information, on request under the Environmental Information Regulations 2004 or the Freedom of Information Act 2000. However, the appropriate authority will not permit any unwarranted breach of confidentiality nor will they act in contravention of their obligations under the Data Protection Act 1998.