

REGISTER OF DEPOSITS

- **HIGHWAYS ACT 1980***

☒

- **COMMONS ACT 2006***

☒

(* tick if applicable or specify N/A)

DETAILS OF APPLICATION

Date Application received in prescribed form 29th Sept 2015

Date on which any highways declaration expires 28th Sept 2035

Parcel

District Dacorum Parish Kings Langley

Address and postcode of buildings
on each piece of land subject to the
application to which a postcode has
been assigned

Land off Ruckless Lane
Kings Langley
Near Hemel Hempstead
WD4 9NE

Nearest town/city to above

Hemel Hempstead/St Albans

OS 6 figure Grid Reference(s)
for a point within the area of the land
(if possible for postcode point above)

TL 058 041



NOTICE OF LANDOWNER DEPOSITS under
Section 31(6) of the Highways Act 1980 and
Section 15A(1) of the Commons Act 2006
HERTFORDSHIRE COUNTY COUNCIL

An application to deposit a map and statement under section 31(6) of the Highways Act 1980 and deposit a statement under section 15A(1) of the Commons Act 2006 has been made in relation to the land (or lands) described below and shown edged black and coloured blue on the accompanying map.

PLEASE NOTE:

This deposit may affect rights over the land described below. Deposits made under section 31(6) of the Highways Act 1980 may prevent deemed dedication of public rights of way over such land under section 31(1) of that Act. Deposits made under section 15A(1) of the Commons Act 2006 may affect the ability to register such land as a town or village green under section 15 of that Act. For further information please see guidance at <http://www.defra.gov.uk/rural/protected/greens/>

Description of the land:

Land off Ruckless Lane, King's Langley, WD4 9NE

Name of the parish, ward or district in which the land(s) is situated:

Dacorum borough, Kings Langley parish

The deposit was submitted by Anne McWilliams and was received by this authority on 29th September 2015.

The authority maintains a register of maps, statements and declarations deposited under section 31A of the Highways Act 1980 and section 15B of the Commons Act 2006. This register can be accessed online at

<http://www.hertsdirect.org/services/envplan/countrysideaccess/row/apps/deposit/>

or can be inspected free of charge at Hertfordshire County Council
County Hall Pegs Lane Hertford, Hertfordshire, SG13 8DN during office hours
between 9:00am and 5:00 pm

Signed on behalf of Hertfordshire County Council:

Name and position of Signatory: R. Cuthbert Team Leader Access & Rights of Way

Date: 29th September 2015

PART A

Information relating to the Applicant and Land to which the Application relates

(all applicants must complete this part)

- 1 Name of appropriate authority to which the application is addressed:

Hertfordshire County Council

- 2 Name and full address (including postcode) of applicant:

Name: Anne McWilliams

Address: Deva

Bell Lane

Henley on Thames

Oxon

Postcode: RG9 2HP

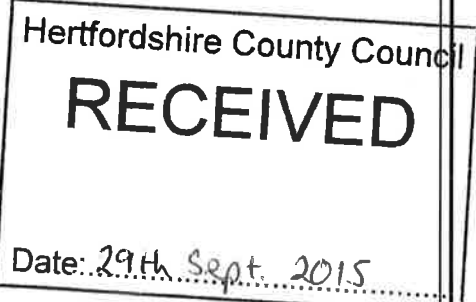

- 3 Status of applicant (tick relevant box or boxes):

I am

- (a) ☒ the owner of the land(s) described in paragraph 4.
(b) ☐ making this application and the statements/declarations it contains on behalf of [insert name of owner] who is the owner of the land(s) described in paragraph 4 and in my capacity as [insert details].

- 4 Insert description of the land(s) to which the application relates (including full address and postcode):

Description of Land(s): 21 acre field with tithe number HD371973

Full address: Between Shendish Estate and Rucklers Lane

Postcode: WD4 9NE

- 5 Ordnance Survey six-figure grid reference(s) of a point within the area of land(s) to which the application relates (if known):

505800 204100

- 6 This deposit comprises the following statement(s) and/or declarations (tick relevant box or boxes):

PART B ☒
PART C ☐
PART D ☒

(delete Parts B, C or D from the form below where not applicable):

PART B

Statement under section 31(6) of the Highways Act 1980

I am the owner of the land described in paragraph 4 of Part A of this form and shown edged black and coloured blue on the map accompanying this statement.

Ways shown red on the accompanying map are public footpaths.

No other ways over the land shown edged black and coloured blue on the accompanying map have been dedicated as highways.

PART D

Statement under section 15A(1) of the Commons Act 2006

I am the owner of the land described in paragraph 4 of Part A of this form and shown edged black and coloured blue on the map accompanying this statement.

I wish to bring to an end any period during which persons may have indulged as of right in lawful sports and pastimes on the whole or any part of the land shown edged black and coloured blue on the accompanying map.

PART F

Statement of Truth

(all applicants must complete this part)

WARNING: If you dishonestly enter information or make a statement that you know is, or might be, untrue or misleading, and intend by doing so to make a gain for yourself or another person, or to cause loss or the risk of loss to another person, you may commit the offence of fraud under section 1 of the Fraud Act 2006, the maximum penalty for which is 10 years' imprisonment or an unlimited fine, or both.

I BELIEVE THAT THE FACTS AND MATTERS CONTAINED IN THIS FORM ARE TRUE

Signature:

[Redacted Signature]

(of the person making the statement of truth)

Date: 25 Sept 2015

Print Name:

ANNE MCWILLIAMS

You should keep a copy of the completed form

Data Protection Act 1998

Fair Processing Notice

The purpose of this Fair Processing Notice is to inform you of the use that will be made of your personal data, as required by the Data Protection Act 1998.

The appropriate authority (see explanation of definition in above guidance notes) in England is the data controller in respect of any personal data that you provide when you complete this form.

The information that you provide will be used by the appropriate authority in its duties to process applications to deposit statements, maps and declarations under section 31(6) the Highways Act 1980 and statements under section 15A(1) of the Commons Act 2006. The information you provide will also be used by the appropriate authority in its duty to upgrade the registers in which details of such deposits are recorded under the Dedicated Highways (Registers under Section 31A of the Highways Act 1980 (England) Regulations 2007 and the Commons (Registration of Town or Village Greens) and Dedicated Highways (Landowner Statements and Declarations) (England) Regulations 2013.

The appropriate authority is required by the legislation above to maintain a register which holds information provided in this form, which can be inspected online or in person by members of the public on request. It may also be required to release information, including personal data and commercial information, on request under the Environmental Information Regulations 2004 or the Freedom of Information Act 2000. However, the appropriate authority will not permit any unwarranted breach of confidentiality nor will they act in contravention of their obligations under the Data Protection Act 1998.

From Jan 14th 1999
HD 371973

TITLE	NUMBER
1	1
2	2
3	3
4	4
5	5
6	6
7	7
8	8
9	9
10	10
11	11
12	12
13	13
14	14
15	15
16	16
17	17
18	18
19	19
20	20
21	21
22	22
23	23
24	24
25	25
26	26
27	27
28	28
29	29
30	30
31	31
32	32
33	33
34	34
35	35
36	36
37	37
38	38
39	39
40	40
41	41
42	42
43	43
44	44
45	45
46	46
47	47
48	48
49	49
50	50
51	51
52	52
53	53
54	54
55	55
56	56
57	57
58	58
59	59
60	60
61	61
62	62
63	63
64	64
65	65
66	66
67	67
68	68
69	69
70	70
71	71
72	72
73	73
74	74
75	75
76	76
77	77
78	78
79	79
80	80
81	81
82	82
83	83
84	84
85	85
86	86
87	87
88	88
89	89
90	90
91	91
92	92
93	93
94	94
95	95
96	96
97	97
98	98
99	99
100	100

HD 164686
HD 371973

- Since Jan 4 1999 changed to

ORDNANCE SURVEY PLAN REFERENCE	TL 0503	TL 0603	TL 0504	TL 0604
-----------------------------------	---------	---------	---------	---------

Scale
1/2500

COUNTY HERTFORDSHIRE

DISTRICT DACORUM

© Crown copyright 1982

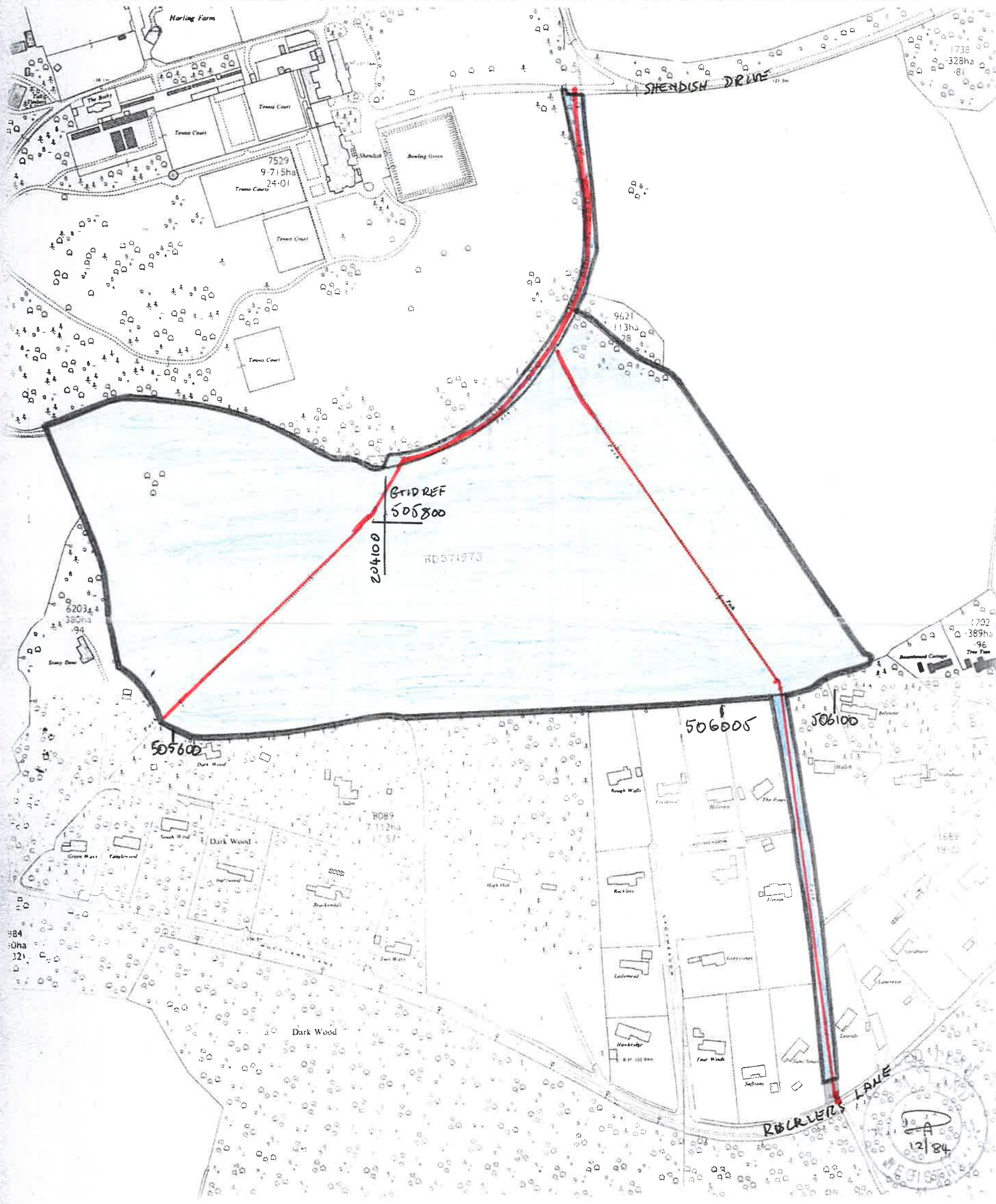

1458025004

This title is dealt with by the **Stevenage District Land Registry.**

© Crown copyright. Produced by HMLR. Further reproduction in whole or part is prohibited without the prior written permission of Ordnance Survey. Licence Number GD272728.