

REGISTER OF DEPOSITS

- **HIGHWAYS ACT 1980***

- **COMMONS ACT 2006***

(* tick if applicable or specify N/A)

DETAILS OF APPLICATION

Date Application received in prescribed form 15/01/2020

Date by which any subsequent highways
declaration must be lodged 14/01/2040

Parcel

District	East Herts	Parish	Little Berkhamsted
Address and postcode of buildings on each piece of land subject to the application to which a postcode has been assigned	Land at Little Berkhamsted Glebe Church Road, Little Berkhamsted Hertford, Herts SG13 8LY		
Nearest town/city to above	Hertford		
OS 6 figure Grid Reference(s) for a point within the area of the land (if possible for postcode point above)	TL 293 077		



NOTICE OF LANDOWNER DEPOSITS under
Section 31(6) of the Highways Act 1980 and
Section 15A(1) of the Commons Act 2006
HERTFORDSHIRE COUNTY COUNCIL

An application to deposit a map and statement under section 31(6) of the Highways Act 1980 and deposit a statement under section 15A(1) of the Commons Act 2006 has been made in relation to the land (or lands) described below and shown edged red on the accompanying map.

PLEASE NOTE:

This deposit may affect rights over the land described below. Deposits made under section 31(6) of the Highways Act 1980 may prevent deemed dedication of public rights of way over such land under section 31(1) of that Act. Deposits made under section 15A(1) of the Commons Act 2006 may affect the ability to register such land as a town or village green under section 15 of that Act. For further information please see guidance at <https://www.gov.uk/guidance/town-and-village-greens-how-to-register>

Description of the land:

Land at Little Berkhamsted Glebe,
Church Road, Little Berkhamsted, Hertford, Herts, SG13 8LY

Name of the parish, ward or district in which the land is situated:

Little Berkhamsted, East Herts

The deposit was submitted by The St Albans Diocesan Board of Finance and was received by this authority on 13th January 2020.

The authority maintains a register of maps, statements and declarations deposited under section 31A of the Highways Act 1980 and section 15B of the Commons Act 2006. This register can be accessed online at www.hertfordshire.gov.uk/landownerdeposits or can be inspected free of charge at Hertfordshire County Council, County Hall, Pegs Lane, Hertford, Hertfordshire, SG13 8DN during office hours between 9:00am and 5:00 pm

Signed on behalf of Hertfordshire County Council:

Name and position of Signatory: R. Cuthbert, Definitive Map & Enforcement Team Leader

Date: 15th January 2020

PART A

Information relating to the Applicant and Land to which the Application relates

(all applicants must complete this part)

1 Name of appropriate authority to which the application is addressed:
Hertfordshire County Council

2 Name and full address (including postcode) of applicant:

Name: The St Albans Diocesan Board of Finance
Address: Holywell Lodge
41 Holywell Hill
St Albans
Hertfordshire
Postcode: AL1 1HE

Hertfordshire County Council

RECEIVED

Date: 13th January 2020

3 Status of applicant (tick relevant box or boxes):

I am

(a)

the owner of the land(s) described in paragraph 4.

(b)

making this application and the statements/declarations it contains on behalf of [insert name of owner] who is the owner of the land(s) described in paragraph 4 and in my capacity as [insert details].

4 Insert description of the land(s) to which the application relates (including full address and postcode):

Description of Land(s):	Land at Aldenham Glebe
Full address:	Radlett Road, Aldenham, Watford
Postcode	WD25 8BQ
OS Ref:	TQ143984
Description of Land(s):	Land at Barley Glebe
Full address:	Shaftenhoe End Road, Barley, Royston
Postcode	SG8 8JW
OS Ref:	TL403384
Description of Land(s):	Land at Bayford Glebe
Full address:	Well Row, Bayford, Hertford
Postcode	SG13 8PW
OS Ref:	TL309085
Description of Land(s):	Land at Braughing Glebe

Full address:	Pelham Road, Braughing, Ware
Postcode	SG11 2QU
OS Ref:	TL398254
Description of Land(s):	Land at Essendon Glebe
Full address:	Essendon Hill, Essendon, Hatfield
Postcode	AL9 6AL
OS Ref:	TL275089
Description of Land(s):	Land at Frogmore Glebe
Full address:	Frogmore, St Albans
Postcode	AL2 2JU
OS Ref:	TL153032
Description of Land(s):	Land at Hunsdon Glebe
Full address:	Acorn Street, Hunsdon, Ware
Postcode	SG12 8PB
OS Ref:	TL416138
Description of Land(s):	Land at Knebworth Glebe
Full address:	Park Lane, Old Knebworth
Postcode	SG3 6QA
OS Ref:	TL232201
Description of Land(s):	Land at Little Berkhamsted Glebe
Full address:	Church Road, Little Berkhamsted, Hertford
Postcode	SG13 8LY
OS Ref:	TL293077
Description of Land(s):	Land at London Colney Glebe
Full address:	High Street, London Colney, St Albans
Postcode	AL2 1RG
OS Ref:	TL181040
Description of Land(s):	Land at Sarratt Glebe
Full address:	Church Lane, Sarratt, Rickmansworth
Postcode	WD3 6BD
OS Ref:	TQ040991
Description of Land(s):	Land at Spellbrook Glebe
Full address:	Spellbrook Lane, Bishop's Stortford
Postcode	CM23 4AU
OS Ref:	TL486178
Description of	Land at St Ippolyts Paddock and Garden

Land(s):	
Full address:	Sperberry Hill, St Ippolyts, Hitchin
Postcode	SG4 7NZ
OS Ref:	TL198268
Description of Land(s):	Land at Thorley Glebe
Full address:	Thorley Lane East, Bishops Stortford
Postcode	CM23 4BQ
OS Ref:	TL479192
Description of Land(s):	Land at Wheathampstead Allotments
Full address:	Marford Road, Wheathampstead, St Albans
Postcode	AL4 8NQ
OS Ref:	TL183139
Description of Land(s):	Land at Wheathampstead Rectory Meadow
Full address:	Ash Grove, Wheathampstead
Postcode	AL4 8HA
OS Ref:	TL175141

- 5 Ordnance Survey six-figure grid reference(s) of a point within the area of land(s) to which the application relates (if known):

See above

- 6 This deposit comprises the following statement(s) and/or declarations (*tick relevant box or boxes*):

PART B
PART C
PART D

(delete Parts B, C or D from the form below where not applicable):

PART B

Statement under section 31(6) of the Highways Act 1980

I am the owner of the land described in paragraph 4 of Part A of this form and shown edged red on the maps accompanying this statement.

Ways shown purple on the accompanying maps are public footpaths.

No other ways over the land shown edged red on the accompanying maps have been dedicated as highways.

PART D

Statement under section 15A(1) of the Commons Act 2006

I am the owner of the land described in paragraph 4 of Part A of this form and shown edged red on the maps accompanying this statement.

I wish to bring to an end any period during which persons may have indulged as of right in lawful sports and pastimes on the whole or any part of the land shown edged red on the accompanying maps.

PART F

Statement of Truth

(all applicants must complete this part)

WARNING: If you dishonestly enter information or make a statement that you know is, or might be, untrue or misleading, and intend by doing so to make a gain for yourself or another person, or to cause loss or the risk of loss to another person, you may commit the offence of fraud under section 1 of the Fraud Act 2006, the maximum penalty for which is 10 years' imprisonment or an unlimited fine, or both.

I BELIEVE THAT THE FACTS AND MATTERS CONTAINED IN THIS FORM ARE TRUE

Signature: _____

(of the person making the statement of truth)

Date: 7.1.2020

Print Name: _____

ELIZABETH PAZZI-AXWORTHY

You should keep a copy of the completed form

Data Protection Act 1998

Fair Processing Notice

The purpose of this Fair Processing Notice is to inform you of the use that will be made of your personal data, as required by the Data Protection Act 1998.

The appropriate authority (see explanation of definition in above guidance notes) in England is the data controller in respect of any personal data that you provide when you complete this form.

The information that you provide will be used by the appropriate authority in its duties to process applications to deposit statements, maps and declarations under section 31(6) the Highways Act 1980 and statements under section 15A(1) of the Commons Act 2006. The information you provide will also be used by the appropriate authority in its duty to upgrade the registers in which details of such deposits are recorded under the Dedicated Highways (Registers under Section 31A of the Highways Act 1980 (England) Regulations 2007 and the Commons (Registration of Town or Village Greens) and Dedicated Highways (Landowner Statements and Declarations) (England) Regulations 2013.

The appropriate authority is required by the legislation above to maintain a register which holds information provided in this form, which can be inspected online or in person by members of the public on request. It may also be required to release information, including personal data and commercial information, on request under the Environmental Information Regulations 2004 or the Freedom of Information Act 2000. However, the appropriate authority will not permit any unwarranted breach of confidentiality nor will they act in contravention of their obligations under the Data Protection Act 1998.

Land at Little Berkhampsted - Section 31(6)

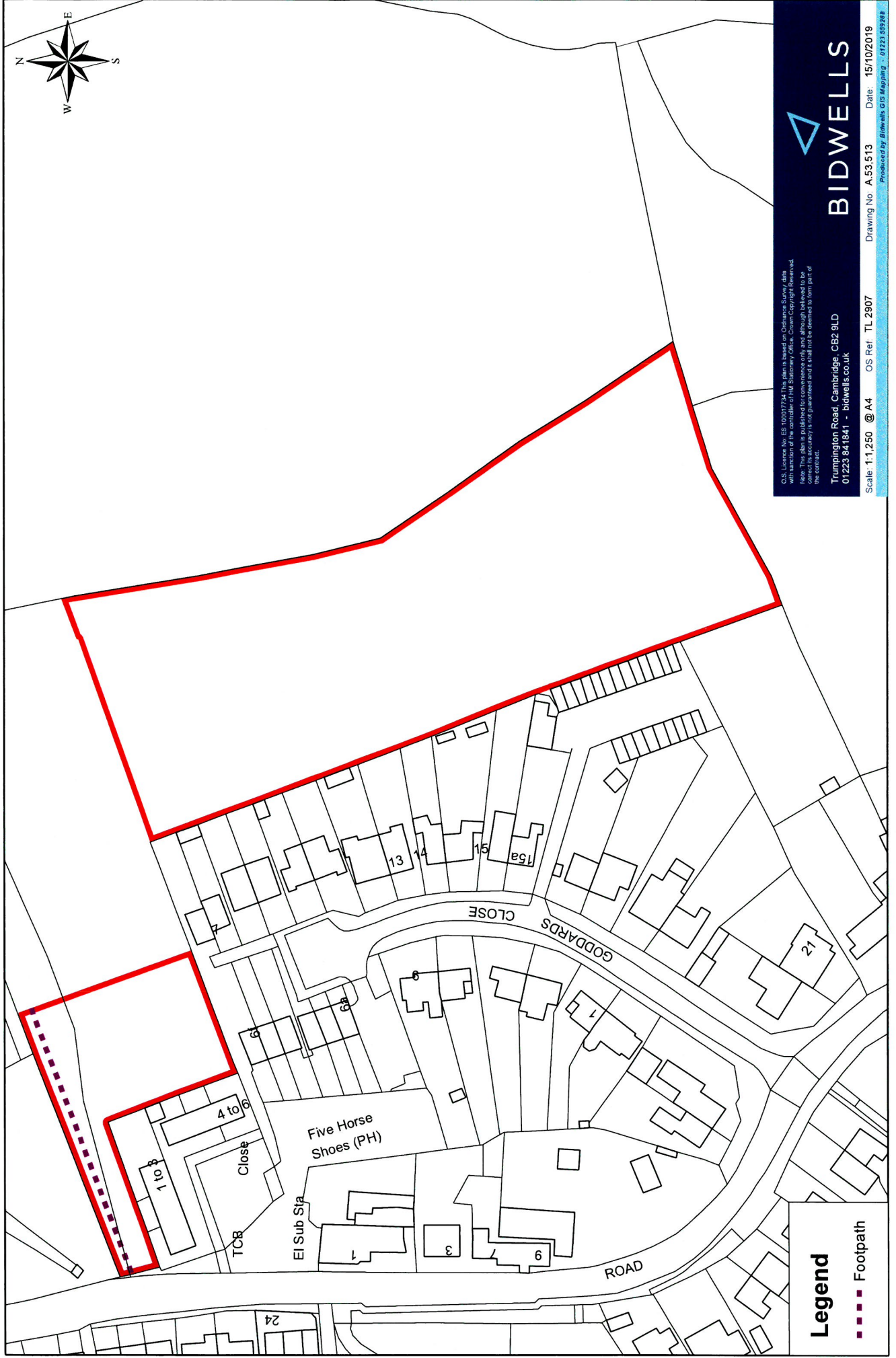

OS Licence ref: 100019777. This plan is based on Ordnance Survey data. The plan is published for convenience only, and although believed to be correct its accuracy is not guaranteed and it shall not be deemed to form part of the contract.

Trumpington Road, Cambridge, CB2 9LD
01223 841841 - bidwells.co.uk



BIDWELLS

Scale: 1:1,250 @ A4 OS Ref: TL 2907 Drawing No. A.53.513 Date: 15/10/2019
Produced by Bidwells GIS Mapping - 01223 359588

Legend

- Footpath

REGISTER OF DEPOSITS- **HIGHWAYS ACT 1980***- **COMMONS ACT 2006***

(* tick if applicable or specify N/A)

DETAILS OF APPLICATION

Date Application received in prescribed form 14/02/2020

Date by which any subsequent highways
declaration must be lodged 13/02/2040**Parcel**

District East Herts

Parish Little Berkhamsted

Address and postcode of buildings
on each piece of land subject to the
application to which a postcode has
been assignedLand at Little Berkhamsted Glebe
Church Road, Little Berkhamsted
Hertford, Herts
SG13 8LY

Nearest town/city to above

Hertford

OS 6 figure Grid Reference(s)
for a point within the area of the land
(if possible for postcode point above)

TL 293 077



NOTICE OF LANDOWNER DEPOSITS under
Section 31(6) of the Highways Act 1980 and
Section 15A(1) of the Commons Act 2006
HERTFORDSHIRE COUNTY COUNCIL

An application to lodge a declaration under section 31(6) of the Highways Act 1980 has been made in relation to the land (or lands) described below and shown edged red on the accompanying map.

PLEASE NOTE:

This deposit may affect rights over the land described below. Deposits made under section 31(6) of the Highways Act 1980 may prevent deemed dedication of public rights of way over such land under section 31(1) of that Act. Deposits made under section 15A(1) of the Commons Act 2006 may affect the ability to register such land as a town or village green under section 15 of that Act. For further information please see guidance at <https://www.gov.uk/guidance/town-and-village-greens-how-to-register>

Description of the land:

Land at Little Berkhamsted Glebe,
Church Road, Little Berkhamsted, Hertford, Herts, SG13 8LY

Name of the parish, ward or district in which the land is situated:

Little Berkhamsted, East Herts

The deposit was submitted by The St Albans Diocesan Board of Finance and was received by this authority on 13th February 2020.

The authority maintains a register of maps, statements and declarations deposited under section 31A of the Highways Act 1980 and section 15B of the Commons Act 2006. This register can be accessed online at www.hertfordshire.gov.uk/landownerdeposits or can be inspected free of charge at Hertfordshire County Council, County Hall, Pegs Lane, Hertford, Hertfordshire, SG13 8DN during office hours between 9:00am and 5:00 pm

Signed on behalf of Hertfordshire County Council:

Name and position of Signatory: R. Cuthbert, Definitive Map & Enforcement Team Leader

Date: 14th February 2020

PART A

Information relating to the Applicant and Land to which the Application relates

(all applicants must complete this part)

1 Name of appropriate authority to which the application is addressed:
Hertfordshire County Council

2 Name and full address (including postcode) of applicant:

Name: The St Albans Diocesan Board of Finance
 Address: Holywell Lodge
41 Holywell Hill
St Albans
Hertfordshire
 Postcode: AL1 1HE

Hertfordshire County Council

RECEIVED

Date: 13th February 2020

3 Status of applicant (tick relevant box or boxes):

I am

(a) *AMV*
 (b)

THE ST ALBANS DIOCESAN BOARD OF FINANCE
 the owner of the land(s) described in paragraph 4.
 making this application and the statements/declarations it contains on behalf of *[insert name of owner]* who is the owner of the land(s) described in paragraph 4 and in my capacity as *[insert details]*.

ESTATES AND TRUSTS OFFICER

4 Insert description of the land(s) to which the application relates (including full address and postcode):

Description of Land(s):	Land at Aldenham Glebe
Full address:	Radlett Road, Aldenham, Watford
Postcode	WD25 8BQ
OS Ref:	TQ143984
Description of Land(s):	Land at Barley Glebe
Full address:	Shaftenhoe End Road, Barley, Royston
Postcode	SG8 8JW
OS Ref:	TL403384
Description of Land(s):	Land at Bayford Glebe
Full address:	Well Row, Bayford, Hertford
Postcode	SG13 8PW
OS Ref:	TL309085
Description of Land(s):	Land at Braughing Glebe

Full address:	Pelham Road, Braughing, Ware
Postcode	SG11 2QU
OS Ref:	TL398254
Description of Land(s):	Land at Essendon Glebe
Full address:	Essendon Hill, Essendon, Hatfield
Postcode	AL9 6AL
OS Ref:	TL275089
Description of Land(s):	Land at Frogmore Glebe
Full address:	Frogmore, St Albans
Postcode	AL2 2JU
OS Ref:	TL153032
Description of Land(s):	Land at Hunsdon Glebe
Full address:	Acorn Street, Hunsdon, Ware
Postcode	SG12 8PB
OS Ref:	TL416138
Description of Land(s):	Land at Knebworth Glebe
Full address:	Park Lane, Old Knebworth
Postcode	SG3 6QA
OS Ref:	TL232201
Description of Land(s):	Land at Little Berkhamsted Glebe
Full address:	Church Road, Little Berkhamsted, Hertford
Postcode	SG13 8LY
OS Ref:	TL293077
Description of Land(s):	Land at London Colney Glebe
Full address:	High Street, London Colney, St Albans
Postcode	AL2 1RG
OS Ref:	TL181040
Description of Land(s):	Land at Sarratt Glebe
Full address:	Church Lane, Sarratt, Rickmansworth
Postcode	WD3 6BD
OS Ref:	TQ040991
Description of Land(s):	Land at Spellbrook Glebe
Full address:	Spellbrook Lane, Bishop's Stortford
Postcode	CM23 4AU
OS Ref:	TL486178
Description of	Land at St Ippolyts Paddock and Garden

Land(s):	
Full address:	Sperberry Hill, St Ippolyts, Hitchin
Postcode	SG4 7NZ
OS Ref:	TL198268
Description of Land(s):	Land at Thorley Glebe
Full address:	Thorley Lane East, Bishops Stortford
Postcode	CM23 4BQ
OS Ref:	TL479192
Description of Land(s):	Land at Wheathampstead Allotments
Full address:	Marford Road, Wheathampstead, St Albans
Postcode	AL4 8NQ
OS Ref:	TL183139
Description of Land(s):	Land at Wheathampstead Rectory Meadow
Full address:	Ash Grove, Wheathampstead
Postcode	AL4 8HA
OS Ref:	TL175141

5 Ordnance Survey six-figure grid reference(s) of a point within the area of land(s) to which the application relates (if known):

See above

6 This deposit comprises the following statement(s) and/or declarations (*tick relevant box or boxes*):

PART B
PART C
PART D

(delete Parts B, C or D from the form below where not applicable):

PART C

Declaration under section 31(6) of the Highways Act 1980

- 1 I am the owner of the land described in paragraph 4 of Part A of this form and shown edged red on the map lodged with Hertfordshire County Council on 10 January 2020.
- 2 On the 10th day of January 2020 I deposited with Hertfordshire County Council, being the appropriate council, a statement accompanied by a map showing my property edged red which stated that:

the ways shown purple on that map had been dedicated as footpaths

no other ways had been dedicated as highways over my property.
- 4 No additional ways have been dedicated over the land edged red on the map referenced in paragraph 1 above since the statement dated 10 January 2020 referenced to in paragraph 2 above and at the present time I have no intention of dedicating any more public rights of way over my property.

PART F

Statement of Truth

(all applicants must complete this part)

WARNING: If you dishonestly enter information or make a statement that you know is, or might be, untrue or misleading, and intend by doing so to make a gain for yourself or another person, or to cause loss or the risk of loss to another person, you may commit the offence of fraud under section 1 of the Fraud Act 2006, the maximum penalty for which is 10 years' imprisonment or an unlimited fine, or both.

I BELIEVE THAT THE FACTS AND MATTERS CONTAINED IN THIS FORM ARE TRUE

Signature: _____



Date: 5.2.20

(of the person making the statement of truth)

Print Name: E PAZZI-AXWORTHY

You should keep a copy of the completed form

Data Protection Act 1998

Fair Processing Notice

The purpose of this Fair Processing Notice is to inform you of the use that will be made of your personal data, as required by the Data Protection Act 1998.

The appropriate authority (see explanation of definition in above guidance notes) in England is the data controller in respect of any personal data that you provide when you complete this form.

The information that you provide will be used by the appropriate authority in its duties to process applications to deposit statements, maps and declarations under section 31(6) the Highways Act 1980 and statements under section 15A(1) of the Commons Act 2006. The information you provide will also be used by the appropriate authority in its duty to upgrade the registers in which details of such deposits are recorded under the Dedicated Highways (Registers under Section 31A of the Highways Act 1980 (England) Regulations 2007 and the Commons (Registration of Town or Village Greens) and Dedicated Highways (Landowner Statements and Declarations) (England) Regulations 2013.

The appropriate authority is required by the legislation above to maintain a register which holds information provided in this form, which can be inspected online or in person by members of the public on request. It may also be required to release information, including personal data and commercial information, on request under the Environmental Information Regulations 2004 or the Freedom of Information Act 2000. However, the appropriate authority will not permit any unwarranted breach of confidentiality nor will they act in contravention of their obligations under the Data Protection Act 1998.