

Dated

22nd October

2010

DEPOSIT OF STATEMENT AND MAP

SECTION 31(6) HIGHWAYS ACT 1980

Relating to

**Land to the east of Blue Bridge Road, south east of Bluebridge Avenue,
Brookmans Park, Hertfordshire**

**Leach (Brookmans Park) Limited,
Hamels Mansion,
Buntingford,
Herts. SG9 9NF**

To Hertfordshire County Council

1. We are and have been since 1957 the owner within the meaning of the above section of above section of land known as Land east of Blue Bridge Road, south east of Bluebridge Avenue, Bookman's Park, Hertfordshire more particularly delineated on the map accompanying this statement and thereon edged red.
2. The aforementioned land lies in the Civil Parish of North Mymms.
3. No ways over the land have been dedicated as highways, with vehicular status, bridleways or footpaths.
4. The deposit shall comprise this statement and accompanying map.

Signed:  P.B. Leach -- Chairman

Name: Leach (Brookmans Park) Limited

Address: Hamels Mansion, Knights Hill, Buntingford, Herts. SG9 9NF

Date: 

Witness

Signed:

Name:

Address:

Occupation: MANAGER

NOTES

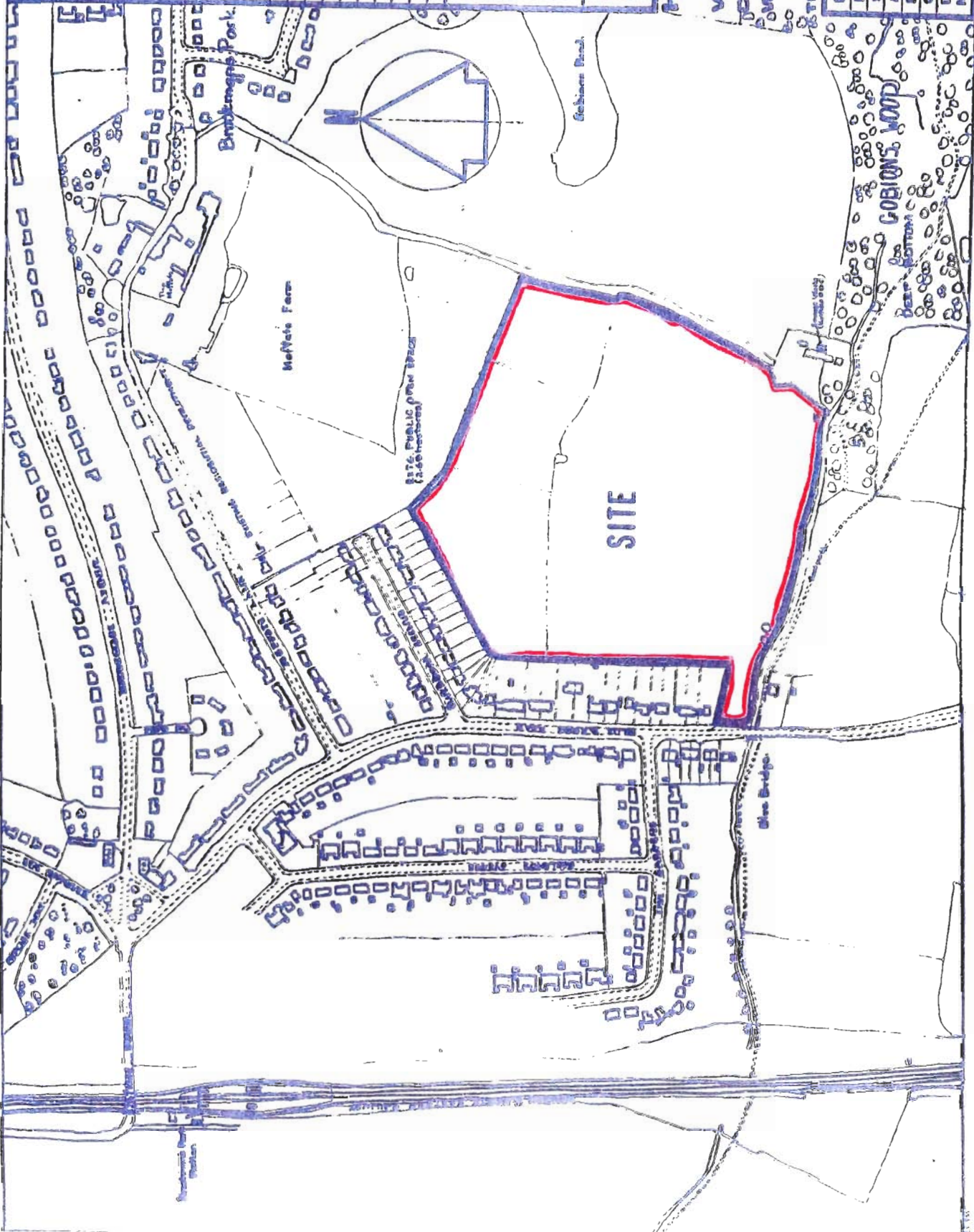

SITE PLAN

Contract

BLUE BRIDGE ROAD.
BROOKMANS PARK.

HUBERT C LEACH LT

VALLEY HOUSE 103-104
CROSBROOK STREET
WALTHAM CROSS HERTS

WALTHAM CROSS HERTS

Head of Planning. J.D. Turner.	
Date	October 1973.
Scale	1:2500
Area	995 sq. ft.
Drawn by	Anthony J. Sharp
Checked	
Drawing Number	BLUE/1
Amendments	