

DEPOSIT OF STATEMENT AND PLAN  
SECTION 31(6) OF THE HIGHWAYS ACT 1980

- We are
1. I am and have been since the 1st day of April 2005 the owner of the land known as Highdown House Estate more particularly delineated on the plan accompanying this declaration and thereon edged in red.
  2. The aforementioned land lies in the parishes of Pirton and Hexton
  3. The ways coloured purple on the said plan have been dedicated as footpaths
  4. The ways coloured in green on the said plan have been dedicated as bridleways
  5. No other ways over the land have been dedicated as highways
  6. The deposit shall comprise this statement and accompanying plan



Signed.....

Address:.....

Date: 17/9/06.....

Agent: Strutt & Parker  
34 St Peters Street  
St Albans  
Hertfordshire  
AL1 3NA

Signed.....

Witness

Name.....

Witness

Address:.....

Occupation:.....



HERTFORDSHIRE  
SG5



The County Secretary,  
Hertfordshire County Council,  
County Hall,  
Hertford  
SG13 8DE

**DEPOSIT OF STATEMENT and PLAN  
SECTION 31 (6) OF THE HIGHWAYS ACT 1980**

1. We are, and have been since 29th September 1998, the owner of the land known as Eighteen Acres and Wood Leys, Highdown Farm, Pirton, Hitchin more particularly delineated on the plan accompanying this statement and thereon edged red.
2. The aforementioned land lies in the parish of Pirton
3. The ways coloured green on the said plan have been dedicated as bridleways.
4. The ways coloured purple on the said plan have been dedicated as footpaths.
6. No other ways over the land have been dedicated as highways.
7. The deposit shall comprise this statement and accompanying plan.

Signed

Secretary, Groveway, Ltd.

On behalf of Groveway, Ltd.,

Hertfordshire  
SG5

Date: 3<sup>rd</sup> June 1999.

Witnessed by

Name

Address

Occupation *COMPUTER CONSULTANT*

*HITCHIN  
HARTS SG5*

HIGHDOWN TOWN,  
PIREX

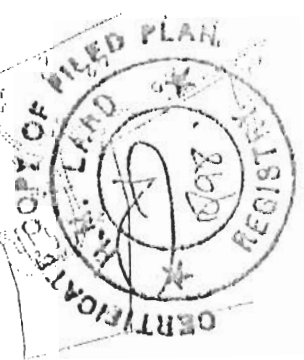

HIGHDOWN  
PIREX

FOOTPATH

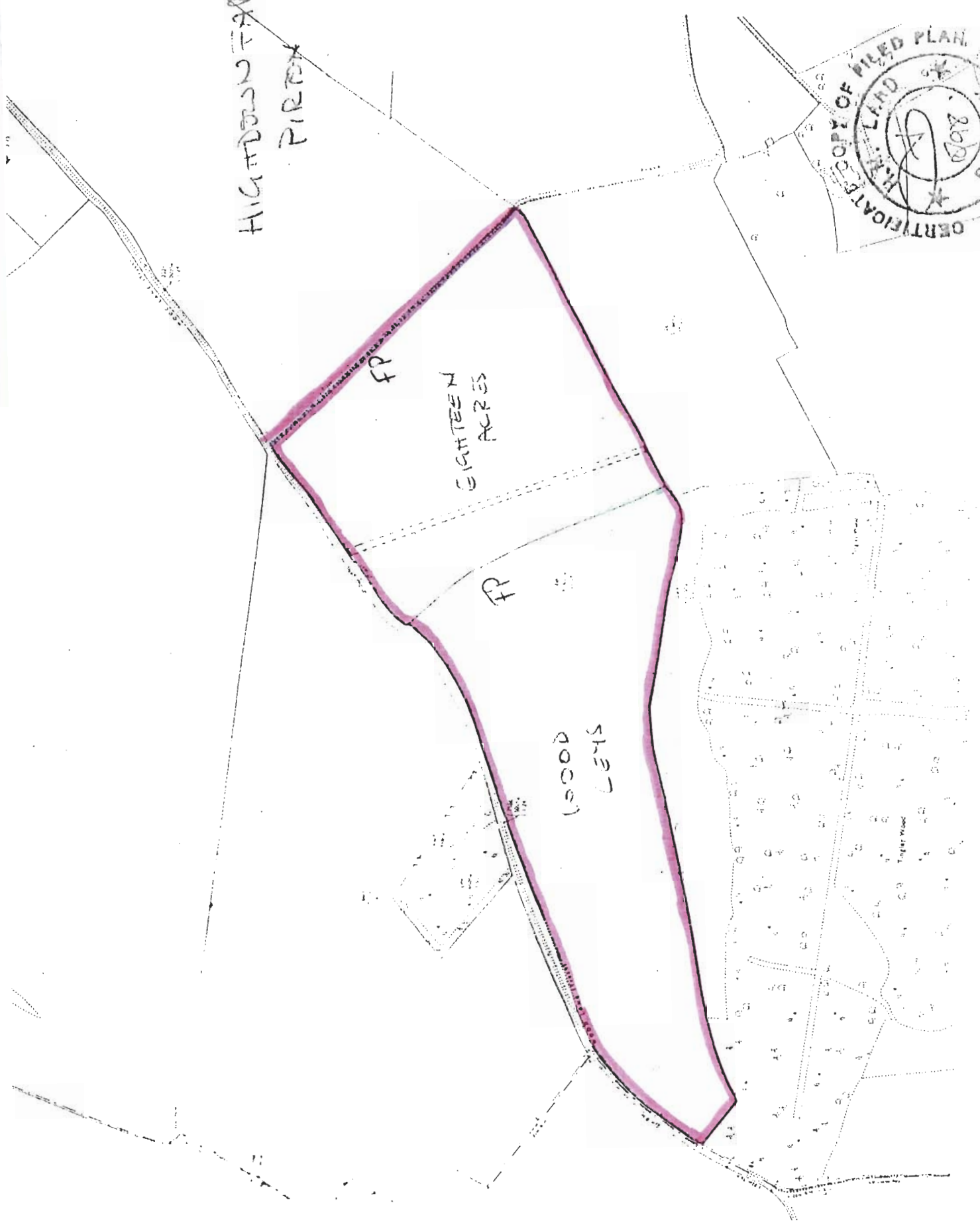

DEPOSIT OF STATEMENT AND PLAN  
SECTION 31(6) OF THE HIGHWAYS ACT 1980

1. We are, and have been since 29.09.1998, the owner of the land known as Eighteen Acres and Wood Leys, Highdown Farm, Pirton, Hitchin, more particularly delineated on the plan accompanying this declaration and thereon edged in pink.
2. The aforementioned land lies in the Parish of Pirton.
3. The ways coloured blue on the said plan have been dedicated as footpaths.
4. The ways coloured green on the said plan have been dedicated as bridleways.
5. No other ways over the land have been dedicated as highways,
6. The deposit shall comprise this statement and accompanying plan.

Signed (landowner):  on behalf of Groveway Limited

Name (landowner): J. Secretary, Groveway Limited

Address :

Hitchin  
SG5

Date 26/04/00

Signed (witness): 

Name (witness):

Address:

Henlow  
SG16

Occupation Head Groom



WOOD  
LOTS

EIGHTEEN  
ACRES

HIGHDOWN FARM  
PIEDMONT

