

REGISTER OF DEPOSITS

- **HIGHWAYS ACT 1980***

☒

- **COMMONS ACT 2006***

☒

(* tick if applicable or specify N/A)

DETAILS OF APPLICATION

Date Application received in prescribed form 25/03/14

Date on which any highways declaration expires 06/04/34

Parcel

District North Herts

Parish Pirton

Address and postcode of buildings
on each piece of land subject to the
application to which a postcode has
been assigned

Land at Rosehill Farm at
Burge End
Pirton
SG5 3QN

Nearest town/city to above

Cambridge

OS 6 figure Grid Reference(s)
for a point within the area of the land
(if possible for postcode point above)

TL 141 326



NOTICE OF LANDOWNER DEPOSITS under
Section 31(6) of the Highways Act 1980
HERTFORDSHIRE COUNTY COUNCIL

An application to deposit a map and statement under section 31(6) of the Highways Act 1980 has been made in relation to the land (or lands) described below and shown edged red on the accompanying map.

PLEASE NOTE:

This deposit may affect rights over the land described below. Deposits made under section 31(6) of the Highways Act 1980 may prevent deemed dedication of public rights of way over such land under section 31(1) of that Act. Deposits made under section 15A(1) of the Commons Act 2006 may affect the ability to register such land as a town or village green under section 15 of that Act. For further information please see guidance at <http://www.defra.gov.uk/rural/protected/greens/>

Description of the land

The agricultural fields Millers Close, Washbrook Lane and North End at Burge End, Pirton, being part of Rosehill Farm

Name of the Parish, Ward or District in which the land(s) is situated:

North Herts, Pirton

The deposit was submitted by David Simkins, Farmer, and was received by this authority on 25th March 2014.

The authority maintains a register of maps, statements and declarations deposited under section 31A of the Highways Act 1980 and section 15B of the Commons Act 2006. This register can be accessed online at

<http://www.hertsdirect.org/services/envplan/countrysideaccess/row/apps/deposit/>

or can be inspected free of charge at Hertfordshire County Council
County Hall Pegs Lane Hertford, Hertfordshire, SG13 8DN during office hours
between 9:00am and 5:00 pm

Signed on behalf of Hertfordshire County:

Name and position of Signatory: R. Cuthbert Team Leader Access & Rights of Way

Date: 25th March 2014

PART A

Information relating to the Applicant and Land to which the Application relates

(all applicants must complete this part)

- 1 Name of appropriate authority to which the application is addressed:

Hertfordshire County Council

- 2 Name and full address (including postcode) of applicant:

Name: John David Simkins, T/A David Simkins (1st of 3 Partners)

Address: Rosehill Farm

Shillington

HITCHIN

Hertfordshire

Postcode: SG5 3HE

- 3 Status of applicant (tick relevant box or boxes):

I am

- (a) ☒ the owner of the land(s) described in paragraph 4.
(b) ☐ making this application and the statements/declarations it contains on behalf of *[insert name of owner]* who is the owner of the land(s) described in paragraph 4 and in my capacity as *[insert details]*.

- 4 Insert description of the land(s) to which the application relates (including full address and postcode):

Description of Land(s):

One parcel of land comprising three agricultural fields, namely: Millers Close, Washbrook Lane and North End.

Full address:

Burge End, Pirton, HITCHIN, Hertfordshire

Postcode

SG5 3QN (nearest residential property in Burge End)

- 5 Ordnance Survey six-figure grid reference(s) of a point within the area of land(s) to which the application relates (if known):

TL 1432 NW

- 6 This deposit comprises the following statement(s) and/or declarations (tick relevant box or boxes):

PART B



PART C



PART D



PART A

Information relating to the Applicant and Land to which the Application relates

(all applicants must complete this part)

- 2 Name of appropriate authority to which the application is addressed:

Hertfordshire County Council

- 2 Name and full address (including postcode) of applicant:

Name: Jacqueline Helen Simkins, T/A David Simkins (2nd of 3 Partners)

Address: Rosehill Farm

Shillington

HITCHIN

Hertfordshire

Postcode: SG5 3HE

- 3 Status of applicant (tick relevant box or boxes):

I am

- (a) ☒ the owner of the land(s) described in paragraph 4.
(b) ☐ making this application and the statements/declarations it contains on behalf of *[insert name of owner]* who is the owner of the land(s) described in paragraph 4 and in my capacity as *[insert details]*.

- 4 Insert description of the land(s) to which the application relates (including full address and postcode):

Description of Land(s): One parcel of land comprising three agricultural fields, namely: Millers Close, Washbrook Lane and North End.

Full address: Burge End, Pirton, HITCHIN, Hertfordshire

Postcode: SG5 3QN (nearest residential property in Burge End)

- 5 Ordnance Survey six-figure grid reference(s) of a point within the area of land(s) to which the application relates (if known):

TL 1432 NW

- 6 This deposit comprises the following statement(s) and/or declarations (*tick relevant box or boxes*):

PART B



PART C



PART D



PART A

Information relating to the Applicant and Land to which the Application relates

(all applicants must complete this part)

- 3 Name of appropriate authority to which the application is addressed:

Hertfordshire County Council

- 2 Name and full address (including postcode) of applicant:

Name: Roger David Simkins, T/A David Simkins (3rd of 3 Partners)

Address: Rosehill Farm

Shillington

HITCHIN

Hertfordshire

Postcode: SG5 3HE

- 3 Status of applicant (tick relevant box or boxes):

I am

- (a) ☒ the owner of the land(s) described in paragraph 4.
(b) ☐ making this application and the statements/declarations it contains on behalf of *[insert name of owner]* who is the owner of the land(s) described in paragraph 4 and in my capacity as *[insert details]*.

- 4 Insert description of the land(s) to which the application relates (including full address and postcode):

Description of Land(s): One parcel of land comprising three agricultural fields, namely: Millers Close, Washbrook Lane and North End.

Full address: Burge End, Pirton, HITCHIN, Hertfordshire

Postcode: SG5 3QN (nearest residential property in Burge End)

- 5 Ordnance Survey six-figure grid reference(s) of a point within the area of land(s) to which the application relates (if known):

TL 1432 NW

- 6 This deposit comprises the following statement(s) and/or declarations (*tick relevant box or boxes*):

PART B

☒

PART C

☐

PART D

☐

PART B

Statement under section 31(6) of the Highways Act 1980

John David Simkins, Jacqueline Helen Simkins and Roger David Simkins T/A David Simkins are the owners of the land described in paragraph 4 of Part A of this form and shown edged RED on the map accompanying this statement.

No ways over the land shown RED on the accompanying map have been dedicated as highways.

PART F

Statement of Truth

(all applicants must complete this part)

WARNING: If you dishonestly enter information or make a statement that you know is, or might be, untrue or misleading, and intend by doing so to make a gain for yourself or another person, or to cause loss or the risk of loss to another person, you may commit the offence of fraud under section 1 of the Fraud Act 2006, the maximum penalty for which is 10 years' imprisonment or an unlimited fine, or both.

I BELIEVE THAT THE FACTS AND MATTERS CONTAINED IN THIS FORM ARE TRUE

Signature: _____

Date: 18.3.2014

Print Name: _____

JOHN DAVID SIMKINS

(1st Partner)

You should keep a copy of the completed form

Data Protection Act 1998

Fair Processing Notice

The purpose of this Fair Processing Notice is to inform you of the use that will be made of your personal data, as required by the Data Protection Act 1998.

The appropriate authority (see explanation of definition in above guidance notes) in England is the data controller in respect of any personal data that you provide when you complete this form.

The information that you provide will be used by the appropriate authority in its duties to process applications to deposit statements, maps and declarations under section 31(6) the Highways Act 1980 and statements under section 15A(1) of the Commons Act 2006. The information you provide will also be used by the appropriate authority in its duty to upgrade the registers in which details of such deposits are recorded under the Dedicated Highways (Registers under Section 31A of the Highways Act 1980 (England) Regulations 2007 and the Commons (Registration of Town or Village Greens) and Dedicated Highways (Landowner Statements and Declarations) (England) Regulations 2013.

The appropriate authority is required by the legislation above to maintain a register which holds information provided in this form, which can be inspected online or in person by members of the public on request. It may also be required to release information, including personal data and commercial information, on request under the Environmental Information Regulations 2004 or the Freedom of Information Act 2000. However, the appropriate authority will not permit any unwarranted breach of confidentiality nor will they act in contravention of their obligations under the Data Protection Act 1998.

PART F

Statement of Truth

(all applicants must complete this part)

WARNING: If you dishonestly enter information or make a statement that you know is, or might be, untrue or misleading, and intend by doing so to make a gain for yourself or another person, or to cause loss or the risk of loss to another person, you may commit the offence of fraud under section 1 of the Fraud Act 2006, the maximum penalty for which is 10 years' imprisonment or an unlimited fine, or both.

I BELIEVE THAT THE FACTS AND MATTERS CONTAINED IN THIS FORM ARE TRUE

Signature: _____

Date: 18.3.14

th)

Print Name: _____

T. H. SIMKINS.

(2nd Partner)

You should keep a copy of the completed form

Data Protection Act 1998

Fair Processing Notice

The purpose of this Fair Processing Notice is to inform you of the use that will be made of your personal data, as required by the Data Protection Act 1998.

The appropriate authority (see explanation of definition in above guidance notes) in England is the data controller in respect of any personal data that you provide when you complete this form.

The information that you provide will be used by the appropriate authority in its duties to process applications to deposit statements, maps and declarations under section 31(6) the Highways Act 1980 and statements under section 15A(1) of the Commons Act 2006. The information you provide will also be used by the appropriate authority in its duty to upgrade the registers in which details of such deposits are recorded under the Dedicated Highways (Registers under Section 31A of the Highways Act 1980 (England) Regulations 2007 and the Commons (Registration of Town or Village Greens) and Dedicated Highways (Landowner Statements and Declarations) (England) Regulations 2013.

The appropriate authority is required by the legislation above to maintain a register which holds information provided in this form, which can be inspected online or in person by members of the public on request. It may also be required to release information, including personal data and commercial information, on request under the Environmental Information Regulations 2004 or the Freedom of Information Act 2000. However, the appropriate authority will not permit any unwarranted breach of confidentiality nor will they act in contravention of their obligations under the Data Protection Act 1998.

PART F

Statement of Truth

(all applicants must complete this part)

WARNING: If you dishonestly enter information or make a statement that you know is, or might be, untrue or misleading, and intend by doing so to make a gain for yourself or another person, or to cause loss or the risk of loss to another person, you may commit the offence of fraud under section 1 of the Fraud Act 2006, the maximum penalty for which is 10 years' imprisonment or an unlimited fine, or both.

I BELIEVE THAT THE FACTS AND MATTERS CONTAINED IN THIS FORM ARE TRUE

Signature: _____

Date: 18th March 2014

th)

Print Name: _____

K J Simkins

(3rd Partner)

You should keep a copy of the completed form

Data Protection Act 1998

Fair Processing Notice

The purpose of this Fair Processing Notice is to inform you of the use that will be made of your personal data, as required by the Data Protection Act 1998.

The appropriate authority (see explanation of definition in above guidance notes) in England is the data controller in respect of any personal data that you provide when you complete this form.

The information that you provide will be used by the appropriate authority in its duties to process applications to deposit statements, maps and declarations under section 31(6) the Highways Act 1980 and statements under section 15A(1) of the Commons Act 2006. The information you provide will also be used by the appropriate authority in its duty to upgrade the registers in which details of such deposits are recorded under the Dedicated Highways (Registers under Section 31A of the Highways Act 1980 (England) Regulations 2007 and the Commons (Registration of Town or Village Greens) and Dedicated Highways (Landowner Statements and Declarations) (England) Regulations 2013.

The appropriate authority is required by the legislation above to maintain a register which holds information provided in this form, which can be inspected online or in person by members of the public on request. It may also be required to release information, including personal data and commercial information, on request under the Environmental Information Regulations 2004 or the Freedom of Information Act 2000. However, the appropriate authority will not permit any unwarranted breach of confidentiality nor will they act in contravention of their obligations under the Data Protection Act 1998.

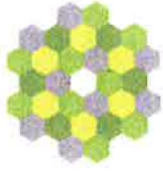

Title number **HD517908**
Ordnance Survey map reference **TL1432NW**
Scale **1:2500**
Administrative area **Hertfordshire: North Hertfordshire**

Land Registry
Official copy of
title plan

© Crown copyright and database rights 2012 Ordnance Survey 100028316.
You are not permitted to copy, sub-license, distribute or sell any of this data to third parties in any form.





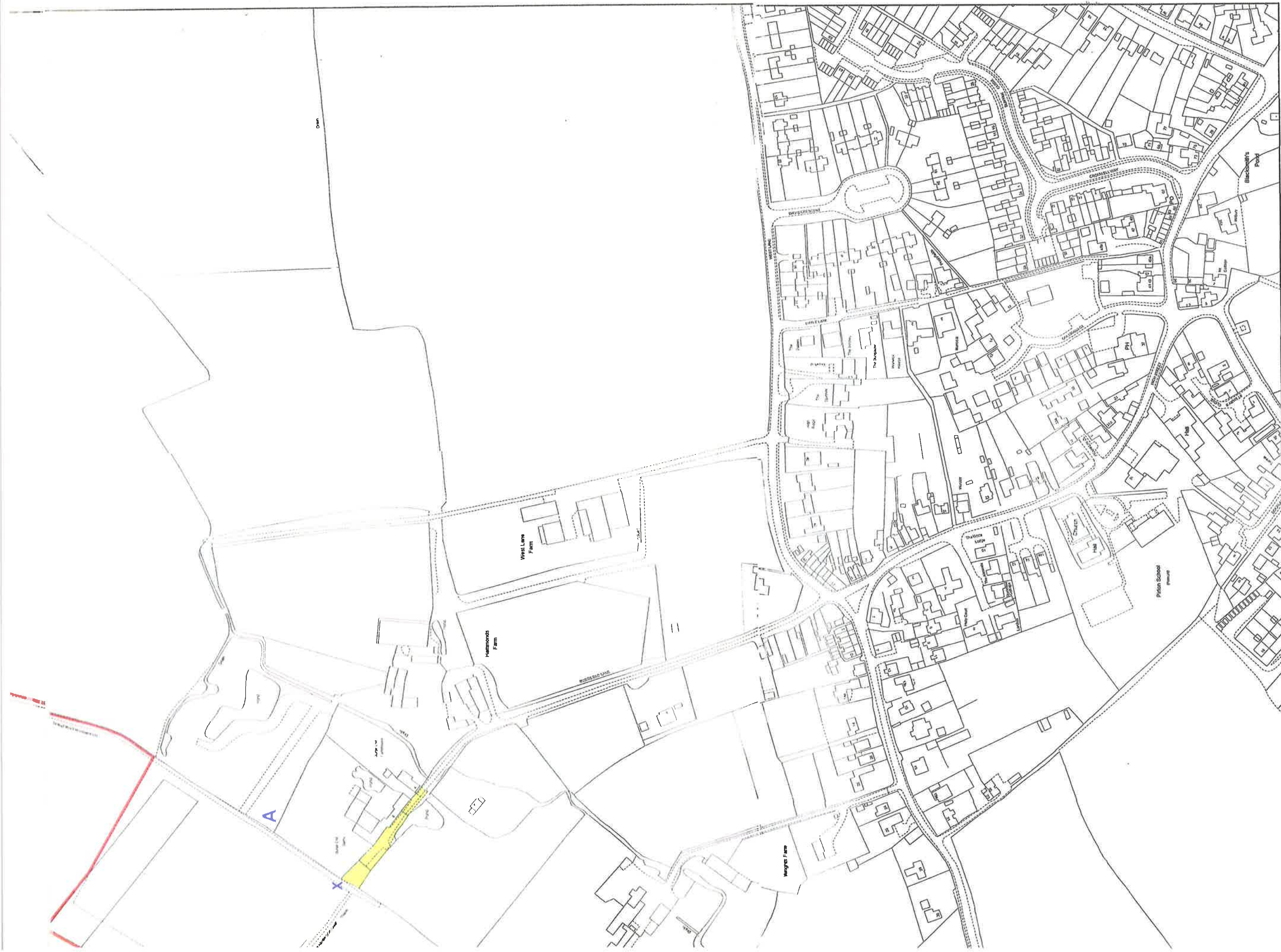

ial (s.67 Land Registration Act 2002).
atch measurements between the same points on the ground. See Land Registry Public Guide 19 - Title Plans and Boundaries.

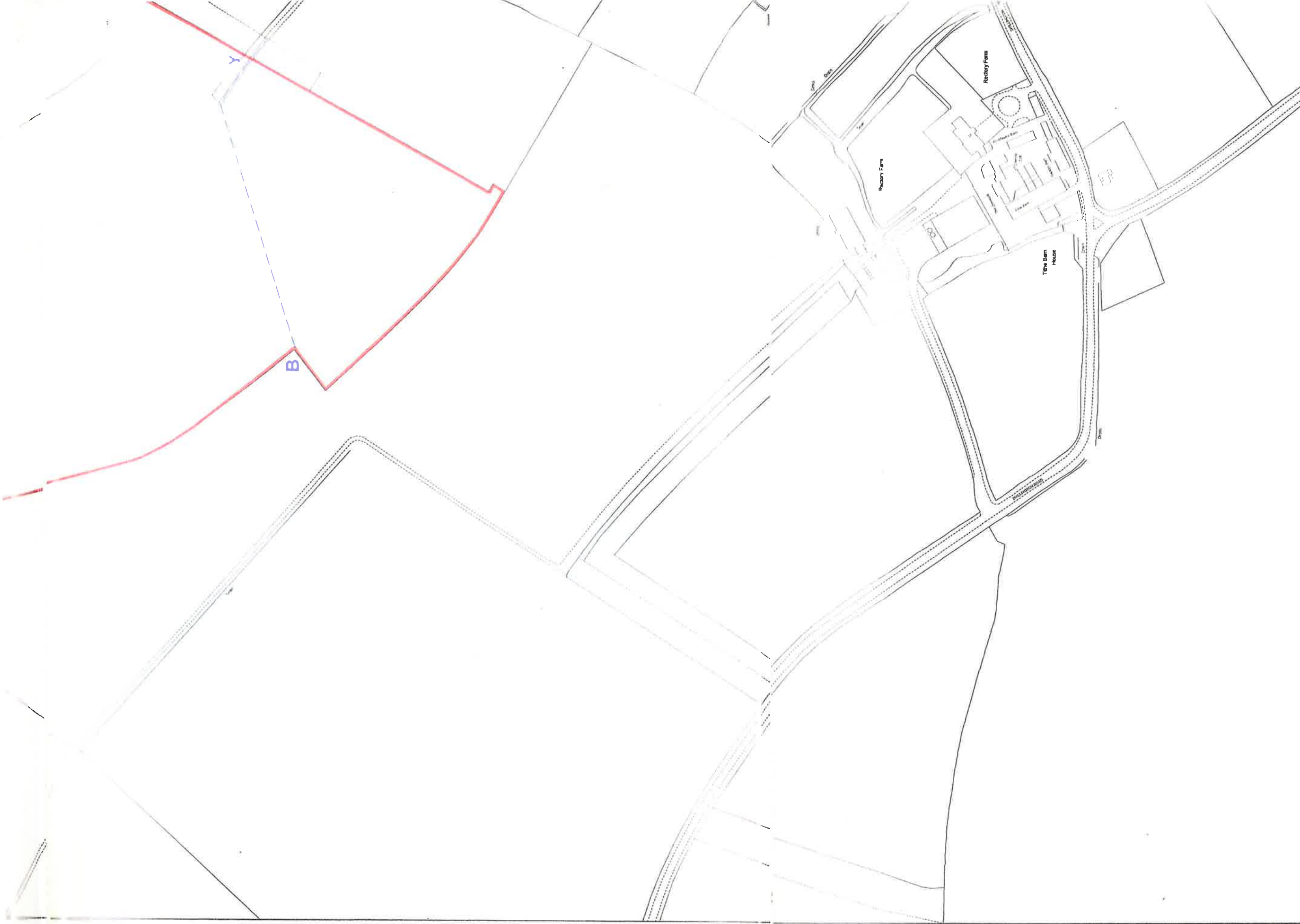

This official copy issued on 21 June 2012 shows the state of this title plan on 21 June 2012 at 14:35:51. It is admissible in evidence to the same extent as the original title plan. This title plan shows the general position, not the exact line, of the boundaries. It may be subject to distortions in scale. Measurements scaled from this plan may not be accurate. This title is dealt with by Land Registry, Leicester Office.

PART A

Information relating to the Applicant and Land to which the Application relates

(all applicants must complete this part)

- 1 Name of appropriate authority to which the application is addressed:

Hertfordshire County Council

- 2 Name and full address (including postcode) of applicant:

Name: John David Simkins, T/A David Simkins (1st of 3 Partners)

Address: Rosehill Farm

Shillington

HITCHIN

Hertfordshire

Postcode: SG5 3HE

- 3 Status of applicant (tick relevant box or boxes):

I am

(a) ☒

the owner of the land(s) described in paragraph 4.

(b) ☐

making this application and the statements/declarations it contains on behalf of *[insert name of owner]* who is the owner of the land(s) described in paragraph 4 and in my capacity as *[insert details]*.

- 4 Insert description of the land(s) to which the application relates (including full address and postcode):

Description of
Land(s):

One parcel of land comprising three agricultural fields,
namely: Millers Close, Washbrook Lane and North End.

Full address:

Burge End, Pirton, HITCHIN, Hertfordshire

Postcode

SG5 3QN (nearest residential property in Burge End)

- 5 Ordnance Survey six-figure grid reference(s) of a point within the area of land(s) to which the application relates (if known):

TL 1432 NW

- 6 This deposit comprises the following statement(s) and/or declarations (*tick relevant box or boxes*):

PART B

☐

PART C

☒

PART D

☒

PART A

Information relating to the Applicant and Land to which the Application relates

(all applicants must complete this part)

- 2 Name of appropriate authority to which the application is addressed:

Hertfordshire County Council

- 2 Name and full address (including postcode) of applicant:

Name: Jacqueline Helen Simkins, T/A David Simkins (2nd of 3 Partners)

Address: Rosehill Farm

Shillington

HITCHIN

Hertfordshire

Postcode: SG5 3HE

- 3 Status of applicant (tick relevant box or boxes):

I am

- (a) ☒ the owner of the land(s) described in paragraph 4.
(b) ☐ making this application and the statements/declarations it contains on behalf of *[insert name of owner]* who is the owner of the land(s) described in paragraph 4 and in my capacity as *[insert details]*.

- 4 Insert description of the land(s) to which the application relates (including full address and postcode):

Description of
Land(s):

One parcel of land comprising three agricultural fields,
namely: Millers Close, Washbrook Lane and North End.

Full address:

Burge End, Pirton, HITCHIN, Hertfordshire

Postcode

SG5 3QN (nearest residential property in Burge End)

- 5 Ordnance Survey six-figure grid reference(s) of a point within the area of land(s) to which the application relates (if known):

TL 1432 NW

- 6 This deposit comprises the following statement(s) and/or declarations *(tick relevant box or boxes)*:

PART B

☐

PART C

☒

PART D

☒

PART A

Information relating to the Applicant and Land to which the Application relates

(all applicants must complete this part)

- 3 Name of appropriate authority to which the application is addressed:

Hertfordshire County Council

- 2 Name and full address (including postcode) of applicant:

Name: Roger David Simkins, T/A David Simkins (3rd of 3 Partners)

Address: Rosehill Farm

Shillington

HITCHIN

Hertfordshire

Postcode: SG5 3HE

- 3 Status of applicant (tick relevant box or boxes):

I am

- (a) ☒ the owner of the land(s) described in paragraph 4.
(b) ☐ making this application and the statements/declarations it contains on behalf of *[insert name of owner]* who is the owner of the land(s) described in paragraph 4 and in my capacity as *[insert details]*.

- 4 Insert description of the land(s) to which the application relates (including full address and postcode):

Description of Land(s): One parcel of land comprising three agricultural fields, namely: Millers Close, Washbrook Lane and North End.

Full address: Burge End, Pirton, HITCHIN, Hertfordshire

Postcode: SG5 3QN (nearest residential property in Burge End)

- 5 Ordnance Survey six-figure grid reference(s) of a point within the area of land(s) to which the application relates (if known):

TL 1432 NW

- 6 This deposit comprises the following statement(s) and/or declarations (*tick relevant box or boxes*):

PART B

☐

PART C

☒

PART D

☒

PART C

Declaration under section 31(6) of the Highways Act 1980

- 1 I am the owner of the land described in paragraph 4 of Part A of this form and shown edged RED on the map lodged with Hertfordshire County Council on 25 March 2014.
- 2 On the 25th day of March 2014 I deposited with Hertfordshire County Council, being the appropriate council, a statement accompanied by a map showing my property edged RED which stated that:

no ways had been dedicated as highways over my property.
- 4 No additional ways have been dedicated over the land edged RED on the map referenced in paragraph 1 above since the statement dated 25 March 2014 referenced in paragraph 2 above and at the present time I have no intention of dedicating any public rights of way over my property.

PART D

Statement under section 15A(1) of the Commons Act 2006

I am the owner of the land described in paragraph 4 of Part A of this form and shown edged RED on the map deposited with Hertfordshire County Council on 25 March 2014.

I wish to bring to an end any period during which persons may have indulged as of right in lawful sports and pastimes on the whole or any part of the land shown edged RED on the map referenced above.

PART F

Statement of Truth

(all applicants must complete this part)

WARNING: If you dishonestly enter information or make a statement that you know is, or might be, untrue or misleading, and intend by doing so to make a gain for yourself or another person, or to cause loss or the risk of loss to another person, you may commit the offence of fraud under section 1 of the Fraud Act 2006, the maximum penalty for which is 10 years' imprisonment or an unlimited fine, or both.

I BELIEVE THAT THE FACTS AND MATTERS CONTAINED IN THIS FORM ARE TRUE

Signature: _____

Date: 1.4.2014

Print Name: _____

D. D. SIMKINS

(1st Partner)

You should keep a copy of the completed form

Data Protection Act 1998

Fair Processing Notice

The purpose of this Fair Processing Notice is to inform you of the use that will be made of your personal data, as required by the Data Protection Act 1998.

The appropriate authority (see explanation of definition in above guidance notes) in England is the data controller in respect of any personal data that you provide when you complete this form.

The information that you provide will be used by the appropriate authority in its duties to process applications to deposit statements, maps and declarations under section 31(6) the Highways Act 1980 and statements under section 15A(1) of the Commons Act 2006. The information you provide will also be used by the appropriate authority in its duty to upgrade the registers in which details of such deposits are recorded under the Dedicated Highways (Registers under Section 31A of the Highways Act 1980 (England) Regulations 2007 and the Commons (Registration of Town or Village Greens) and Dedicated Highways (Landowner Statements and Declarations) (England) Regulations 2013.

The appropriate authority is required by the legislation above to maintain a register which holds information provided in this form, which can be inspected online or in person by members of the public on request. It may also be required to release information, including personal data and commercial information, on request under the Environmental Information Regulations 2004 or the Freedom of Information Act 2000. However, the appropriate authority will not permit any unwarranted breach of confidentiality nor will they act in contravention of their obligations under the Data Protection Act 1998.

PART F

Statement of Truth

(all applicants must complete this part)

WARNING: If you dishonestly enter information or make a statement that you know is, or might be, untrue or misleading, and intend by doing so to make a gain for yourself or another person, or to cause loss or the risk of loss to another person, you may commit the offence of fraud under section 1 of the Fraud Act 2006, the maximum penalty for which is 10 years' imprisonment or an unlimited fine, or both.

I BELIEVE THAT THE FACTS AND MATTERS CONTAINED IN THIS FORM ARE TRUE

Signature: _____

Date: 1.4.14

Print Name: J. H. SIMKINS

(2nd Partner)

You should keep a copy of the completed form

Data Protection Act 1998

Fair Processing Notice

The purpose of this Fair Processing Notice is to inform you of the use that will be made of your personal data, as required by the Data Protection Act 1998.

The appropriate authority (see explanation of definition in above guidance notes) in England is the data controller in respect of any personal data that you provide when you complete this form.

The information that you provide will be used by the appropriate authority in its duties to process applications to deposit statements, maps and declarations under section 31(6) the Highways Act 1980 and statements under section 15A(1) of the Commons Act 2006. The information you provide will also be used by the appropriate authority in its duty to upgrade the registers in which details of such deposits are recorded under the Dedicated Highways (Registers under Section 31A of the Highways Act 1980 (England) Regulations 2007 and the Commons (Registration of Town or Village Greens) and Dedicated Highways (Landowner Statements and Declarations) (England) Regulations 2013.

The appropriate authority is required by the legislation above to maintain a register which holds information provided in this form, which can be inspected online or in person by members of the public on request. It may also be required to release information, including personal data and commercial information, on request under the Environmental Information Regulations 2004 or the Freedom of Information Act 2000. However, the appropriate authority will not permit any unwarranted breach of confidentiality nor will they act in contravention of their obligations under the Data Protection Act 1998.

PART F

Statement of Truth

(all applicants must complete this part)

WARNING: If you dishonestly enter information or make a statement that you know is, or might be, untrue or misleading, and intend by doing so to make a gain for yourself or another person, or to cause loss or the risk of loss to another person, you may commit the offence of fraud under section 1 of the Fraud Act 2006, the maximum penalty for which is 10 years' imprisonment or an unlimited fine, or both.

I BELIEVE THAT THE FACTS AND MATTERS CONTAINED IN THIS FORM ARE TRUE

Signature: _____

Date: 1st April 2014

Print Name: _____

KID SINKINS

(3rd Partner)

You should keep a copy of the completed form

Data Protection Act 1998

Fair Processing Notice

The purpose of this Fair Processing Notice is to inform you of the use that will be made of your personal data, as required by the Data Protection Act 1998.

The appropriate authority (see explanation of definition in above guidance notes) in England is the data controller in respect of any personal data that you provide when you complete this form.

The information that you provide will be used by the appropriate authority in its duties to process applications to deposit statements, maps and declarations under section 31(6) the Highways Act 1980 and statements under section 15A(1) of the Commons Act 2006. The information you provide will also be used by the appropriate authority in its duty to upgrade the registers in which details of such deposits are recorded under the Dedicated Highways (Registers under Section 31A of the Highways Act 1980 (England) Regulations 2007 and the Commons (Registration of Town or Village Greens) and Dedicated Highways (Landowner Statements and Declarations) (England) Regulations 2013.

The appropriate authority is required by the legislation above to maintain a register which holds information provided in this form, which can be inspected online or in person by members of the public on request. It may also be required to release information, including personal data and commercial information, on request under the Environmental Information Regulations 2004 or the Freedom of Information Act 2000. However, the appropriate authority will not permit any unwarranted breach of confidentiality nor will they act in contravention of their obligations under the Data Protection Act 1998.