

DEPOSIT UNDER SECTION 31 (6) HIGHWAYS ACT 1980

for

MR R HARMER

of

LYBURY FARM, LYBURY LANE,

REDBOURN, HERTS, AL3 7JJ

and

MRS M E HARMER

of

ST AGNELL'S FARM, LYBURY LANE,

REDBOURN, HERTS, AL3 7JL

ROBINSON & HALL
LAND & PROPERTY CONSULTANTS

**DEPOSIT UNDER THE
SECTION 31 (6) HIGHWAYS ACT 1980**

We, Robert Harmer, of Lybury Farm, Lybury Lane, Redbourn, Herts, and Mrs M E Harmer
of St Agnell's Farm, Lybury Lane, Redbourn, Herts JL declare:

THAT we are the freehold owners of all of the land at St Agnell's Farm edged pink on the attached
plan 36301/1A, located in the county of Hertfordshire.

THAT we recognise as public rights of way running over the land only those routes coloured red
and green on the attached plan 36301/3.

THAT we have no intention to dedicate any further ways to public use and wish this deposit to be
lodged with the appropriate council under Section 31 (6) of the Highways Act 1980 as evidence
that no intention of dedication should be presumed.

Signed:  on the 5th day of March 2008
Mr R Harmer

Signed: on the 5th day of March 2008
Mrs M E Harmer

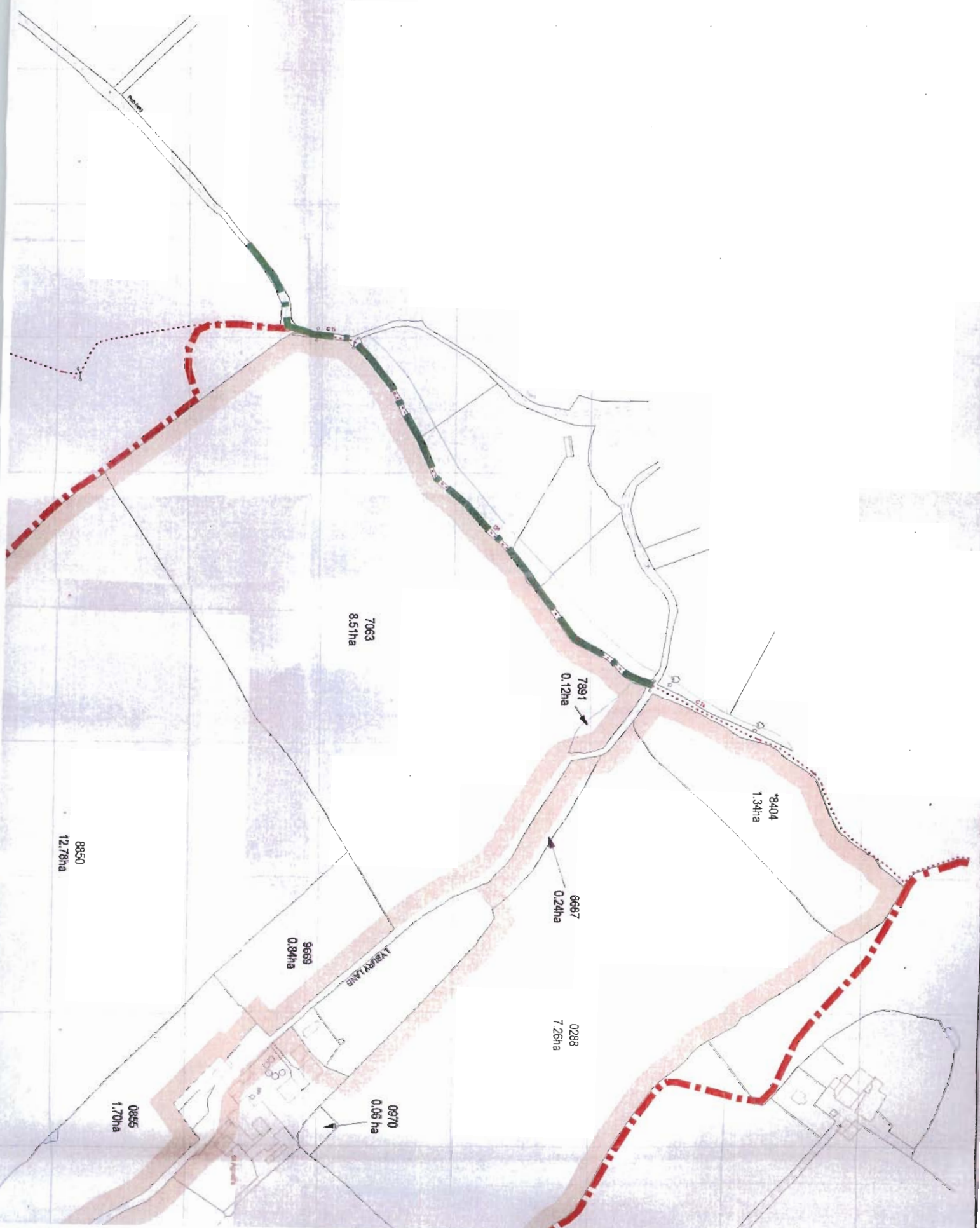

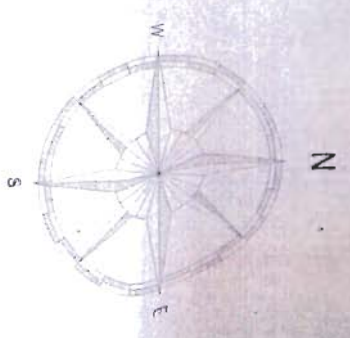
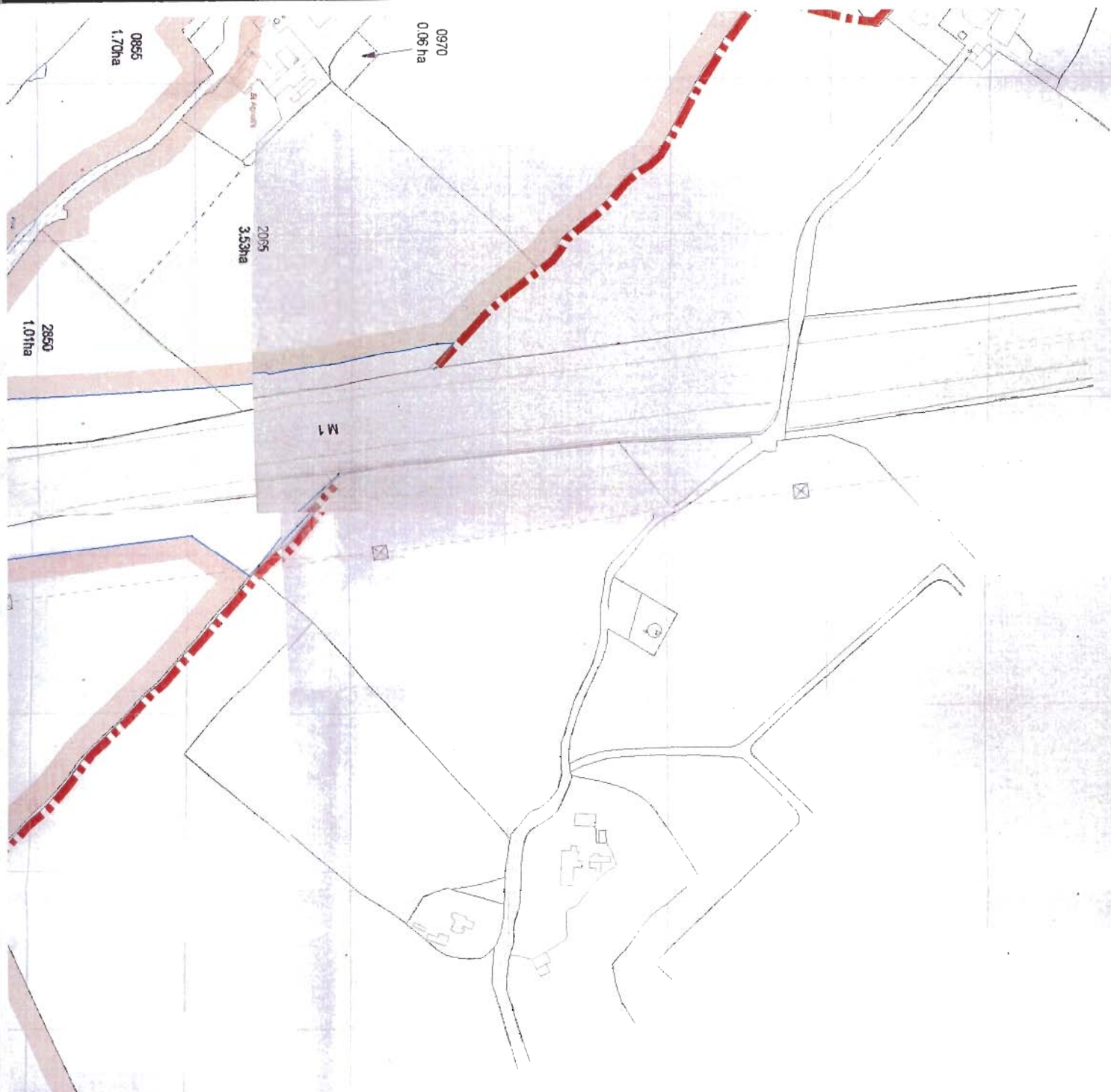

Based upon Ordnance Survey Sheets TL 0912, TL 0813 & TL 0913

Revisions

Project

St. Agnell's Farm
Lybury Lane
Redbourn
Hertfordshire

ROBINSON & HALL

118 Bromham Road, Bedford, Bedfordshire, MK40 2QN
Tel: (01234) 362201 Fax: (01234) 362919
Broomdale Business Centre, Little Blakenham, Ipswich, IP8 4JU
Tel: (01473) 831531 Fax: (01473) 832200
www.robinsonandhall.co.uk

Scale

1/2500

Date

October 2006

Drawn

MAR

Checked by

DS

Drawing No.

36301/3

KEY

Public Footpath
Public Bridleway

Measure
Green 112m
6606
1.42ha

0289
6.08ha

Redbourn Spine

1824
13.36ha

5538
8.25 ha

7836
5.25ha

7105
3.48 ha

Widdow's Spring

Widdow's Spring