

## STATUTORY DECLARATION

### SECTION 31 (6) OF THE HIGHWAYS ACT 1980

We D'Arblay Investments Limited DO SOLEMNLY AND SINCERELY DECLARE as follows:-

1. We are and have been since January 1993 the owners of the land known as 24.80 acres of land at Jersey Farm more particularly delineated on the plan accompanying this declaration and thereon edged red.
2. On the 25<sup>th</sup> March 2003 we deposited with Hertfordshire County Council, being the appropriate Council, a statement dated 25<sup>th</sup> March 2003 accompanied by a plan delineating our property by red edging which stated that no ways over the land on the said plan and the plan accompanying this declaration had been dedicated as highways over our property.
3. No additional ways have been dedicated over the land edged red on the plan accompanying this declaration since the statement deposited on 25<sup>th</sup> March 2003 referred to in 2 above and at the present time we have no intention of dedicating any more public right of way over our property.

AND WE MAKE this solemn declaration on the 16<sup>th</sup> day of December 2003 conscientiously believing it to be true and by virtue of the Statutory Declaration Act 1835.

Declared at (address) **ST. HELIER,  
ISLAND OF JERSEY,  
CHANNEL ISLANDS**

..... ise  
..... Centre  
St Helier  
Jersey  
JE4 8

(signature of land owner)  
For and on behalf of  
D'Arblay Investments Limited

.....  
..... er - Director

Before me.....  
(Commissioner for Oaths or a Justice of the Peace or Solicitor)

GEOFFREY ST. C. CORNWALL  
NOTARY PUBLIC  
3 CHARLES STREET  
ST. HELIER JERSEY JE2 4SF  
TEL: 01534 766088 FAX: 01534 766088



PHOTO-COPY

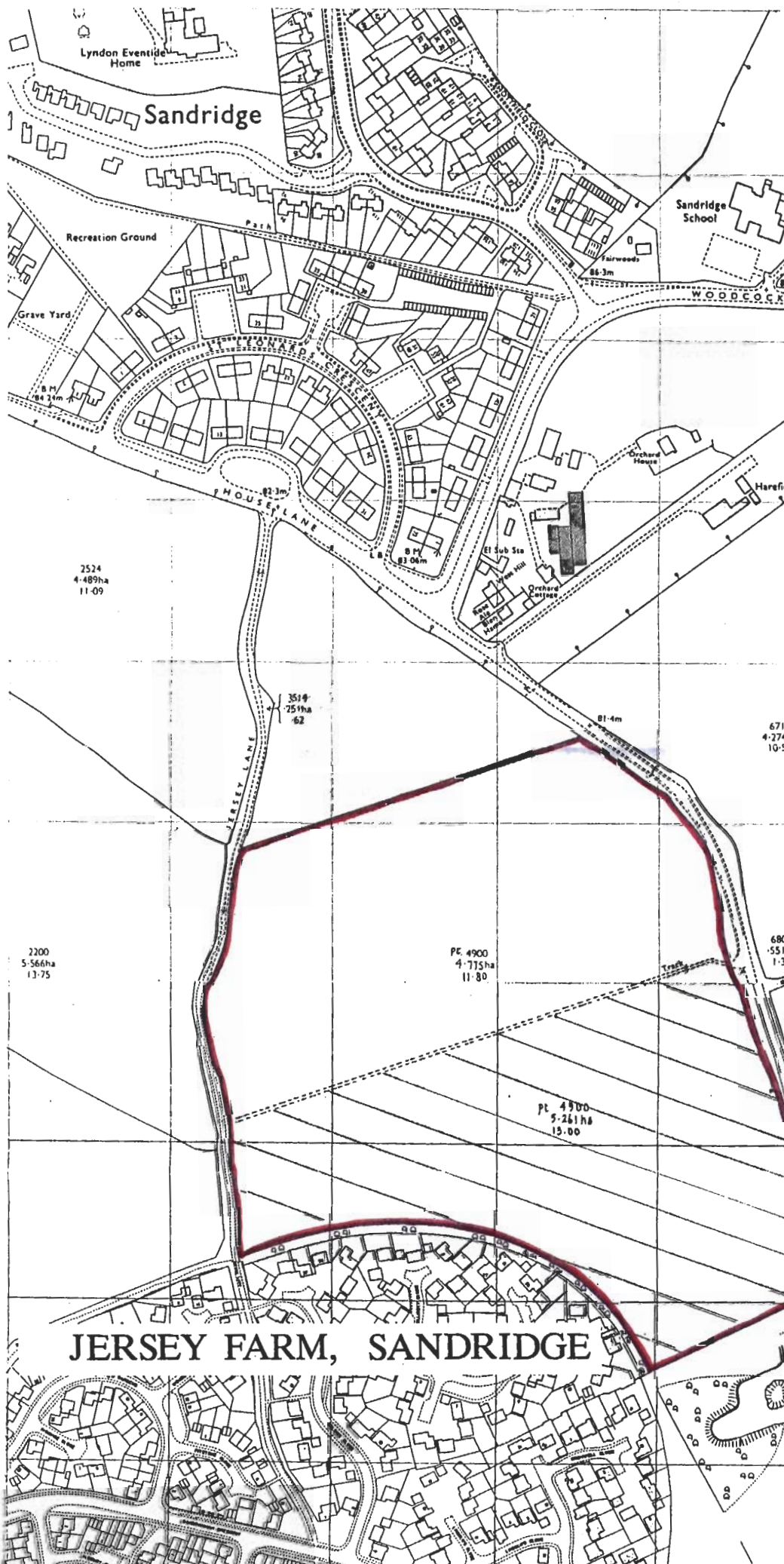

SCALE: 1/2500

**FAULKNERS**  
Chartered Surveyors  
49 HIGH STREET  
KINGS LANGLEY  
TEL: 09277 68166

**JERSEY FARM, SANDRIDGE**

for Sandridge Western Limited

3/2/2006