

REGISTER OF DEPOSITS

- **HIGHWAYS ACT 1980***
- **COMMONS ACT 2006***

(* tick if applicable or specify N/A)

DETAILS OF APPLICATION

Date Application received in prescribed form 27/02/18
Date by which any subsequent highways
declaration must be lodged 26/02/38

Parcel

District: East Herts Parish: High Wych & Sawbridgeworth

Address and postcode of buildings on each piece of land subject to the application to which a postcode has been assigned Arable land north of West Road
Sawbridgeworth
CM21 0BL

Nearest town/city to above Sawbridgeworth

OS 6 figure Grid Reference(s) for a point within the area of the land (if possible for postcode point above) TL 475 156

District: East Herts Parish: High Wych & Sawbridgeworth

Address and postcode of buildings on each piece of land subject to the application to which a postcode has been assigned Arable land south of West Road
Sawbridgeworth
CM21 0DH

Nearest town/city to above Sawbridgeworth

OS 6 figure Grid Reference(s) for a point within the area of the land (if possible for postcode point above) TL 470 148

District: East Herts

Parish: High Wych

Address and postcode of buildings
on each piece of land subject to the
application to which a postcode has
been assigned

Paddock east of High Wych Lane
High Wych
Sawbridgeworth
CM21 0JR

Nearest town/city to above

Sawbridgeworth

OS 6 figure Grid Reference(s)
for a point within the area of the land
(if possible for postcode point above)

TL 465 148



NOTICE OF LANDOWNER DEPOSITS under
Section 31(6) of the Highways Act 1980 and
Section 15A(1) of the Commons Act 2006
HERTFORDSHIRE COUNTY COUNCIL

An application to deposit a map and statement under section 31(6) of the Highways Act 1980 and deposit a statement under section 15A(1) of the Commons Act 2006 has been made in relation to the land (or lands) described below and shown edged red on the accompanying map.

PLEASE NOTE:

This deposit may affect rights over the land described below. Deposits made under section 31(6) of the Highways Act 1980 may prevent deemed dedication of public rights of way over such land under section 31(1) of that Act. Deposits made under section 15A(1) of the Commons Act 2006 may affect the ability to register such land as a town or village green under section 15 of that Act. For further information please see guidance at <https://www.gov.uk/guidance/town-and-village-greens-how-to-register>

Description of the land:

Arable land north of West Road, Sawbridgeworth, CM21 0BL
Arable land south of West Road, Sawbridgeworth, CM21 0DH
Paddock east of High Wych Lane, High Wych, CM21 0JR

Name of the parish, ward or district in which the land is situated:

East Herts district; High Wych and Sawbridgeworth parishes

The deposit was submitted by Savills on behalf of St Johns College Cambridge and was received by this authority on 27th February 2018.

The authority maintains a register of maps, statements and declarations deposited under section 31A of the Highways Act 1980 and section 15B of the Commons Act 2006. This register can be accessed online at www.hertfordshire.gov.uk/landownerdeposits or can be inspected free of charge at Hertfordshire County Council, County Hall, Pegs Lane, Hertford, Hertfordshire, SG13 8DN during office hours between 9:00am and 5:00 pm

Signed on behalf of Hertfordshire County Council:

Name and position of Signatory: R. Cuthbert Team Leader Access & Rights of Way

Date: 27th February 2018

PART A

Information relating to the Applicant and Land to which the Application relates

(all applicants must complete this part)

1 Name of appropriate authority to which the application is addressed:

Hertfordshire County Council

2 Name and full address (including postcode) of applicant:

Name: John Wootton
Address: Savills (UK) Ltd
Unex House
132-134 Hills Road
Cambridge
Postcode: CB2 8PA

3 Status of applicant (tick relevant box or boxes):

I am

- (a) the owner of the land(s) described in paragraph 4.
(b) making this application and the statements/declarations it contains on behalf of St John's College who is the owner of the land(s) described in paragraph 4 and in my capacity as agent.

4 Insert description of the land(s) to which the application relates (including full address and postcode):

Description of Land(s): **Parcel 1:** Arable land to the west of Sawbridgeworth and to the north of West Road.
Parcel 2: Arable land to the south of West Road and north of High Wych Road.
Parcel 3: Grass paddock that is located to the east of High Wych lane
Full address: Sawbridgeworth, Hertfordshire
Postcode: CM21 0BW

5 Ordnance Survey six-figure grid reference(s) of a point within the area of land(s) to which the application relates (if known):

Parcel 1: TL475156

Parcel 2: TL470148

Parcel 3: TL465148

6 This deposit comprises the following statement(s) and/or declarations (tick relevant box or boxes):

PART B
PART C
PART D

PART B

Statement under section 31(6) of the Highways Act 1980

St John's College, Cambridge is the owner of the land described in paragraph 4 of Part A of this form and shown edged *red* on the map accompanying this statement.

Ways shown *green* on the accompanying map are public bridleways.

Ways shown *blue* on the accompanying map are public footpaths.

No other ways over the land shown on the accompanying map coloured *pink* and edged *red* have been dedicated as highways.

PART D

Statement under section 15A(1) of the Commons Act 2006

St John's College, Cambridge is the owner of the land described in paragraph 4 of Part A of this form and shown edged *red* on the map accompanying this statement.

St John's College, Cambridge wishes to bring to an end any period during which persons may have indulged as of right in lawful sports and pastimes on the whole or any part of the land shown red on the map referenced above.

PART F

Statement of Truth

(all applicants must complete this part)

WARNING: If you dishonestly enter information or make a statement that you know is, or might be, untrue or misleading, and intend by doing so to make a gain for yourself or another person, or to cause loss or the risk of loss to another person, you may commit the offence of fraud under section 1 of the Fraud Act 2006, the maximum penalty for which is 10 years' imprisonment or an unlimited fine, or both.

I BELIEVE THAT THE FACTS AND MATTERS CONTAINED IN THIS FORM ARE TRUE

Signature: _____

(of the person making the statement of truth)

Date: 16/1/18

Print Name: _____

John Wootton, Savills

You should keep a copy of the completed form

Data Protection Act 1998

Fair Processing Notice

The purpose of this Fair Processing Notice is to inform you of the use that will be made of your personal data, as required by the Data Protection Act 1998.

The appropriate authority (see explanation of definition in above guidance notes) in England is the data controller in respect of any personal data that you provide when you complete this form.

The information that you provide will be used by the appropriate authority in its duties to process applications to deposit statements, maps and declarations under section 31(6) the Highways Act 1980 and statements under section 15A(1) of the Commons Act 2006. The information you provide will also be used by the appropriate authority in its duty to upgrade the registers in which details of such deposits are recorded under the Dedicated Highways (Registers under Section 31A of the Highways Act 1980 (England) Regulations 2007 and the Commons (Registration of Town or Village Greens) and Dedicated Highways (Landowner Statements and Declarations) (England) Regulations 2013.

The appropriate authority is required by the legislation above to maintain a register which holds information provided in this form, which can be inspected online or in person by members of the public on request. It may also be required to release information, including personal data and commercial information, on request under the Environmental Information Regulations 2004 or the Freedom of Information Act 2000. However, the appropriate authority will not permit any unwarranted breach of confidentiality nor will they act in contravention of their obligations under the Data Protection Act 1998.

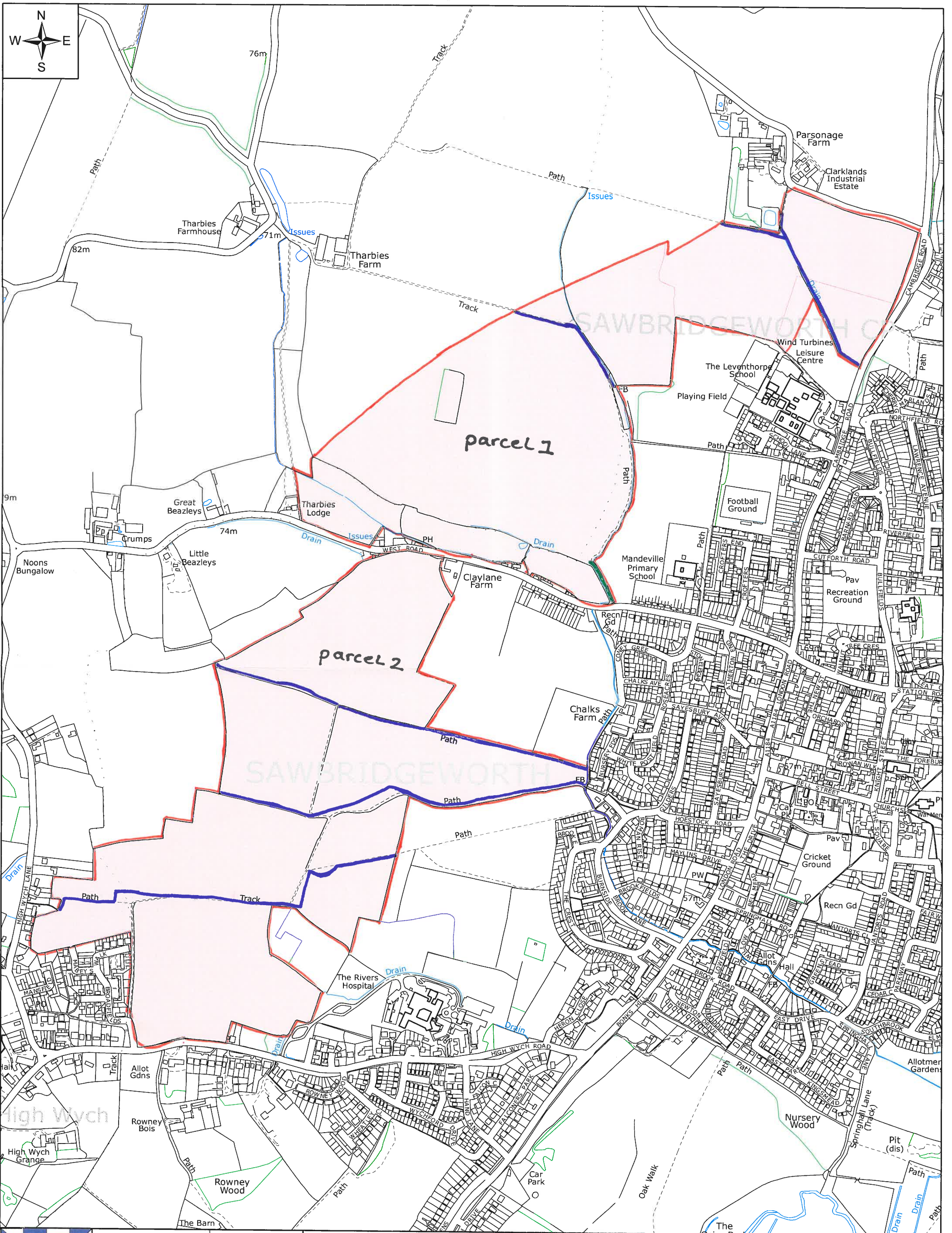

St John's College
Cambridge
CB2 1TP
United Kingdom

Tel: 01223 338600
k.lea@joh.cam.ac.uk

Property No.
932

County:
Rest of UK

Address:
Land to west of Sawbridgeworth

Scale: 1:8,000 O.S. Ref: TL4716 Plan No.: B.12,430 Date: 15/01/2018

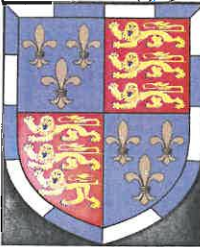
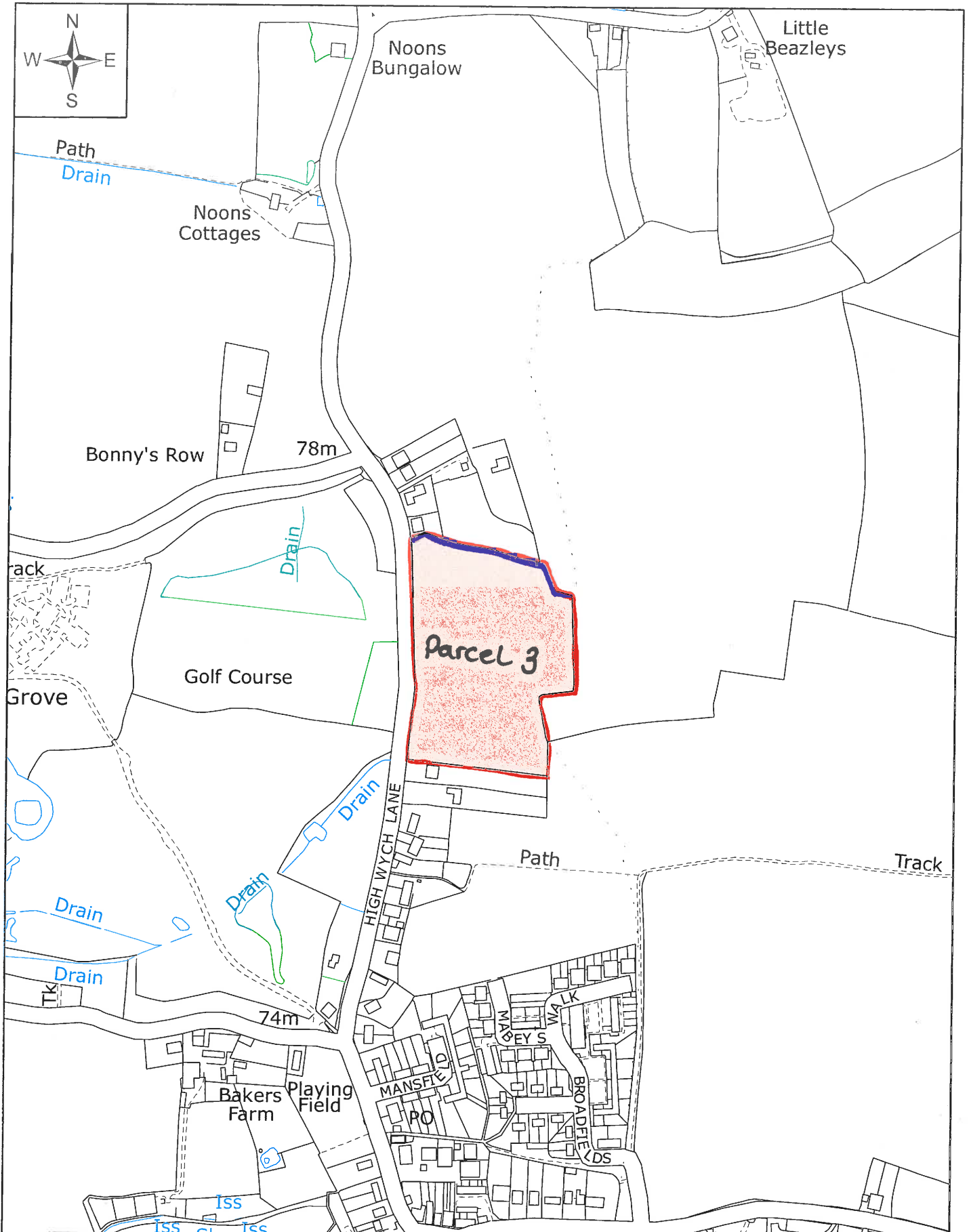

St John's College
Cambridge
CB2 1TP
United Kingdom

Tel: 01223 338600
k.lea@joh.cam.ac.uk

Property No. :
County :
Herts

Address :
Land at High Wych, Sawbridgeworth

Scale : 1:5,000 O.S. Ref : TL2614 Plan No : A.50,589 Date : 09/10/2017