

REGISTER OF DEPOSITS- **HIGHWAYS ACT 1980***- **COMMONS ACT 2006***

(* tick if applicable or specify N/A)

DETAILS OF APPLICATION

Date Application received in prescribed form 11/03/14

Date on which any highways declaration expires 18/03/14

Parcel

District Welwyn & Hatfield

Parish Tewin

Address and postcode of buildings
on each piece of land subject to the
application to which a postcode has
been assignedLadywalk
Queen Hoo Lane
Tewin
AL6 0LT

Nearest town/city to above

St Albans

OS 6 figure Grid Reference(s)
for a point within the area of the land
(if possible for postcode point above)

TL 275 166



NOTICE OF LANDOWNER DEPOSITS under
Section 31(6) of the Highways Act 1980 and
Section 15A(1) of the Commons Act 2006
HERTFORDSHIRE COUNTY COUNCIL

An application to deposit a map and statement under section 31(6) of the Highways Act 1980 and deposit a statement under section 15A(1) of the Commons Act 2006 has been made in relation to the land (or lands) described below and shown edged red on the accompanying map.

PLEASE NOTE:

This deposit may affect rights over the land described below. Deposits made under section 31(6) of the Highways Act 1980 may prevent deemed dedication of public rights of way over such land under section 31(1) of that Act. Deposits made under section 15A(1) of the Commons Act 2006 may affect the ability to register such land as a town or village green under section 15 of that Act. For further information please see guidance at <http://www.defra.gov.uk/rural/protected/greens/>

Description of the land:

Ladywalk, Queen Hoo Lane, Tewin, Hertfordshire, AL6 0LT

Name of the Parish, Ward or District in which the land(s) is situated:

Welwyn & Hatfield district; Tewin parish

The deposit was submitted by Anthony Hamilton and was received by this authority on 11th March 2014.

The authority maintains a register of maps, statements and declarations deposited under section 31A of the Highways Act 1980 and section 15B of the Commons Act 2006. This register can be accessed online at <http://www.hertsdirect.org/services/envplan/countrysideaccess/row/apps/deposit/>

or can be inspected free of charge at Hertfordshire County Council
County Hall Pegs Lane Hertford, Hertfordshire, SG13 8DN during office hours
between 9:00am and 5:00 pm

Signed on behalf of Hertfordshire County:

Name and position of Signatory: R. Cuthbert Team Leader Access & Rights of Way

Date: 11th March 2014

PART A

Information relating to the Applicant and Land to which the Application relates

(all applicants must complete this part)

1 Name of appropriate authority to which the application is addressed:
Hertfordshire County Council

2 Name and full address (including postcode) of applicant:

Name: Mr Anthony Carl Hamilton
Address: Ladywalk
Queen Hoo Lane
Tewin
Welwyn
Postcode: AL6 0LT

3 Status of applicant (tick relevant box or boxes):

I am

- (a) the owner of the land(s) described in paragraph 4.
(b) making this application and the statements/declarations it contains on behalf of [*insert name of owner*] who is the owner of the land(s) described in paragraph 4 and in my capacity as [*insert details*].

4 Insert description of the land(s) to which the application relates (including full address and postcode):

Description of Land(s): All that land at Ladywalk and Bramble Lodge

Full address: Queen Hoo Lane, Tewin, Welwyn
Postcode: AL6 0LT

5 Ordnance Survey six-figure grid reference(s) of a point within the area of land(s) to which the application relates (if known):

TL275166

6 This deposit comprises the following statement(s) and/or declarations (*tick relevant box or boxes*):

PART B
PART C
PART D

(delete Parts B, C or D from the form below where not applicable):

PART B

Statement under section 31(6) of the Highways Act 1980

I Anthony Carl Hamilton am the owner of the land described in paragraph 4 of Part A of this form and shown edged red on the map accompanying this statement.

(delete wording in square brackets as appropriate and/or insert information as required)

~~[Ways shown [insert colouring] on the accompanying map are byways open to all traffic.]~~

~~[Ways shown [insert colouring] on the accompanying map are restricted byways.]~~

~~[Ways shown [insert colouring] on the accompanying map are public bridleways.]~~

Ways shown coloured blue on the accompanying map are public footpaths.

No other ways over the land shown edged red on the accompanying map have been dedicated as highways.

(delete wording in square brackets as appropriate and/or insert information as required)

PART D

Statement under section 15A(1) of the Commons Act 2006

I, Anthony Carl Hamilton am the owner of the land described in paragraph 4 of Part A of this form and shown edged red on the map accompanying this statement.

I, Anthony Carl Hamilton wish to bring to an end any period during which persons may have indulged as of right in lawful sports and pastimes on the whole or any part of the land shown edged red on the accompanying map.

(delete wording in square brackets as appropriate and/or insert information as required)

PART E

Additional information relevant to the application

(insert any additional information relevant to the application)

None.

PART F

Statement of Truth

(all applicants must complete this part)

WARNING: If you dishonestly enter information or make a statement that you know is, or might be, untrue or misleading, and intend by doing so to make a gain for yourself or another person, or to cause loss or the risk of loss to another person, you may commit the offence of fraud under section 1 of the Fraud Act 2006, the maximum penalty for which is 10 years' imprisonment or an unlimited fine, or both.

I BELIEVE THAT THE FACTS AND MATTERS CONTAINED IN THIS FORM ARE TRUE

Signature: _____

(of the person making the statement of truth)

Date: 21 02 14

Print Name: Anthony Carl Hamilton

You should keep a copy of the completed form

Data Protection Act 1998 Fair Processing Notice

The purpose of this Fair Processing Notice is to inform you of the use that will be made of your personal data, as required by the Data Protection Act 1998.

The appropriate authority (see explanation of definition in above guidance notes) in England is the data controller in respect of any personal data that you provide when you complete this form.

The information that you provide will be used by the appropriate authority in its duties to process applications to deposit statements, maps and declarations under section 31(6) the Highways Act 1980 and statements under section 15A(1) of the Commons Act 2006. The information you provide will also be used by the appropriate authority in its duty to upgrade the registers in which details of such deposits are recorded under the Dedicated Highways (Registers under Section 31A of the Highways Act 1980 (England) Regulations 2007 and the Commons (Registration of Town or Village Greens) and Dedicated Highways (Landowner Statements and Declarations) (England) Regulations 2013.

The appropriate authority is required by the legislation above to maintain a register which holds information provided in this form, which can be inspected online or in person by members of the public on request. It may also be required to release information, including personal data and commercial information, on request under the Environmental Information Regulations 2004 or the Freedom of Information Act 2000. However, the appropriate authority will not permit any unwarranted breach of confidentiality nor will they act in contravention of their obligations under the Data Protection Act 1998.

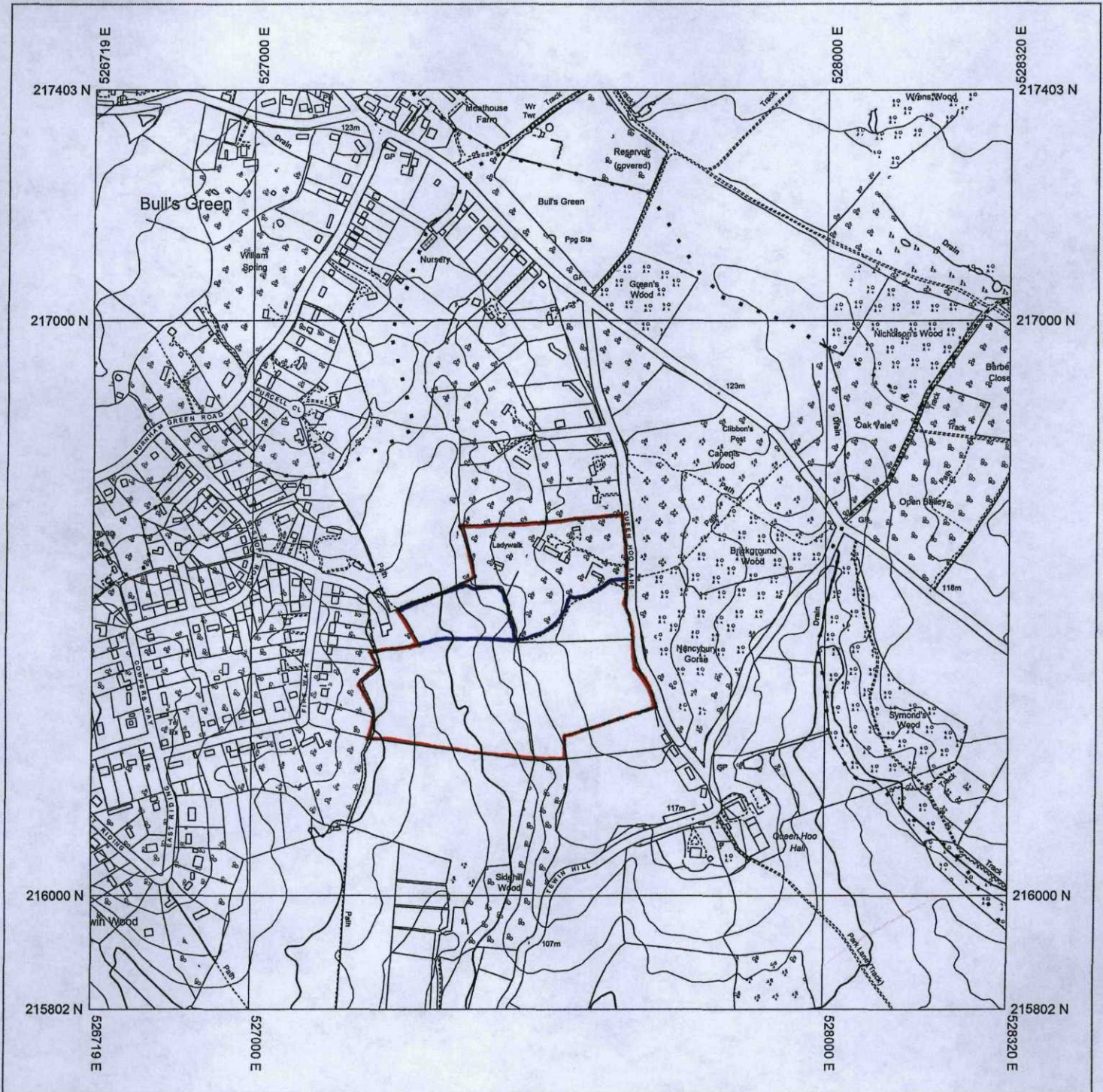

Produced 12/02/2014 from the Ordnance Survey National Geographic Database and incorporating surveyed revision available at this date. © Crown Copyright 2014

Reproduction in whole or in part is prohibited without the prior permission of Ordnance Survey

Ordnance Survey and the OS Symbol are registered trademarks of Ordnance Survey, the national mapping agency of Great Britain.

The representation of a road, track or path is no evidence of a right of way.

The representation of features as lines is no evidence of a property boundary.

Reproduced from the Ordnance Survey Map by permission of Ordnance Survey® on behalf of The Controller of Her Majesty's Stationery Office®. Crown Copyright. All rights reserved. Licence Number AL 1000 34373. Birketts LLP 2014

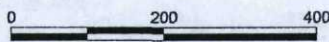

Scale 1:10000

Supplied By: **Hussey Knights Ipswich**

Serial number: 001134498

Plot Centre Coordinates: 527519, 216602

PART A

Information relating to the Applicant and Land to which the Application relates

(all applicants must complete this part)

1 Name of appropriate authority to which the application is addressed:
Hertfordshire County Council

2 Name and full address (including postcode) of applicant:

Name: Mr Anthony Carl Hamilton
Address: Ladywalk
Queen Hoo Lane
Tewin
Welwyn
Postcode: AL6 0LT

3 Status of applicant (tick relevant box or boxes):

I am

- (a) the owner of the land(s) described in paragraph 4.
(b) making this application and the statements/declarations it contains on behalf of [*insert name of owner*] who is the owner of the land(s) described in paragraph 4 and in my capacity as [*insert details*].

4 Insert description of the land(s) to which the application relates (including full address and postcode):

Description of Land(s): All that land at Ladywalk and Bramble Lodge

Full address: Queen Hoo Lane, Tewin, Welwyn
Postcode: AL6 0LT

5 Ordnance Survey six-figure grid reference(s) of a point within the area of land(s) to which the application relates (if known):

TL275166

6 This deposit comprises the following statement(s) and/or declarations (*tick relevant box or boxes*):

- PART B**
PART C
PART D

(delete Parts B, C or D from the form below where not applicable):

PART C

Declaration under section 31(6) of the Highways Act 1980

1 I, Anthony Carl Hamilton am the owner of the land described in paragraph 4 of Part A of this form and shown edged red on the map lodged with Hertfordshire County Council on 11 March 2014.

2 On the 11th day of March 2014 I, Anthony Carl Hamilton deposited with Hertfordshire County Council, being the appropriate council, a statement accompanied by a map showing my property edged red which stated that:

~~{the ways shown [insert colouring] on that map [and on the map accompanying this declaration] had been dedicated as byways open to all traffic}~~

~~{the ways shown [insert colouring] on that map [and on the map accompanying this declaration] had been dedicated as restricted byways}~~

~~{the ways shown [insert colouring] on that map [and on the map accompanying this declaration] had been dedicated as bridleways}~~

the ways shown blue on that map had been dedicated as footpaths

no other ways had been dedicated as highways over my property.

3 No additional ways have been dedicated over the land edged red on the map referenced in paragraph 1 above since the statement dated 11 March 2014 referenced to in paragraph 2 above and at the present time I, Anthony Carl Hamilton have no intention of dedicating any more public rights of way over my property.

PART F

Statement of Truth

(all applicants must complete this part)

WARNING: If you dishonestly enter information or make a statement that you know is, or might be, untrue or misleading, and intend by doing so to make a gain for yourself or another person, or to cause loss or the risk of loss to another person, you may commit the offence of fraud under section 1 of the Fraud Act 2006, the maximum penalty for which is 10 years' imprisonment or an unlimited fine, or both.

I BELIEVE THAT THE FACTS AND MATTERS CONTAINED IN THIS FORM ARE TRUE

Signature:

A Hamilton
(of the person making the statement of truth)

Date: 19/03/14

Print Name:

Anthony Carl Hamilton

You should keep a copy of the completed form

Data Protection Act 1998 Fair Processing Notice

The purpose of this Fair Processing Notice is to inform you of the use that will be made of your personal data, as required by the Data Protection Act 1998.

The appropriate authority (see explanation of definition in above guidance notes) in England is the data controller in respect of any personal data that you provide when you complete this form.

The information that you provide will be used by the appropriate authority in its duties to process applications to deposit statements, maps and declarations under section 31(6) the Highways Act 1980 and statements under section 15A(1) of the Commons Act 2006. The information you provide will also be used by the appropriate authority in its duty to upgrade the registers in which details of such deposits are recorded under the Dedicated Highways (Registers under Section 31A of the Highways Act 1980 (England) Regulations 2007 and the Commons (Registration of Town or Village Greens) and Dedicated Highways (Landowner Statements and Declarations) (England) Regulations 2013.

The appropriate authority is required by the legislation above to maintain a register which holds information provided in this form, which can be inspected online or in person by members of the public on request. It may also be required to release information, including personal data and commercial information, on request under the Environmental Information Regulations 2004 or the Freedom of Information Act 2000. However, the appropriate authority will not permit any unwarranted breach of confidentiality nor will they act in contravention of their obligations under the Data Protection Act 1998.

