

REGISTER OF DEPOSITS- **HIGHWAYS ACT 1980***- **COMMONS ACT 2006***

(* tick if applicable or specify N/A)

DETAILS OF APPLICATION

Date Application received in prescribed form 22/05/17

Date by which any subsequent highways
declaration must be lodged 21/05/37**Parcel**

District East Herts Parish Tewin

Address and postcode of buildings
on each piece of land subject to the
application to which a postcode has
been assigned Warrengate Farm
Tewin
AL6 0JD

Nearest town/city to above Hertford

OS 6 figure Grid Reference(s)
for a point within the area of the land
(if possible for postcode point above) TL 271 134



NOTICE OF LANDOWNER DEPOSITS under
Section 31(6) of the Highways Act 1980 and
Section 15A(1) of the Commons Act 2006
HERTFORDSHIRE COUNTY COUNCIL

An application to lodge a declaration under section 31(6) of the Highways Act 1980 and deposit a statement under section 15A(1) of the Commons Act 2006 has been made in relation to the land (or lands) described below and shown edged red on the accompanying map.

PLEASE NOTE:

This deposit may affect rights over the land described below. Deposits made under section 31(6) of the Highways Act 1980 may prevent deemed dedication of public rights of way over such land under section 31(1) of that Act. Deposits made under section 15A(1) of the Commons Act 2006 may affect the ability to register such land as a town or village green under section 15 of that Act. For further information please see guidance at <https://www.gov.uk/guidance/town-and-village-greens-how-to-register>

Description of the land:
Warrengate Farm, Tewin, AL6 0JD

Name of the parish, ward or district in which the land is situated:
East Herts district, Tewin parish

The deposit was submitted by Bidwells on behalf of Maria McQuaid and was received by this authority on 22nd May 2017.

The authority maintains a register of maps, statements and declarations deposited under section 31A of the Highways Act 1980 and section 15B of the Commons Act 2006. This register can be accessed online at www.hertfordshire.gov.uk/landownerdeposits or can be inspected free of charge at Hertfordshire County Council, County Hall, Pegs Lane, Hertford, Hertfordshire, SG13 8DN during office hours between 9:00am and 5:00 pm

Signed on behalf of Hertfordshire County Council: 
Name and position of Signatory: R. Cuthbert Team Leader Access & Rights of Way
Date: 24th May 2017

PART A

Information relating to the Applicant and Land to which the Application relates

(all applicants must complete this part)

1 Name of appropriate authority to which the application is addressed:
Hertfordshire County Council

2 Name and full address (including postcode) of applicant:

Name: Louise Newton
Address: Bidwells
45 Grosvenor Road,
St Albans

Postcode: AL1 3AW

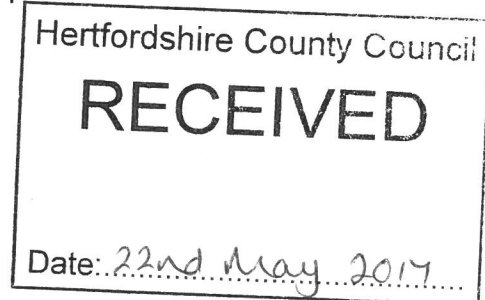

3 Status of applicant (tick relevant box or boxes):

I am

- (a) the owner of the land(s) described in paragraph 4.
(b) making this application and the statements/declarations it contains on behalf of Mrs Maria J McQuaid who is the owner of the land(s) described in paragraph 4 and in my capacity as Rural Surveyor.

4 Insert description of the land(s) to which the application relates (including full address and postcode):

Description of Land(s):	Approximately 71.62 acres (28.96 hectares) of land at Warrengate Farm,
Full address:	Tewin, Welwyn
Postcode	AL6 0JD

5 Ordnance Survey six-figure grid reference(s) of a point within the area of land(s) to which the application relates (if known):

TL271134

6 This deposit comprises the following statement(s) and/or declarations (tick relevant box or boxes):

- PART B**
PART C
PART D

(delete Parts B, C or D from the form below where not applicable):

PART C

Declaration under section 31(6) of the Highways Act 1980

- 1 Mrs Maria J McQuaid is the owner of the land described in paragraph 4 of Part A of this form and shown edged red on the map accompanying this declaration.
- 2 On the 3rd day of October 2012, Mrs Maria J McQuaid's predecessors in title Mr J A Barton and Mrs Z M Barton deposited with Hertfordshire County Council, being the appropriate council, a statement accompanied by a map showing Mrs Maria J McQuaid's property edged in red which stated that:

the ways shown in purple on that map and on the map accompanying this declaration had been dedicated as footpaths

no other ways had been dedicated as highways over Mrs Maria J McQuaid's property.
- 3 On the 29th day of October 2012, Mrs Maria J McQuaid's predecessors in title Mr J A Barton and Mrs Z M Barton deposited with Hertfordshire County Council, being the appropriate council, a declaration dated 29th October 2012, stating that no additional ways had been dedicated since the deposit of the statement referred to in paragraph 2 above.
- 4 No additional ways have been dedicated over the land shown edged red on the map referenced in paragraph 1 above since the date of the declaration referred to in paragraph 3 above and at the present time Mrs Maria J McQuaid has no intention of dedicating any more public rights of way over the property.

PART D

Statement under section 15A(1) of the Commons Act 2006

Mrs Maria J McQuaid is the owner of the land described in paragraph 4 of Part A of this form and shown edged red on the map accompanying this statement.

Mrs Maria J McQuaid wishes to bring to an end any period during which persons may have indulged as of right in lawful sports and pastimes on the whole or any part of the land shown edged red on the map referenced above.

PART F

Statement of Truth

(all applicants must complete this part)

WARNING: If you dishonestly enter information or make a statement that you know is, or might be, untrue or misleading, and intend by doing so to make a gain for yourself or another person, or to cause loss or the risk of loss to another person, you may commit the offence of fraud under section 1 of the Fraud Act 2006, the maximum penalty for which is 10 years' imprisonment or an unlimited fine, or both.

I BELIEVE THAT THE FACTS AND MATTERS CONTAINED IN THIS FORM ARE TRUE

Signature: _____
(of the person making the statement of truth)

Date: 19/05/2017

Print Name: LOUISE NEWTON

You should keep a copy of the completed form

Data Protection Act 1998

Fair Processing Notice

The purpose of this Fair Processing Notice is to inform you of the use that will be made of your personal data, as required by the Data Protection Act 1998.

The appropriate authority (see explanation of definition in above guidance notes) in England is the data controller in respect of any personal data that you provide when you complete this form.

The information that you provide will be used by the appropriate authority in its duties to process applications to deposit statements, maps and declarations under section 31(6) the Highways Act 1980 and statements under section 15A(1) of the Commons Act 2006. The information you provide will also be used by the appropriate authority in its duty to upgrade the registers in which details of such deposits are recorded under the Dedicated Highways (Registers under Section 31A of the Highways Act 1980 (England) Regulations 2007 and the Commons (Registration of Town or Village Greens) and Dedicated Highways (Landowner Statements and Declarations) (England) Regulations 2013.

The appropriate authority is required by the legislation above to maintain a register which holds information provided in this form, which can be inspected online or in person by members of the public on request. It may also be required to release information, including personal data and commercial information, on request under the Environmental Information Regulations 2004 or the Freedom of Information Act 2000. However, the appropriate authority will not permit any unwarranted breach of confidentiality nor will they act in contravention of their obligations under the Data Protection Act 1998.

Land at Warrengate Farm, Tewin

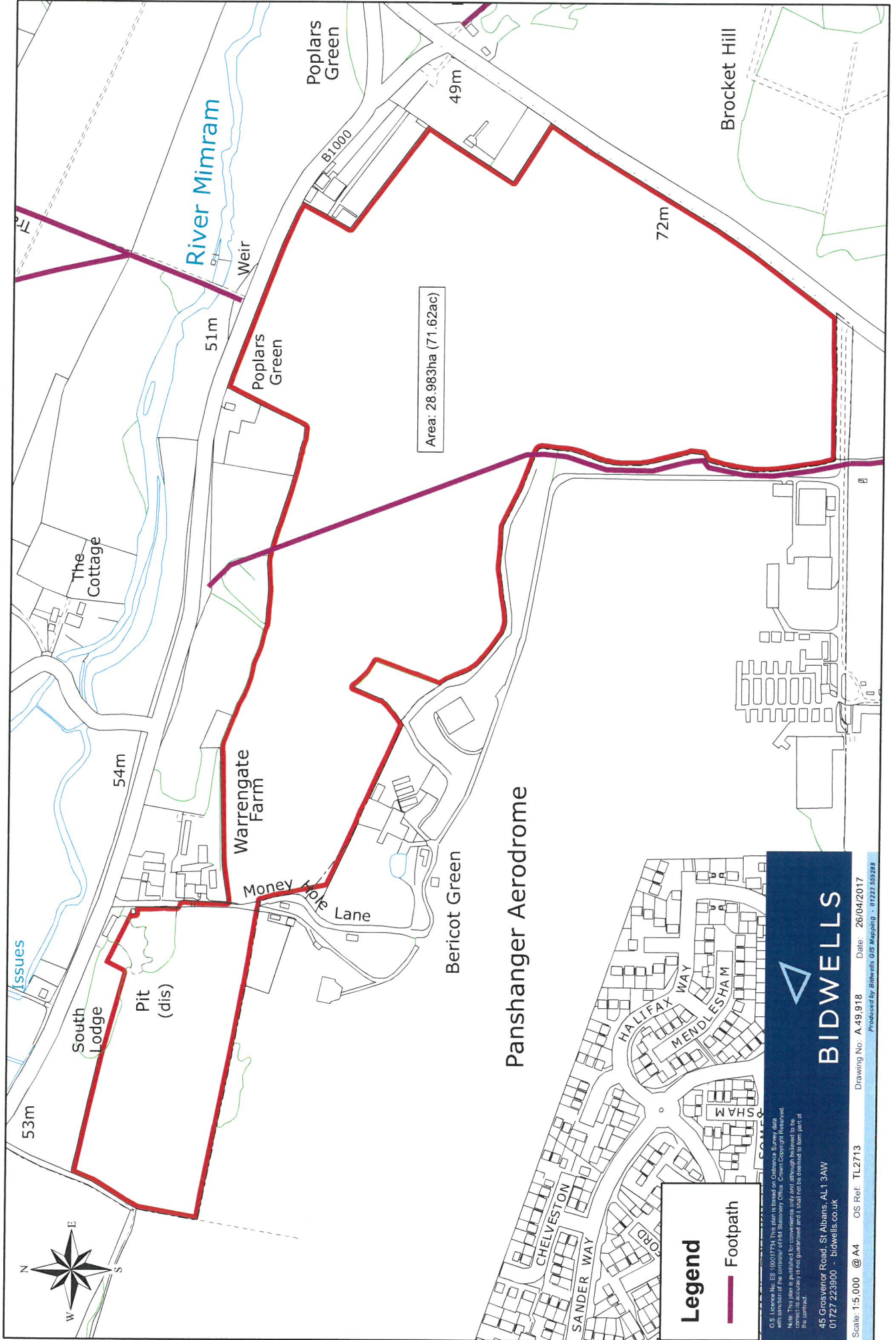

Legend

Footpath

OS Licence No. ES 10017934. This plan is based on Ordnance Survey data with sanction of the controller of Her Majesty's Stationery Office. Crown Copyright Reserved. Note: This plan is published for convenience only and although believed to be accurate it is not guaranteed and is not to be relied on as part of the contract.

45 Grosvenor Road, St Albans, AL1 3AW
01727 223900 - bidwells.co.uk



BIDWELLS

Scale: 1:5,000 @ A4 OS Ref: TL2713 Drawing No: A.49.918 Date: 26/04/2017
Produced by Bidwells GIS Mapping - 01223 559268