

REGISTER OF DEPOSITS

Highways Act 1980 **X**

Commons Act 2006 **N/A**

DETAILS OF APPLICATION

Date Application received in prescribed form 01/07/2022

Date by which any subsequent highways declaration must be lodged 30/06/2042

Parcel

District	North Hertfordshire	Parish	Kelshall & Therfield
Address and postcode of buildings on each piece of land subject to the application to which a postcode has been assigned		Land at Thrift Farm Baldock Road, Royston. SG8 9NN	
Nearest town / city to above		Royston	
OS 6 figure Grid Reference(s) for a point within the area of the land (if possible, for postcode point above)		TL 313 095	

NOTICE OF LANDOWNER DEPOSITS under Section 31(6) of the Highways Act 1980 and Section 15A(1) of the Commons Act 2006

HERTFORDSHIRE COUNTY COUNCIL

An application to deposit a map and statement under section 31(6) of the Highways Act 1980 has been made in relation to the land (or lands) described below and shown edged red on the accompanying map.

PLEASE NOTE: - This deposit may affect rights over the land described below. Deposits made under section 31(6) of the Highways Act 1980 may prevent deemed dedication of public rights of way over such land under section 31(1) of that Act. Deposits made under section 15A(1) of the Commons Act 2006 may affect the ability to register such land as a town or village green under section 15 of that Act. For further information please see guidance at <https://www.gov.uk/guidance/town-and-village-greens-how-to-register>

Description of land: - Land at Thrift Farm

Name of the parish, ward or district in which the land is situated: Kelshall & Therfield, North Hertfordshire

The deposit was submitted by Katie Hills on behalf of Robert Law and was received by this authority on 06/07/2022.

The authority maintains a register of maps, statements and declarations deposited under section 31A of the Highways Act 1980 and section 15B of the Commons Act 2006. This register can be accessed online at www.hertfordshire.gov.uk/landownerdeposits or can be inspected free of charge at Hertfordshire County Council, County Hall, Pegs Lane, Hertford, Hertfordshire, SG13 8DN during office hours between 9:00am and 5:00 pm

Signed on behalf of Hertfordshire County Council:



Name and position of Signatory: R. Cuthbert, Definitive Map & Enforcement Team Leader. Date: 06/07/2022



Application Form

Form CA16

Application Form for deposits under section 31(6) of the Highways Act 1980 and section 15A(1) of the Commons Act 2006

Please read the following guidance carefully before completing this form

1. *Guidance relating to completion of this form is available from <https://www.gov.uk/town-and-village-greens-how-to-register>. Please refer to these separate notes when completing this form.*

2. *Parts A and F must be completed in all cases.*

3. *The form must be signed and dated by, or by a duly authorised representative of, every owner of land to which the application relates who is an individual, and by the secretary or some other duly authorised officer of every owner of land to which the application relates which is a body corporate or an unincorporated association.*

4. *In the case of land in joint ownership all the joint owners must complete paragraphs 2 and 3 of Part A and complete and sign the application in Part F, unless a duly authorised representative completes and signs the form on behalf of all of the owners of the land. Paragraph 3 should be completed in full to clearly explain the capacity of each applicant e.g. trustee, landowner's managing agent, executor.*

5. *'Owner' is defined in section 61(3) of the Commons Act 2006 and section 31(7) of the Highways Act 1980 and means, broadly, a legal owner of the freehold interest in the land.*

6. *Where the application relates to more than one parcel of land, a description of each parcel should be included in Paragraph 4 of Part A and the remainder of the form should be completed to clearly identify which statement and/or declaration relates to which parcel of land. This may require the insertion of additional wording. See separate notes for further guidance. Multiple parcels of land should be clearly identified by coloured edging on any accompanying map.*

7. *Where a statement or declaration requires reference to colouring shown on an accompanying map or previously lodged map, the colouring must be clearly specified and must match that shown on the relevant map. For example, if a footpath is specified in a Part C declaration as shown coloured brown, the accompanying map or previously deposited map referred to must reflect that colouring.*

8. *An application must be accompanied by an ordnance map, or (in respect of declarations under Part C or statements under Part D of this form) refer to a map previously deposited in accordance with the Commons (Registration of Town or Village Greens) and Dedicated Highways (Landowner Statements and Declaration) (England) Regulations 2013 or (if deposited before 1st October 2013) in accordance with section 31(6) of the Highways Act 1980. Any accompanying map must be an ordnance map at a scale of not less than 1:10,560 showing the boundary of the land to which the application relates in coloured edging.*

9. *An application must be accompanied by the requisite fee – please ask the appropriate authority for details.*

10. 'Appropriate authority' means (a) in relation to a map or statement deposited or declaration lodged under section 31(6) of that Act, an appropriate council (as defined in section 31(7) of the Highways Act 1980); and (b) in relation to a statement and map deposited under section 15A(1) of the 2006 Act, a commons registration authority (defined in section 4 of the Commons Act 2006 and section 2 of the Commons Registration Act 1965). In practice, the appropriate council and commons registration authority will usually be the same body.

**PART A: Information relating to the applicant and land to which the application relates
(all applicants must complete this Part)**

1. Name of appropriate authority to which the application is addressed:

Hertfordshire County Council

2. Name and full address (including postcode) of applicant:

Katie Hilton
Cheffins
Clifton House
1 & 2 Clifton Road
Cambridge
CB1 7EA

3. Status of applicant (tick relevant box or boxes):

I am

- (a) the owner of the land(s) described in paragraph 4.
(b) making this application and the statements/declarations it contains on behalf of Cheffins on behalf of Mr Robert Law who is the owner of the land described in paragraph 4 and in my capacity as land agent.

4. Insert description of the land(s) to which the application relates (including full address and postcode):

This application relates to land at Thrift Farm, Baldock Road, Royston, Hertfordshire SG8 9NN shown outlined in RED on the plan annexed hereto. The land area encompasses 320 hectares (791 acres) defined by Rural Land Register (RLR) field parcel numbers as follows:

TL3138 0958	TL3139 6905	TL3239 0313	TL3339 2215
TL3138 2162	TL3139 8001	TL3238 4482	TL3338 4766
TL3138 3130	TL3138 7191	TL3238 5457	TL3339 5722
TL3138 4215	TL3138 8469	TL3238 6560	TL3339 3534
TL3137 6585	TL3138 9168	TL3238 4461	TL3339 2249
TL3138 3747	TL3238 1568	TL3239 5420	TL3339 2053
TL3138 4286	TL3139 7425	TL3238 7778	TL3339 3950
TL3138 4065	TL3139 8415	TL3238 9857	TL3339 4767
TL3138 5248	TL3139 9208	TL3239 9214	TL3339 5980
TL3138 8236	TL3139 9726	TL3239 6462	
TL3139 7111	TL3239 1931	TL3339 0837	
TL3139 8320	TL3239 2701	TL3339 2341	

5. Ordnance Survey six-figure grid reference(s) of a point within the area of land(s) to which the application relates (if known):

TL321386

6. This deposit comprises the following statement(s) and/or declarations (*delete Parts B, C, or D where not applicable*):

Part B

PART B: Statement under section 31(6) of the Highways Act 1980

Mr Robert Law is the owner of the land described in paragraph 4 of Part A of this form and shown outlined in RED on the map accompanying this statement.

Ways shown BLUE on the accompanying map are public footpaths.

No other ways over the land shown outlined in RED on the accompanying map have been dedicated as highways.

PART F: Statement of Truth
(all applicants must complete this Part)

WARNING: If you dishonestly enter information or make a statement that you know is, or might be, untrue or misleading, and intend by doing so to make a gain for yourself or another person, or to cause loss or the risk of loss to another person, you may commit the offence of fraud under section 1 of the Fraud Act 2006, the maximum penalty for which is 10 years' imprisonment or an unlimited fine, or both.

I BELIEVE THAT THE FACTS AND MATTERS CONTAINED IN THIS FORM ARE TRUE

Signature (of the person making the statement of truth): 

Print full name: Katie Hilton BSc (Hons) MBIAC for and on behalf of Cheffins

Date: 01/07/2022

You should keep a copy of the completed form

Data Protection Act 1998 - Fair Processing Notice

The purpose of this Fair Processing Notice is to inform you of the use that will be made of your personal data, as required by the Data Protection Act 1998.

The appropriate authority (see explanation of definition in above guidance notes) in England is the data controller in respect of any personal data that you provide when you complete this form.

The information that you provide will be used by the appropriate authority in its duties to process applications to deposit statements, maps and declarations under section 31(6) the Highways Act 1980 and statements under section 15A(1) of the Commons Act 2006. The information you provide will also be used by the appropriate authority in its duty to update the registers in which details of such deposits are recorded under the Dedicated Highways (Registers under Section 31A of the Highways Act 1980) (England) Regulations 2007 and the Commons (Registration of Town or Village Greens) and Dedicated Highways (Landowner Statements and Declarations) (England) Regulations 2013.

The appropriate authority is required by the legislation above to maintain a register which holds information provided in this form, which can be inspected online or in person by members of the public on request. It may also be required to release information, including personal data and commercial information, on request under the Environmental Information Regulations 2004 or the Freedom of Information Act 2000. However, the appropriate authority will not permit any unwarranted breach of confidentiality nor will they act in contravention of their obligations under the Data Protection Act 1998.

Thrift Farm, Baldock Road, Royston, Hertfordshire SG8 9NN

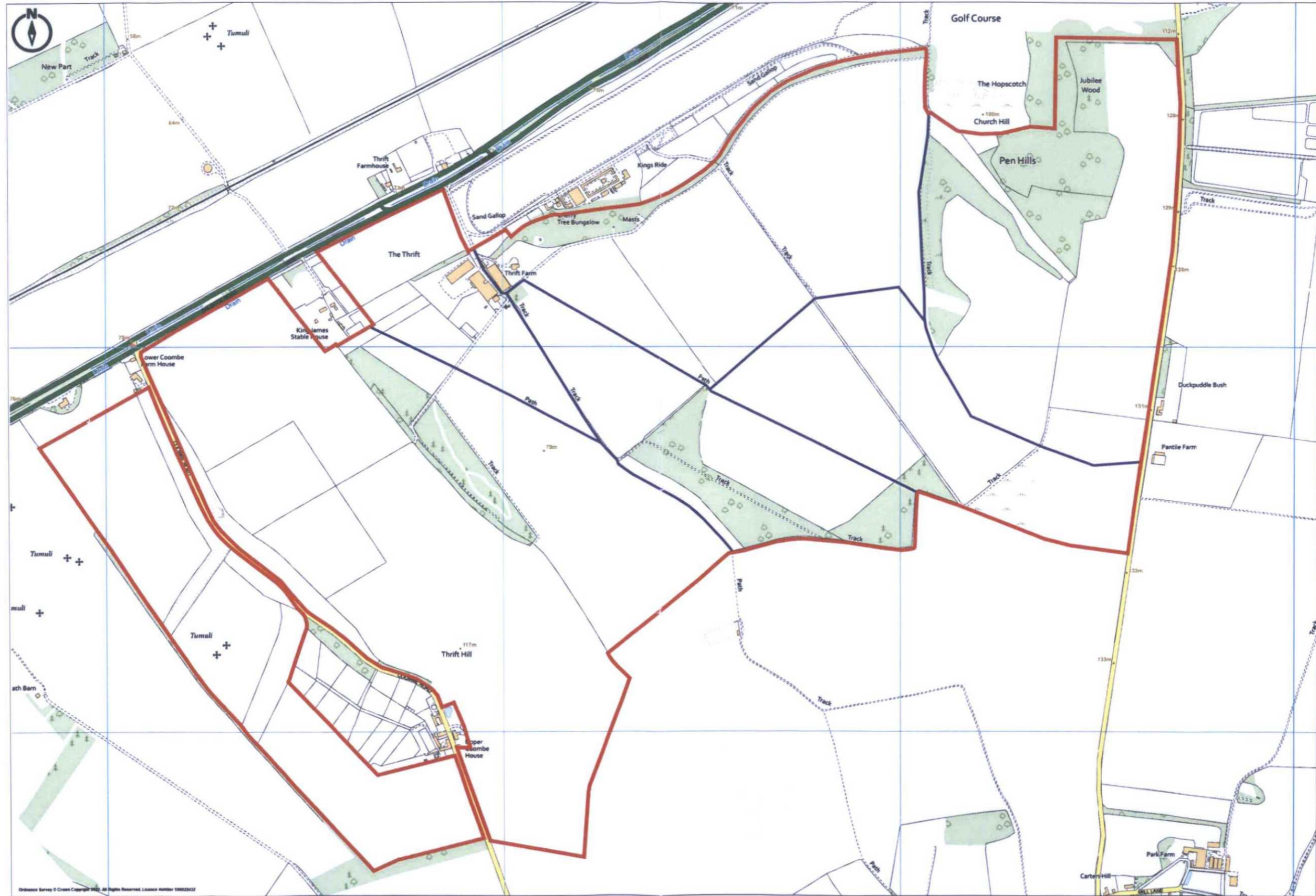

Promap
LANDMARK INFORMATION

Ordnance Survey © Crown Copyright 2022. All Rights Reserved.
License number 100022432
Plotted Scale - 1:10000. Paper Size - A3

CHEFFINS

For Identification Purposes Only

REGISTER OF DEPOSITS

Highways Act 1980 **X**

Commons Act 2006 **N/A**

DETAILS OF APPLICATION

Date Application received in prescribed form 22/11/2022

Date by which any subsequent highways declaration must be lodged 21/11/2042

Parcel

District	North Hertfordshire	Parish	Kelshall & Therfield
Address and postcode of buildings on each piece of land subject to the application to which a postcode has been assigned		Land at Thrift Farm Baldock Road, Royston. SG8 9NN	
Nearest town / city to above		Royston	
OS 6 figure Grid Reference(s) for a point within the area of the land (if possible, for postcode point above)		TL 313 095	

NOTICE OF LANDOWNER DEPOSITS under Section 31(6) of the Highways Act 1980 and Section 15A(1) of the Commons Act 2006

HERTFORDSHIRE COUNTY COUNCIL

An application to lodge a declaration under section 31(6) of the Highways Act 1980 has been made in relation to the land (or lands) described below and shown edged red on the accompanying map.

PLEASE NOTE: - This deposit may affect rights over the land described below. Deposits made under section 31(6) of the Highways Act 1980 may prevent deemed dedication of public rights of way over such land under section 31(1) of that Act. Deposits made under section 15A(1) of the Commons Act 2006 may affect the ability to register such land as a town or village green under section 15 of that Act. For further information please see guidance at <https://www.gov.uk/guidance/town-and-village-greens-how-to-register>

Description of land: - Land at Thrift Farm

Name of the parish, ward or district in which the land is situated: Kelshall & Therfield, North Hertfordshire

The deposit was submitted by Katie Hills on behalf of Robert Law and was received by this authority on 22/11/2022.

The authority maintains a register of maps, statements and declarations deposited under section 31A of the Highways Act 1980 and section 15B of the Commons Act 2006. This register can be accessed online at www.hertfordshire.gov.uk/landownerdeposits or can be inspected free of charge at Hertfordshire County Council, County Hall, Pegs Lane, Hertford, Hertfordshire, SG13 8DN during office hours between 9:00am and 5:00 pm

Signed on behalf of Hertfordshire County Council:



Name and position of Signatory: R. Cuthbert, Definitive Map & Enforcement Team Leader. Date: 07/12/2022



Hertfordshire

Crow Received

SCHEDULE 1

Regulation 2(2)(a)

22/11/2022

Application Form

Form CA16

Application Form for deposits under section 31(6) of the Highways Act 1980 and section 15A(1) of the Commons Act 2006

Please read the following guidance carefully before completing this form

1. *Guidance relating to completion of this form is available from <https://www.gov.uk/town-and-village-greens-how-to-register>. Please refer to these separate notes when completing this form.*

2. *Parts A and F must be completed in all cases.*

3. *The form must be signed and dated by, or by a duly authorised representative of, every owner of land to which the application relates who is an individual, and by the secretary or some other duly authorised officer of every owner of land to which the application relates which is a body corporate or an unincorporated association.*

4. *In the case of land in joint ownership all the joint owners must complete paragraphs 2 and 3 of Part A and complete and sign the application in Part F, unless a duly authorised representative completes and signs the form on behalf of all of the owners of the land. Paragraph 3 should be completed in full to clearly explain the capacity of each applicant e.g. trustee, landowner's managing agent, executor.*

5. *'Owner' is defined in section 61(3) of the Commons Act 2006 and section 31(7) of the Highways Act 1980 and means, broadly, a legal owner of the freehold interest in the land.*

6. *Where the application relates to more than one parcel of land, a description of each parcel should be included in Paragraph 4 of Part A and the remainder of the form should be completed to clearly identify which statement and/or declaration relates to which parcel of land. This may require the insertion of additional wording. See separate notes for further guidance. Multiple parcels of land should be clearly identified by coloured edging on any accompanying map.*

7. *Where a statement or declaration requires reference to colouring shown on an accompanying map or previously lodged map, the colouring must be clearly specified and must match that shown on the relevant map. For example, if a footpath is specified in a Part C declaration as shown coloured brown, the accompanying map or previously deposited map referred to must reflect that colouring.*

8. *An application must be accompanied by an ordnance map, or (in respect of declarations under Part C or statements under Part D of this form) refer to a map previously deposited in accordance with the Commons (Registration of Town or Village Greens) and Dedicated Highways (Landowner Statements and Declaration) (England) Regulations 2013 or (if deposited before 1st October 2013) in accordance with section 31(6) of the Highways Act 1980. Any accompanying map must be an ordnance map at a scale of not less than 1:10,560 showing the boundary of the land to which the application relates in coloured edging.*

9. *An application must be accompanied by the requisite fee – please ask the appropriate authority for details.*

10. 'Appropriate authority' means (a) in relation to a map or statement deposited or declaration lodged under section 31(6) of that Act, an appropriate council (as defined in section 31(7) of the Highways Act 1980); and (b) in relation to a statement and map deposited under section 15A(1) of the 2006 Act, a commons registration authority (defined in section 4 of the Commons Act 2006 and section 2 of the Commons Registration Act 1965). In practice, the appropriate council and commons registration authority will usually be the same body.

**PART A: Information relating to the applicant and land to which the application relates
(all applicants must complete this Part)**

1. Name of appropriate authority to which the application is addressed:

Hertfordshire County Council

2. Name and full address (including postcode) of applicant:

Katie Hilton
Cheffins
Clifton House
1 & 2 Clifton Road
Cambridge
CB1 7EA

3. Status of applicant (tick relevant box or boxes):

I am

- (a) the owner of the land(s) described in paragraph 4.
(b) making this application and the declarations it contains on behalf of Cheffins on behalf of Mr Robert Law who is the owner of the land described in paragraph 4 and in my capacity as land agent.

4. Insert description of the land(s) to which the application relates (including full address and postcode):

This application relates to land at Thrift Farm, Baldock Road, Royston, Hertfordshire SG8 9NN shown outlined in RED on the plan annexed hereto. The land area encompasses 320 hectares (791 acres) defined by Rural Land Register (RLR) field parcel numbers as follows:

TL3138 0958	TL3139 6905	TL3239 0313	TL3339 2215
TL3138 2162	TL3139 8001	TL3238 4482	TL3338 4766
TL3138 3130	TL3138 7191	TL3238 5457	TL3339 5722
TL3138 4215	TL3138 8469	TL3238 6560	TL3339 3534
TL3137 6585	TL3138 9168	TL3238 4461	TL3339 2249
TL3138 3747	TL3238 1568	TL3239 5420	TL3339 2053
TL3138 4286	TL3139 7425	TL3238 7778	TL3339 3950
TL3138 4065	TL3139 8415	TL3238 9857	TL3339 4767
TL3138 5248	TL3139 9208	TL3239 9214	TL3339 5980
TL3138 8236	TL3139 9726	TL3239 6462	
TL3139 7111	TL3239 1931	TL3339 0837	
TL3139 8320	TL3239 2701	TL3339 2341	

5. Ordnance Survey six-figure grid reference(s) of a point within the area of land(s) to which the application relates (if known):

TL321386

6. This deposit comprises the following statement(s) and/or declarations (*delete Parts B, C, or D where not applicable*):

Part C

PART C: Declaration under section 31(6) of the Highways Act 1980

1. Mr Robert Law is the owner of the land described in paragraph 4 of Part A of this form and shown outlined RED on the map lodged with Hertfordshire County Council on the first day of July 2022.

2. On the first day of July 2022 Mr Robert Law deposited with Hertfordshire County Council, being the appropriate council, a statement accompanied by a map showing Mr Robert Law's property outlined RED which stated that:

- the ways shown BLUE on that map had been dedicated as footpaths

No other ways had been dedicated as highways over Mr Robert Law's property.

3. No additional ways have been dedicated over the land outlined RED on the map referenced in paragraph 1 above since the statement dated the first day of July 2022 referred to in paragraph 2 above and at the present time Mr Robert Law has no intention of dedicating any more public rights of way over the property.

PART F: Statement of Truth
(all applicants must complete this Part)

WARNING: If you dishonestly enter information or make a statement that you know is, or might be, untrue or misleading, and intend by doing so to make a gain for yourself or another person, or to cause loss or the risk of loss to another person, you may commit the offence of fraud under section 1 of the Fraud Act 2006, the maximum penalty for which is 10 years' imprisonment or an unlimited fine, or both.

I BELIEVE THAT THE FACTS AND MATTERS CONTAINED IN THIS FORM ARE TRUE

Signature (of the person making the statement of truth): 

Print full name: Katie Hilton BSc (Hons) MBIAC for and on behalf of Cheffins

Date: 22nd November 2022

You should keep a copy of the completed form

Data Protection Act 1998 - Fair Processing Notice

The purpose of this Fair Processing Notice is to inform you of the use that will be made of your personal data, as required by the Data Protection Act 1998.

The appropriate authority (see explanation of definition in above guidance notes) in England is the data controller in respect of any personal data that you provide when you complete this form.

The information that you provide will be used by the appropriate authority in its duties to process applications to deposit statements, maps and declarations under section 31(6) the Highways Act 1980 and statements under section 15A(1) of the Commons Act 2006. The information you provide will also be used by the appropriate authority in its duty to update the registers in which details of such deposits are recorded under the Dedicated Highways (Registers under Section 31A of the Highways Act 1980) (England) Regulations 2007 and the Commons (Registration of Town or Village Greens) and Dedicated Highways (Landowner Statements and Declarations) (England) Regulations 2013.

The appropriate authority is required by the legislation above to maintain a register which holds information provided in this form, which can be inspected online or in person by members of the public on request. It may also be required to release information, including personal data and commercial information, on request under the Environmental Information Regulations 2004 or the Freedom of Information Act 2000. However, the appropriate authority will not permit any unwarranted breach of confidentiality nor will they act in contravention of their obligations under the Data Protection Act 1998.