

133/2/13

DEPOSIT OF STATEMENT AND PLAN

SECTION 31(6) OF THE HIGHWAYS ACT 1980

To Hertfordshire County Council

- 1 McMullen & Sons, Limited is and has been since 5 August 1950 the owner within the meaning of the above section of the land known as Chadwell Springs Golf Course more particularly delineated on the plan accompanying this statement and thereon edged red
- 2 The aforementioned land lies in the Parishes of Little Amwell and Great Amwell
- 3 No ways over the land have been dedicated as highways
- 4 The deposit shall comprise this statement and accompanying the plan.

Signed:

Director

Name of Landowner: McMullen & Sons, Limited

Address: 26 Old Cross, Hertford, Hertfordshire

Date 31st January 1986.

Signed (Witness)

Name (of Witness)

Address 26 OLD CROSS, HERTFORD, HERTS.

Occupation CHARTERED SURVEYOR.

Disc 133/2/13, Docs.2

Ref 15



Site-centred



OS 1:50,000

GOLF COURSE

FARMWAY

WATER ROAD

WATER POND

OS 1:50,000

Superplan...

Option 1

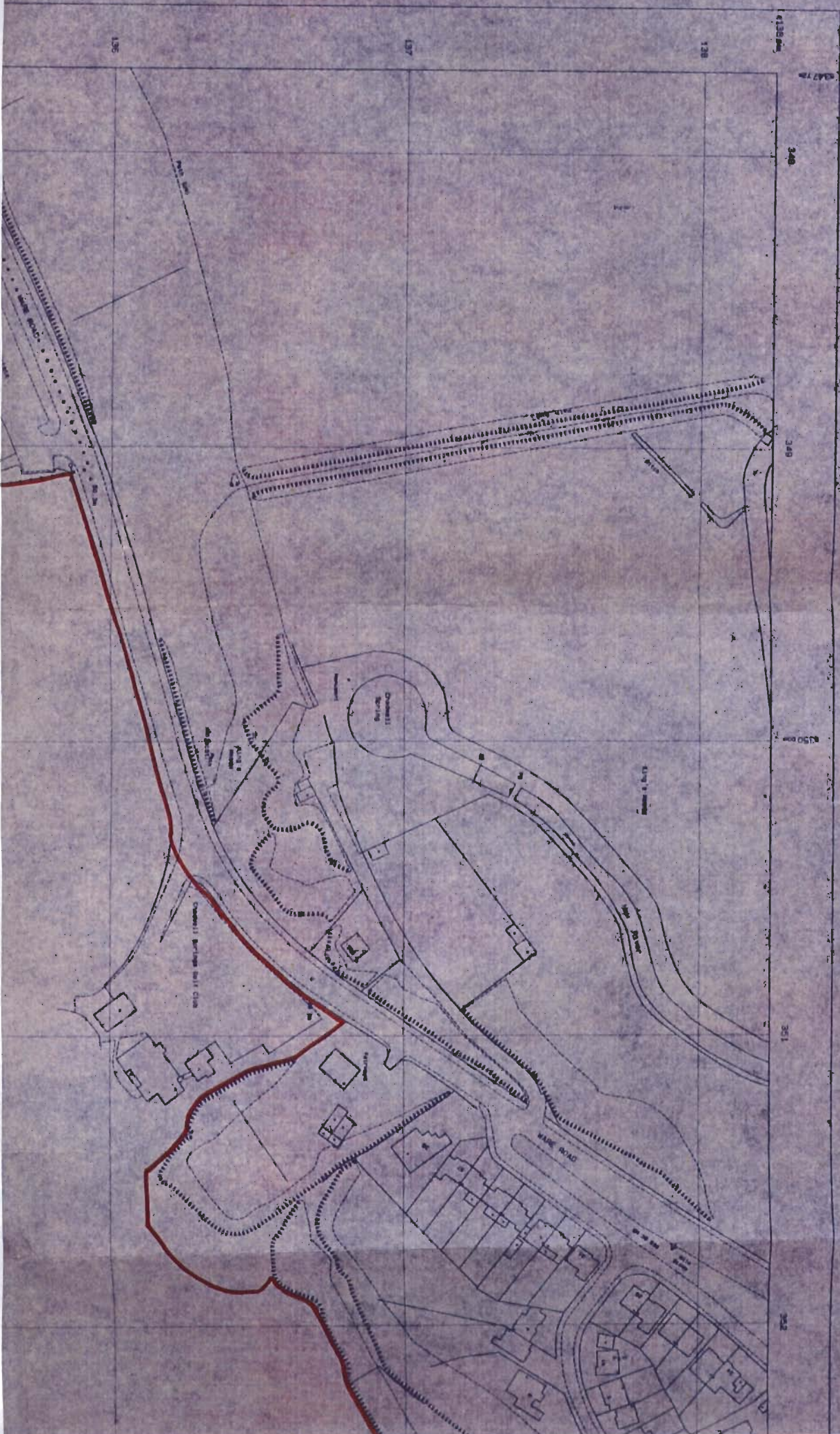

ENTER GIRD
FROM ROAD
10000 1000



SALT CREEK

BIRCH FIELD

BIRCH FIELD

SPORTS GROUNDS



133

134

135

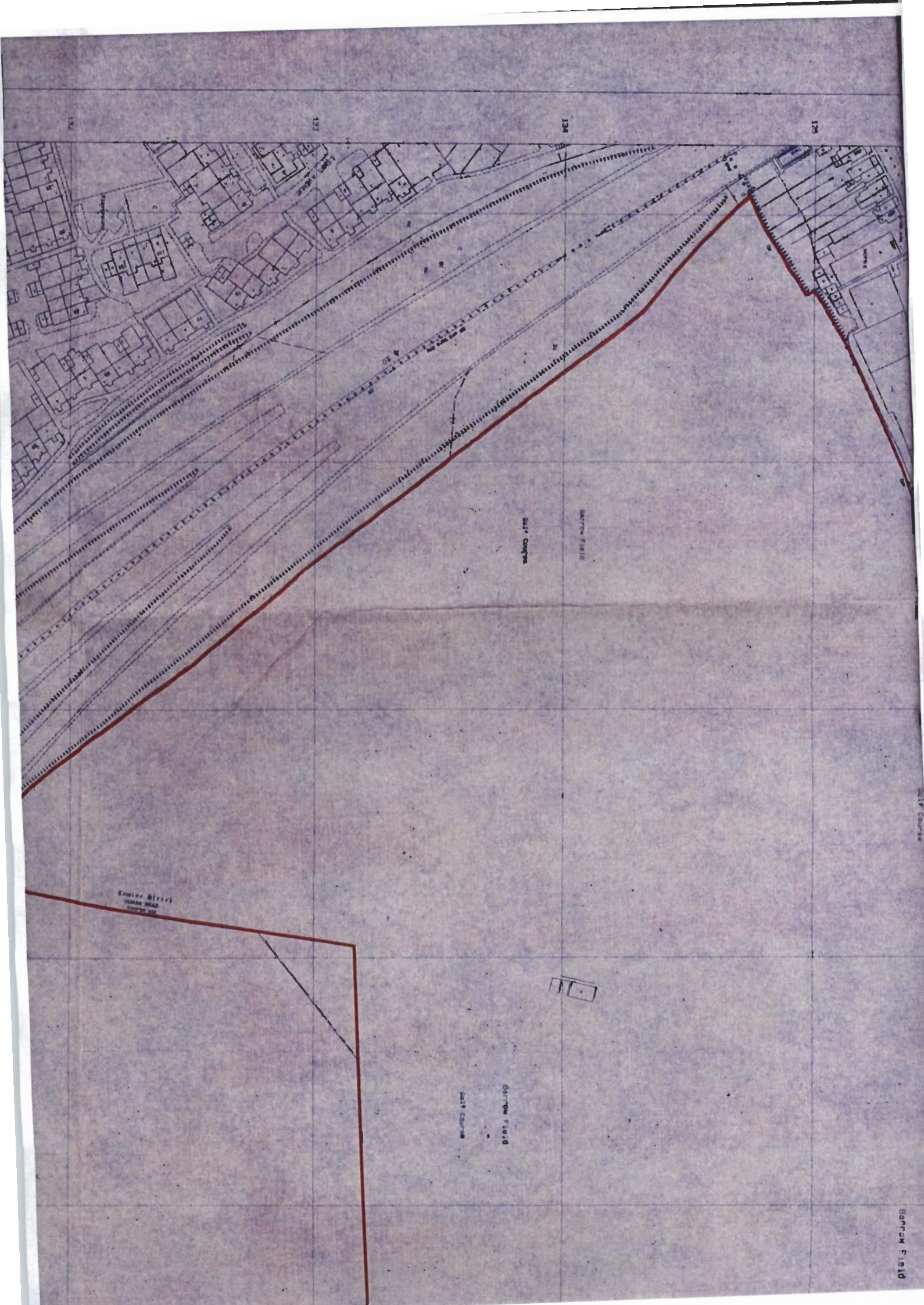

Plotted 13 Nov 1952 from Ordnance Survey original
 data and incorporating surveying revision
 available at this date. © Crown Copyright 1952.
 Reproduction in whole or in part is prohibited
 without the prior permission of Ordnance Survey.
 Ordnance Survey are sold subject to Ordnance
 Survey Terms & Conditions of Sale, available
 on request.

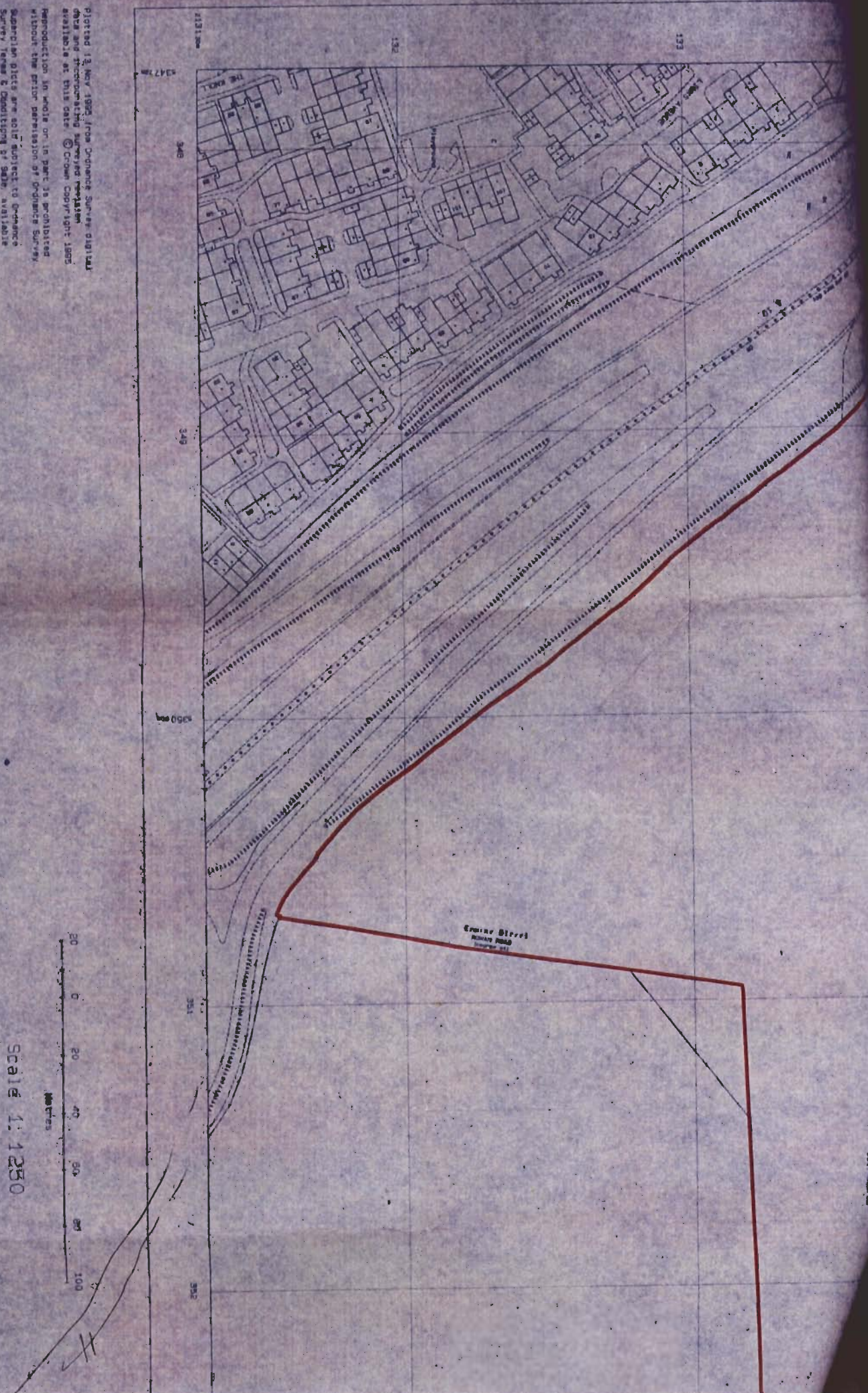

DATED 27th November **1996**

STATUTORY DECLARATION

-of-

Under S31(6) Highways Act 1980

relating to

**Chadwell Springs Golf Club,
Ware,
Hertfordshire**

**McLellans
13 Old Cross
Hertford
Hertfordshire
SG14 1RE**

STATUTORY DECLARATION

SECTION 31(6) OF THE HIGHWAYS ACT 1980

I _____ IE, of 26 Old Cross Hertford Hertfordshire DO
SOLEMNLY AND SINCERELY DECLARE as follows

1 I am a Director of McMullen & Sons, Limited whose registered office is at 26 Old Cross, Hertford, Hertfordshire and am duly authorised to make this statutory declaration on behalf of McMullen & Sons, Limited. McMullen & Sons, Limited is and has been since 5 August 1950 the owner of the land known as Chadwell Springs Golf Club more particularly delineated on the plan accompanying this declaration and thereon edged red.

2 I am informed by Mr Nigel Mahoney, a partner in the firm of McLellans of 13 Old Cross, Hertford, Hertfordshire, the solicitors acting for McMullen & Sons, Limited in this matter, that on the 13th day of February 1996 he deposited with Hertfordshire County Council, being the appropriate Council, a statement by me dated 31 January 1996 accompanied by a plan delineating the property of McMullen & Sons, Limited by red edging which stated that no ways had been dedicated as highways over the property of McMullen & Sons, Limited.

3 No additional ways have been dedicated over the land edged red on the plan marked "KMC2" accompanying this declaration since the statement dated 31 January 1996 referred to in paragraph 2 above.

AND I MAKE this solemn declaration conscientiously believing it to be true and by virtue of the Statutory Declarations Act 1835.

Declared at

Hertford, Hertfordshire

MARTIN SPOFFERD
ST. ANDREW HOUSE
46/48 ST. ANDREW'S STREET
HERTFORD
HERTS. SG14 1JT

This 27 day of November 1996

Before me

Solicitor empowered to administer oaths/Commissioner for Oaths.

**This is the plan marked "KMC2"
referred to in
the Statutory Declaration of**

Declared this 27 day of November 1996

Before me

~~Solicitor empowered to administer Oaths~~/Commissioner for Oaths



Site-centred



Superplan...

Option 1

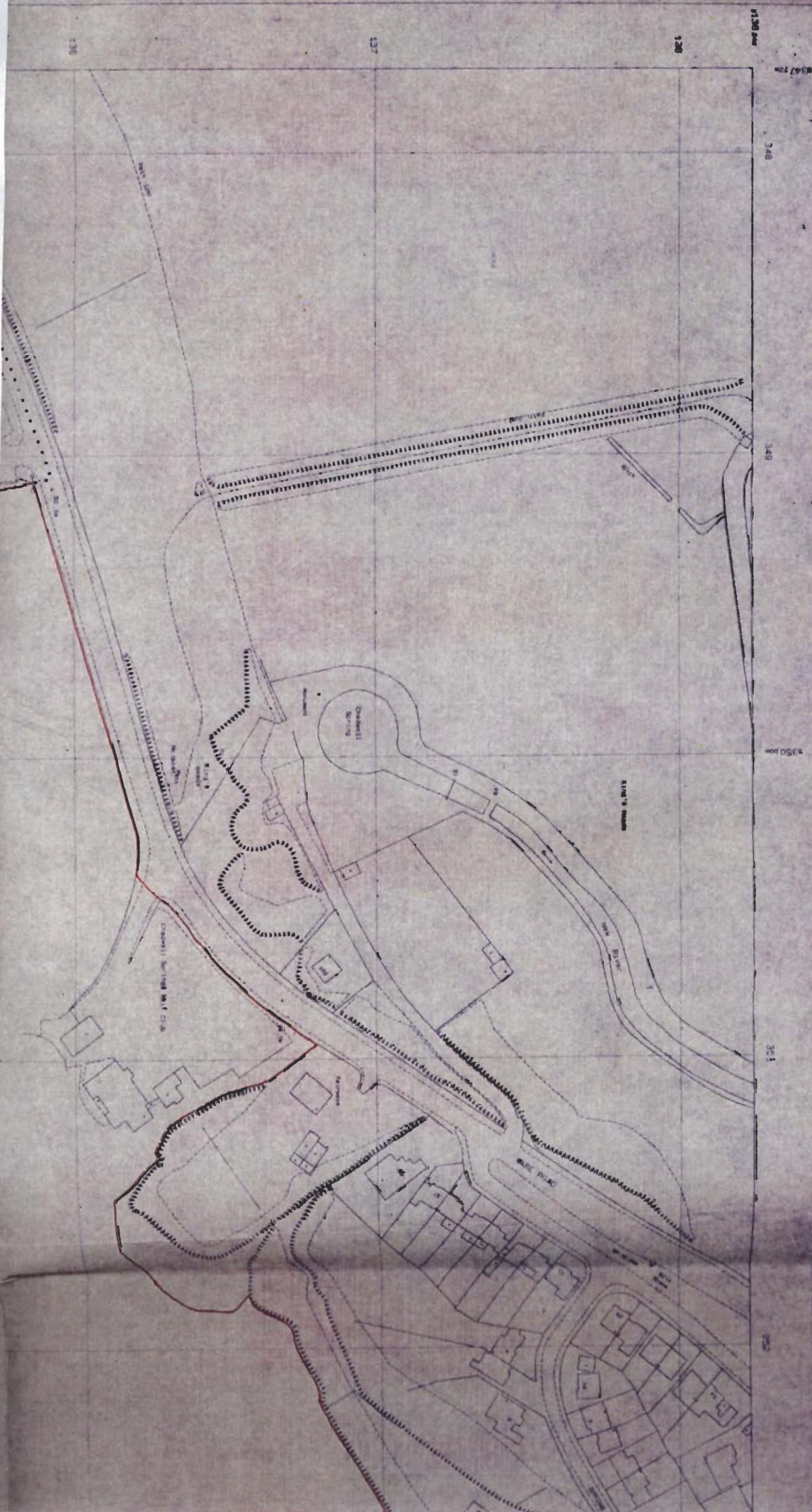

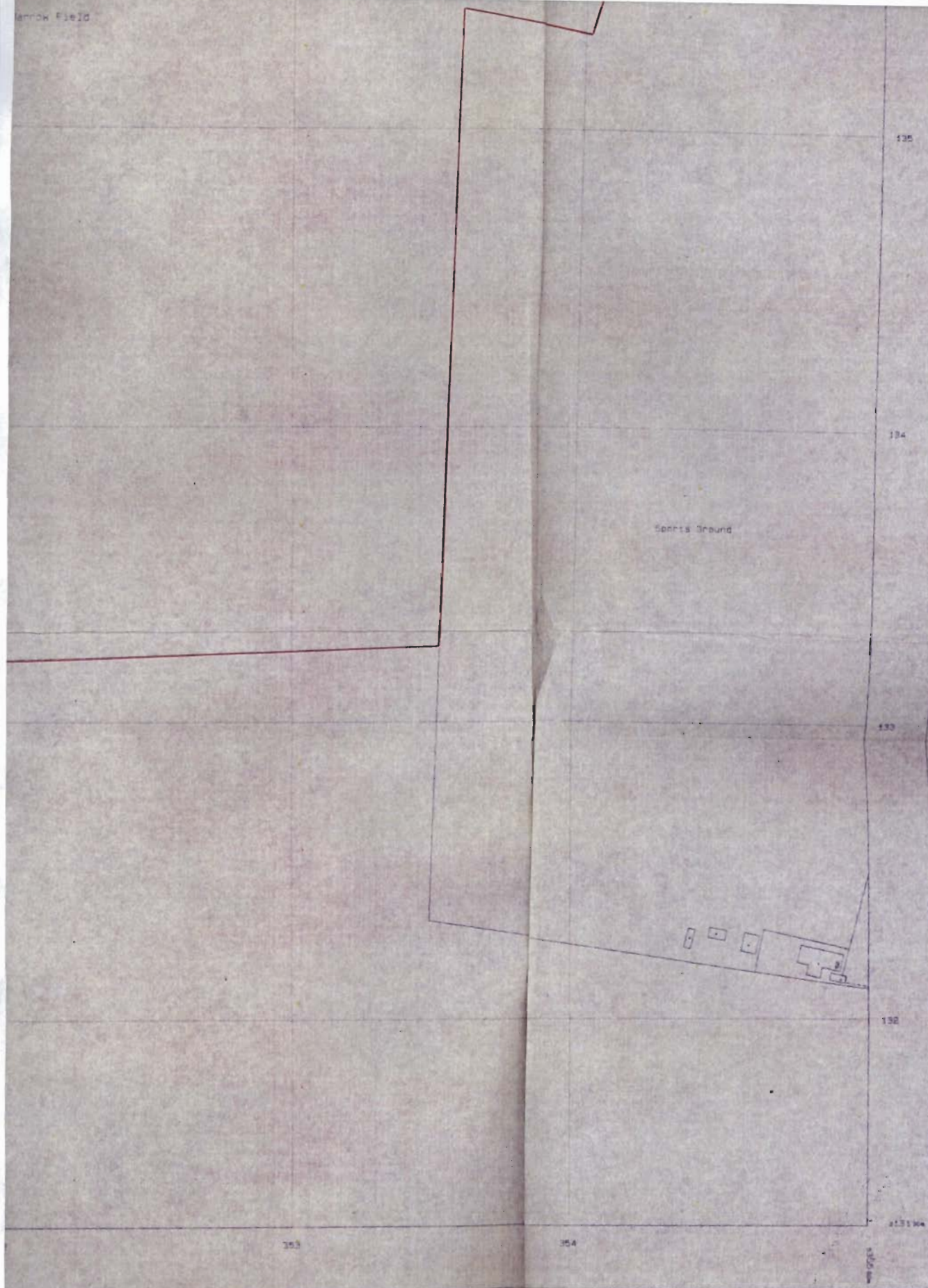

The representation of a road, track or path is no evidence of a right of way.
Heights given in metres above the Newlyn Datum.
The alignment of tunnels is approximate.

Available at this date. Crown Copyright is available under license from the Controller of Her Majesty's Stationery Office. Reproduction in whole or in part is prohibited without the prior permission of the Controller of Her Majesty's Stationery Office. Applications for such permission should be made to the Controller, 90 Tottenham Court Road, London W1P 0LP.

