

REGISTER OF DEPOSITS

☒ **HIGHWAYS ACT 1980***

X

☒ **COMMONS ACT 2006***

X

(* tick if applicable or specify N/A)

DETAILS OF APPLICATION

Date Application received in prescribed form 04/11/16

Date on which any highways declaration expires 03/11/36

Parcel

<p>District East Herts</p> <p>Address and postcode of buildings on each piece of land subject to the application to which a postcode has been assigned</p> <p>Nearest town/city to above</p> <p>OS 6 figure Grid Reference(s) for a point within the area of the land <i>(if possible for postcode point above)</i></p>	<p>Parish Ware</p> <p>Land east of the A10, west of the A1170 and north of Quincey Road Ware</p> <p>Ware/St Albans</p> <p>TL 353 157</p>
---	--



NOTICE OF LANDOWNER DEPOSITS under
Section 31(6) of the Highways Act 1980 and
Section 15A(1) of the Commons Act 2006
HERTFORDSHIRE COUNTY COUNCIL

An application to lodge a declaration under section 31(6) of the Highways Act 1980 and deposit a statement under section 15A(1) of the Commons Act 2006 has been made in relation to the land (or lands) described below and shown edged red on the accompanying map.

PLEASE NOTE:

This deposit may affect rights over the land described below. Deposits made under section 31(6) of the Highways Act 1980 may prevent deemed dedication of public rights of way over such land under section 31(1) of that Act. Deposits made under section 15A(1) of the Commons Act 2006 may affect the ability to register such land as a town or village green under section 15 of that Act. For further information please see guidance at <https://www.gov.uk/guidance/town-and-village-greens-how-to-register>

Description of the land

Land east of the A10, west of the A1170 and north of Quincey Road, Ware

Name of the parish, ward or district in which the land is situated

Ware parish, East Herts district

The deposit was submitted on behalf of Hubert C Leach (Nun's Triangle) Ltd and was received by this authority on 4th November 2016.

The authority maintains a register of maps, statements and declarations deposited under section 31A of the Highways Act 1980 and section 15B of the Commons Act 2006. This register can be accessed online at www.hertfordshire.gov.uk/landownerdeposits or can be inspected free of charge at Hertfordshire County Council, County Hall, Pegs Lane, Hertford, Hertfordshire, SG13 8DN during office hours between 9:00am and 5:00 pm

Signed on behalf of Hertfordshire County Council:

Name and position of Signatory: R. Cuthbert Team Leader Access & Rights of Way

Date: 4th November 2016

PART A

Information relating to the Applicant and Land to which the Application relates

(all applicants must complete this part)

- 1 Name of appropriate authority to which the application is addressed:
Hertfordshire County Council

- 2 Name and full address (including postcode) of applicant:

Name: Christopher R Shelton
Address: Springfield House
99 – 101 Crossbrook Street
Waltham Cross
Herts
Postcode: EN8 8JR

Hertfordshire County Council

RECEIVED

Date: 4th November 2016

- 3 Status of applicant (tick relevant box or boxes):

I am

- (a) ☐ the owner of the land(s) described in paragraph 4.
(b) ☒ making this application and the statements/declarations it contains on behalf of Hubert C Leach (Nun's Triangle) Ltd who is the owner of the land(s) described in paragraph 4 and in my capacity as Company Director.

- 4 Insert description of the land(s) to which the application relates (including full address and postcode):

Description of Land(s): Land to the east of the A10, west of the A1170 and north of Quincey Road, Ware, Hertfordshire

Full address:

Postcode: No postal code available

- 5 Ordnance Survey six-figure grid reference(s) of a point within the area of land(s) to which the application relates (if known):

- 6 This deposit comprises the following statement(s) and/or declarations (tick relevant box or boxes):

PART B ☐
PART C ☒
PART D ☐

PART C

Declaration under section 31(6) of the Highways Act 1980

- 1 Hubert C Leach (Nun's Triangle) Limited is the owner of the land described in paragraph 4 of Part A of this form and shown edged in red on the map accompanying this declaration.

- 2 On the 1st day of November 2006 Swanfield (Hamels) Limited predecessor in title deposited with Hertfordshire County Council, being the appropriate council, a statement accompanied by a map showing Swanfield (Hamels) Limited property edged in red which stated that:

 No ways had been dedicated as highways over Swanfield (Hamels) Limited property.

- 3 On the 8th day of November 2006 Swanfield (Hamels) Limited predecessor in deposited with Hertfordshire County Council, being the appropriate council, a declaration dated 8th November 2006, stating that no additional ways had been dedicated since the deposit of the statement referred to in paragraph 2 above.

- 4 No additional ways have been dedicated over the land edged red on the map accompanying this declaration/referenced in paragraph 1 above since the statement dated 1st November 2006 referenced to in paragraph 2 above since the date of the declaration referred to in paragraph 3 above and at the present time Hubert C Leach (Nun's Triangle) Limited have no intention of dedicating any more public rights of way over the property.

PART D

Statement under section 15A(1) of the Commons Act 2006

Hubert C Leach (Nun's Triangle) Limited the owner of the land described in paragraph 4 of Part A of this form and shown edged red on the map accompanying this statement.

Hubert C Leach (Nun's Triangle) Limited wish to bring to an end any period during which persons may have indulged as of right in lawful sports and pastimes on the whole or any part of the land shown edged red on the accompanying map referenced above.

PART F

Statement of Truth

(all applicants must complete this part)

WARNING: If you dishonestly enter information or make a statement that you know is, or might be, untrue or misleading, and intend by doing so to make a gain for yourself or another person, or to cause loss or the risk of loss to another person, you may commit the offence of fraud under section 1 of the Fraud Act 2006, the maximum penalty for which is 10 years' imprisonment or an unlimited fine, or both.

I BELIEVE THAT THE FACTS AND MATTERS CONTAINED IN THIS FORM ARE TRUE

Signature: _____

(of the person making the statement of truth)

Date: _____

1/11/2016

Print Name: _____

CHRISTOPHER SHELTON

You should keep a copy of the completed form

Data Protection Act 1998

Fair Processing Notice

The purpose of this Fair Processing Notice is to inform you of the use that will be made of your personal data, as required by the Data Protection Act 1998.

The appropriate authority (see explanation of definition in above guidance notes) in England is the data controller in respect of any personal data that you provide when you complete this form.

The information that you provide will be used by the appropriate authority in its duties to process applications to deposit statements, maps and declarations under section 31(6) the Highways Act 1980 and statements under section 15A(1) of the Commons Act 2006. The information you provide will also be used by the appropriate authority in its duty to upgrade the registers in which details of such deposits are recorded under the Dedicated Highways (Registers under Section 31A of the Highways Act 1980 (England) Regulations 2007 and the Commons (Registration of Town or Village Greens) and Dedicated Highways (Landowner Statements and Declarations) (England) Regulations 2013.

The appropriate authority is required by the legislation above to maintain a register which holds information provided in this form, which can be inspected online or in person by members of the public on request. It may also be required to release information, including personal data and commercial information, on request under the Environmental Information Regulations 2004 or the Freedom of Information Act 2000. However, the appropriate authority will not permit any unwarranted breach of confidentiality nor will they act in contravention of their obligations under the Data Protection Act 1998.

H.M. LAND REGISTRY		TITLE NUMBER
		HD 344007
ORDNANCE SURVEY PLAN REFERENCE	TL 3515 TL 3516	Scale 1/2500
ADMINISTRATIVE AREA	HERTFORDSHIRE : EAST HERTFORDSHIRE	
		© Crown copyright

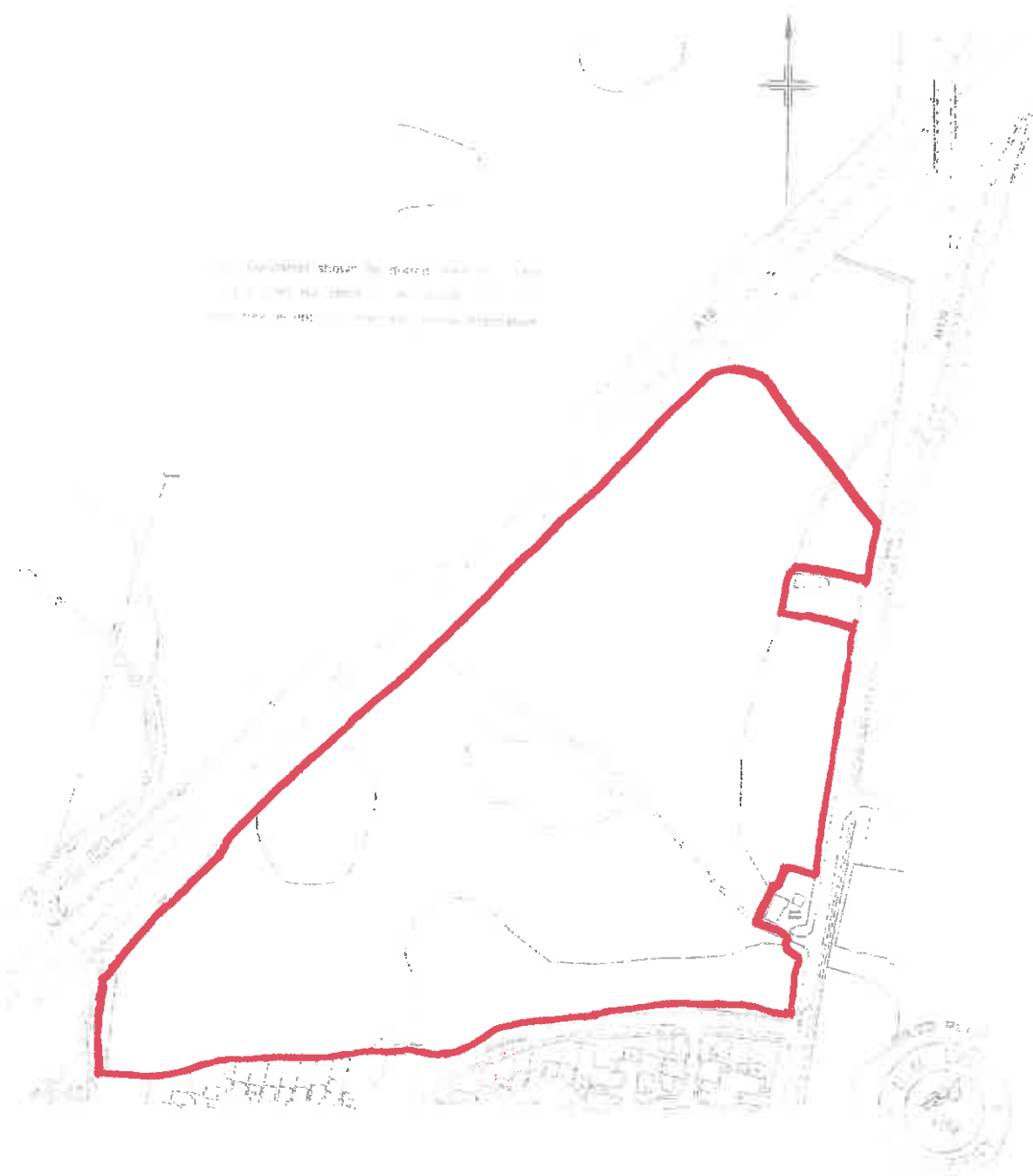

0890034003

title plan shows the general position of the boundaries; it does not show the exact line of the boundaries. Measurements scaled from this plan may not match measurements between the same points on the ground.
 more information see Land Registry Public Guide 7 - Title Plans.
 official copy shows the state of the title plan on 24 October 2006 at 9:29:37. It may be subject to distortions in scale.
 or s.67 of the Land Registration Act 2002, this copy is admissible in evidence to the same extent as the original.
 sd on 24 October 2006.
 own copyright. Produced by HMLR. Further reproduction in whole or part is prohibited without the prior written permission of Ordnance Survey. Licence Number GD272728.
 title is dealt with by the Stevenage District Land Registry.