



BARCLAYS

3

The Definitive Map Officer
Environmental Management Group
Hertfordshire County Council
County Hall
Hertford
SG13 8DN

EJM/RD
(D

23rd April 1997

Dear Sir

**HIGHWAYS ACT 1980
LAND AT HITCHIN AND WELWYN, HERTFORDSHIRE**

In accordance with Section 31(6) of the Highways Act 1980, the freehold owner of land shown coloured red upon the attached two plans marked A and B by this letter make a statement that only those highways indicated upon the accompanying plans to a scale of 1/2500 and 1/10,000 are admitted as being highways dedicated to the public.

You will note that the only highway dedicated to the public which appears to cross our property is that in relation to Footpath 25 at Welwyn. Whilst we as owners do not refute the existence of Footpath 25, we believe that there is doubt as to whether the footpath in fact follows the route of the track as presently constituted on the ground. We understand that the evidence of elderly residents of the area appears to indicate that the correct position of the footpath is immediately to the north of the track, and if this were so then for much of its length it would not cross land within our ownership.

Would you please confirm receipt of this Statement to our authorised Agents, Warmingtons, The Estate Office, Offley Hoo, Great Offley, Hitchin, Herts, SG5 3ED, where Mr C J Perks has authority to discuss the matter with you. Please also confirm that this Statement is suitable as a deposit under Section 31(6) of the Highways Act 1980.

Yours faithfully

Private Client Manager

PO Box 48, 4th Floor,
Telephone (

lex 629

PLAN A

FOR BARCLAYS PRIVATE BANK TRUST (ASSET OF MANAGED)

Scale: 1:2500

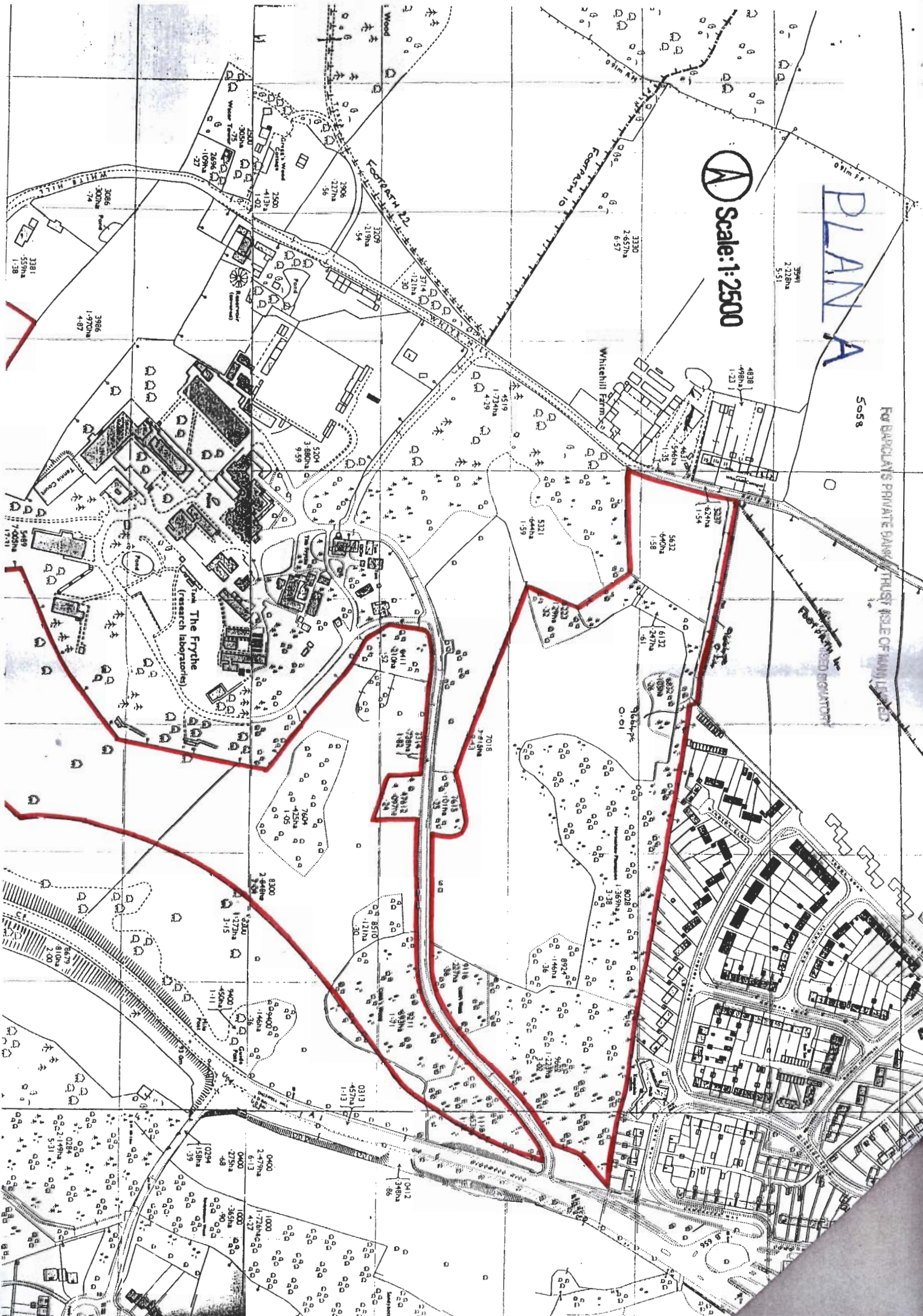

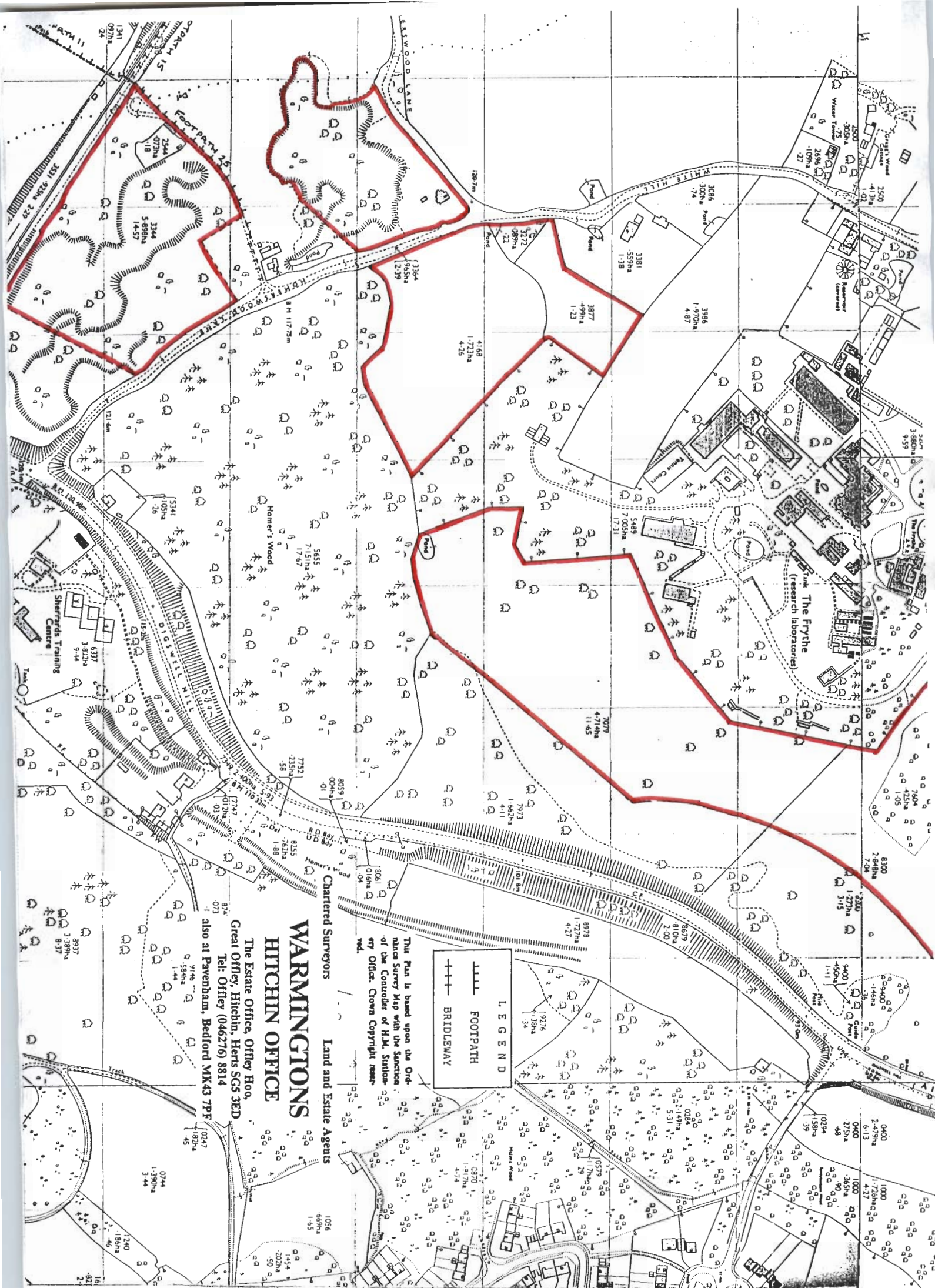

LEGEND
--- FOOTPATH
--- BRIDLEWAY

This Plan is based upon the Ordnance Survey Map with the Sanctions of the Controller of H.M. Stationery Office. Crown Copyright reserved.

Chartered Surveyors
WARMINGTONS
HITCHIN OFFICE
Land and Estate Agents
The Estate Office, Office Hoo,
Great Office, Hitchin, Herts SG5 3ED
Tel: Office (046276) 8814
also at Pavenham, Bedford MK43 7PF

For BARCLAYS PRIVATE BANK & TRUST (ISLE OF MAN) LIMITED

Fox
Cove

AUTHORISED SIGNATORY

PLAN B

HOLWELL

(Det.)

Cadwell

Jeknild
Way

2
51.809

9
39.433

10
20.721

11 pt

39.392

21 pt

Camp

Allot
Gdn

Cumulus

Allotment
Gardens

Recreation
Ground

U.D. Bdy

Bridge
(Children)

LEGEND

FOOTPATH

BRIDLEWAY

This Plan is based upon the Ordnance Survey Map with the Sanction of the Controller of H.M. Stationery Office. Crown Copyright reserved.

Chartered Surveyors

Land and Estate Agents

WARMINGTONS
HITCHIN OFFICE

The Estate Office, Offley Hoo,
Great Offley, Hitchin, Herts SG5 3ED
Tel: Offley (046276) 8814
also at Pavenham, Bedford MK43 7PF