

## HERTFORDSHIRE COUNTY COUNCIL

### THE HERTFORDSHIRE (LITTLE GREEN LANE, CROXLEY GREEN) (PROHIBITION OF MOTOR VEHICLES) (EXPERIMENTAL) ORDER 2024

NOTICE is given that the Hertfordshire County Council, for the purpose of carrying out an experimental scheme of traffic control, has made an Order under the Road Traffic Regulation Act 1984, to introduce an experimental Prohibition of Motor Vehicles in parts of Croxley Green.

The purpose of the Order will be to trial the new Prohibition of Motor Vehicles in parts of Little Green Lane, as set out within the Order, operating at all times in the following locations:

- (a) between the junction with Lincoln Drive and No. 5 Little Green Lane; and
- (b) between Waterdell House, Little Green Lane and the junction with Sarratt Road.

There will be exemptions for access by agricultural vehicles to adjacent fields. Other exemptions will apply in respect of Emergency Service vehicles and other vehicles being used by Statutory Authorities pursuant to exercise of statutory powers.

The trial will evaluate the effect of the introduction of such movement controls within Croxley Green. The Order, which will come into effect on Monday 25 March 2024, will remain in effect for a period of up to 18 months.

Documents giving more detailed particulars of the Order may be viewed from 15 March 2024 during office hours, at Main Reception, Hertfordshire County Council, County Hall, Pegs Lane, Hertford, or on line at [www.hertfordshire.gov.uk/trafficorders](http://www.hertfordshire.gov.uk/trafficorders) by selecting Three Rivers and looking at ref: TR00324.

General enquiries relating to the Experimental Order should be referred to the Highways Engineer concerned Ross Corben tel: 0300 123 4047 or [ross.corben@hertfordshire.gov.uk](mailto:ross.corben@hertfordshire.gov.uk).

Hertfordshire County Council will monitor the effects of the experimental restrictions and may amend the experimental provisions, if considered necessary. The Council will be considering in due course whether the experimental provisions of this Order should be continued in force indefinitely.

Any person may object to the making of the permanent Order within a period of 6 months beginning with the date on which the experimental Order comes into force or, if the Order is varied by another Order or modified pursuant to section 10(2) of the 1984 Act, beginning with the date on which the variation or modification or the latest variation or modification comes into force. Objections or other representations should be made in writing to [tro.team@hertfordshire.gov.uk](mailto:tro.team@hertfordshire.gov.uk) or TRO Services Team, Postal Point (CHO242), County Hall, Pegs Lane, Hertford, SG13 8DN stating the grounds on which they are made.

Any person wishing to question the validity of the Order, or of any provision contained in it on the grounds that it is not within the powers conferred by the Road Traffic Regulation Act 1984, or on the grounds that any requirement of the Act or any Instrument made under it has not been complied with in relation to the Order, may within 6 weeks from the date of this Notice apply to the High Court for this purpose.

*The process for introducing this scheme is a statutory duty of the County Council. Any personal data you provide in responding to this Notice will be treated as confidential but will be shared with HCC Officers; County Councillors and contracted third parties who are involved in the statutory process. We will not share identifiable data with third parties outside of the statutory process. Guidance on your rights in respect of personal data are published in the Privacy Policy on our website, [Hertfordshire.gov.uk](http://Hertfordshire.gov.uk)*

County Hall  
Hertford  
Herts SG13 8DN

15 March 2024  
Mark Doran  
Executive Director, Growth and Environment

## HERTFORDSHIRE COUNTY COUNCIL

### ROAD TRAFFIC REGULATION ACT 1984

Date of Order: 05/03/2024

Order No: 8612

#### **THE HERTFORDSHIRE (LITTLE GREEN LANE, CROXLEY GREEN) (PROHIBITION OF MOTOR VEHICLES) (EXPERIMENTAL) ORDER 2024**

The Hertfordshire County Council in exercise of their powers under Sections 9 and 10 of the Road Traffic Regulation Act 1984 (which said Act of 1984 is hereinafter referred to as “the Act of 1984”), and Part IV of Schedule 9 of the Act of 1984 and of all other enabling powers and after consultation with the Chief Officer of Police in accordance with Part III of Schedule 9 of the Act of 1984, hereby make the following Order:-

1. (a) This Order may be cited as “The Hertfordshire (Little Green Lane, Croxley Green) (Prohibition of Motor Vehicles) (Experimental) Order 2024” shall come into effect on Monday 25 March 2024 and remain in effect for a period of up to 18 months.
- (b) The Hertfordshire (Little Green Lane, Croxley Green) (Prohibition of Motor Vehicles) (Experimental) Order 2024 plan numbered **TR00324P** inclusive of the key therein, is incorporated into this Order, as set out in the Schedule to this Order.
2. **Interpretation**  
In this Order –
  - (a) ‘motor vehicle’ shall have the meaning as given in Section 136(1) Road Traffic Regulation Act 1984.
  - (b) ‘pedal cycle’ shall have the meaning as given in The Traffic Signs Regulations and General Directions 2016 – Part 2, Schedule 1.
  - (c) “restricted area” means those lengths of Little Green Lane, Croxley Green as particularised on plan **TR00324P** and in its key therein, which is incorporated into this Order.
  - (d) “universal service provider”, “provision of a universal postal Service” and “postal packet” shall bear the same meanings as in Section 65 of the Postal Services Act 2011.
3. Save as provided in Article 4 to this Order, no person shall cause or permit any motor vehicle to enter or be in the restricted area as defined within Article 2(c).
4. Nothing in Article 3 of this Order applies in relation to –
  - (a) an agricultural vehicle being used in adjacent fields.
  - (b) a vehicle being used for Fire and Rescue, Ambulance or Police purposes.
  - (c) anything done with the permission of or at the direction of a Police Constable in uniform.
  - (d) a vehicle which is being used for one or more of the following purposes and which cannot reasonably be used for such a purpose without entering or being in the restricted area;
    - (i) any operation involving building, demolition or excavation;
    - (ii) the removal of any obstruction to traffic;
    - (iii) the maintenance (including winter maintenance), improvement or reconstruction of a road;
    - (iv) constructing, improving, maintaining, or cleaning of any street furniture;

- (v) the laying, erection, alteration, repair or cleaning of any sewer or of any main pipe or apparatus for the supply of gas, water or electricity, or of any telecommunications apparatus kept or installed for the purposes of a telecommunications code system or of any other telecommunications apparatus lawfully kept installed in any position; or
  - (vi) in the service of the local authority, or statutory water undertaker or water authority in pursuance of statutory powers or duties.
- (e) a marked vehicle which, whilst used by a universal service provider in the course of the provision of a universal postal service, is required to enter or be in the restricted area to enable postal packets to be delivered or collected.
- (f) a pedal cycle.
5. The Hertfordshire County Council in making this Order are satisfied that this Order is required to avoid the likelihood of danger to persons using those lengths of road specified in Article 2(c) of this Order.
6. The Interpretation Act 1978 shall apply for the interpretation of this Order as it applies for the interpretation of an Act of Parliament.
7. The restrictions imposed by this Order shall be in addition to and not in derogation from any restriction or requirement imposed by any other regulations made or having effect as if made under the Act of 1984 or by or under any other enactment.

**Signed:**

*Charlotte McKay*

**Charlotte McKay**  
**Assistant Chief Legal Officer**  
**Environment Law / Legal Services**

**Dated:** 05/03/2024

## STATEMENT OF REASONS

### THE HERTFORDSHIRE (LITTLE GREEN LANE, CROXLEY GREEN) (PROHIBITION OF MOTOR VEHICLES) (EXPERIMENTAL) ORDER 2024

Hertfordshire County Council, for the purpose of carrying out an experimental scheme of traffic control, has made Orders under the Road Traffic Regulation Act 1984, to introduce an experimental Prohibition of Motor Vehicles in parts of Croxley Green.

The trial will comprise of –

- A **Prohibition of Motor Vehicles** effecting Little Green Lane, between the junction with Lincoln Drive and 5 Little Green Lane (approximately 575 metres) and between Waterdell House, Little Green Lane and the junction with Sarratt Road (approximately 230 metres) operating at all times. There will be exemptions for access by agricultural vehicles to adjacent fields. Other exemptions will apply in respect of Emergency Service vehicles, and other vehicles being used by Statutory Authorities pursuant to exercise of statutory powers.

The general purpose of the trial is to improve safety for non-motorised road users, to prevent fly tipping and unnecessary use by off-road vehicles. There has been a petition to the Council to install a road closure with exemptions for local farm traffic, emergency vehicles, maintenance vehicles and statutory undertakers of utilities.

The sections of Little Green Lane are unsuitable for further use by motor vehicles due to deterioration of the road surface. The road closure will prevent anti-social use by off-road vehicles and will add a few vehicles to the local road network.

The road closure to motor traffic will improve conditions for pedestrians, horse riders and cyclists, which will encourage journeys by these modes, improving air quality.

The Authority consider that an experimental scheme of traffic control is required, to evaluate the effectiveness of the introduction of vehicular movement control in Little Green Lane.

The experiment restrictions seek to trial a reduction in motor vehicle movements through the prohibition of vehicles.

The restrictions described are to be trialled for a period of up to 18 months by way of Experimental Traffic Regulation Order.

Hertfordshire County Council will monitor the effects of the experimental restrictions and may amend the experimental provisions, if considered necessary. The Hertfordshire County Council will be considering in due course whether the experimental provisions of this Order should be continued in force indefinitely.

The experimental Orders have been subject to consultation with local and County Councillors representing the area and Three Rivers District Council. The local Police, Ambulance, Fire & Rescue Services, Hertfordshire County Council Passenger Transport Unit Council, Croxley Green Parish Council, Sarratt Parish Council, Cyclist Touring Club, Road Haulage Association, Freight Transport Association, Watford Cycle Hub, The Hill Group, Spokes, Watford Velo Cycling Club, Ramblers, Breakspeare School Project, local businesses and affected residents have also been consulted.

THE HERTFORDSHIRE (LITTLE GREEN LANE, CROXLEY GREEN) (PROHIBITION OF MOTOR VEHICLES) (EXPERIMENTAL) ORDER 2024  
PLAN NO TR00324



**Signed:**  
*Charlotte McKay*  
**Charlotte McKay**  
Assistant Chief Legal Officer  
**Dated:** 05/03/2024

**KEY**  
 "Restricted area" -  
 EXPERIMENTAL  
 MOTOR VEHICLE  
 RESTRICTION

100mm  
50  
20  
10mm  
0

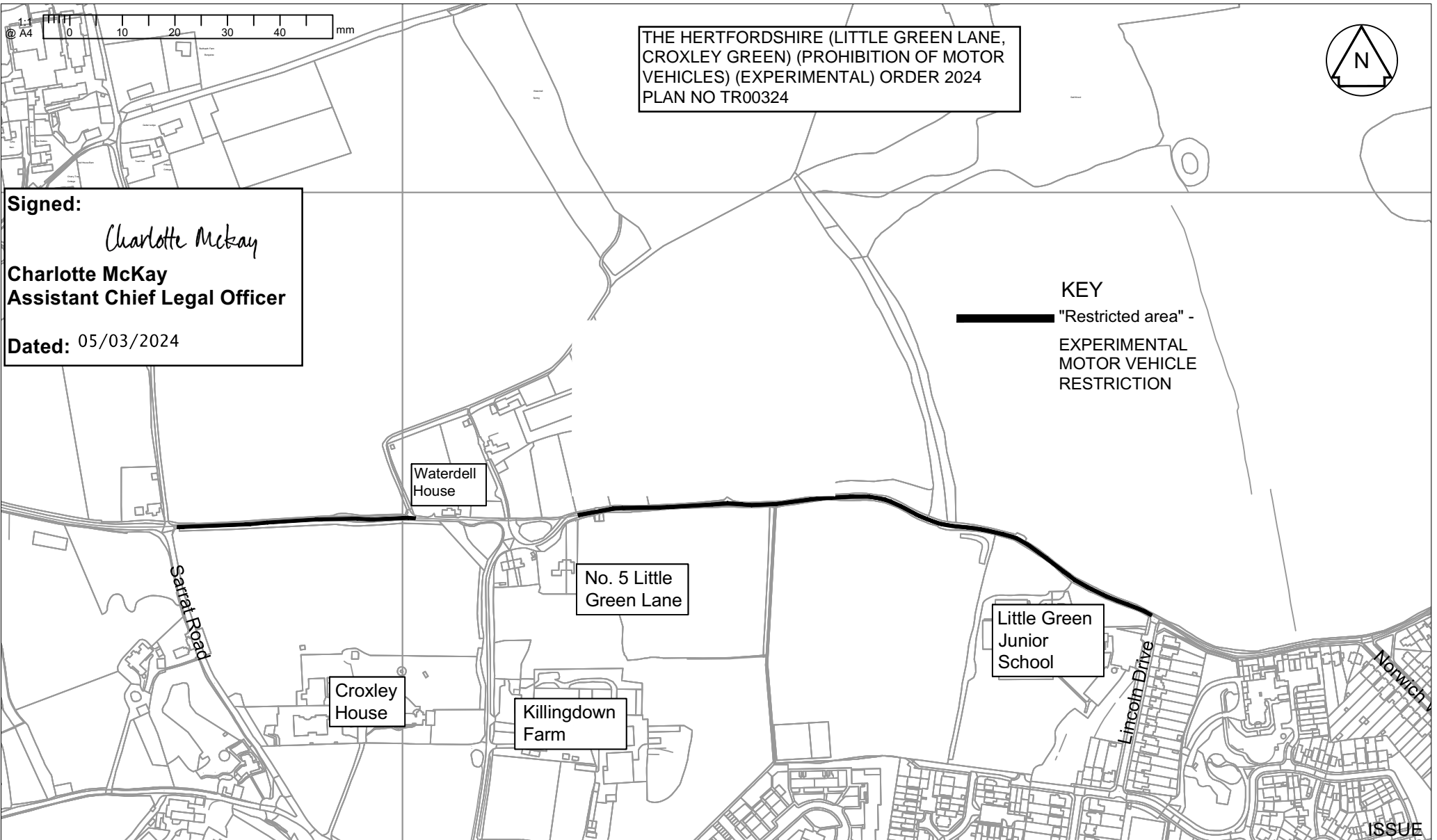

ISSUE

Rev	Date	Description of Revisions	Drawn	Chkd	Appr
XXX	XXX	XXX	XXX	XXX	XXX



Notes					Project	
N1. You are not permitted to copy, sub-licence, distribute or sell any of this data to third parties in any form. (This restriction may not apply to HCC and its licensed contractors, agents & partners.)					LITTLE GREEN LANE, CROXLEY	
N2. © Crown copyright and database right to 2022 Ordnance Survey 100019606.					ED 60/64	
Drawn					Sheet	
RC	RC	IR	IR	28.11.23	230032 EXPERIMENTAL MOTOR VEHICLE RESTRICTIONS EXTENTS	
Signature					Project No.	
				Scale(s)	CH.77002038.Y11.60.LGL	
					1:5000	Sheet No.
						Revision
						000 -